

COPY OF THIS MAP ARE AVAILABLE TO THE PUBLIC AT THE FOLLOWING ADDRESS:
 N.C. DEPARTMENT OF TRANSPORTATION
 DIVISION OF HIGHWAYS
 MAIL STOP 7411
 RALEIGH, NORTH CAROLINA 27611

REVISED
 REN 7-8-96

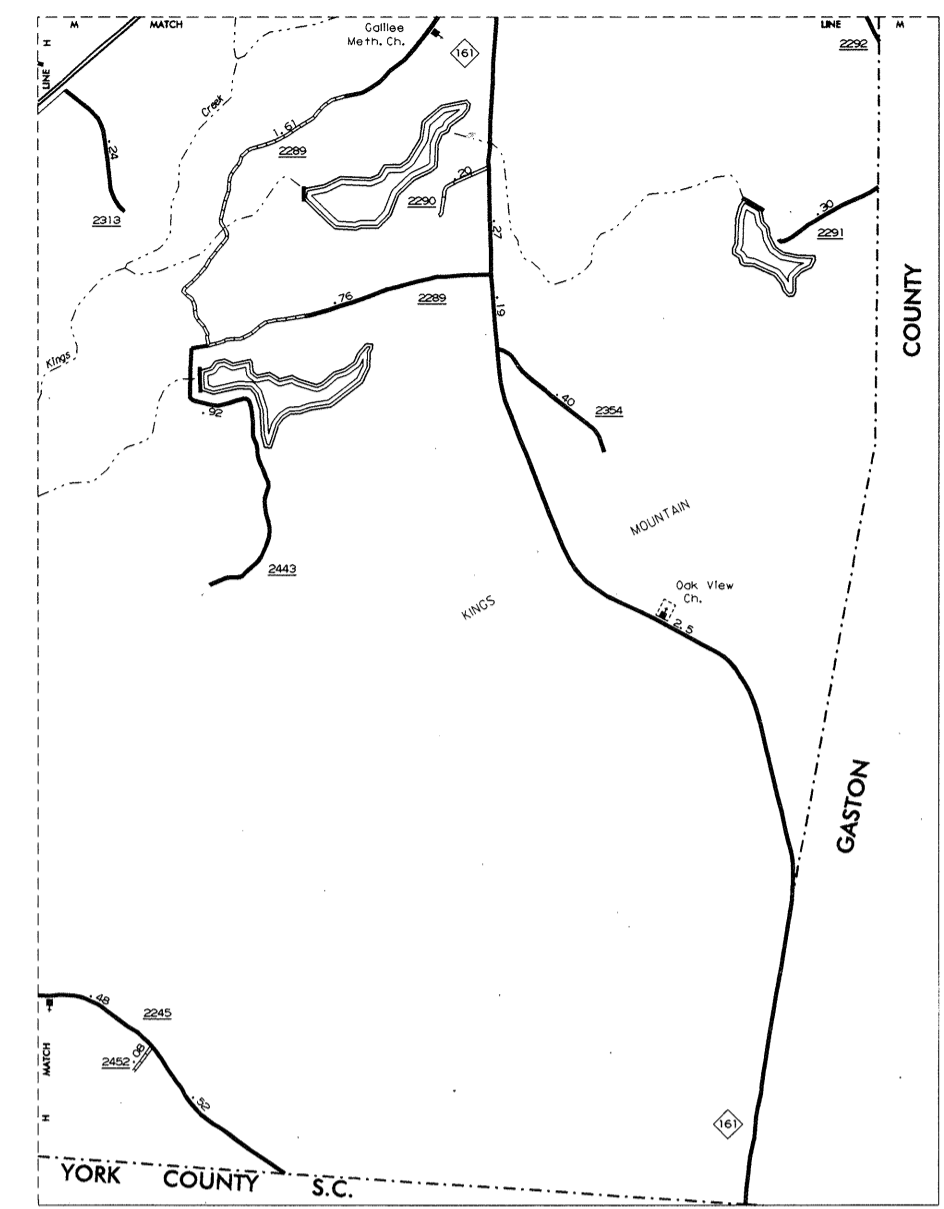
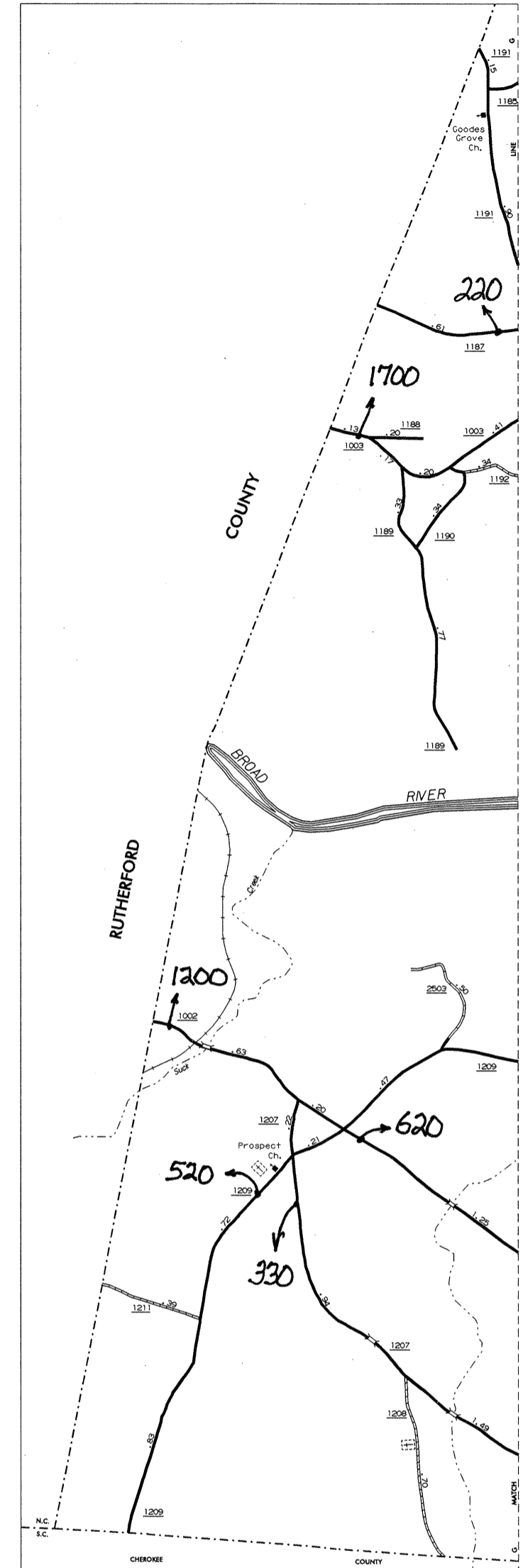
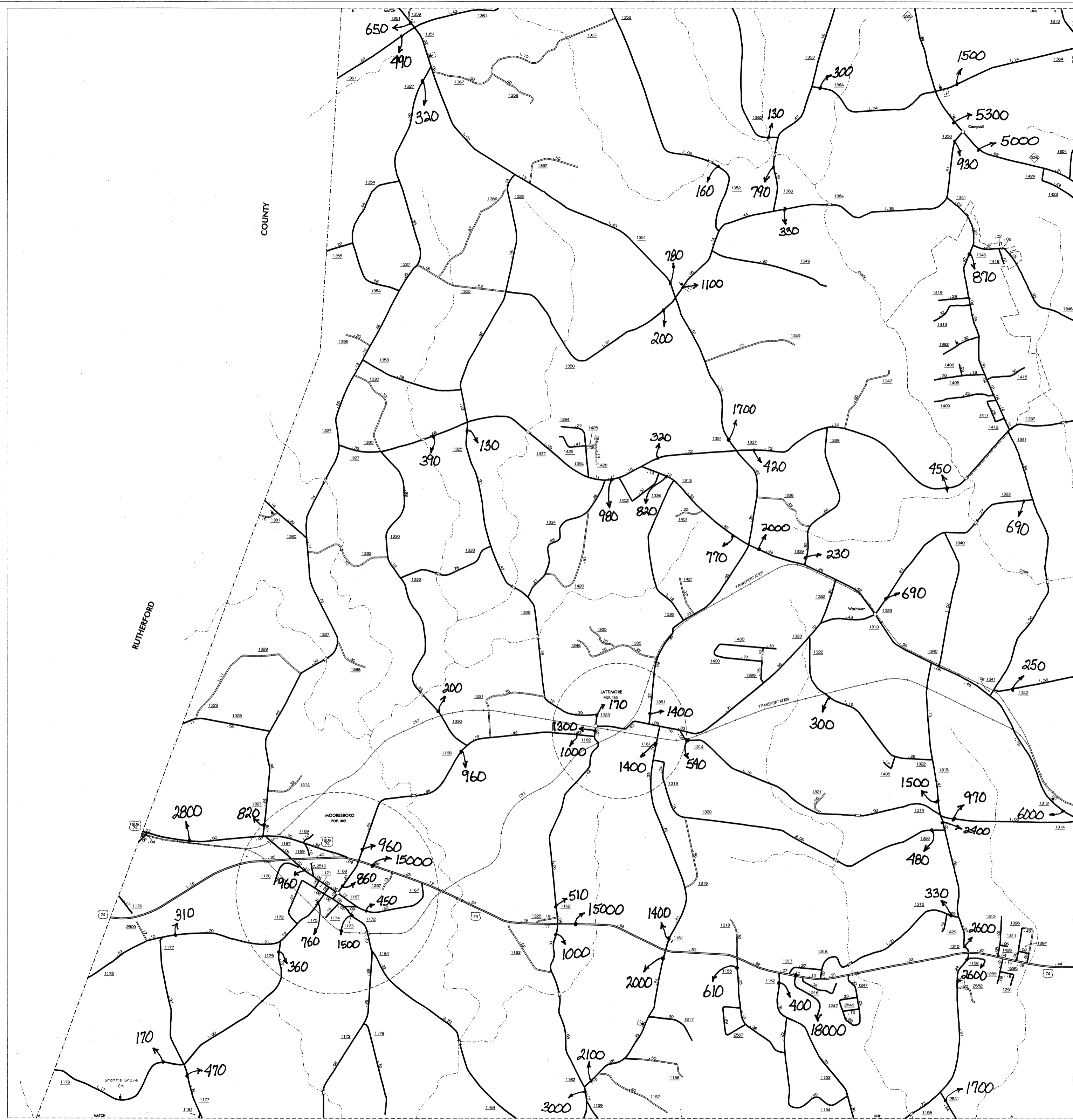

N.C. Department of Transportation
 Statewide Planning Branch
 Traffic Survey Unit
 1554 Mail Service Center
 Raleigh, NC 27699-1554

**1999
 ANNUAL AVERAGE
 DAILY TRAFFIC**

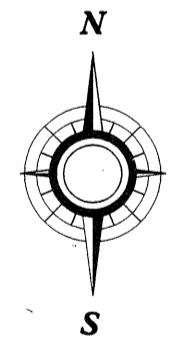

ENLARGED MUNICIPAL AND SUBURBAN AREAS

**CLEVELAND COUNTY
 NORTH CAROLINA**

PREPARED BY THE
 NORTH CAROLINA DEPARTMENT OF TRANSPORTATION
 DIVISION OF HIGHWAYS - GIS UNIT

IN COOPERATION WITH THE
 U.S. DEPARTMENT OF TRANSPORTATION
 FEDERAL HIGHWAY ADMINISTRATION

