

PEACHLAND  
POP. 487

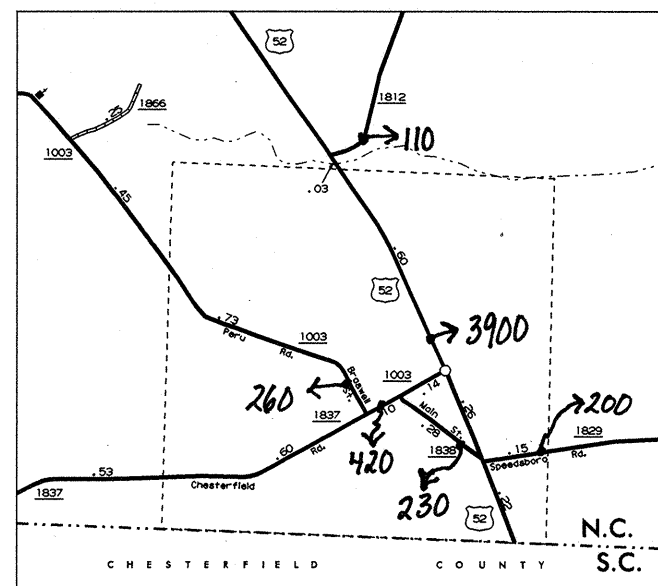

McFARLAN  
POP. 90

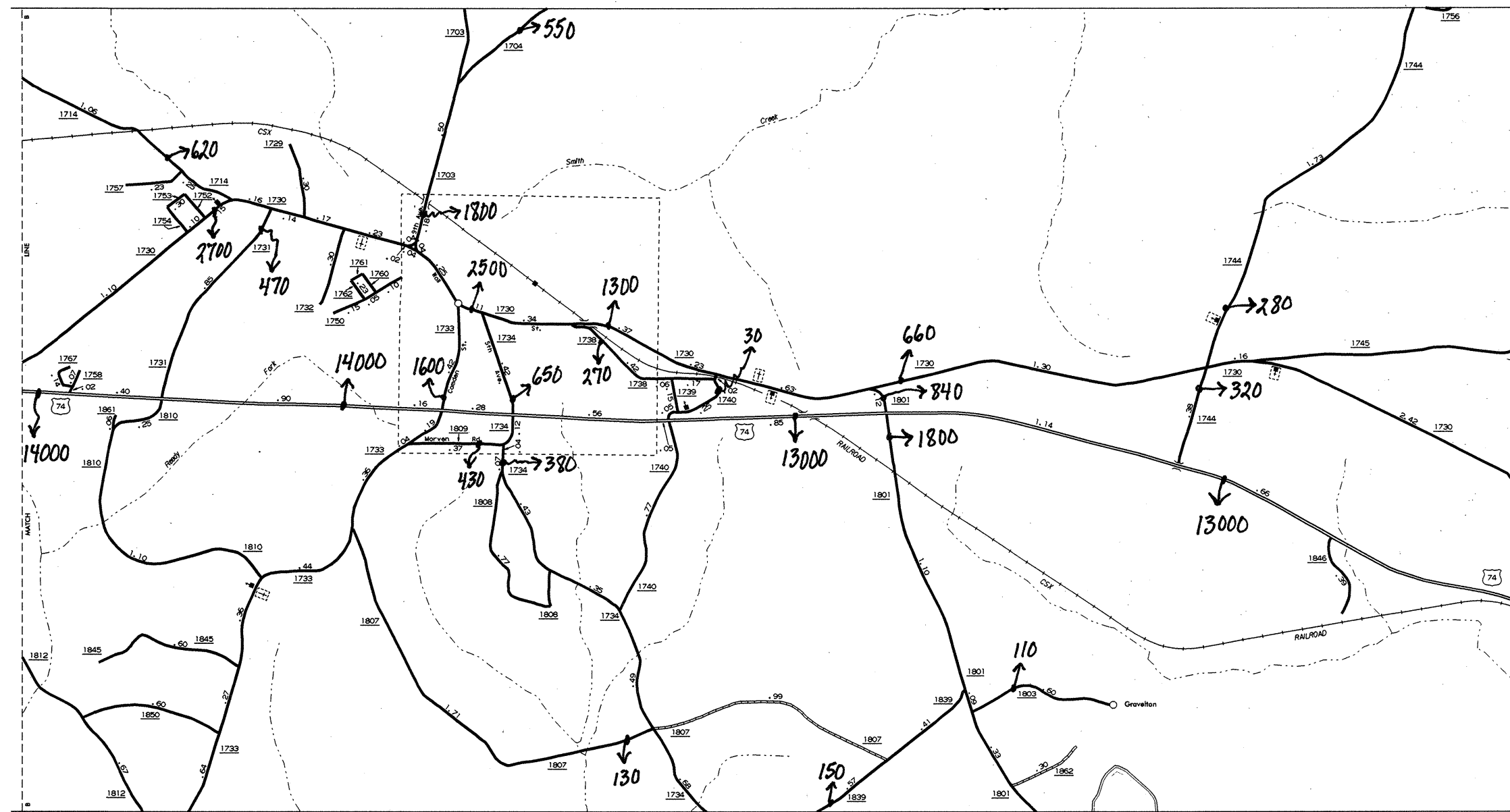

LILESVILLE  
POP. 436

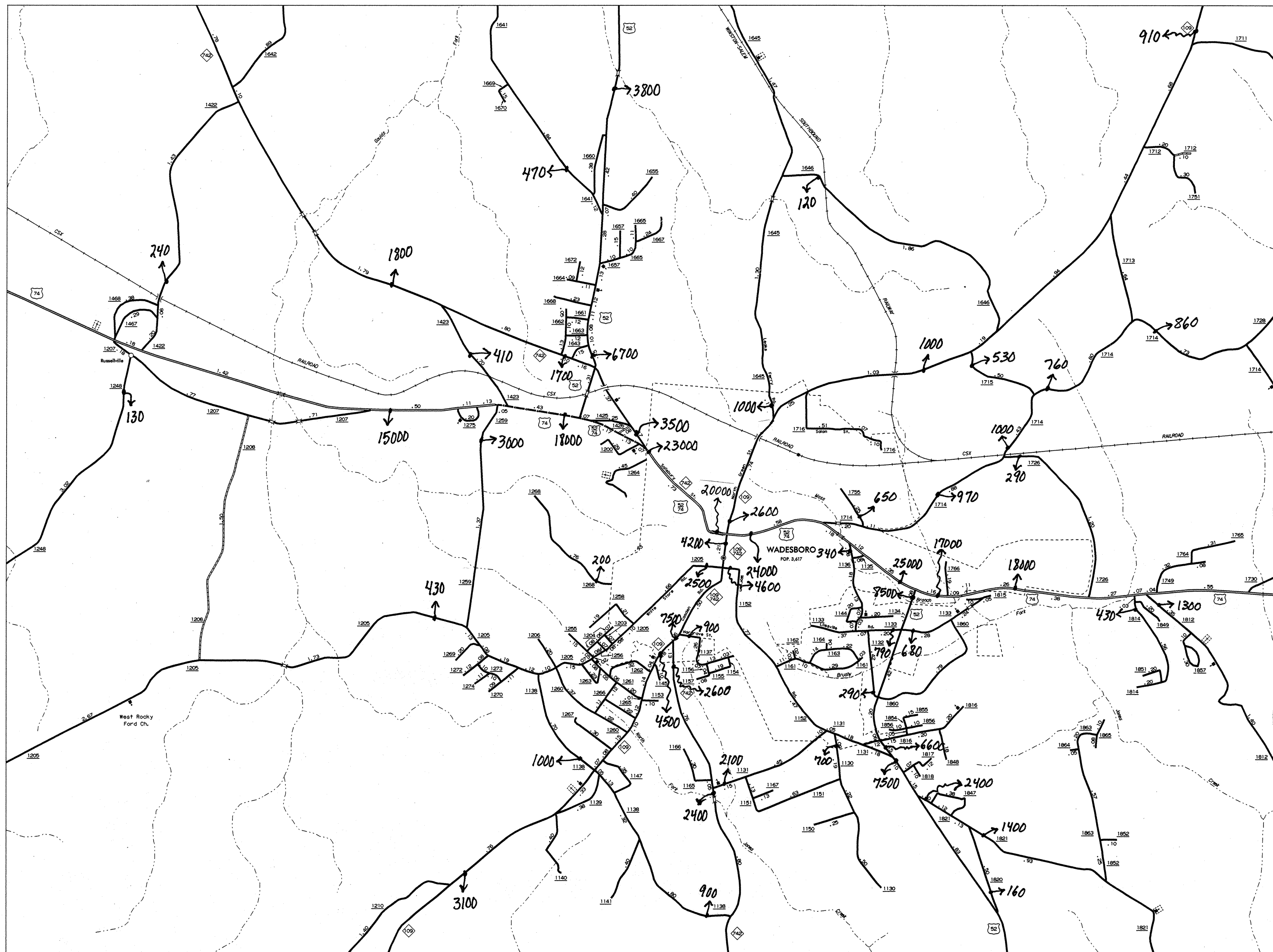

WADESBORO  
POP. 3,617

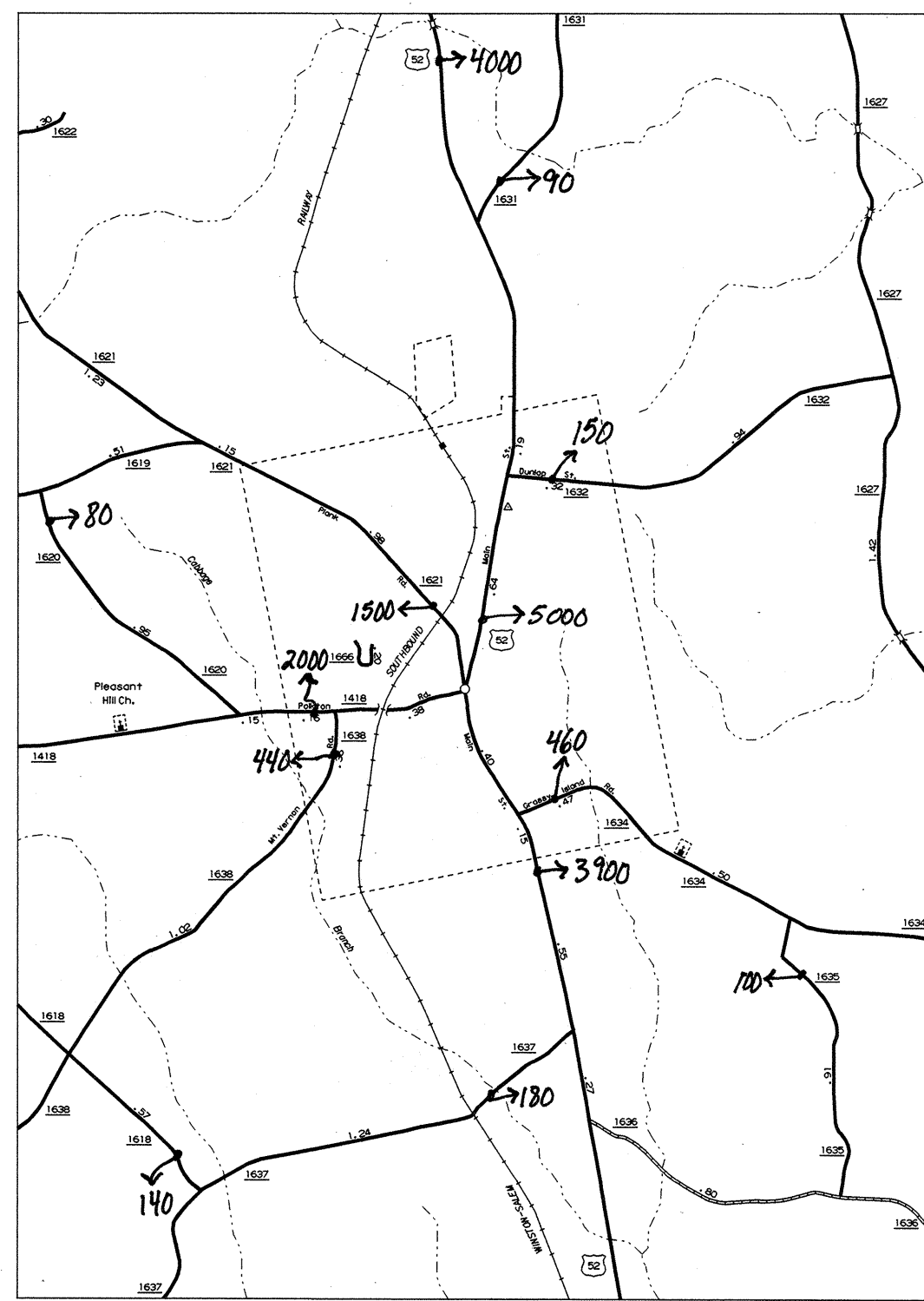

ANSONVILLE  
POP. 609

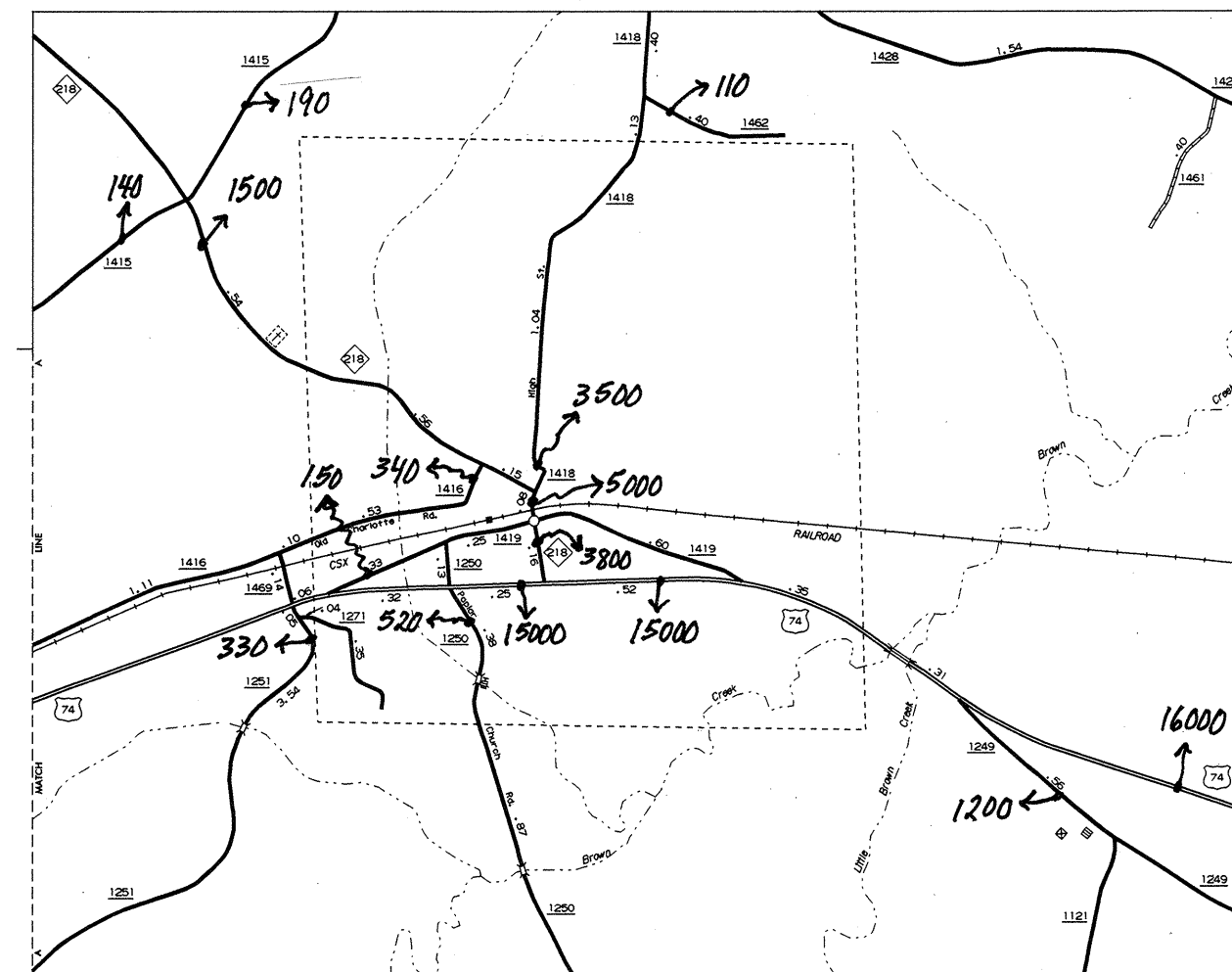

POLKTON  
POP. 649

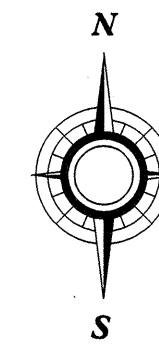

ENLARGED MUNICIPAL AND SUBURBAN AREAS

# ANSON COUNTY NORTH CAROLINA

PREPARED BY THE  
NORTH CAROLINA DEPARTMENT OF TRANSPORTATION  
DIVISION OF HIGHWAYS - GIS UNIT

IN COOPERATION WITH THE  
U.S. DEPARTMENT OF TRANSPORTATION  
FEDERAL HIGHWAY ADMINISTRATION

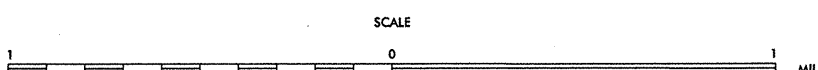

**1999  
ANNUAL AVERAGE  
DAILY TRAFFIC**

N.C. Department of Transportation  
Statewide Planning Branch  
Traffic Survey Unit  
1554 Mail Service Center  
Raleigh, NC 27699-1554

COPIES OF THIS MAP ARE AVAILABLE  
TO THE PUBLIC AT A NOMINAL COST.  
ADDRESS: MAPS, N.C. DEPARTMENT OF TRANSPORTATION  
DIVISION OF HIGHWAYS  
RALEIGH, NORTH CAROLINA 27611

REVISED
1991
5-4-98 AM
4-1-99 FOR
7-31-99 LAM