

N.C. Department of Transportation
 Statewide Planning Branch
 Traffic Survey Unit
 1554 Mail Service Center
 Raleigh, NC 27699-1554

**1999
 ANNUAL AVERAGE
 DAILY TRAFFIC**



ENLARGED MUNICIPAL AND SUBURBAN AREAS

ALEXANDER COUNTY

NORTH CAROLINA

PREPARED BY THE
 NORTH CAROLINA DEPARTMENT OF TRANSPORTATION
 DIVISION OF HIGHWAYS - GIS UNIT

IN COOPERATION WITH THE
 U.S. DEPARTMENT OF TRANSPORTATION
 FEDERAL HIGHWAY ADMINISTRATION

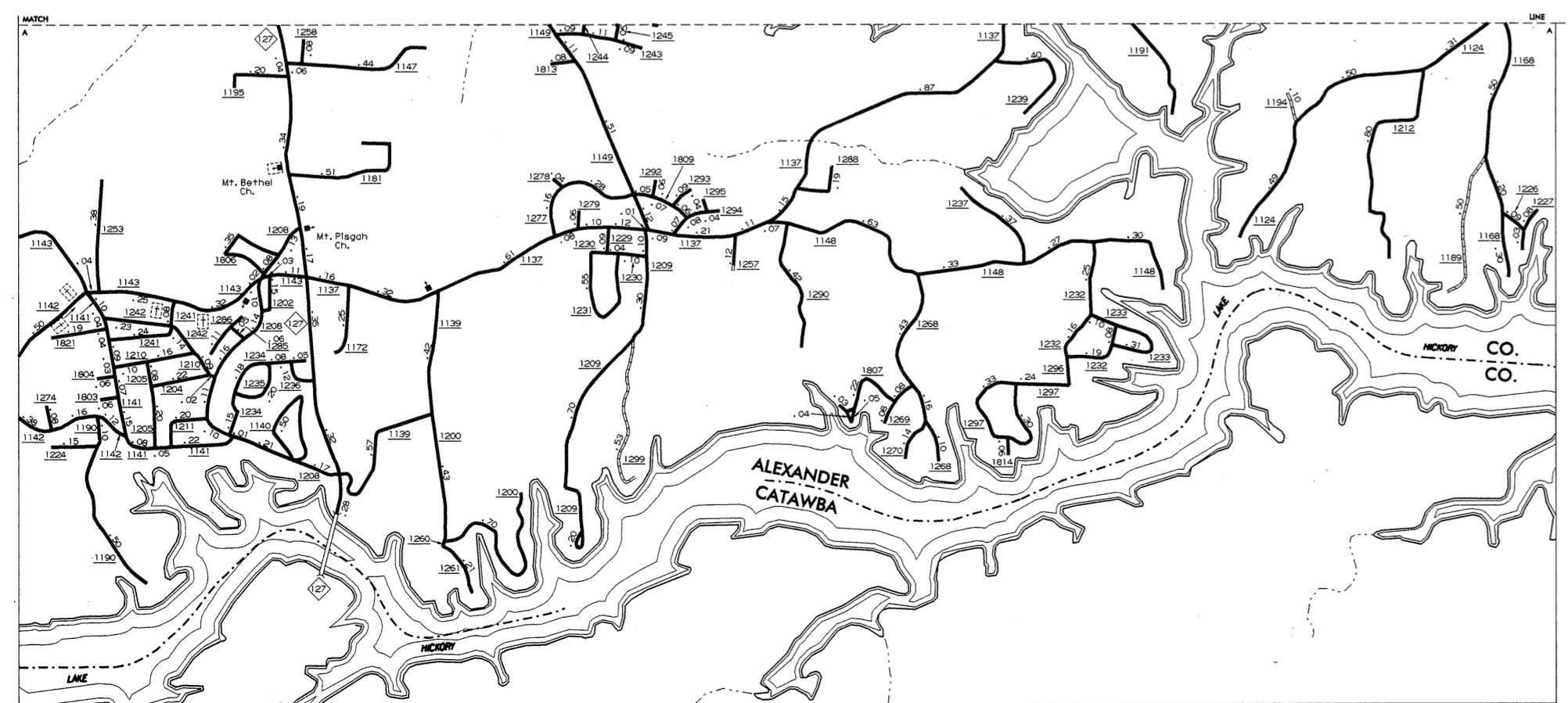
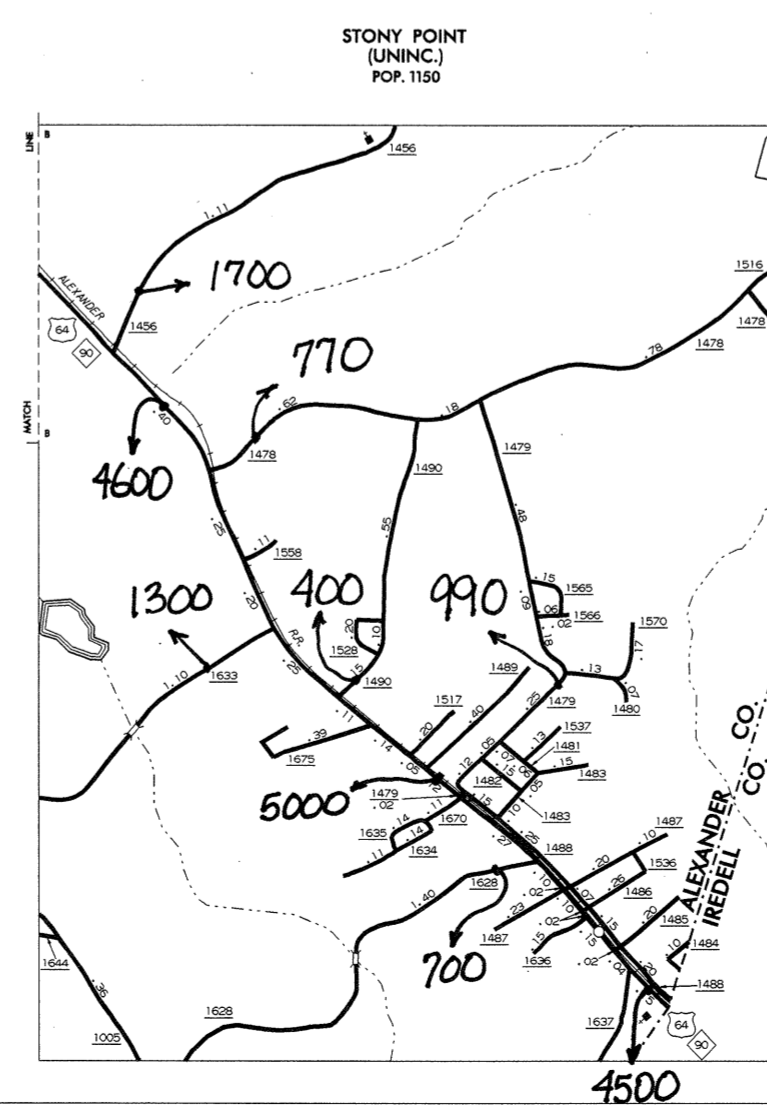
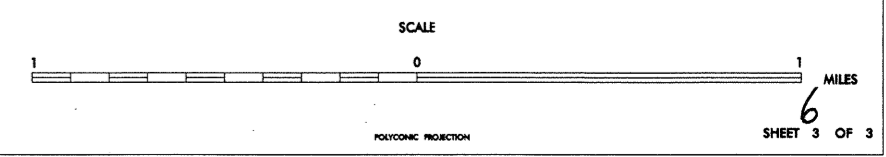

REVISIONS
 1-24-99 2488

COPIES OF THIS MAP ARE AVAILABLE
 TO THE PUBLIC AT A MINOR COST.
 ADDRESS: N.C. DEPARTMENT OF TRANSPORTATION
 DIVISION OF HIGHWAYS
 RALEIGH, NORTH CAROLINA 27611