

B

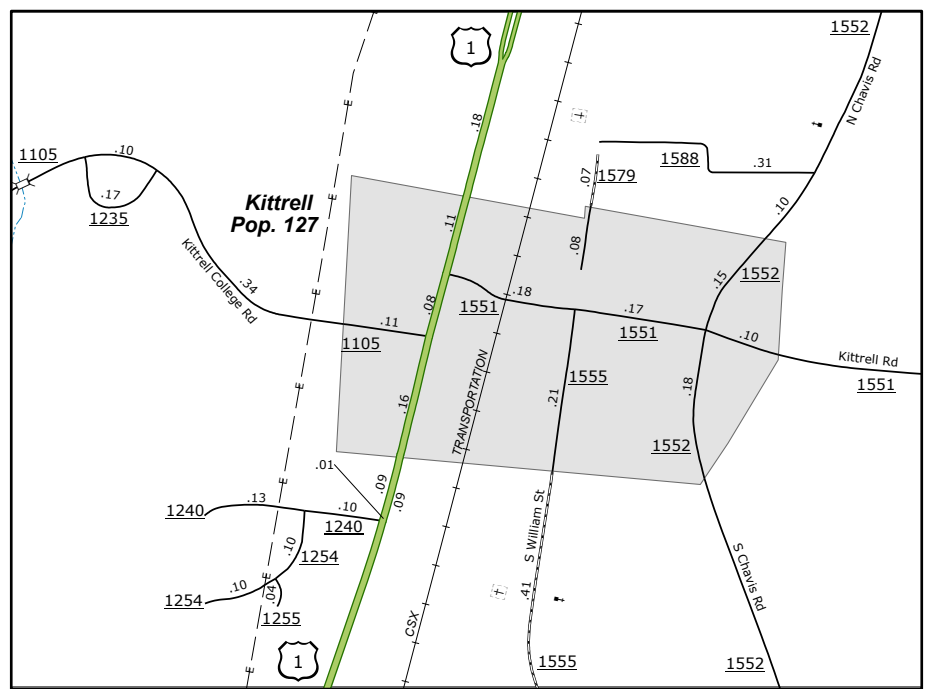

C



D

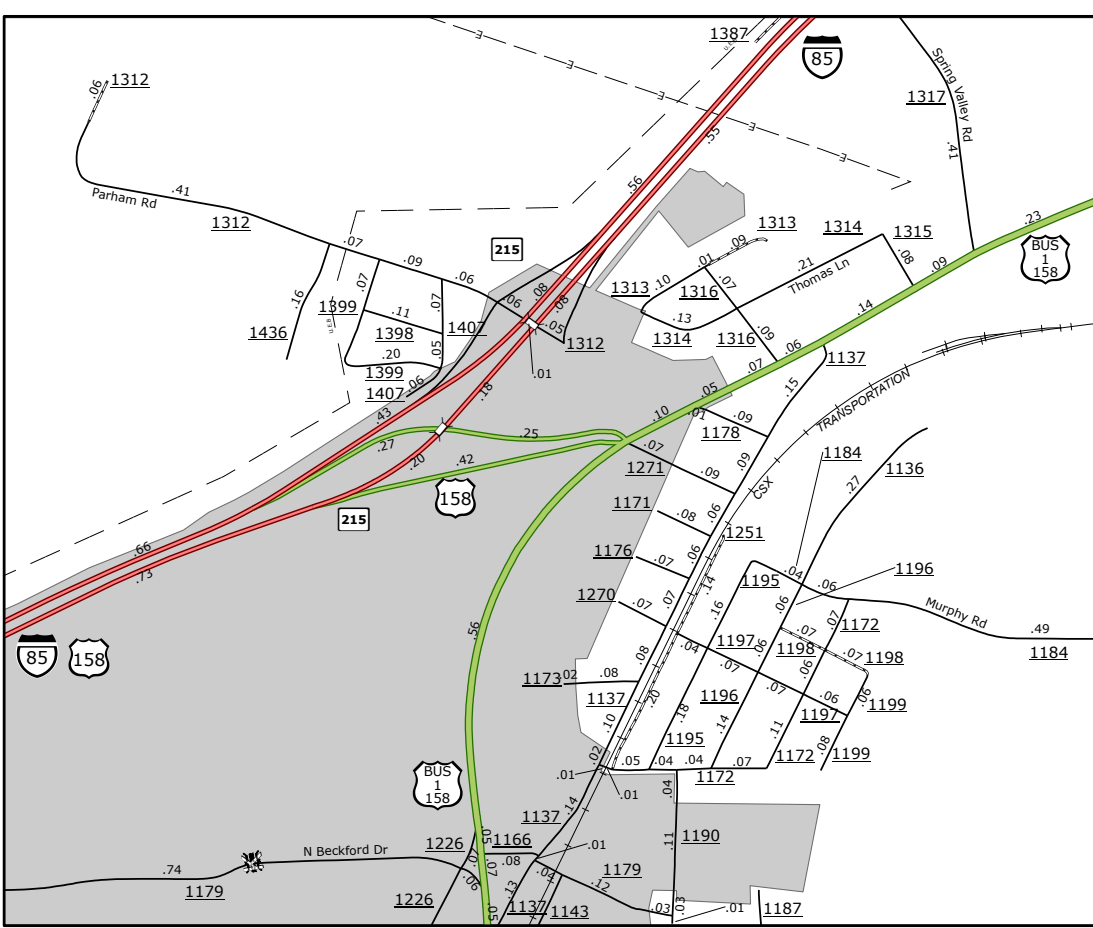

A

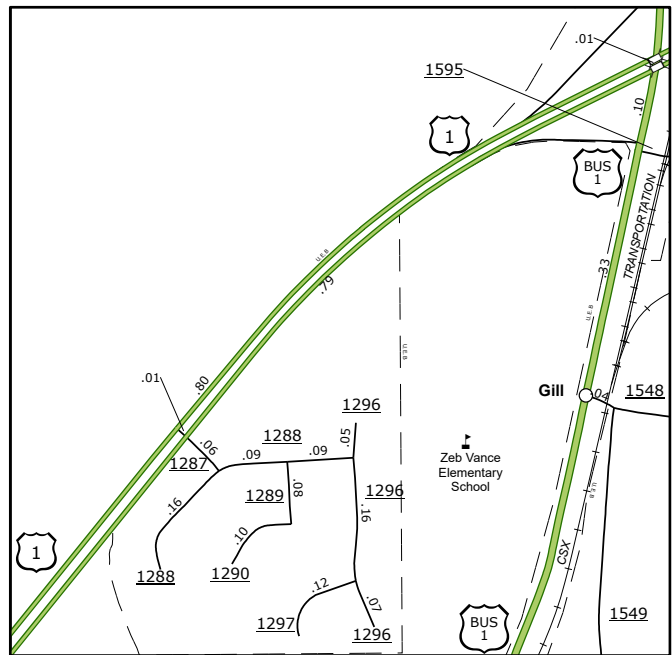

E

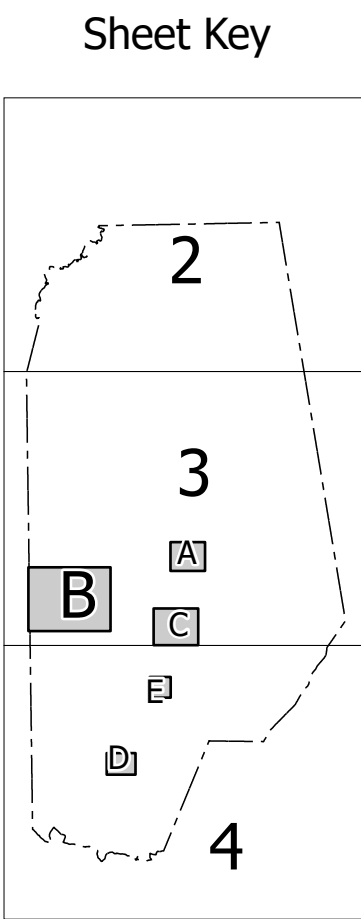

Sheet Key

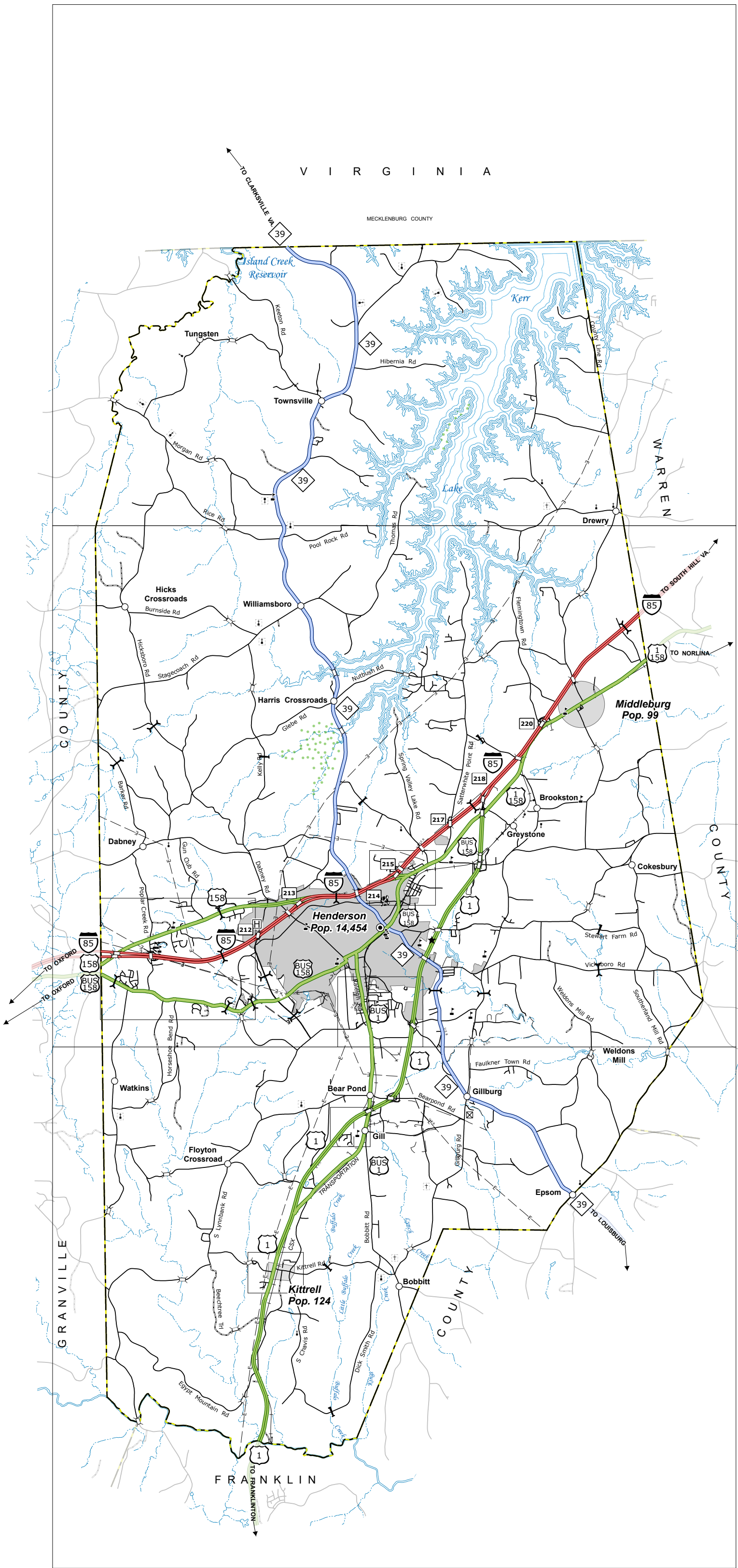

- LEGEND
- INTERSTATE US NC Divided Hwy Undivided Hwy
 - BLUE RIDGE PARKWAY
 - UNPAVED SURFACED ROAD
 - ROAD SURFACED ROAD
 - NON-SYSTEM ROAD
 - PROPOSEDLY DRAWN ROAD
 - PROJECTED LOCATION
 - INTERSECTION DISTANCE
 - STANDARD ROAD-BRIDGE
 - RAILROAD BRIDGE
 - DRAW SPAN ON BRIDGE
 - PEDESTRIAN BRIDGE
 - PEDESTRIAN WALKWAY
 - PEDESTRIAN UNDERPASS
 - VEHICLE UNDERPASS
 - TUNNEL
 - CULVERT
 - PIPE
 - INTERSTATE HIGHWAY
 - U.S. NUMBERED HIGHWAY
 - N.C. NUMBERED HIGHWAY
 - U.S. NUMBERED BYCICLE ROUTE
 - S.C. NUMBERED BYCICLE ROUTE
 - INTERSTATE INTERCHANGE NUMBER
 - SECONDARY ROAD NUMBER
 - UTILITY LINE
 - RAILROAD LINE
 - RAILROAD STATION
 - INSET AREA
 - STATE LINE
 - COUNTY LINE
 - SMOOTHED URBAN BOUNDARIES
 - CITY LIMITS
 - TRUCK ROUTE AND RAMP
 - NARROW CREEK OR STREAM
 - WIDE RIVER OR CREEK
 - RESERVOIR, POND OR LAKE W/ ISLAND
 - DAM OR DAM WITH LOCK
 - MATERIAL
 - SWAMP
 - COMMUNITY
 - COUNTY SEAT
 - SCHOOL
 - COLLEGE OR UNIVERSITY
 - HOSPITAL
 - COAST GUARD STATION
 - CHURCH
 - CHURCH WITH CEMETERY
 - CEMETERY
 - RAILROAD STATION
 - CORRECTION OR PENAL INSTITUTION
 - QUARRY
 - MINE OR PIT
 - HIGHWAY GARAGE OR MAINT. YARD
 - HIGHWAY DIV. OR DIST. OFFICE
 - MILITARY POST
 - WEIGH STATION
 - HISTORICAL SITE
 - POINTS OF INTEREST
 - POST OFFICE
 - STATE FOREST
 - LIGHTHOUSE
 - MOUNTAIN SUMMIT
 - OVERLOOK
 - MOUNTAIN GAP
 - VIEWER OR REST AREA
 - REST AREA
 - WELCOME CTR. REST AREA
 - AIRPORT
 - MILITARY AIRPORT
 - NATIONAL / STATE FOREST BOUNDARY
 - WILDLIFE REFUGE
 - NATIONAL / STATE PARK BOUNDARY
 - GAME LANDS BOUNDARY
 - MILITARY RESERVATION BOUNDARY
 - INDIAN RESERVATION BOUNDARY

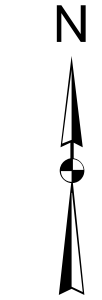

VANCE COUNTY NORTH CAROLINA

PREPARED BY THE
NORTH CAROLINA DEPARTMENT OF TRANSPORTATION
OPERATIONS PROGRAM MANAGEMENT UNIT - MAPPING SECTION
IN COOPERATION WITH THE
U.S. DEPARTMENT OF TRANSPORTATION
FEDERAL HIGHWAY ADMINISTRATION

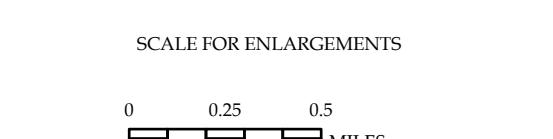
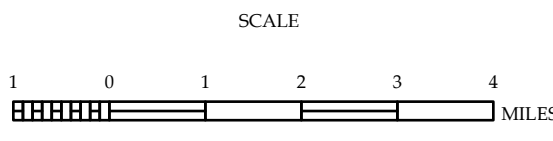

NORTH CAROLINA PLANE COORDINATE SYSTEM
LAMBERT CONFORMAL CONIC PROJECTION

COPIES OF THIS MAP ARE AVAILABLE TO THE
PUBLIC AT NOMINAL COST. CONTACT US TO ORDER:
mapsupport@ncdot.gov
http://connect.ncdot.gov/resources/State-Mapping/Pages/Ordering-Maps.aspx
(813) 634-6400

TERMS OF USE: The Mapping Section's goal is to provide the most accurate and current information possible. Map data is compiled from numerous sources with varying dates of publication and map accuracy standards. As a result, the accuracy, currency, and completeness of the data provided will vary. The North Carolina Department of Transportation shall not be held liable for any errors in the map data. This map cannot be construed to be a legal document. The information shown on this map was last updated in May 2025. For digital copies of this map or additional map products, visit <http://connect.ncdot.gov/resources/State-Mapping>

TERMS OF USE: The Mapping Section's goal is to provide the most accurate and current information possible. Map data is compiled from numerous sources with varying levels of precision and map accuracy standards. As a result, the accuracy, currency, and completeness of the information shown on this map cannot be guaranteed. The information shown on this map was last updated in July 2025. For digital copies of this map or additional map products, visit <https://www.ncdot.gov/transportation/transportation-planning-and-development/transportation-planning-and-development.aspx>

COPYRIGHT: THIS MAP IS AVAILABLE TO THE PUBLIC AT NO CHARGE. CONTACT US TO ORDER: maps@ncdot.gov (919) 845-4400

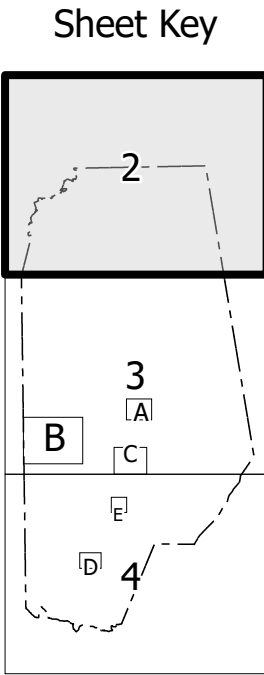
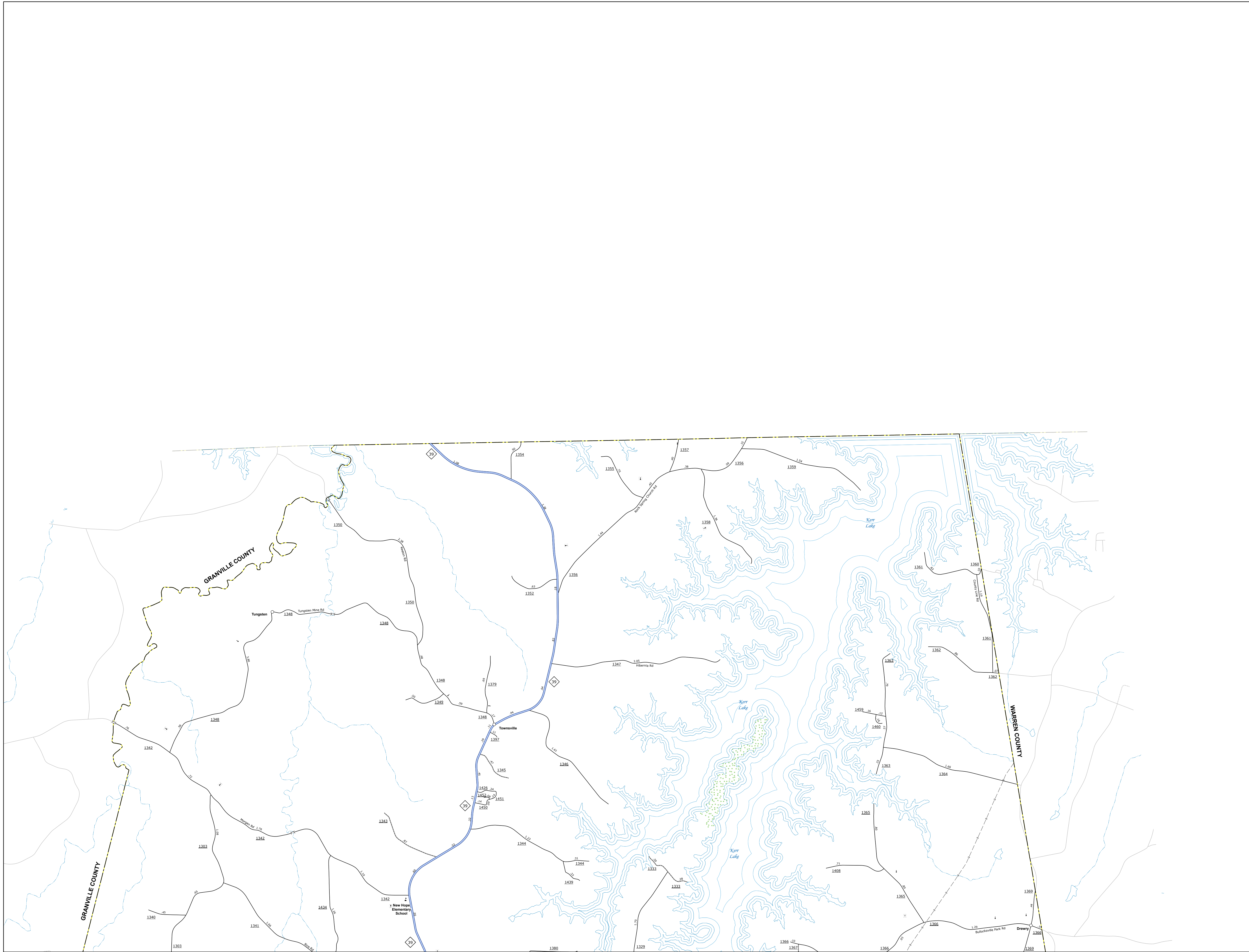

- LEGEND
- INTERSTATE US NC
 - Divided Hwy
 - Undivided Hwy
 - BLU-RIDGE PARKWAY
 - UNPAVED SURFACED ROAD
 - HARD SURFACED ROAD
 - NON-SYSTEM ROAD
 - PROVISIONALLY DRAWN ROAD
 - PROJECTED LAY-OUT
 - INTERSECTION DISTANCE
 - STANDARD ROAD BRIDGE
 - RAILROAD BRIDGE
 - DRAW SPAN ON BRIDGE
 - PEDESTRIAN BRIDGE
 - PEDESTRIAN WALKWAY
 - PEDESTRIAN UNDERPASS
 - VEHICULAR UNDERPASS
 - TUNNEL
 - CULVERT
 - PYE
 - INTERSTATE HIGHWAY
 - U.S. NUMBERED HIGHWAY
 - N.C. NUMBERED HIGHWAY
 - U.S. NUMBERED BI-CYCLE ROUTE
 - N.C. NUMBERED BI-CYCLE ROUTE
 - INTERSTATE INTERCHANGE NUMBER
 - SECONDARY ROAD NUMBER
 - UTILITY LINES
 - RAILROAD LINE
 - RAILROAD STATION
 - INSET AREA
 - STATE LINE
 - COUNTY LINE
 - SMOOTHED URBAN BOUNDARIES
 - CITY LIMITS
 - FERRY ROUTE AND RAMP
 - NARROW CREEK OR STREAM
 - WIDE-RIVER OR CREEK
 - RESERVOIR, POND OR LAKE W/ ISLAND
 - DAM OR DAM WITH LOCK
 - WATERFALL
 - SWAMP
 - COMMUNITY
 - COUNTY SEAT
 - SCHOOL
 - COLLEGE OR UNIVERSITY
 - HOSPITAL
 - COAST GUARD STATION
 - CHURCH
 - CHURCH WITH CEMETERY
 - CEMETERY
 - PATROL STATION
 - CORRECTION OR PENAL INSTITUTION
 - QUARRY
 - MINE OR PIT
 - HOUSING GARAGE OR MAINT. YARD
 - HIGHWAY DIV. OR DIST. OFFICE
 - MILITARY POST
 - WIGWAG STATION
 - FARGROUNDS
 - HISTORICAL SITE
 - POINTS OF INTEREST
 - POST OFFICE
 - STATE FOREST
 - LIGHTHOUSE
 - MOUNTAIN SUMMIT
 - MOUNTAIN GAP
 - OVERLOOK
 - REST AREA
 - VISITOR CTR REST AREA
 - WELCOME CTR REST AREA
 - AIRPORT
 - MILITARY AIRPORT
 - NATIONAL / STATE FOREST BOUNDARY
 - WILDLIFE REFUGE
 - NATIONAL / STATE PARK BOUNDARY
 - GAME LANDS BOUNDARY
 - MILITARY RESERVATION BOUNDARY
 - INDIAN RESERVATION BOUNDARY

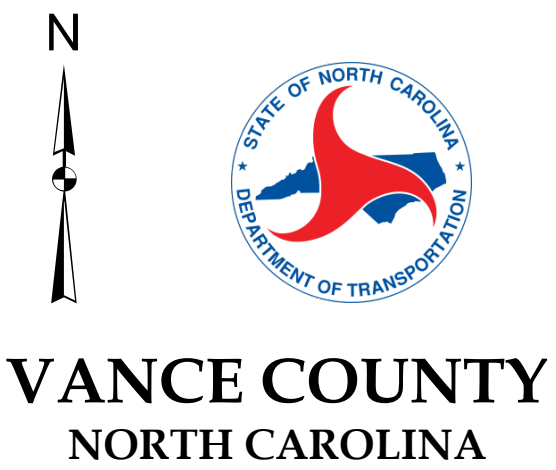

PREPARED BY THE
NORTH CAROLINA DEPARTMENT OF TRANSPORTATION
OPERATIONS PROGRAM MANAGEMENT UNIT - MAPPING SECTION
IN COOPERATION WITH THE
U.S. DEPARTMENT OF TRANSPORTATION
FEDERAL HIGHWAY ADMINISTRATION

SCALE

1 0 1 MILES

NORTH CAROLINA PLANE COORDINATE SYSTEM
LAMBERT CONFORMAL CONIC PROJECTION

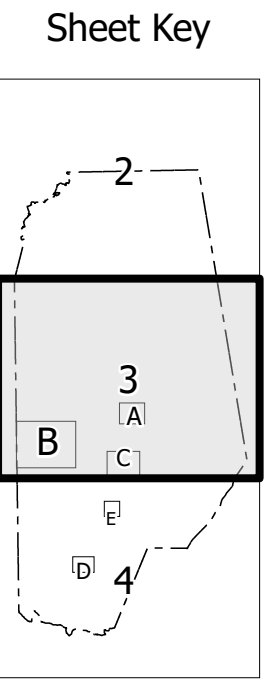
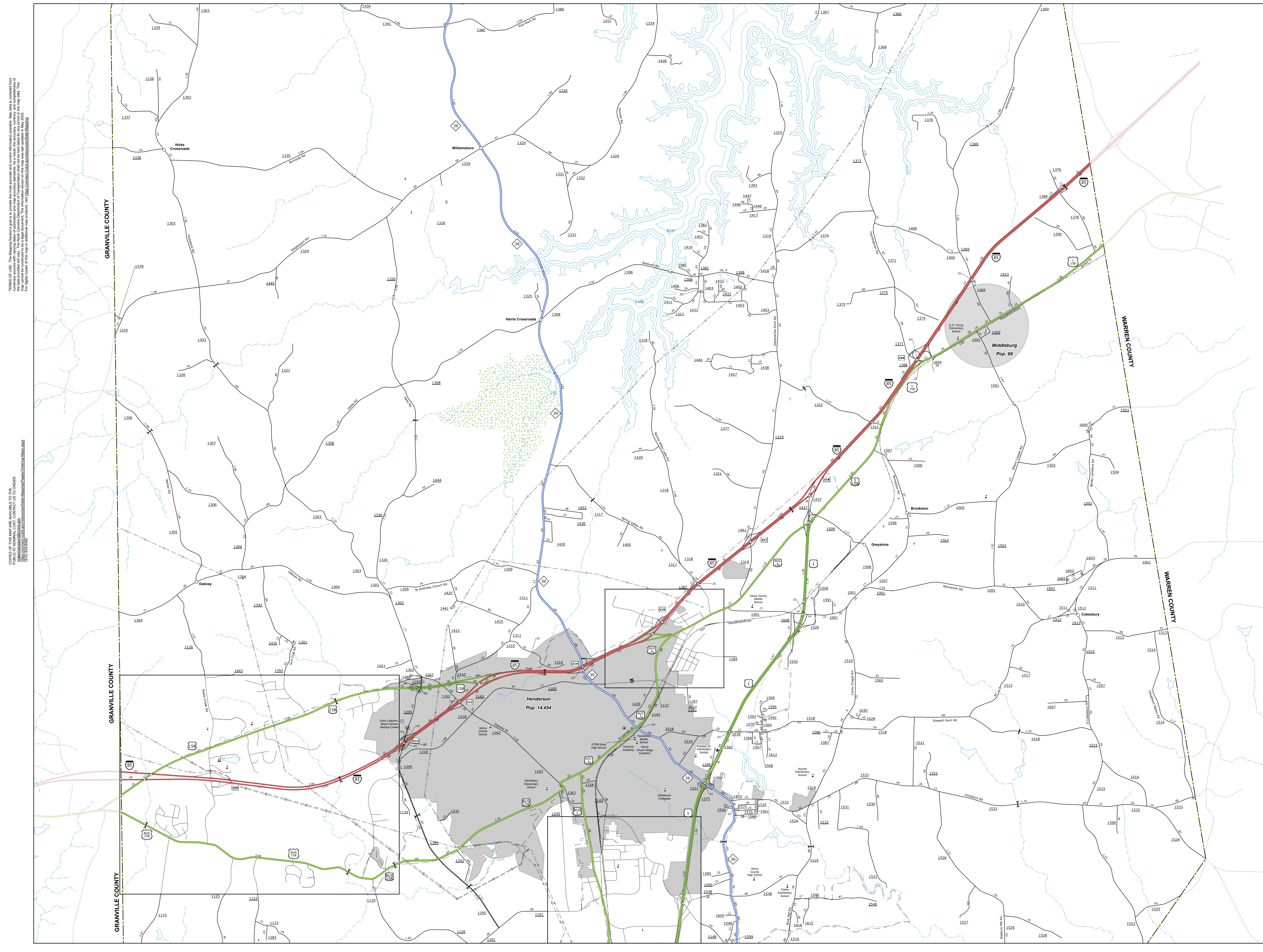

TERMS OF USE: The Mapping Division's intent is to provide the most accurate and up-to-date information possible. Map data is compiled from numerous sources with varying levels of precision and accuracy. As a result, the accuracy, currency, and completeness of the information shown on this map cannot be guaranteed. The information shown on this map was last updated in May 2025. For a full copy of the map or additional map products, visit <https://www.ncdot.gov/transportation/transportation-planning-and-policy/mapping-and-geographic-information-services>.

COPYRIGHT: THIS MAP IS AVAILABLE TO THE PUBLIC AT NO CHARGE. CONTACT US TO ORDER: maps@ncdot.gov or [919-874-4400](tel:919-874-4400). <https://www.ncdot.gov/transportation/transportation-planning-and-policy/mapping-and-geographic-information-services>

- LEGEND**
- INTERSTATE: US, NC, Divided Hwy, Undivided Hwy
 - BLVD: BRIDGE, PARKWAY
 - UNPAVED SURFACED ROAD
 - HARD SURFACED ROAD
 - NOV-SYSTEM ROAD
 - PROVISIONALLY DRAWN ROAD
 - PROJECTED LAY-OUT
 - INTERSECTION DETAIL
 - STANDARD ROAD BRIDGE
 - RAILROAD BRIDGE
 - DRAW SPAN ON BRIDGE
 - PEDESTRIAN BRIDGE
 - PEDESTRIAN WALKWAY
 - PEDESTRIAN UNDERPASS
 - VEHICULAR UNDERPASS
 - TUNNEL
 - CULVERT
 - PYE
 - INTERSTATE HIGHWAY
 - U.S. NUMBERED HIGHWAY
 - N.C. NUMBERED HIGHWAY
 - U.S. NUMBERED BICYCLE ROUTE
 - N.C. NUMBERED BICYCLE ROUTE
 - INTERSTATE INTERCHANGE NUMBER
 - SECONDARY ROAD NUMBER
 - UTILITY LINE
 - RAILROAD LINE
 - RAILROAD STATION
 - INSIT AREA
 - COUNTY LINE
 - STATE LINE
 - SMOOTHED URBAN BOUNDARIES
 - CITY LIMITS
 - FERRY ROUTE AND RAMP
 - NARROW CREEK OR STREAM
 - WIDE RIVER OR CREEK
 - RESERVOIR, POND OR LAKE W/ ISLAND
 - DAM OR DAM WITH LOCK
 - WATERFALL
 - SWAMP
 - CORPUS
 - COUNTY SEAT
 - SCHOOL
 - HOSPITAL
 - COLLEGE OR UNIVERSITY
 - COAST GUARD STATION
 - CHURCH
 - CHURCH WITH CEMETERY
 - CEMETERY
 - PATROL STATION
 - CORRECTION OR PENAL INSTITUTION
 - QUARRY
 - MINE OR PIT
 - BURNING GARBAGE OR MANT. YARD
 - HIGHWAY DIV. OR DIST. OFFICE
 - MILITARY POST
 - WATER STATION
 - FARGROUNDS
 - HISTORICAL SITE
 - POINTS OF INTEREST
 - POST OFFICE
 - STATE FOREST
 - LIGHTHOUSE
 - MOUNTAIN SUMMIT
 - MOUNTAIN GAP
 - OVERLOOK
 - REST AREA
 - VISITOR CTR/REST AREA
 - WELCOME CTR/REST AREA
 - AIRPORT
 - MILITARY AIRPORT
 - NATIONAL / STATE FOREST BOUNDARY
 - WILDLIFE REFUGE
 - NATIONAL / STATE PARK BOUNDARY
 - GAME LANDS BOUNDARY
 - MILITARY RESERVATION BOUNDARY
 - INDIAN RESERVATION BOUNDARY

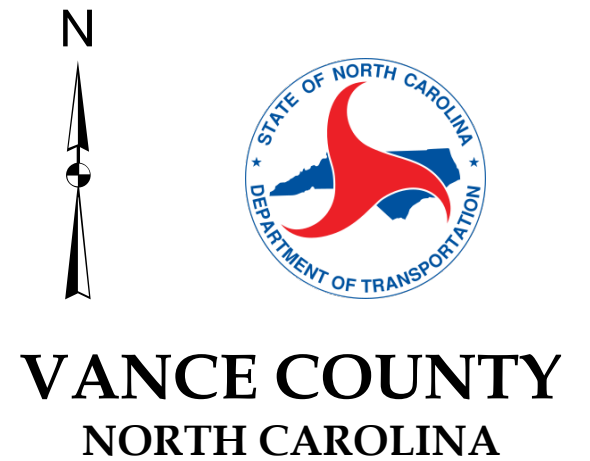

**VANCE COUNTY
NORTH CAROLINA**

PREPARED BY THE
NORTH CAROLINA DEPARTMENT OF TRANSPORTATION
OPERATIONS PROGRAM MANAGEMENT UNIT - MAPPING SECTION
IN COOPERATION WITH THE
U.S. DEPARTMENT OF TRANSPORTATION
FEDERAL HIGHWAY ADMINISTRATION

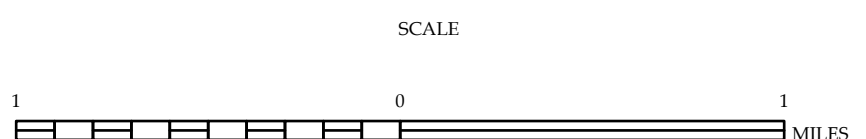

NORTH CAROLINA PLANE COORDINATE SYSTEM
LAMBERT CONFORMAL CONIC PROJECTION

TERMS OF USE: The Mapping Division's goal is to provide the most accurate and current information possible. Map data is compiled from numerous sources with varying dates of publication and map accuracy standards. As a result, the accuracy, currency and completeness of this map cannot be guaranteed. The information shown on this map was last updated in May 2025. For digital copies of this map or additional map products, visit <https://www.ncdot.gov/Information/Maps/Products/Pages/Products.aspx>

COPYIES OF THIS MAP ARE AVAILABLE TO THE PUBLIC AT NO CHARGE. CONTACT US TO ORDER:
1-800-368-3343
1-800-368-3343
1-800-368-3343
1-800-368-3343

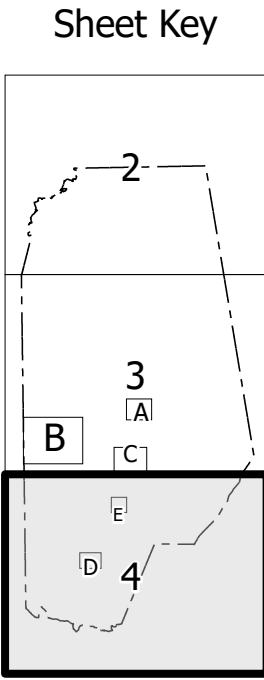
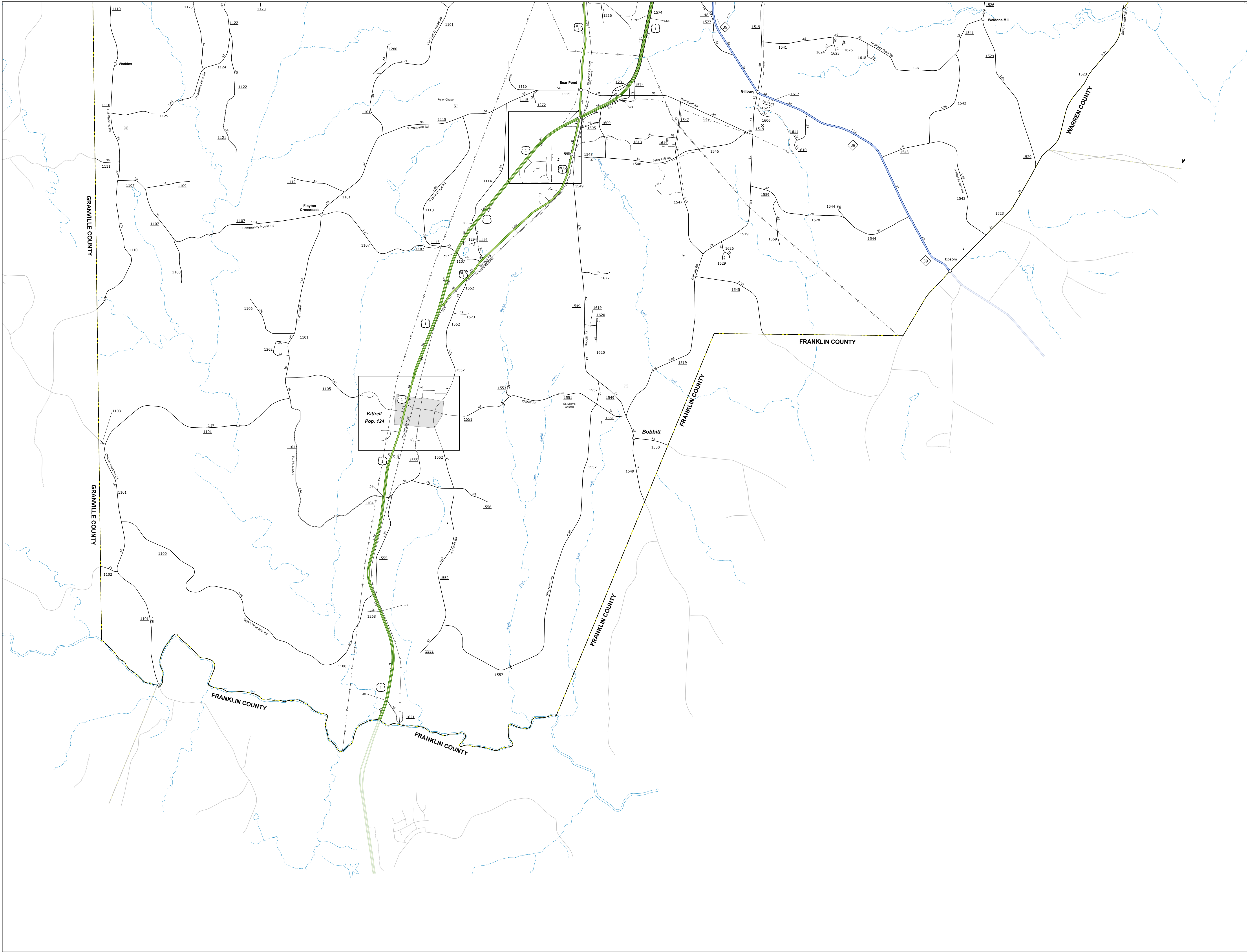

- LEGEND
- INTERSTATE US
 - US
 - Divided Hwy
 - Unimproved Hwy
 - Blue Ridge Parkway
 - Unimproved Hwy
 - Unimproved Suburban Road
 - Hard Surface Road
 - Non-System Road
 - Provisionally Drawn Road
 - Project Trail or Chain
 - Intersection Distance
 - Standard Road Bridge
 - Railroad Bridge
 - Draw Span on Bridge
 - Pedestrian Bridge
 - Pedestrian Walkway
 - Pedestrian Underpass
 - Vehicle Underpass
 - Tunnel
 - Culvert
 - Pipe
 - Interstate Highway
 - U.S. Numbered Highway
 - N.C. Numbered Highway
 - U.S. Numbered Bicycle Route
 - N.C. Numbered Bicycle Route
 - Interstate Interchange Number
 - Secondary Road Number
 - Utility Line
 - Railroad Line
 - Railroad Station
 - Inset Area
 - State Line
 - County Line
 - Smoothed Urban Boundaries
 - City Limits
 - Ferry Route and Ramp
 - Narrow Creek or Stream
 - Wide River or Creek
 - Reservoir, Pond or Lake w/ Island
 - Dam or Dam with Lock
 - Waterfall
 - Swamp
 - Community
 - County Seat
 - School
 - College or University
 - Hospital
 - Coast Guard Station
 - Church
 - Church with Cemetery
 - Cemetery
 - Patrol Station
 - Correction or Penal Institution
 - Quarry
 - Mine or Pit
 - Highway Garage or Maint. Yard
 - Highway Div. or Dist. Office
 - Military Post
 - Witch Station
 - Fairgrounds
 - Historical Site
 - Points of Interest
 - Post Office
 - State Forest
 - Lighthouse
 - Mountain Summit
 - Mountain Gap
 - Overlook
 - Rest Area
 - Visitor Ctr Rest Area
 - Welcome Ctr Rest Area
 - Airport
 - Military Airport
 - National / State Forest Boundary
 - Wildlife Refuge
 - National / State Park Boundary
 - Game Lands Boundary
 - Military Reservation Boundary
 - Indian Reservation Boundary

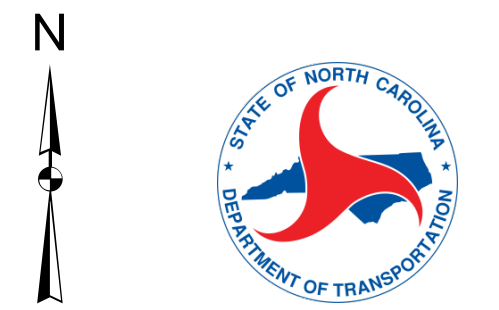

VANCE COUNTY NORTH CAROLINA

PREPARED BY THE
NORTH CAROLINA DEPARTMENT OF TRANSPORTATION
OPERATIONS PROGRAM MANAGEMENT UNIT - MAPPING SECTION
IN COOPERATION WITH THE
U.S. DEPARTMENT OF TRANSPORTATION
FEDERAL HIGHWAY ADMINISTRATION

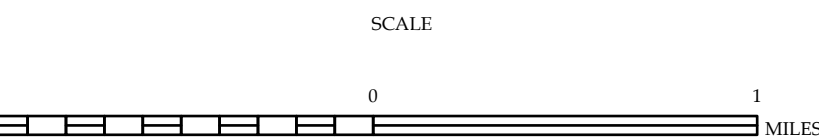

NORTH CAROLINA PLANE COORDINATE SYSTEM
LAMBERT CONFORMAL CONIC PROJECTION