

End of 40

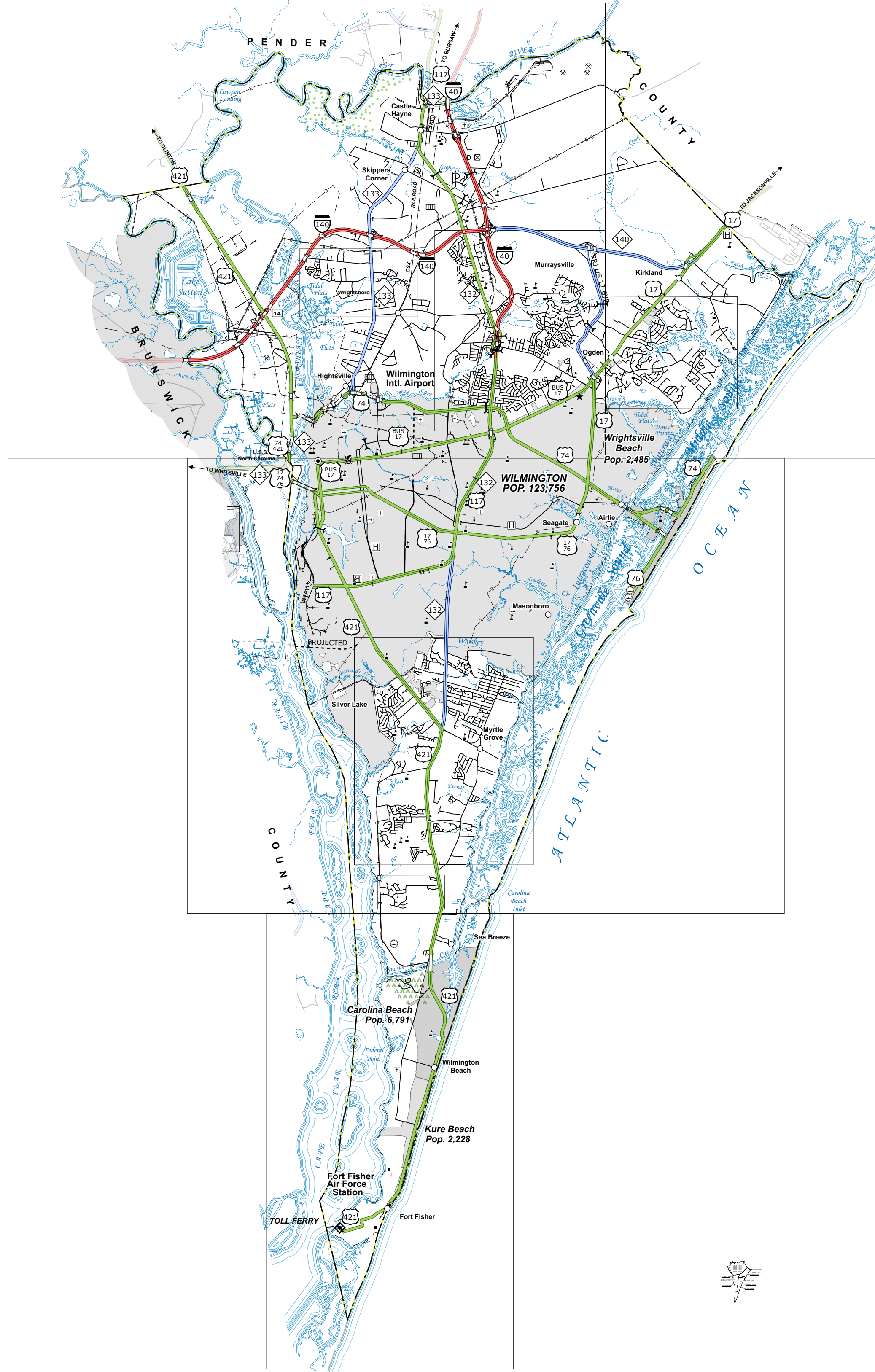

- LEGEND**
- INTERSTATE US NC
  - US NUMBERED HIGHWAY
  - NC NUMBERED HIGHWAY
  - US NUMBERED BIYCLE ROUTE
  - NC NUMBERED BIYCLE ROUTE
  - INTERSTATE INTERCHANGE NUMBER
  - SECONDARY ROAD NUMBER
  - UTILITY LINE
  - RAILROAD LINE
  - RAILROAD STATION
  - INSET AREA
  - STATE LINE
  - COUNTY LINE
  - SMOOTHED URBAN BOUNDARIES
  - CITY LIMITS
  - TRAIL ROUTE AND RAMP
  - NARROW CREEK OR STREAM
  - WIDE RIVER OR CREEK
  - RESERVOIR, POND OR LAKE W/ ISLAND
  - DAM OR DAM WITH LOCK
  - NATURAL
  - SWAMP
  - COMMUNITY
  - COUNTY SEAT
  - SCHOOL
  - COLLEGE OR UNIVERSITY
  - HOSPITAL
  - COAST GUARD STATION
  - CHURCH
  - CHURCH WITH CEMETERY
  - CEMETERY
  - POST OFFICE
  - CORRECTION OR PENAL INSTITUTION
  - QUARRY
  - MINE OR PIT
  - HIGHWAY DIV. OR DIST. OFFICE
  - MILITARY POST
  - WEIGH STATION
  - HISTORICAL SITE
  - POINTS OF INTEREST
  - POST OFFICE
  - STATE FOREST
  - LIGHTHOUSE
  - MOUNTAIN SUMMIT
  - OVERLOOK
  - BEST AREA
  - WILDERNESS REST AREA
  - WELCOME CTR. REST AREA
  - AIRPORT
  - MILITARY AIRPORT
  - NATIONAL STATE FOREST BOUNDARY
  - WILDLIFE REFUGE
  - NATIONAL STATE PARK BOUNDARY
  - GAME LANDS BOUNDARY
  - MILITARY RESERVATION BOUNDARY
  - INDIAN RESERVATION BOUNDARY



## NEW HANOVER COUNTY NORTH CAROLINA

PREPARED BY THE  
NORTH CAROLINA DEPARTMENT OF TRANSPORTATION  
OPERATIONS PROGRAM MANAGEMENT UNIT - MAPPING SECTION  
IN COOPERATION WITH THE  
U.S. DEPARTMENT OF TRANSPORTATION  
FEDERAL HIGHWAY ADMINISTRATION

SCALE

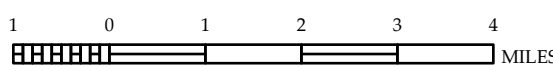

SCALE FOR ENLARGEMENTS

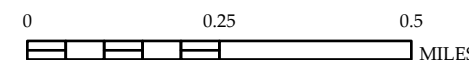

NORTH CAROLINA PLANE COORDINATE SYSTEM  
LAMBERT CONFORMAL CONIC PROJECTION

COPIES OF THIS MAP ARE AVAILABLE TO THE  
PUBLIC AT NOMINAL COST. CONTACT US TO ORDER:  
[maprequest@dot.state.nc.us](mailto:maprequest@dot.state.nc.us)  
<https://www.ncdot.gov/resources/State-Mapping/Pages/Ordering-Maps.aspx>  
(919) 854-4960

TERMS OF USE: The Mapping Section's goal is to provide the most accurate and current information possible. Map data is compiled from numerous sources with varying dates of publication and map accuracy standards. As a result, the accuracy, currency, and completeness of the data provided will vary. The North Carolina Department of Transportation shall not be held liable for any errors in the map data. This map cannot be construed to be a legal document. The information shown on this map was last updated in May 2025.  
For digital copies of this map or additional map products, visit <https://www.ncdot.gov/resources/State-Mapping>



COPIES OF THIS MAP ARE AVAILABLE TO THE  
PUBLIC AT NOMINAL COST. CONTACT US TO ORDER:  
mapinfo@portonology.gov  
<https://connect.ncdct.gov/resources/State-Mapping/Pages/Ordering-Maps.aspx>  
(919) 834-6480

SHEET 2 of 5



TERMS OF USE: The Mapmaker's goal is to provide the most accurate and current information possible. Map data is compiled from the North Carolina Department of Transportation, the U.S. Department of Transportation, and other sources. The data is provided as is, without warranty. The North Carolina Department of Transportation and the U.S. Department of Transportation are not responsible for any errors in the map data. This map is not to be used for navigation purposes. For a full and complete map product, visit [www.ncdot.gov](http://www.ncdot.gov) or call 1-800-368-3346.

COPIES OF THIS MAP ARE AVAILABLE TO THE PUBLIC. CONTACT US TO ORDER. [maps@ncdot.gov](mailto:maps@ncdot.gov) or call 1-800-368-3346.

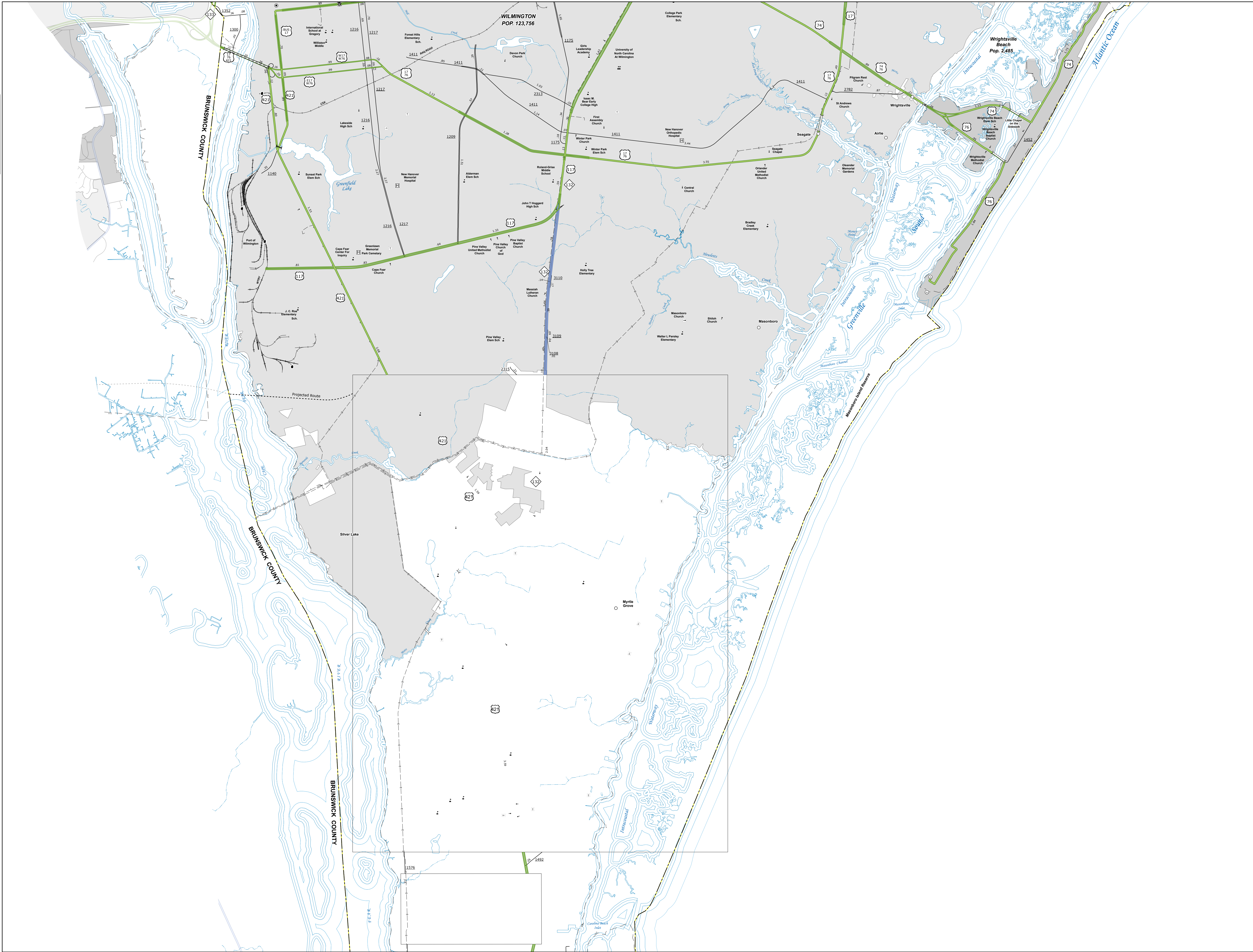

Sheet Key

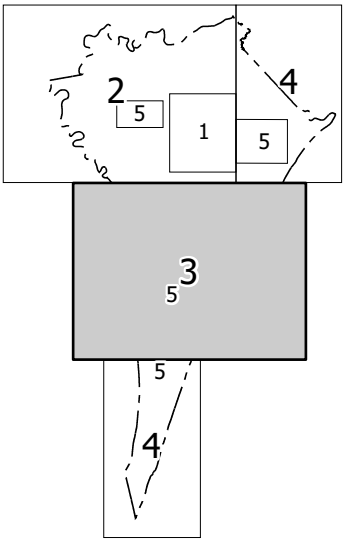

- LEGEND
- INTERSTATE: US (red), NC (blue), Divided Hwy (dashed blue), Undivided Hwy (solid blue)
  - BLUE RIDGE PARKWAY (dashed blue)
  - UNPAVED SURFACED ROAD (dashed green)
  - ROADS: GRAVEL ROAD (dashed green), NON-SURFACED ROAD (dashed green), PROPOSED LOCATION (dashed green), INTERSECTION DISTANCE (dashed green), STANDARD ROAD BRIDGE (dashed green), RAILROAD BRIDGE (dashed green), DRAW SPAN ON BRIDGE (dashed green), PEDESTRIAN BRIDGE (dashed green), PEDESTRIAN WALKWAY (dashed green), PEDESTRIAN UNDERPASS (dashed green), VERTICAL CLEARANCE (dashed green), TUNNEL (dashed green), CULVERT (dashed green), PIPE (dashed green)
  - INTERSTATE HIGHWAY (thick red line), U.S. NUMBERED HIGHWAY (thick blue line), N.C. NUMBERED HIGHWAY (thick blue line), U.S. NUMBERED BI-CYCLE ROUTE (thick blue line), N.C. NUMBERED BI-CYCLE ROUTE (thick blue line), INTERSTATE INTERCHANGE NUMBER (thick blue line), SECONDARY ROAD NUMBER (thick blue line)
  - UTILITY LINES (dashed green), RAILROAD LINE (dashed green), RAILROAD STATION (dashed green), INSET AREA (dashed green), STATE LINE (dashed green), COUNTY LINE (dashed green), SMOOTHED URBAN BOUNDARIES (dashed green), CITY LIMITS (dashed green), FERRY ROUTE AND RAMP (dashed green), NARROW CREEK OR STREAM (dashed green), WIDE RIVER OR CREEK (dashed green), RESERVOIR, POND OR LAKE W/ ISLAND (dashed green), DAM OR DAM WITH LOCK (dashed green), WATERFALL (dashed green), SWAMP (dashed green), COMMUNITY (dashed green), COUNTY SEAT (dashed green), SCHOOL (dashed green), COLLEGE OR UNIVERSITY (dashed green), HOSPITAL (dashed green), CASUALTY STATION (dashed green), CHURCH (dashed green), CHURCH WITH CEMETERY (dashed green), CEMETERY (dashed green), PATROL STATION (dashed green), CORRECTION OR PENAL INSTITUTION (dashed green), QUARRY (dashed green), MINE OR PIT (dashed green), HIGHWAY GARAGE OR MAINT. YARD (dashed green), HIGHWAY DIV. OR DIST. OFFICE (dashed green), MILITARY POST (dashed green), WEIGH STATION (dashed green), LAUNCHES (dashed green), HISTORICAL SITE (dashed green), POINTS OF INTEREST (dashed green), POST OFFICE (dashed green), STATE FOREST (dashed green), LIGHTHOUSE (dashed green), MOUNTAIN SUMMIT (dashed green), MOUNTAIN GAP (dashed green), OVERLOOK (dashed green), REST AREA (dashed green), VISITOR CTR. REST AREA (dashed green), WELCOME CTR. REST AREA (dashed green), AIRPORT (dashed green), MILITARY AIRPORT (dashed green)
  - NATIONAL - STATE FOREST BOUNDARY (dashed green), WILDLIFE REFUGE (dashed green), NATIONAL - STATE PARK BOUNDARY (dashed green), GAME LANDS BOUNDARY (dashed green), MILITARY RESERVATION BOUNDARY (dashed green), INDIAN RESERVATION BOUNDARY (dashed green)



## NEW HANOVER COUNTY NORTH CAROLINA

PREPARED BY THE  
NORTH CAROLINA DEPARTMENT OF TRANSPORTATION  
OPERATIONS PROGRAM MANAGEMENT UNIT - MAPPING SECTION  
IN COOPERATION WITH THE  
U.S. DEPARTMENT OF TRANSPORTATION  
FEDERAL HIGHWAY ADMINISTRATION

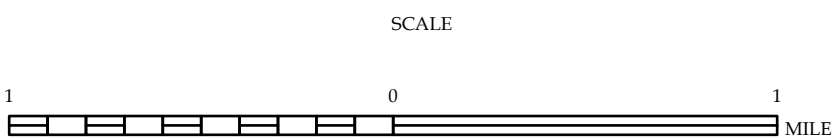

NORTH CAROLINA PLANE COORDINATE SYSTEM  
LAMBERT CONFORMAL CONIC PROJECTION



COPIES OF THIS MAP ARE AVAILABLE TO THE  
PUBLIC AT NOMINAL COST. CONTACT US TO ORDER:  
[mapinfo@support.mn.gov](mailto:mapinfo@support.mn.gov)  
<https://connect.mn.gov/resources/State-Mapping/Pages/Ordering-Maps.aspx>  
(612) 834-6480

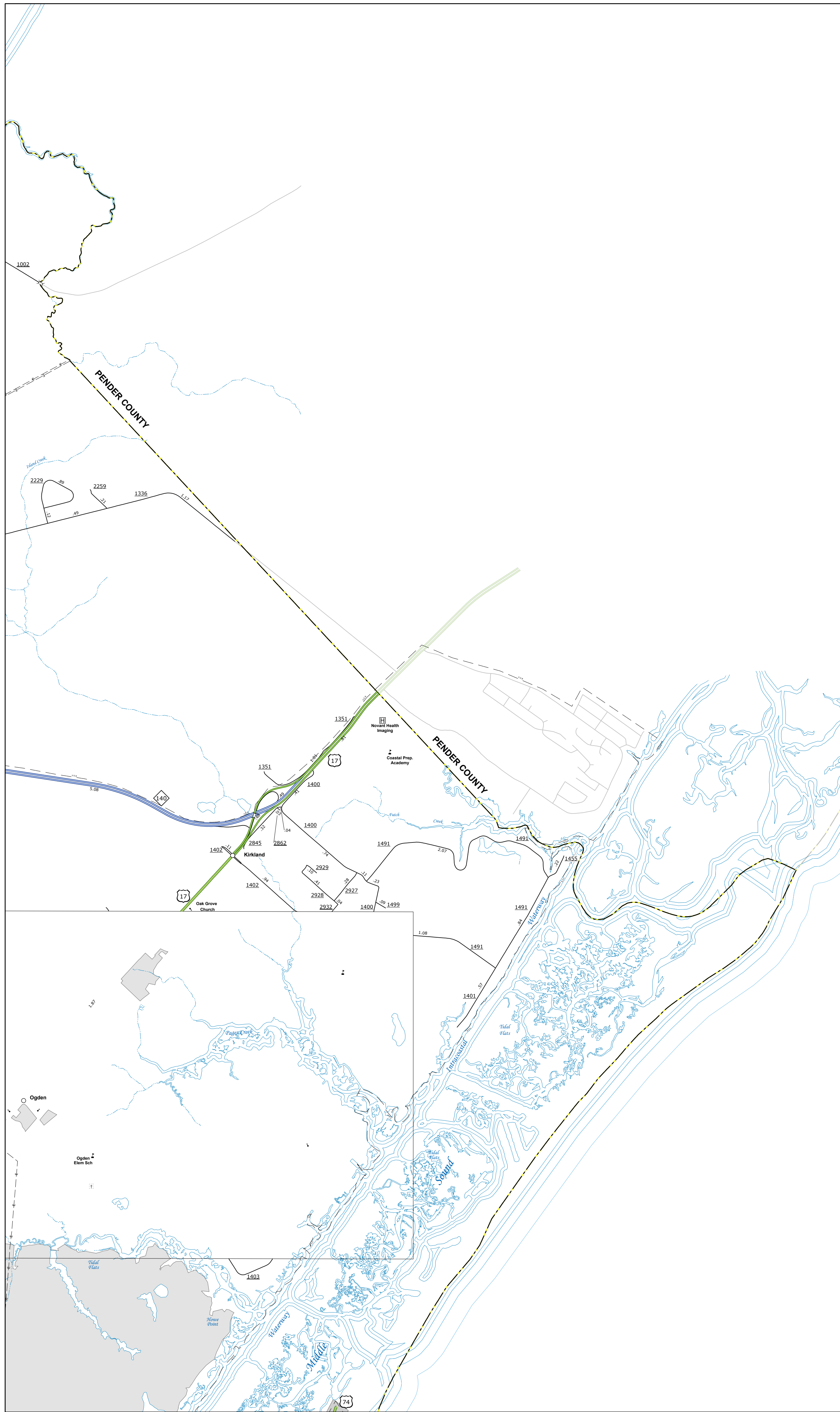



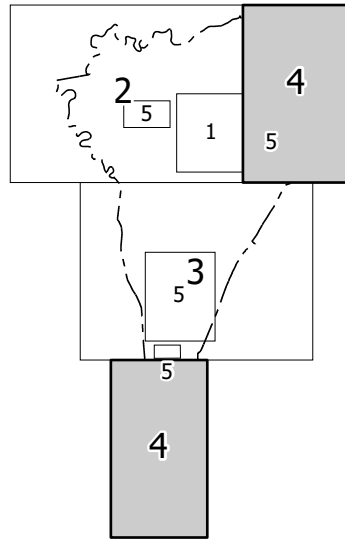



## Sheet Key



### LEGEND

- [illegible]

- |   |                                  |
|---|----------------------------------|
|  | NATIONAL / STATE FOREST BOUNDARY |
|  | WILDLIFE REFUGE                  |
|  | NATIONAL / STATE PARK BOUNDARY   |
|  | GAME LANDS BOUNDARY              |
|  | MILITARY RESERVATION BOUNDARY    |
|  | INDIAN RESERVATION BOUNDARY      |



**NEW HANOVER COUNTY**  
**NORTH CAROLINA**

PREPARED BY THE  
NORTH CAROLINA DEPARTMENT OF TRANSPORTATION  
OPERATIONS PROGRAM MANAGEMENT UNIT - MAPPING SECTION  
IN COOPERATION WITH THE  
U.S. DEPARTMENT OF TRANSPORTATION  
FEDERAL HIGHWAY ADMINISTRATION

SCALE

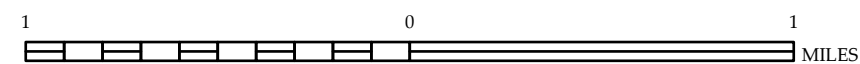

NORTH CAROLINA PLANE COORDINATE SYSTEM  
LAMBERT CONFORMAL CONIC PROJECTION



TERMS OF USE: The map is provided for informational purposes only. It is not intended to be used for legal or financial purposes. The map is provided as a service to the public and is not intended to be used for legal or financial purposes. The map is provided as a service to the public and is not intended to be used for legal or financial purposes.

COPIES OF THIS MAP ARE AVAILABLE TO THE PUBLIC AT A COST OF \$1.00 PER COPY. THE MAP IS PROVIDED AS A SERVICE TO THE PUBLIC AND IS NOT INTENDED TO BE USED FOR LEGAL OR FINANCIAL PURPOSES. THE MAP IS PROVIDED AS A SERVICE TO THE PUBLIC AND IS NOT INTENDED TO BE USED FOR LEGAL OR FINANCIAL PURPOSES.

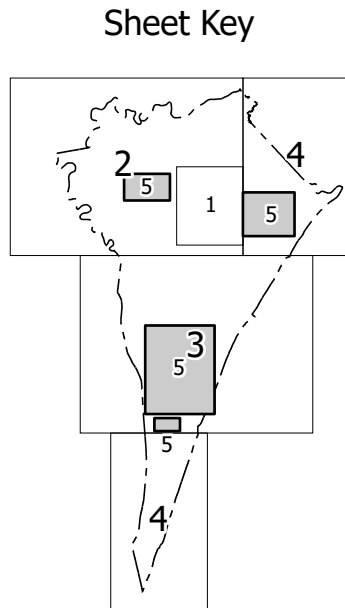
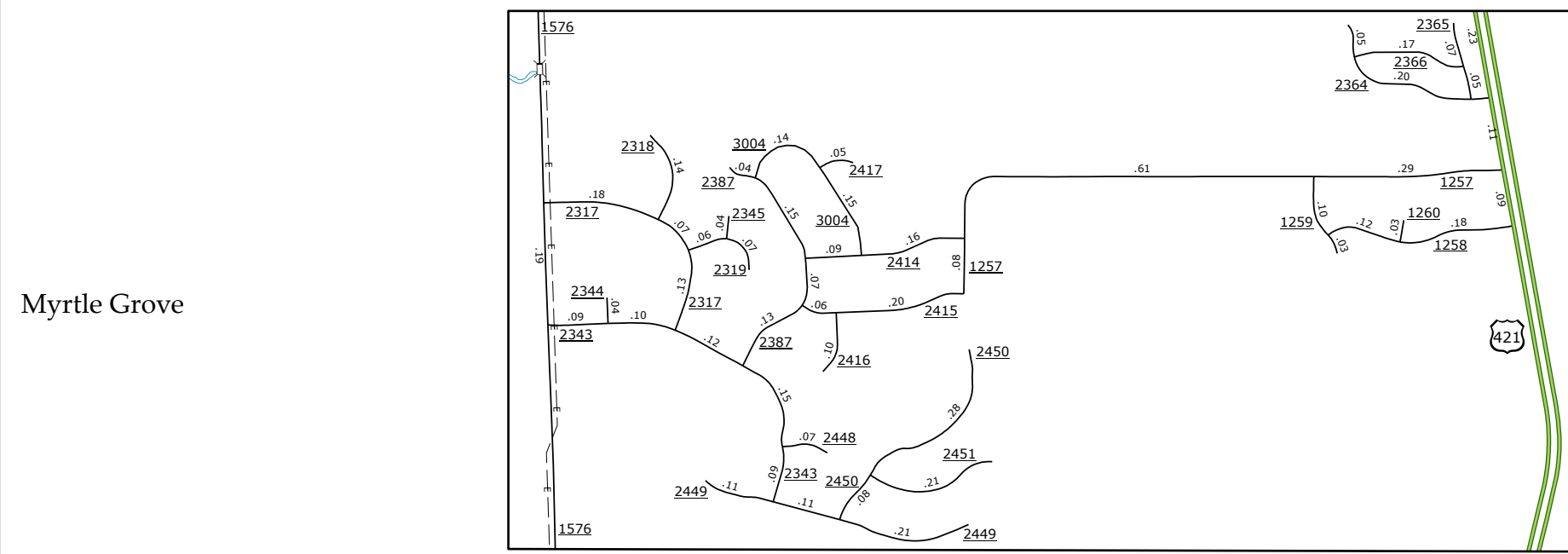
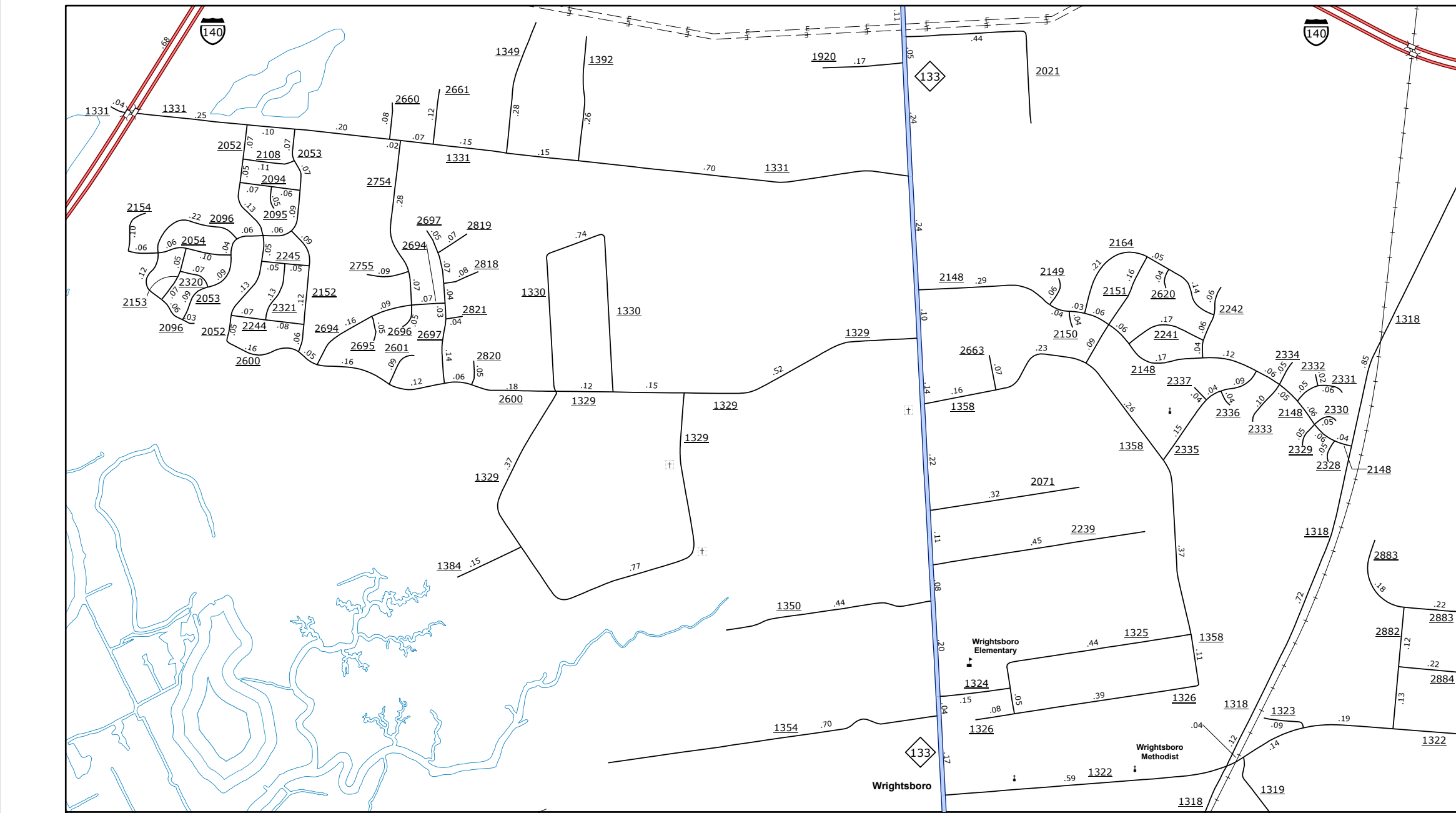
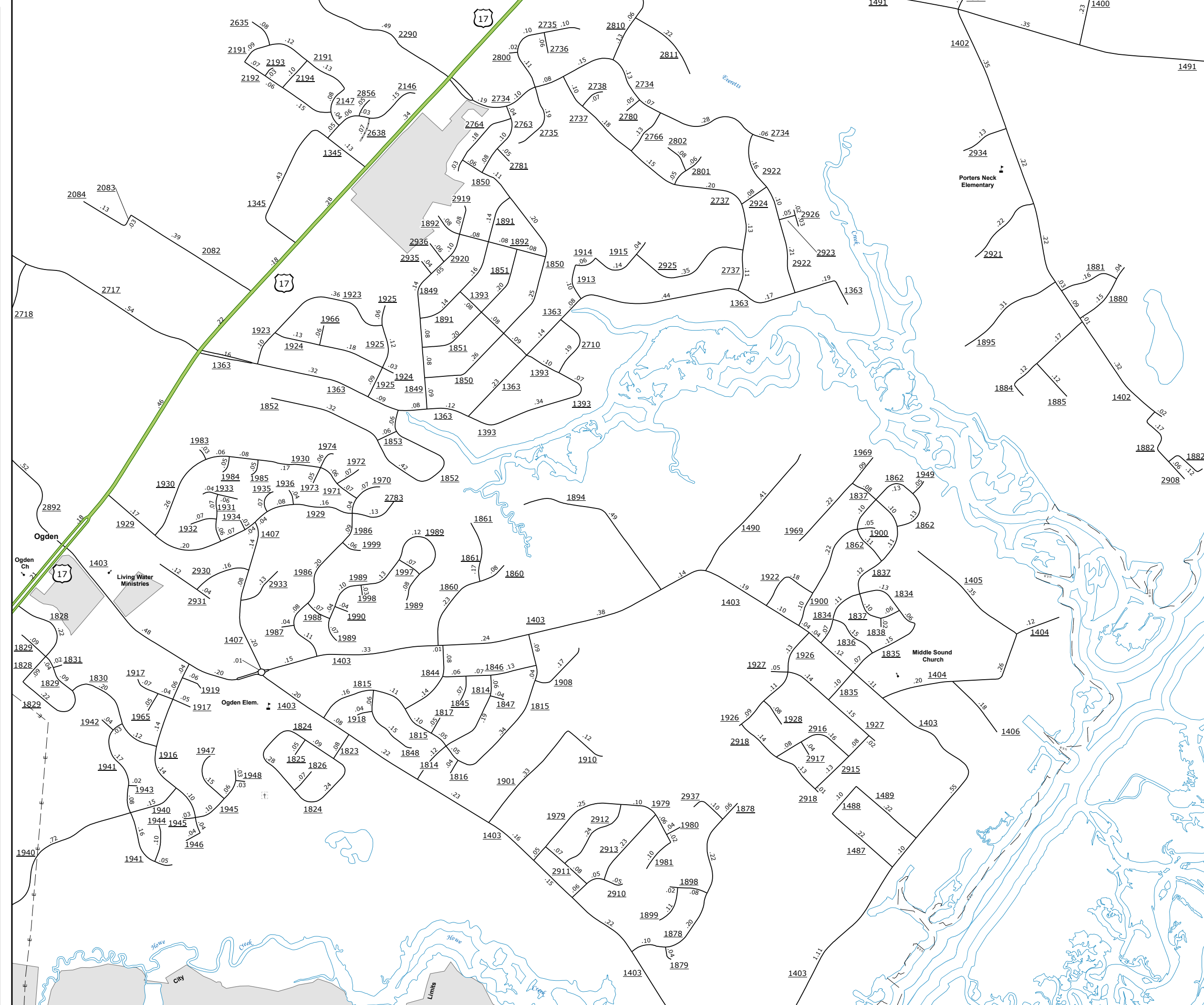
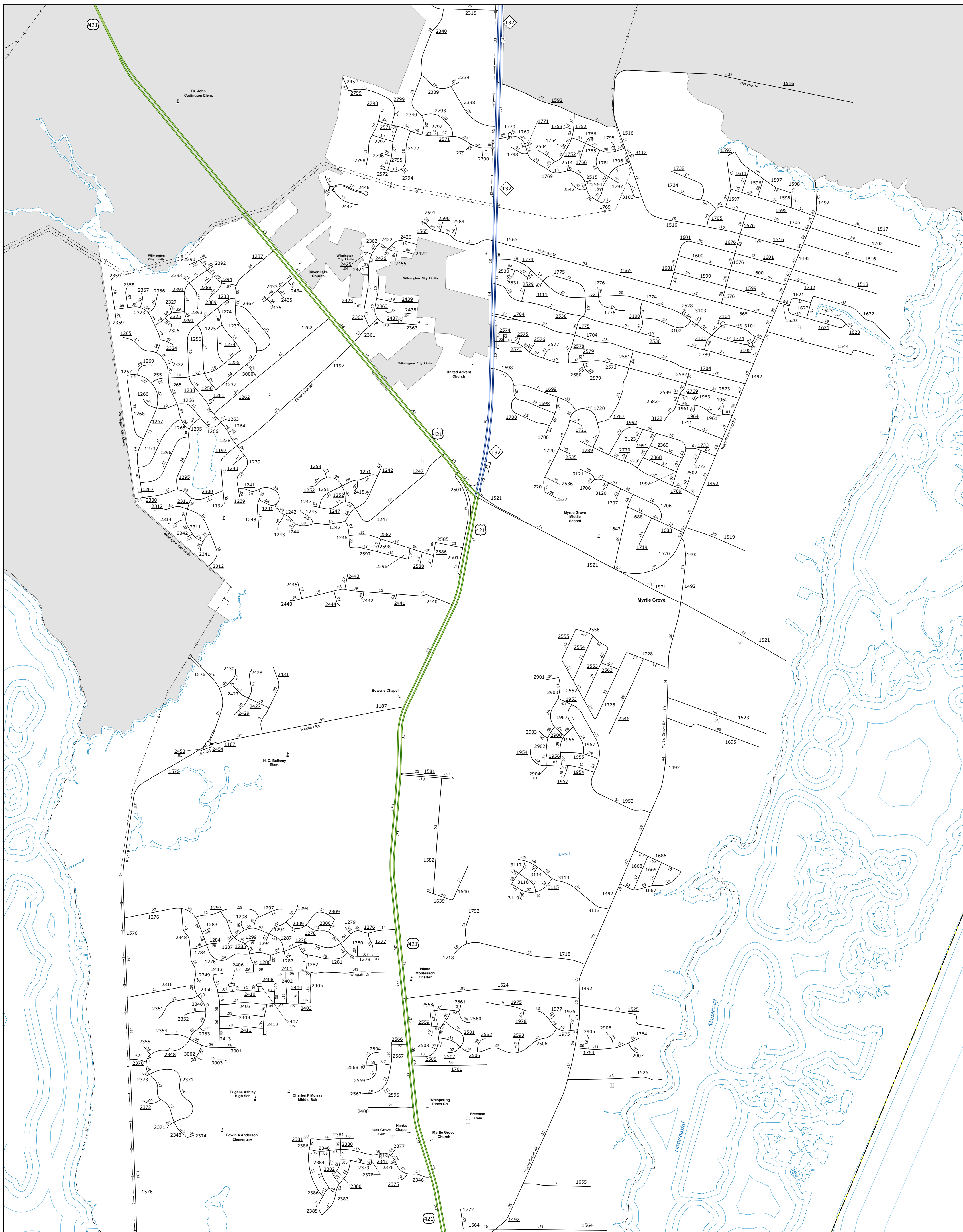

- LEGEND**
- INTERSTATE HIGHWAY
  - U.S. NUMBERED HIGHWAY
  - N.C. NUMBERED HIGHWAY
  - U.S. NUMBERED BICYCLE ROUTE
  - N.C. NUMBERED BICYCLE ROUTE
  - INTERSTATE INTERCHANGE NUMBER
  - SECONDARY ROAD NUMBER
  - TRAIL
  - RAILROAD LINE
  - RAILROAD STATION
  - POST OFFICE
  - STATE LINE
  - COUNTY LINE
  - SMOOTHED URBAN BOUNDARIES
  - CITY LIMITS
  - FERRY ROUTE AND RAMP
  - NARROW CREEK OR STREAM
  - WIDE RIVER OR CREEK
  - RESERVOIR, POND OR LAKE W/ ISLAND
  - DAM OR DAM WITH LOCK
  - WATERFALL
  - WYANAP
  - COMMUNITY
  - COUNTY SEAT
  - SCHOOL
  - COLLEGE OR UNIVERSITY
  - HOSPITAL
  - COAST GUARD STATION
  - CHURCH
  - CHURCH WITH CEMETERY
  - CEMETERY
  - PATROL STATION
  - CORRECTION OR PENAL INSTITUTION
  - QUARRY
  - MINE OR PIT
  - HIGHWAY GARAGE OR MAINT. YARD
  - HIGHWAY DIV. OR DIST. OFFICE
  - MILITARY POST
  - WEIGH STATION
  - FARMSHOUSES
  - HISTORICAL SITE
  - POINT OF INTEREST
  - POST OFFICE
  - STATE FOREST
  - LIGHTHOUSE
  - MOUNTAIN SUMMIT
  - MOUNTAIN GAP
  - OVERLOOK
  - REST AREA
  - VISITOR CENTER AREA
  - WELCOME CENTER AREA
  - AIRPORT
  - MILITARY AIRPORT
  - NATIONAL / STATE FOREST BOUNDARY
  - WILDLIFE REFUGE
  - NATIONAL / STATE PARK BOUNDARY
  - GAME LANDS BOUNDARY
  - MILITARY RESERVATION BOUNDARY
  - INDIAN RESERVATION BOUNDARY

## NEW HANOVER COUNTY NORTH CAROLINA

PREPARED BY THE  
NORTH CAROLINA DEPARTMENT OF TRANSPORTATION  
OPERATIONS PROGRAM MANAGEMENT UNIT - MAPPING SECTION  
IN COOPERATION WITH THE  
U.S. DEPARTMENT OF TRANSPORTATION  
FEDERAL HIGHWAY ADMINISTRATION

SCALE



NORTH CAROLINA PLANE COORDINATE SYSTEM  
LAMBERT CONFORMAL CONIC PROJECTION