

TERMS OF USE: The Mapping Section's goal is to provide the most accurate and current information possible. Map data is compiled from various sources, including aerial photography, ground surveys, and other reliable sources. The North Carolina Department of Transportation and its contractors are not responsible for any errors or omissions in this map data. This map is provided as a general reference only. For more information, please contact the Mapping Section at 1-800-368-3346. For digital copies of this map or additional map products, visit <http://www.ncdot.gov/MapData>.

COPIES OF THIS MAP ARE AVAILABLE TO THE PUBLIC AT NO CHARGE. FOR MORE INFORMATION, CONTACT THE NORTH CAROLINA DEPARTMENT OF TRANSPORTATION, MAPS SECTION, AT 1-800-368-3346.

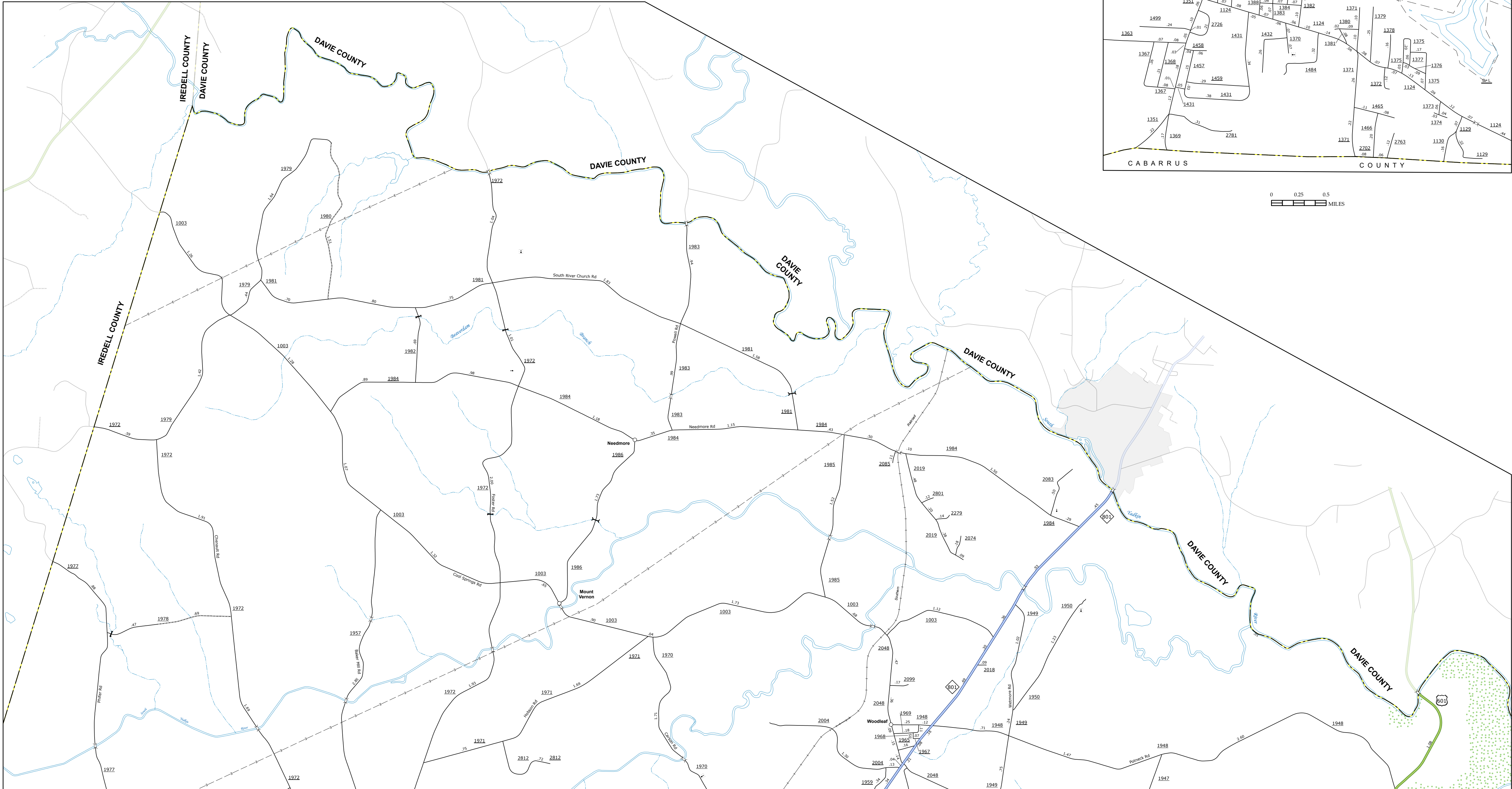
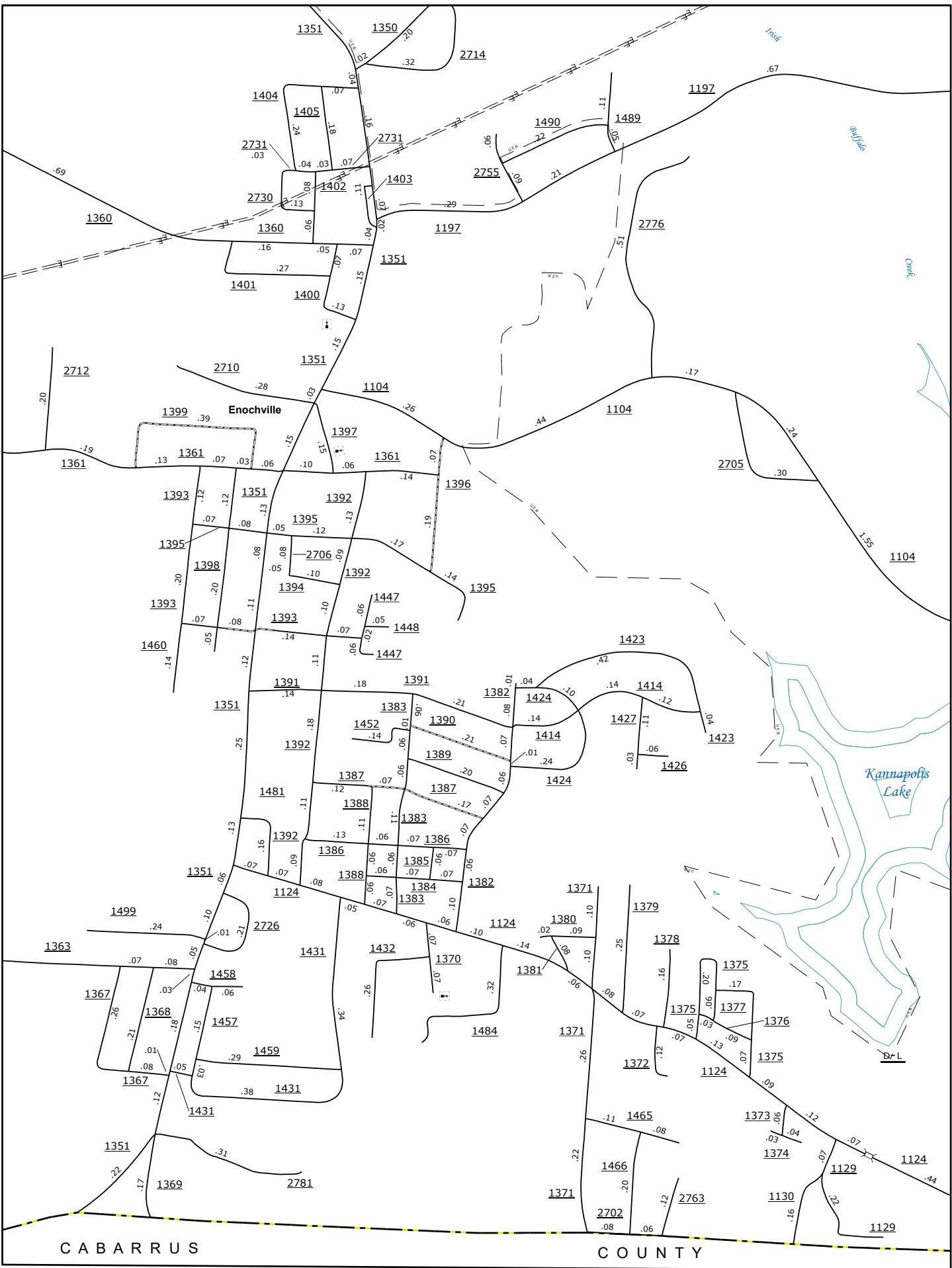
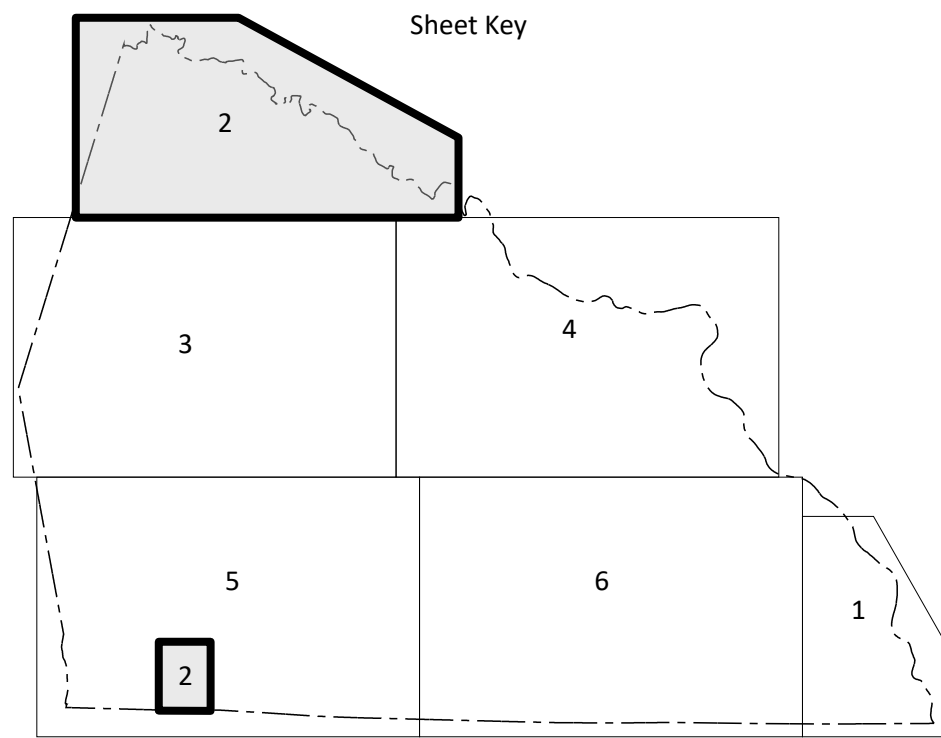

LEGEND

- INTERSTATE US NC Divided Hwy Undivided Hwy
- ROUTE MARK PARKWAY
- UNIMPROVED PRIVATE ROAD
- HIGHWAY RIGHT-OF-WAY
- NON-EXISTENT ROAD
- PROVISIONALLY DRAIN ROAD
- PROPOSED ROAD ALTERNATIVE
- INTERSECTION DISTANCE
- STANDARD ROAD BRIDGE
- RAILROAD BRIDGE
- DRAWN ACROSS BRIDGE
- PEDESTRIAN BRIDGE
- PEDESTRIAN WALKWAY
- PEDESTRIAN UNDERPASS
- VEHICLE UNDERPASS
- TUNNEL
- CULVERT
- PIPE
- INTERSTATE HIGHWAY
- U.S. NUMBERED HIGHWAY
- N.C. NUMBERED HIGHWAY
- U.S. NUMBERED BI-CYCLE ROUTE
- N.C. NUMBERED BI-CYCLE ROUTE
- INTERSTATE INTERCHANGE NUMBER
- SECONDARY ROAD NUMBER
- UTILITY LINE
- RAILROAD LINE
- RAILROAD STATION
- INSIDE AREA
- STATE LINE
- COUNTY LINE
- SMOOTHED URBAN BOUNDARY
- CITY LIMITS
- FERRY ROUTE AND RAMP
- NARROW CREEK OR STREAM
- WIDE RIVER OR CREEK
- RESERVE, POND OR LAKE W/ ISLAND
- DAM OR DAM WITH LOCK
- WATERFALL
- SWAMP
- COMMUNITY
- COUNTY SEAT
- SCHOOL
- COLLEGE OR UNIVERSITY
- HOSPITAL
- COAST GUARD STATION
- CHURCH
- CHURCH WITH CEMETERY
- CEMETERY
- PATROL STATION
- CORRECTION OR PENAL INSTITUTION
- QUARTER
- MINE OR PIT
- HOUSING GARAGE OR MAIN YARD
- HIGHWAY DIV. OR DIST. OFFICE
- MILITARY POST
- WEIGH STATION
- FARMS/GRASS
- HISTORICAL SITE
- POINTS OF INTEREST
- POST OFFICE
- STATE FOREST
- LIGHTHOUSE
- MOUNTAIN SUMMIT
- MOUNTAIN GAP
- OVERLOOK
- REST AREA
- VISITOR CENTER REST AREA
- WELCOME CTR. REST AREA
- AIRPORT
- MILITARY AIRPORT
- NATIONAL STATE FOREST BOUNDARY
- WILDLIFE REFUGE
- NATIONAL STATE PARK BOUNDARY
- GAME LANDS BOUNDARY
- MILITARY RESERVATION BOUNDARY
- INDIAN RESERVATION BOUNDARY

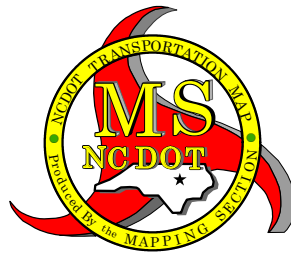

ROWAN COUNTY
NORTH CAROLINA

PREPARED BY THE
NORTH CAROLINA DEPARTMENT OF TRANSPORTATION
OPERATIONS PROGRAM MANAGEMENT UNIT - MAPPING SECTION
IN COOPERATION WITH THE
U.S. DEPARTMENT OF TRANSPORTATION
FEDERAL HIGHWAY ADMINISTRATION

SCALE

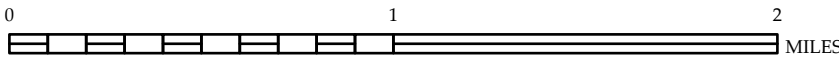

NORTH CAROLINA PLANE COORDINATE SYSTEM
LAMBERT CONFORMAL CONIC PROJECTION

COPIES OF THIS MAP ARE AVAILABLE TO THE
PUBLIC AT NOMINAL COST. CONTACT US TO ORDER:
mapinfo@nrc.ca
<http://bitbucket.nrc.ca/web/resources/State-Mapping/Pages/Ordering-Maps.aspx>
(919) 834-4460

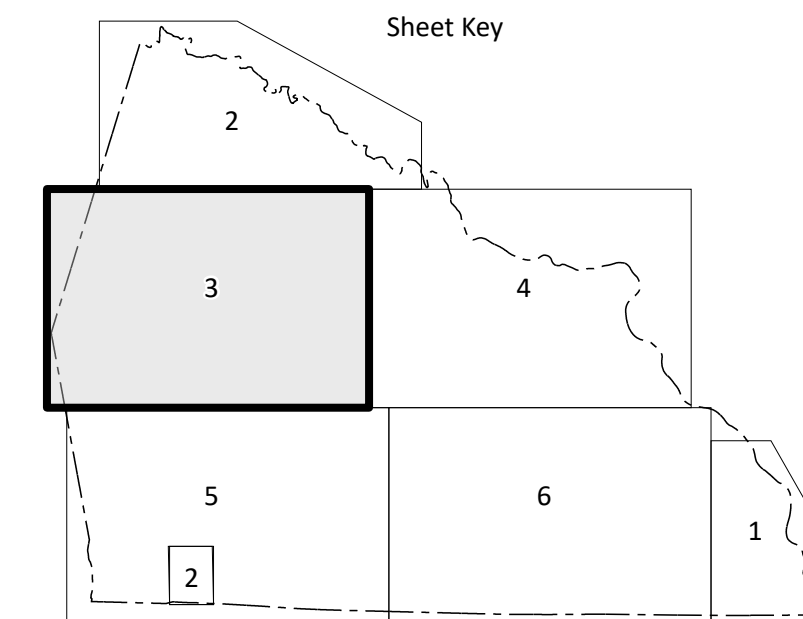
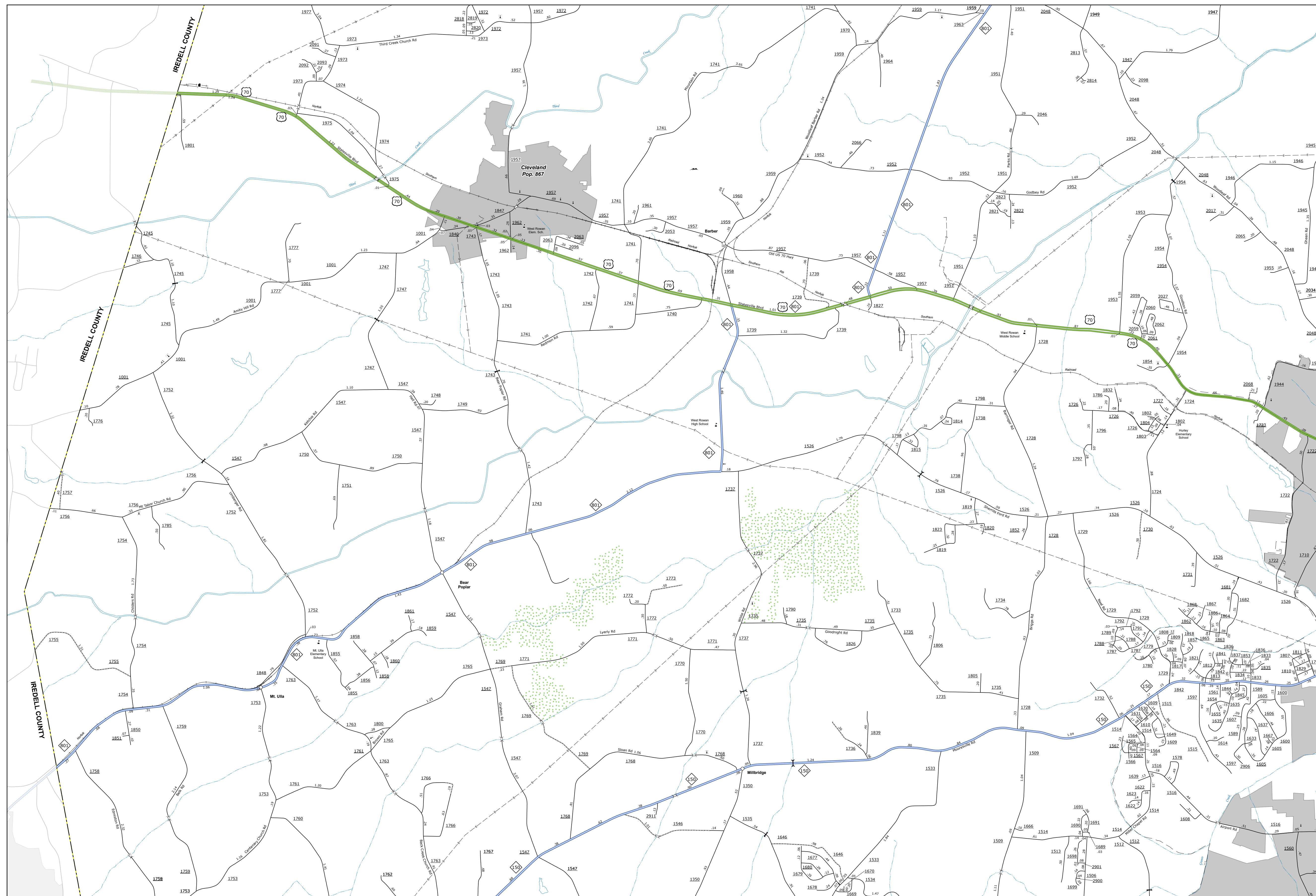

- [illegible]



ROWAN COUNTY
NORTH CAROLINA

PREPARED BY THE
NORTH CAROLINA DEPARTMENT OF TRANSPORTATION
OPERATIONS PROGRAM MANAGEMENT UNIT - MAPPING SECTION
IN COOPERATION WITH THE
U.S. DEPARTMENT OF TRANSPORTATION
FEDERAL HIGHWAY ADMINISTRATION

SCAL

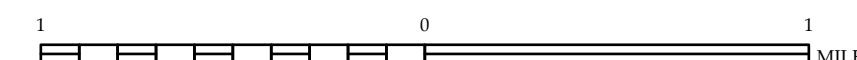
NORTH CAROLINA PLANE COORDINATE SYSTEM
LAMBERT CONFORMAL CONIC PROJECTION

COPIES OF THIS MAP ARE AVAILABLE TO THE PUBLIC AT NOMINAL COST. CONTACT US TO ORDER:
mapinfo@uspoa.net
<http://www.uspoa.net/atlases/atlomcd.html#atlomcd>
 (919) 854-8460

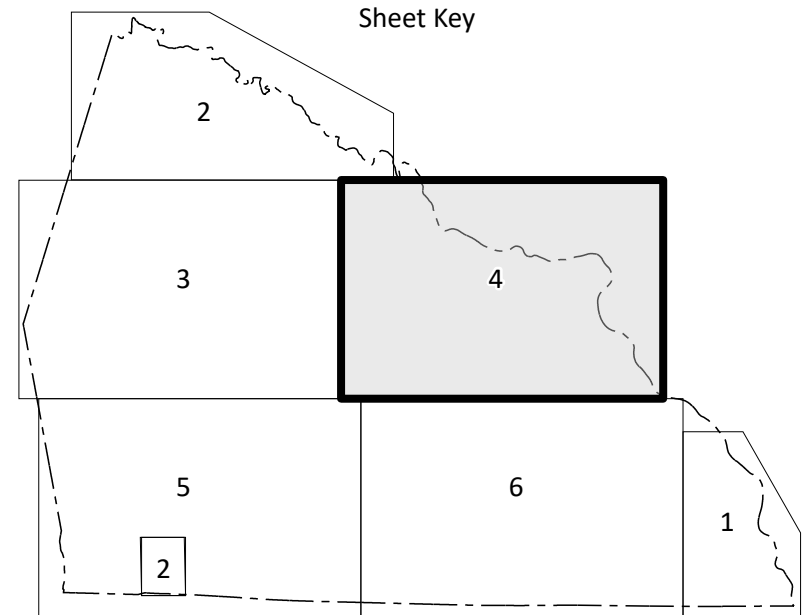

	TERRESTRIAL	US	NC	Dreaded Hwy Undesired Hwy



SCALE



COPIES OF THIS MAP ARE AVAILABLE TO THE
PUBLIC AT NOMINAL COST. CONTACT US TO ORDER:
mappingsupport@nodel.gov
<http://nodel.com/resources/State-Mapping/Pages/Ordering-Maps.aspx>
(919) 834-4460

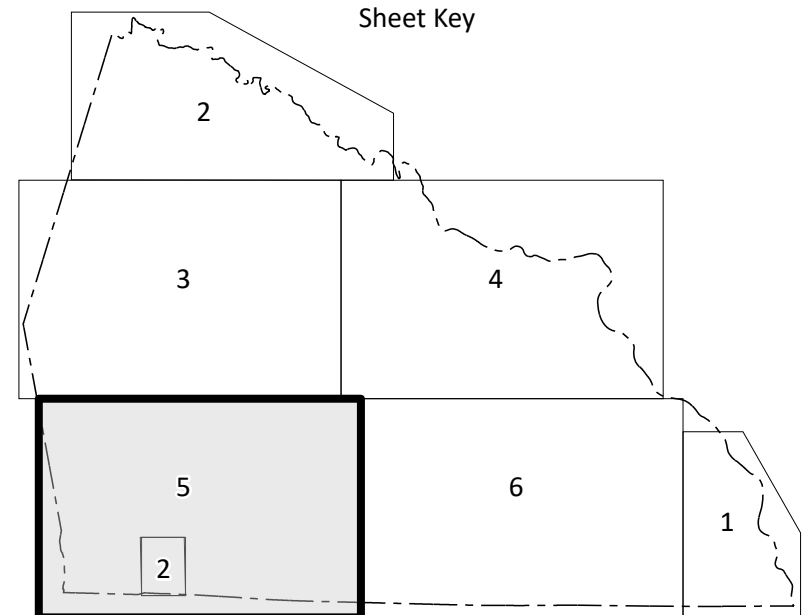

INTERSTATE	US	NC	Unlabeled Hwy



SCAL

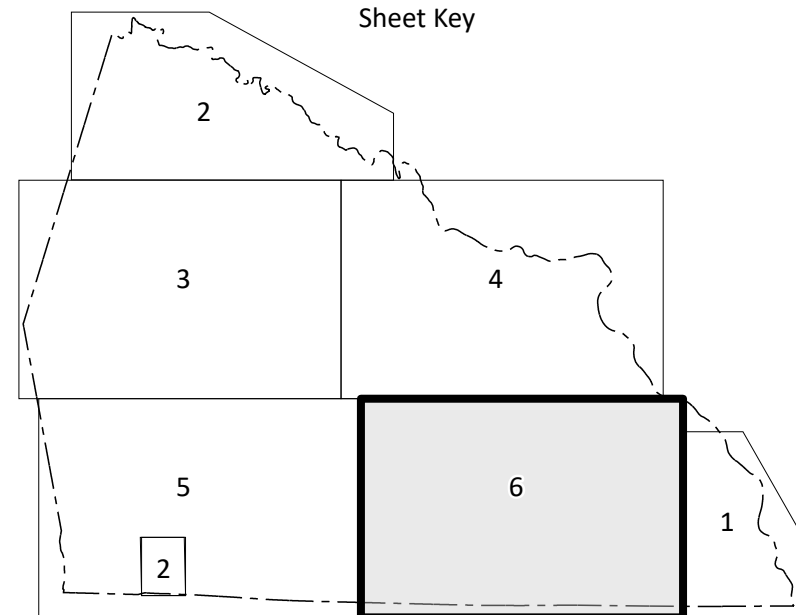

COPIES OF THIS MAP ARE AVAILABLE TO THE
PUBLIC AT NOMINAL COST. CONTACT US TO ORDER:
mappingusps@nps.gov
<https://connect.nps.gov/resources/State-Mapping/Pages/Ordering-Maps.aspx>
(919) 634-6460

[illegible]

SCALE

