

LEGEND

- INTERSTATE US NC
- US NC
- Divided Hwy
- Undivided Hwy
- Blue Ridge Parkway
- UNPAVED SELECTED ROAD
- ROADS IN SERVICE TO ROAD
- NON-SYSTEM ROAD
- PROPOSED/PLANNED ROAD
- PROPOSED/PLANNED ROAD
- INTERSTATE INTERCHANGE
- STANDARD ROAD BRIDGE
- RAILROAD BRIDGE
- BRIDGE-SPAN ON BRIDGE
- PEDESTRIAN BRIDGE
- PEDESTRIAN UNDERPASS
- VEHICULAR UNDERPASS
- TUNNEL
- CULVERT
- HYDRO
- INTERSTATE HIGHWAY
- U.S. NUMBERED HIGHWAY
- U.S. NUMBERED HIGHWAY
- U.S. NUMBERED BI-CYCLE ROUTE
- U.S. NUMBERED BI-CYCLE ROUTE
- INTERSTATE INTERCHANGE NUMBER
- SECONDARY ROAD NUMBER
- UTILITY LINES
- RAILROAD LINE
- RAILROAD STATION
- STATE LINE
- COUNTY LINE
- UNINCORPORATED TOWN BOUNDARIES
- CITY LIMITS
- FERM BOULE AND RAMP
- NARROW CREEK OR STREAM
- WIDE RIVER OR CREEK
- RECREATION/POWDER LAKE W/ ISLAND
- DAM OR DAM WITH LOCK
- WATERFALL
- SWAMP
- COMMUNITY
- CITY/STATE
- SCHOOL
- COLLEGE OR UNIVERSITY
- HOSPITAL
- COUNTY GOVERNMENT
- CHURCH
- CHURCH WITH CEMETERY
- CEMETERY
- POWDER LAKE
- CORRECTIONAL INSTITUTION
- QUARRY
- MINI OR PIT
- HIGHWAY GARAGE OR MAINT. YARD
- HIGHWAY TRUCK OR BUS STOP
- MILITARY POST
- WEIR STATION
- FABRICATION
- HISTORICAL SITE
- POST OFFICE
- STATE FOREST
- LIGHTHOUSE
- MOUNTAIN SUMMIT
- MOUNTAIN GAP
- OVERLOOK
- BEST AREA
- VISITOR CENTER AREA
- AIRPORT
- MILITARY AIRPORT
- NATIONAL / STATE FOREST BOUNDARY
- WILDLIFE REFUGE
- NATIONAL / STATE PARK BOUNDARY
- GAME LANDS BOUNDARY
- MILITARY RESERVATION BOUNDARY
- INDIAN RESERVATION BOUNDARY



PAMLI CO COUNTY
NORTH CAROLINA

PREPARED BY THE
NORTH CAROLINA DEPARTMENT OF TRANSPORTATION
OPERATIONS PROGRAM MANAGEMENT UNIT - MAPPING SECTION
IN COOPERATION WITH THE
U.S. DEPARTMENT OF TRANSPORTATION
FEDERAL HIGHWAY ADMINISTRATION

SCALE

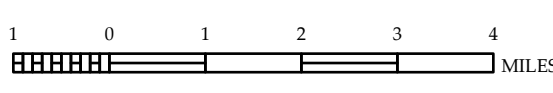

NORTH CAROLINA PLANE COORDINATE SYSTEM
LAMBERT CONFORMAL CONIC PROJECTION

COPIES OF THIS MAP ARE AVAILABLE TO THE
PUBLIC AT NOMINAL COST. CONTACT US TO ORDER:
maps@ncdot.gov
https://connect.ncdot.gov/resources/State_Mapping/Pages/Ordering_Maps.aspx
(919) 834-8480

TERMS OF USE: The Mapping Section's goal is to provide the most accurate and current information possible. Map data is compiled from numerous sources with varying dates of publication and map accuracy standards. As a result, the accuracy, currency, and completeness of the data provided will vary. The North Carolina Department of Transportation shall not be held liable for any errors in the map data. This map cannot be construed to be a legal document. The information shown on this map was last updated in September 2024. For digital copies of this map or additional map products, visit https://connect.ncdot.gov/resources/State_Mapping.

COPIES OF THIS MAP ARE AVAILABLE TO THE
PUBLIC AT NOMINAL COST. CONTACT US TO ORDER:
mapsales@portofmcd.net
<http://www.portofmcd.net/govresources/State-Mapping/Papers/Ordering-Maps.aspx>
(919) 834-8480

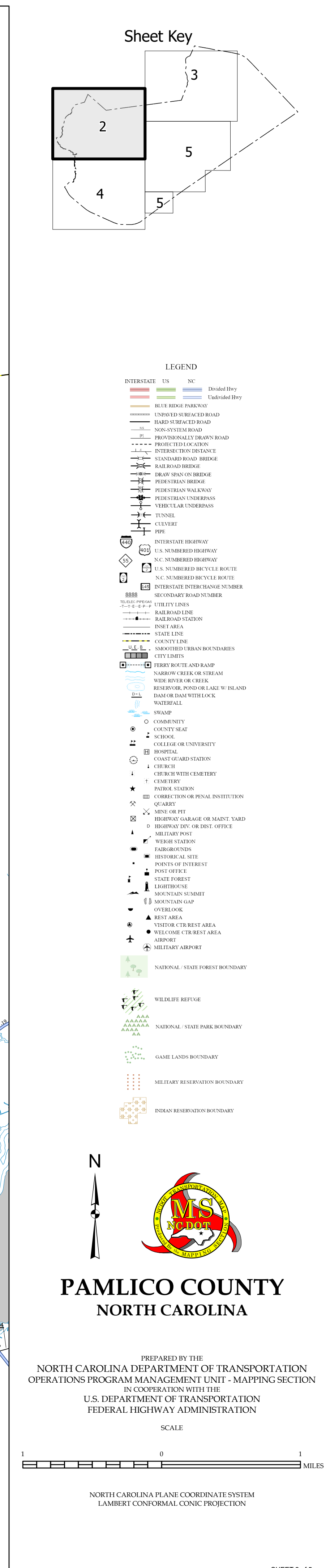

COPIES OF THIS MAP ARE AVAILABLE TO THE PUBLIC AT NOMINAL COST. CONTACT US TO ORDER:
<https://connect.ncda.gov/resources/State-Mapping/Pages/Ordering-Maps.aspx>
 macplon@ncda.gov
 (919) 834-8480

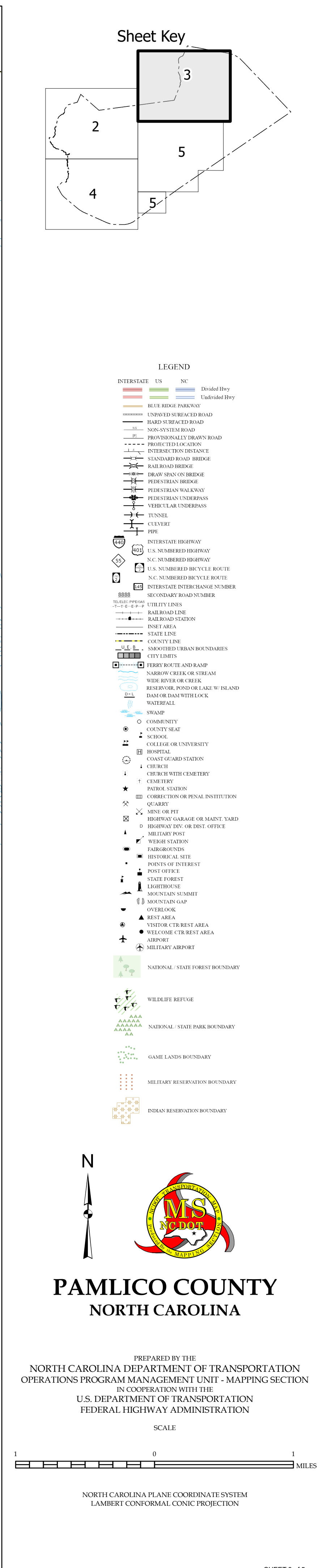

COPIES OF THIS MAP ARE AVAILABLE TO THE
PUBLIC AT NOMINAL COST. CONTACT US TO ORDER:
mapinfo@esri.com
800-368-6868 ext. 6300 or www.esri.com/resources/State-Mapping/Papers/Ordering-Maps.aspx
(919) 834-6460

[illegible]

SCALE



SHEET 4 of 5
DIVISION 2 DISTRICT 2 PAMlico COUNTY NORTH CAROLINA FIPS 137

COPIES OF THIS MAP ARE AVAILABLE TO THE
PUBLIC AT NOMINAL COST. CONTACT US TO ORDER:
mapinfo@usrcdot.gov
<https://connect.ncdot.gov/resources/State-Mapping/Pages/Ordering-Maps.aspx>

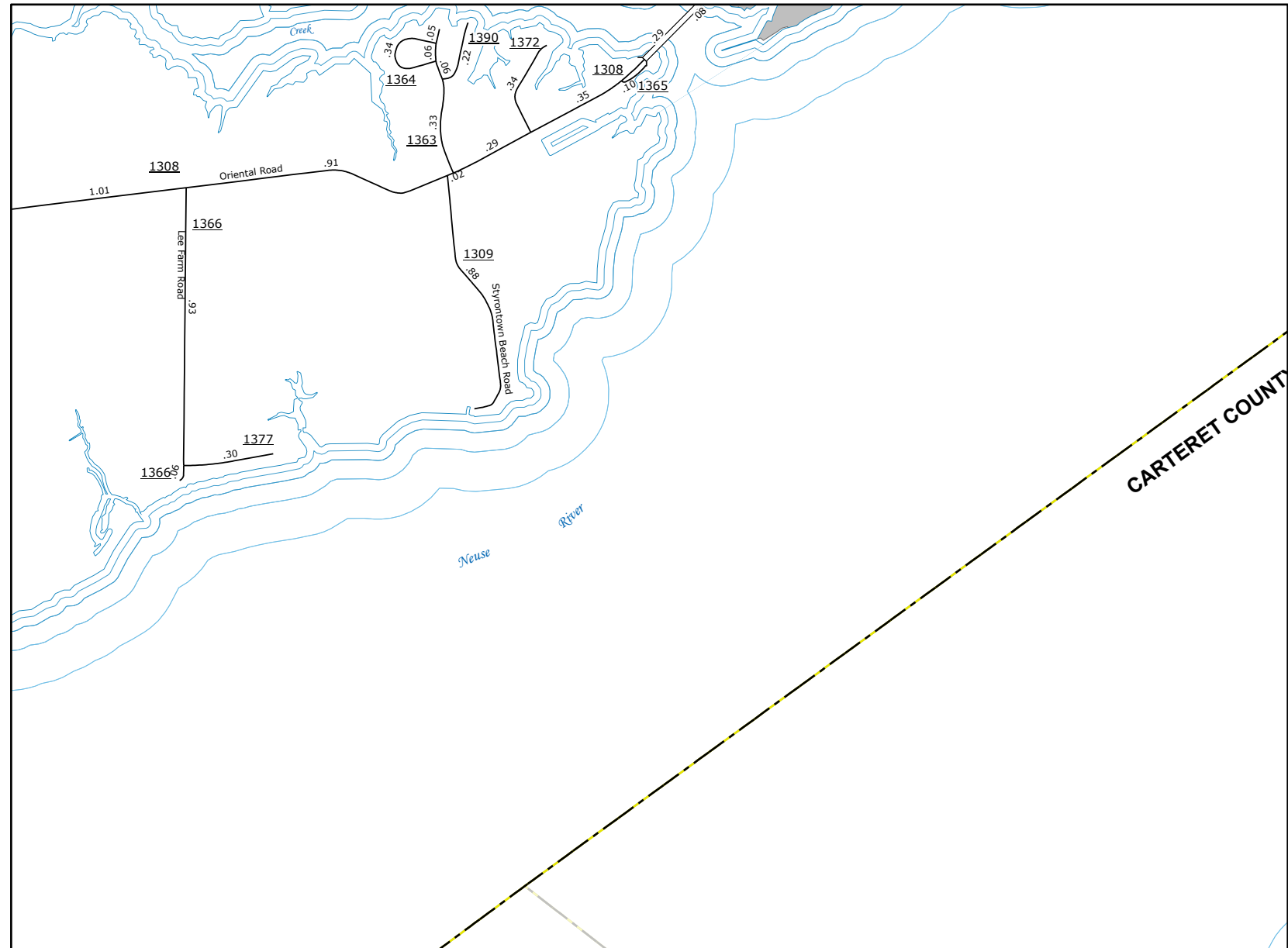
[illegible]

SCALE

