

TERMS OF USE: The Mapping Section's goal is to provide the most accurate and current information possible. Map data is compiled from numerous sources with varying degrees of accuracy and map accuracy standards. As a result, the accuracy, currency, and completeness of map content cannot be guaranteed to be high. The information shown on this map was last updated in July 2024.

COPIES OF THIS MAP ARE AVAILABLE TO THE PUBLIC AT NO CHARGE. CONTACT US TO ORDER: FranklinCountyMap@ncdot.gov or [919-733-7400](tel:9197337400).

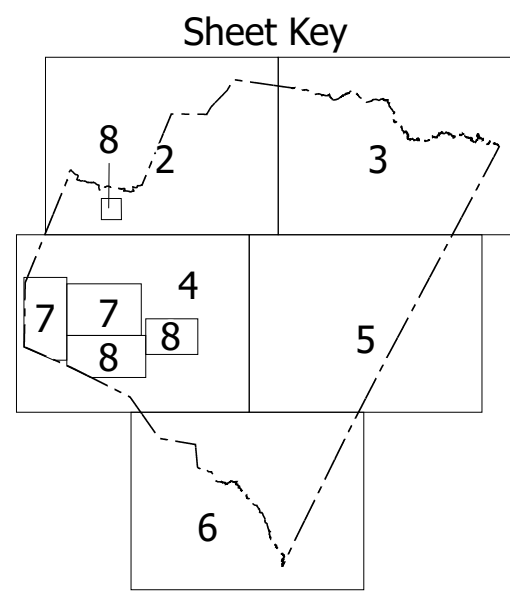

- LEGEND**
- INTERSTATE: US, NC, Divided Hwy, Undivided Hwy
 - BLVD: BLVD, PARKWAY
 - UNPAVED/DEGRADED ROAD
 - ROADS/STREET/ROAD
 - PROPOSED/PLANNED ROAD
 - PROTECTED LOCATION
 - INTERSECTION/DRIVEWAY
 - STANDARD ROAD BRIDGE
 - RAILROAD BRIDGE
 - BRIDGE/SPAN ON BRIDGE
 - PEDESTRIAN BRIDGE
 - PEDESTRIAN WALKWAY
 - PEDESTRIAN UNDERPASS
 - VEHICULAR UNDERPASS
 - TUNNEL
 - CULVERT
 - HYDRO: HYDRO
 - INTERSTATE HIGHWAY
 - U.S. NUMBERED HIGHWAY
 - N.C. NUMBERED HIGHWAY
 - U.S. NUMBERED BI-CYCLE ROUTE
 - N.C. NUMBERED BI-CYCLE ROUTE
 - INTERSTATE INTERCHANGE NUMBER
 - SECONDARY ROAD NUMBER
 - UTILITY LINES
 - RAILROAD LINE
 - RAILROAD STATION
 - INLET AREA
 - STAY LINE
 - COUNTY LINE
 - CITY LIMITS
 - FERRY ROUTE
 - NARROW RIVER OR STREAM
 - WIDE RIVER OR CREEK
 - RESERVOIR, POND OR LAKE W/ ISLAND
 - DAM OR DAM WITH LOCK
 - WATERFALL
 - SWAMP
 - COMMUNITY, TOWN OR CITY CENTER
 - COUNTY SEAT
 - SCHOOL
 - COLLEGE OR UNIVERSITY
 - HOSPITAL
 - COAST GUARD STATION
 - CHURCH WITH CEMETERY
 - CEMETERY
 - POLICE STATION
 - CORRECTION OR PENAL INSTITUTION
 - CLUBHOUSE
 - MINE OR PIT
 - HIGHWAY GARAGE OR MAINT. YARD
 - MILITARY POST
 - WEIGH STATION
 - FARMGROUNDS
 - HISTORICAL SITE
 - POINTS OF INTEREST
 - STATE FOREST
 - LIGHTHOUSE
 - MOUNTAIN SANCTUARY
 - OVERLOOK
 - REST AREA
 - VISITOR/REST AREA
 - WELCOME CTR/REST AREA
 - AIRPORT
 - MILITARY AIRPORT
 - HELIPORT
 - NATIONAL / STATE FOREST BOUNDARY
 - WILDLIFE REFUGE
 - NATIONAL / STATE PARK BOUNDARY
 - GAME LANDS BOUNDARY
 - MILITARY RESERVATION BOUNDARY
 - INDIAN RESERVATION BOUNDARY

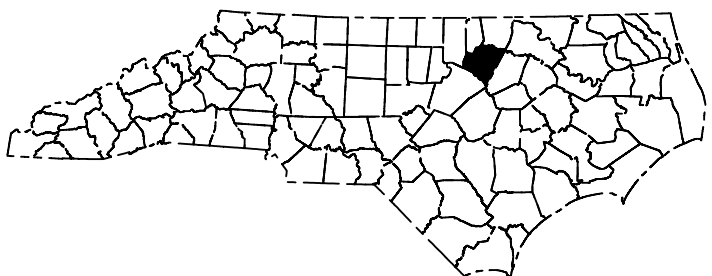
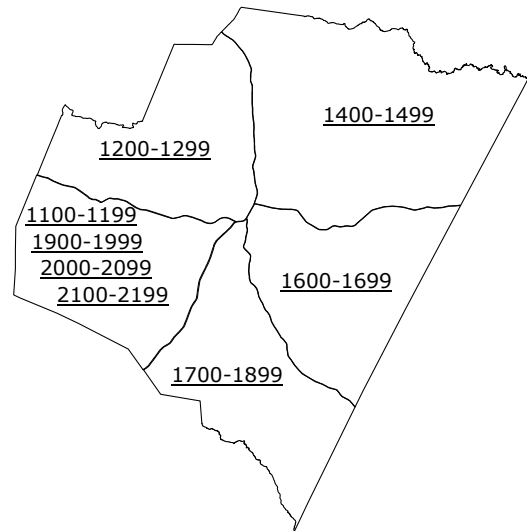
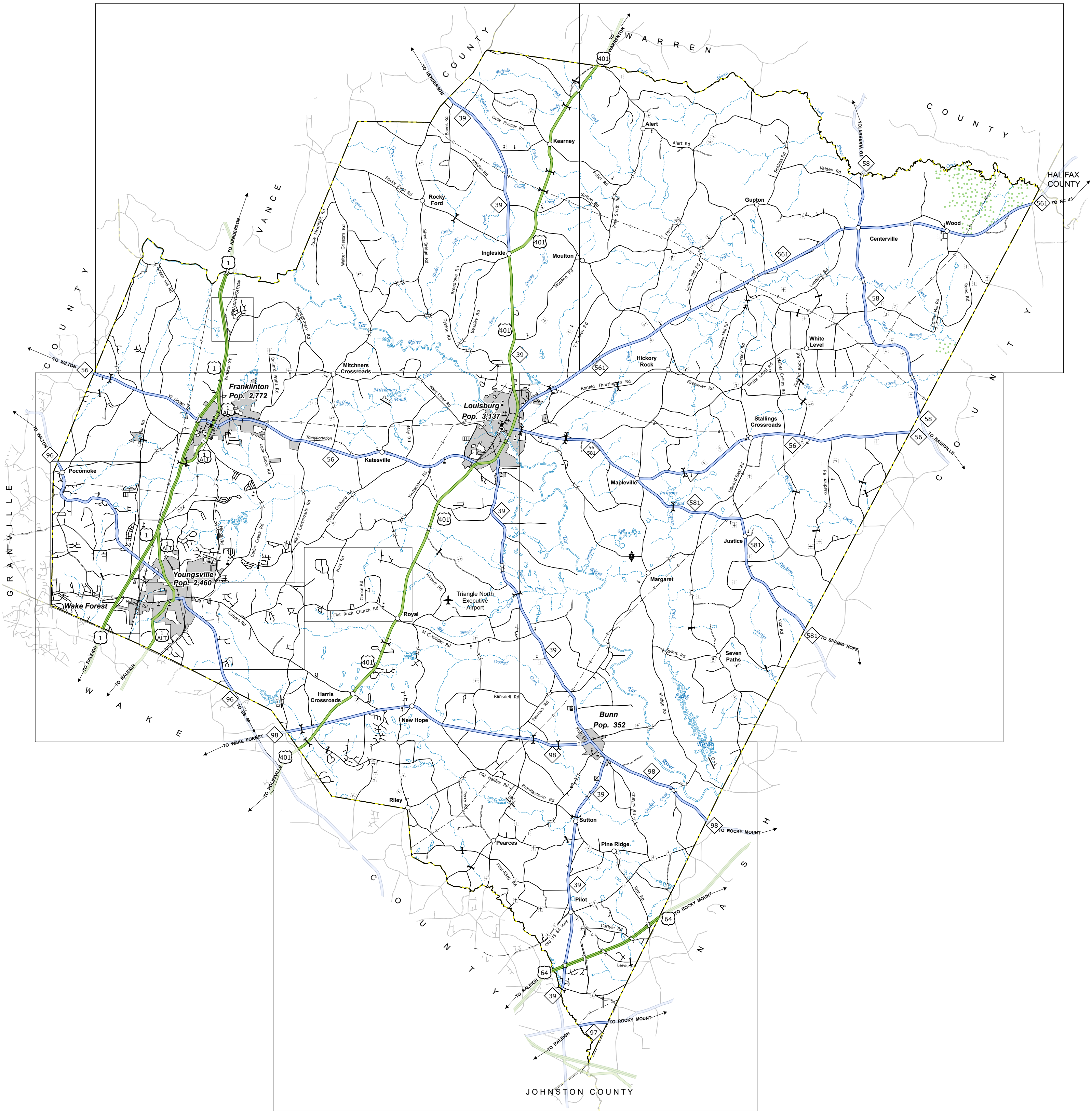
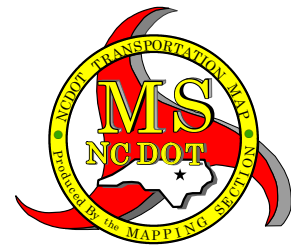

FRANKLIN COUNTY NORTH CAROLINA

PREPARED BY THE
NORTH CAROLINA DEPARTMENT OF TRANSPORTATION
OPERATIONS PROGRAM MANAGEMENT UNIT - MAPPING SECTION
IN COOPERATION WITH THE
U.S. DEPARTMENT OF TRANSPORTATION
FEDERAL HIGHWAY ADMINISTRATION

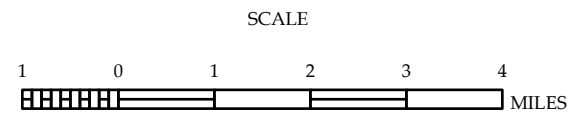

NORTH CAROLINA PLANE COORDINATE SYSTEM
LAMBERT CONFORMAL CONIC PROJECTION

SHEET 1 OF 8

COPIES OF THIS MAP ARE AVAILABLE TO THE
PUBLIC AT NOMINAL COST. CONTACT US TO ORDER:
mapping.support@ncd.gov
<https://connect.ncd.gov/resources/State-Mapping/Pages/01919/834-8480>

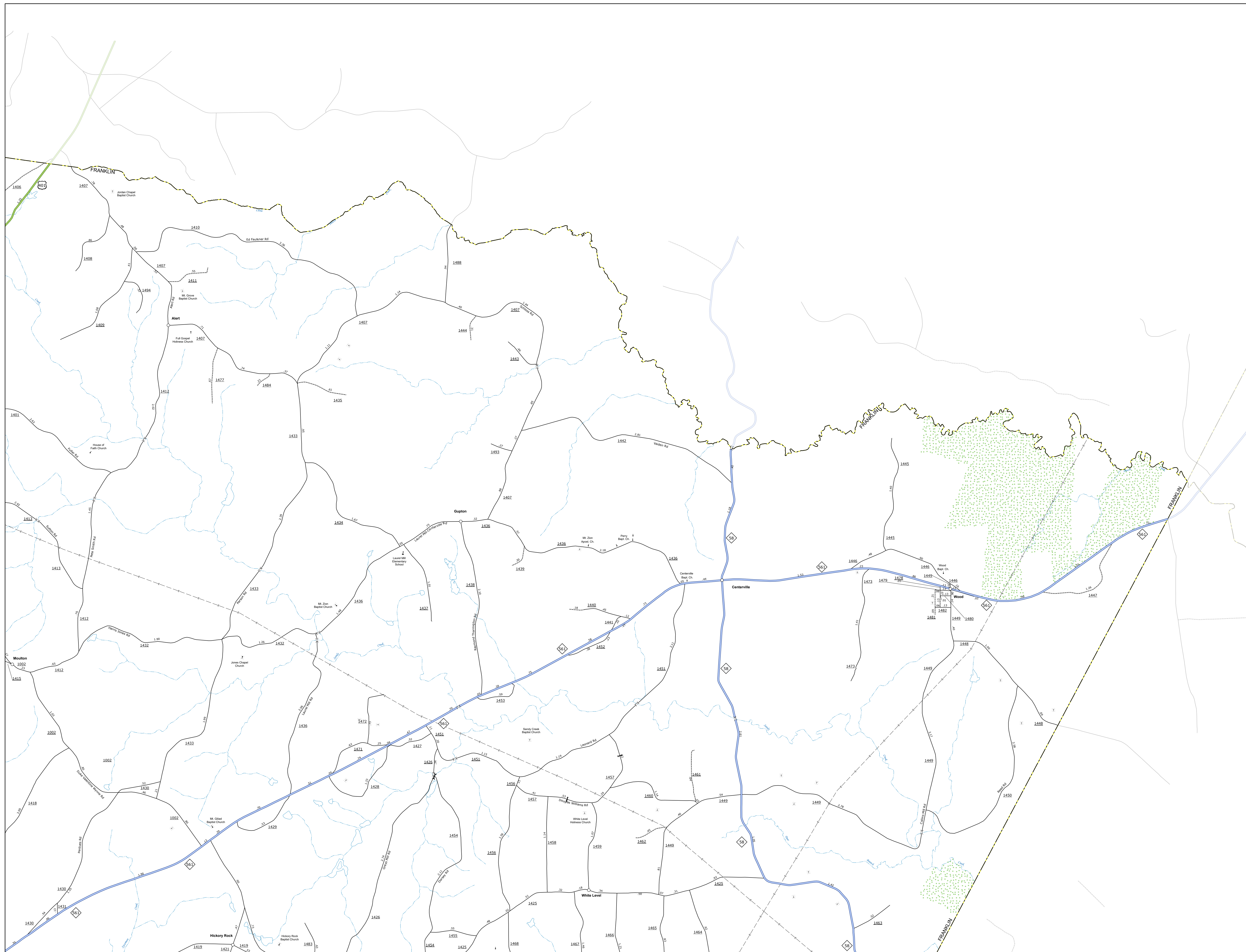

COPIES OF THIS MAP ARE AVAILABLE TO THE
PUBLIC AT NOMINAL COST. CONTACT US TO ORDER:
mapping.support@ncd.gov
<http://ncd.net/pwiresources/State-Mapping/Pages/9191834-8480>

[illegible]

FRANKLIN COUNTY
NORTH CAROLINA

PREPARED BY THE
NORTH CAROLINA DEPARTMENT OF TRANSPORTATION
OPERATIONS PROGRAM MANAGEMENT UNIT - MAPPING SECTION
IN COOPERATION WITH THE
U.S. DEPARTMENT OF TRANSPORTATION
FEDERAL HIGHWAY ADMINISTRATION

A horizontal number line is shown, labeled '1' at the left end, '0' in the middle, and '1' at the right end. The line is divided into 10 equal segments by vertical tick marks. The first 6 segments from the left are shaded gray, and the remaining 4 segments are white. The word 'MILES' is written at the far right end of the line.

NORTH CAROLINA PLANE COORDINATE SYSTEM
LAMBERT CONFORMAL CONIC PROJECTION

TERMS OF USE: The Mapping Section's goal is to provide the most accurate and current information possible. Map data is compiled from various sources, including aerial photography, ground surveys, and other reliable sources. The North Carolina Department of Transportation and the U.S. Department of Transportation are not responsible for any errors in the map data. This map is provided as a guide only and should not be used for legal purposes. For legal purposes, consult the official records of the State of North Carolina.

COPIES OF THIS MAP ARE AVAILABLE TO THE PUBLIC. FOR MORE INFORMATION, CONTACT US AT: FRANKLIN COUNTY, NORTH CAROLINA. PHONE: 919.733.1234. FAX: 919.733.1235. EMAIL: FRANKLIN@NCDOT.GOV. WEBSITE: WWW.NCDOT.GOV/FRANKLIN

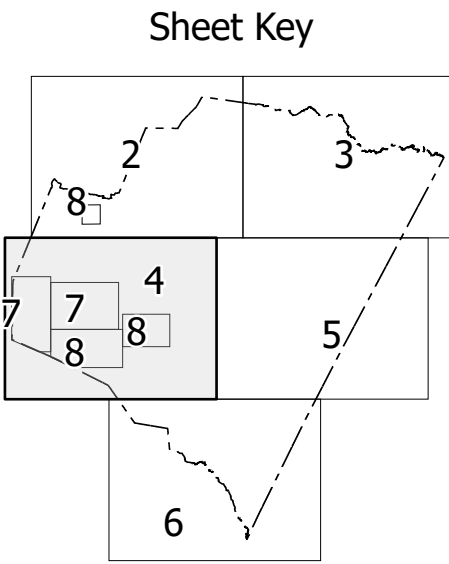
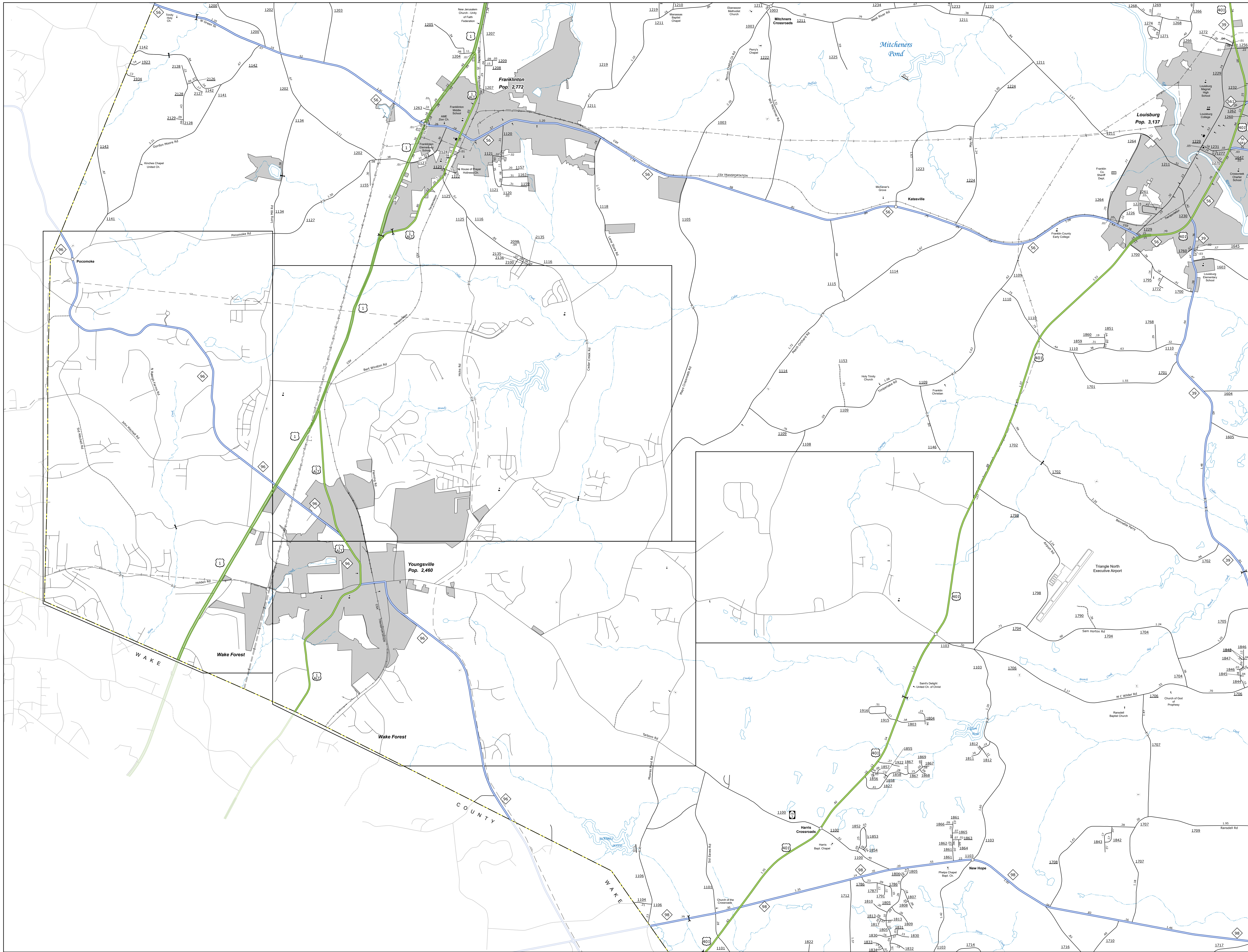

LEGEND

- INTERSTATE US NC Divided Hwy Undivided Hwy
- BLUE RIDGE PARKWAY
- UNIMPROVED/UNPAVED ROAD
- HIGHWAY RIGHT-OF-WAY
- NON-STEEL ROAD
- PROPOSED/PLANNED ROAD
- PROPOSED LOCATION
- INTERSECTION/TRANSITION
- STANDARD ROAD BRIDGE
- RAILROAD BRIDGE
- DRAW SPAN ON BRIDGE
- PEDESTRIAN BRIDGE
- PEDESTRIAN WALKWAY
- PEDESTRIAN UNDERPASS
- VEHICLE UNDERPASS
- TUNNEL
- CULVERT
- WYE
- INTERSTATE HIGHWAY
- U.S. NUMBERED HIGHWAY
- N.C. NUMBERED HIGHWAY
- N.C. NUMBERED BI-CYCLE ROUTE
- INTERSTATE INTERCHANGE NUMBER
- SECONDARY ROAD NUMBER
- UTILITY LINES
- RAILROAD LINE
- RAILROAD STATION
- RAILROAD TUNNEL
- STATE LINE
- COUNTY LINE
- CITY LIMITS
- FERRY ROUTE
- NARROW CREEK OR STREAM
- WIDE RIVER OR CREEK
- RESERVOIR, POND OR LAKE W/ ISLAND
- DAM OR DAM WITH LOCK
- WATERFALL
- SWAMP
- COMMUNITY TOWN OR CITY CENTER
- COUNTY SEAT
- SCHOOL
- COLLEGE OR UNIVERSITY
- HOSPITAL
- COAST GUARD STATION
- CHURCH
- CHURCH WITH CEMETERY
- CEMETERY
- POLICE STATION
- CORRECTIONAL INSTITUTION
- QUARRY
- WIND OR PILE
- HIGHWAY GARAGE OR MAINT. YARD
- HIGHWAY DIV. OR DIST. OFFICE
- MILITARY POST
- WEIGH STATION
- FOREIGN BOUNDARY
- HISTORICAL SITE
- POINT OF INTEREST
- STATE FOREST
- SOFT BRIDGE
- MOUNTAIN SUMMIT
- OVERLOOK
- REST AREA
- VISITOR CENTER AREA
- WELCOME CENTER AREA
- AIRPORT
- MILITARY AIRPORT
- WATERPORT
- NATIONAL STATE FOREST BOUNDARY
- WILDLIFE REFUGE
- NATIONAL STATE PARK BOUNDARY
- GAME LANDS BOUNDARY
- MILITARY RESERVATION BOUNDARY
- INDIAN RESERVATION BOUNDARY



FRANKLIN COUNTY NORTH CAROLINA

PREPARED BY THE
NORTH CAROLINA DEPARTMENT OF TRANSPORTATION
OPERATIONS PROGRAM MANAGEMENT UNIT - MAPPING SECTION
IN COOPERATION WITH THE
U.S. DEPARTMENT OF TRANSPORTATION
FEDERAL HIGHWAY ADMINISTRATION

SCALE

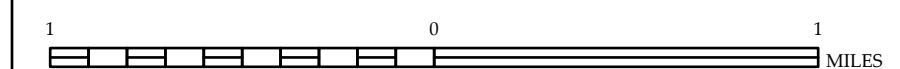

NORTH CAROLINA PLANE COORDINATE SYSTEM
LAMBERT CONFORMAL CONIC PROJECTION

TERMS OF USE: The Mapping Section's goal is to provide the most accurate and current information possible. Map data is compiled from various sources, including aerial photography, ground surveys, and other reliable sources. The North Carolina Department of Transportation and its contractors make no warranty, expressed or implied, for the use of this map data for purposes other than those intended. The user assumes all liability for any errors or omissions in the map data. This map data is not to be used for navigation purposes. For digital copies of this map or additional map products, visit www.ncdot.gov or call 1-800-368-7828.

COPIES OF THIS MAP ARE AVAILABLE TO THE PUBLIC. FOR MORE INFORMATION, CONTACT US AT: FRANKLIN COUNTY, NORTH CAROLINA
FRANKLIN COUNTY, NORTH CAROLINA
FRANKLIN COUNTY, NORTH CAROLINA
FRANKLIN COUNTY, NORTH CAROLINA

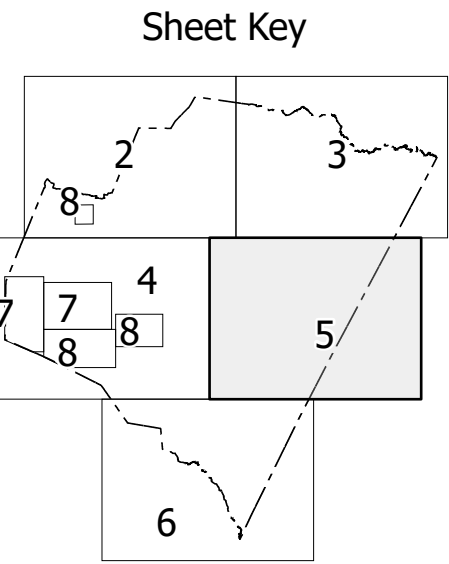
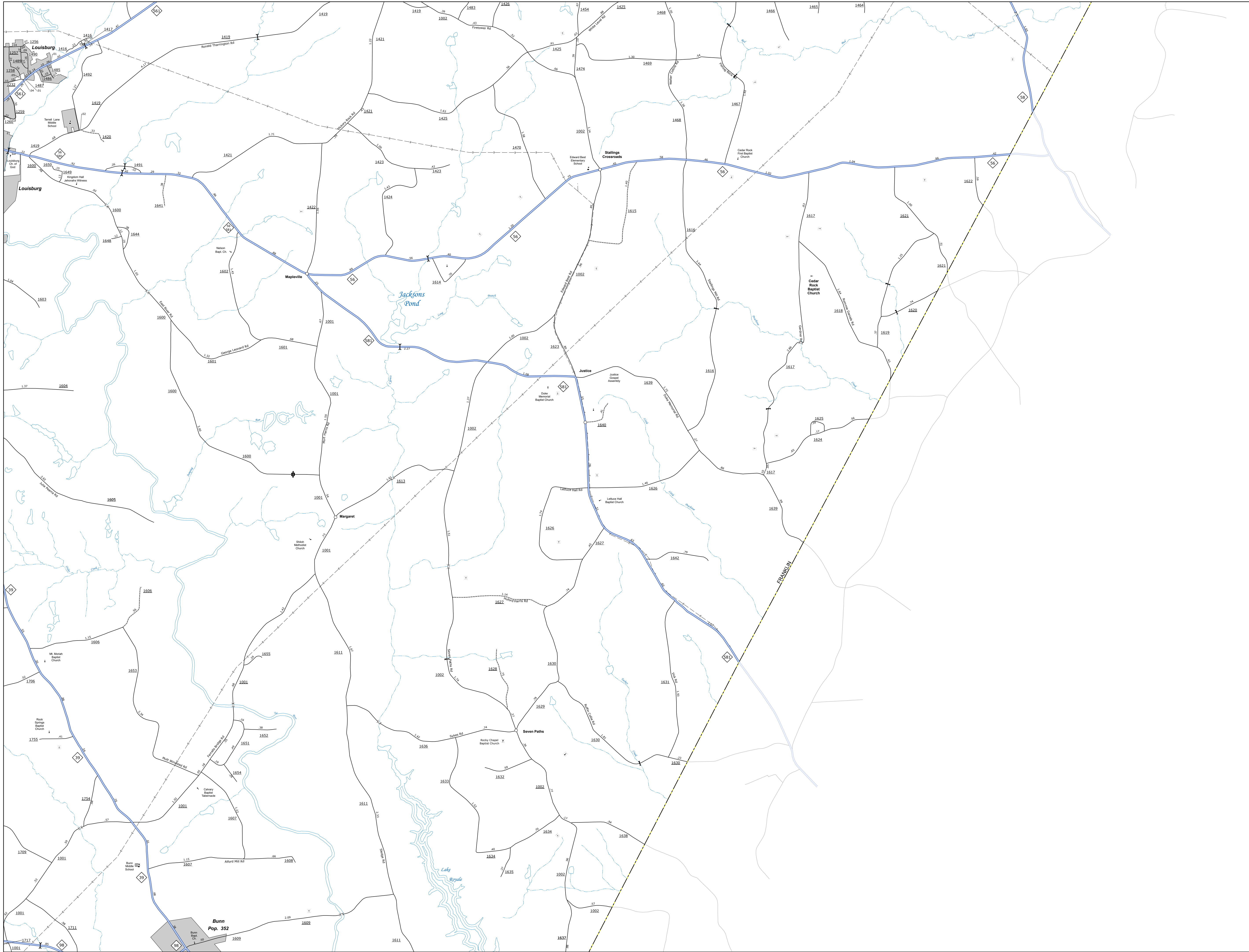

- LEGEND**
- INTERSTATE US NC
 - Blue Ridge Parkway
 - Divided Hwy
 - Undivided Hwy
 - Unimproved Road
 - Hard Surface Road
 - Non-System Road
 - Provisionally Driveway Road
 - Protected Location
 - Intersection Proximity
 - Standard Road Bridge
 - Railroad Bridge
 - Draw Span on Bridge
 - Pedestrian Bridge
 - Pedestrian Walkway
 - Vehicle Underpass
 - Tunnel
 - Culvert
 - Wye
 - Interstate Highway
 - U.S. Numbered Highway
 - U.S. Numbered Highway
 - U.S. Numbered Bicycle Route
 - U.S. Numbered Bicycle Route
 - Interstate Interchange Number
 - Secondary Road Number
 - Utility Lines
 - Railroad Line
 - Railroad Station
 - Inset Area
 - State Line
 - County Line
 - City Limits
 - Ferry Route
 - Narrow Creek or Stream
 - Wide River or Creek
 - Reservoir, Pond or Lake w/ Island
 - Dam or Dam with Lock
 - Waterfall
 - Swamp
 - Community, Town or City Center
 - County Seat
 - School
 - College or University
 - Hospital
 - Coast Guard Station
 - Church
 - Church with Cemetery
 - Cemetery
 - Post Office
 - Correctional or Penal Institution
 - Quarry
 - Wind or P.T.
 - Highway Garage or Maint. Yard
 - Highway Div. or Dist. Office
 - Military Post
 - Weather Station
 - Fire Station
 - Historical Site
 - Point of Interest
 - State Forest
 - Light House
 - Mountain Summit
 - Overlook
 - Rest Area
 - Visitor Center Area
 - Welcome Center Area
 - Airport
 - Military Airport
 - Helipad
 - National State Forest Boundary
 - Wildlife Refuge
 - National State Park Boundary
 - Game Lands Boundary
 - Military Reservation Boundary
 - Indian Reservation Boundary

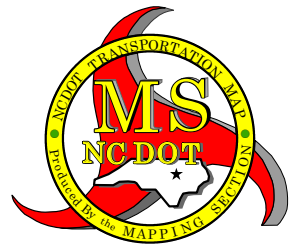

FRANKLIN COUNTY NORTH CAROLINA

PREPARED BY THE
NORTH CAROLINA DEPARTMENT OF TRANSPORTATION
OPERATIONS PROGRAM MANAGEMENT UNIT - MAPPING SECTION
IN COOPERATION WITH THE
U.S. DEPARTMENT OF TRANSPORTATION
FEDERAL HIGHWAY ADMINISTRATION

SCALE

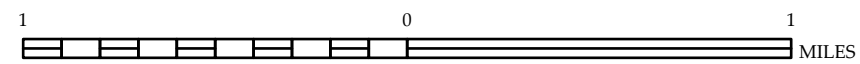

NORTH CAROLINA PLANE COORDINATE SYSTEM
LAMBERT CONFORMAL CONIC PROJECTION

TERMS OF USE: The Mapping Section's goal is to provide the most accurate and current information possible. Map data is compiled from various sources, including aerial photography, ground surveys, and other data. The North Carolina Department of Transportation and the U.S. Department of Transportation are not responsible for any errors in this map. This map is provided as a guide only and should not be used for legal purposes. For digital copies of this map, visit www.ncdot.gov.

COPIES OF THIS MAP ARE AVAILABLE TO THE PUBLIC. FOR MORE INFORMATION, CONTACT US AT: publicinformation@ncdot.gov OR 1-800-368-3343. THIS MAP IS NOT A CONTRACT.

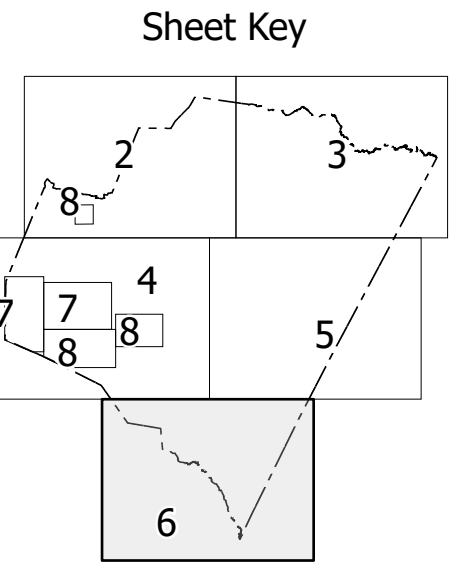
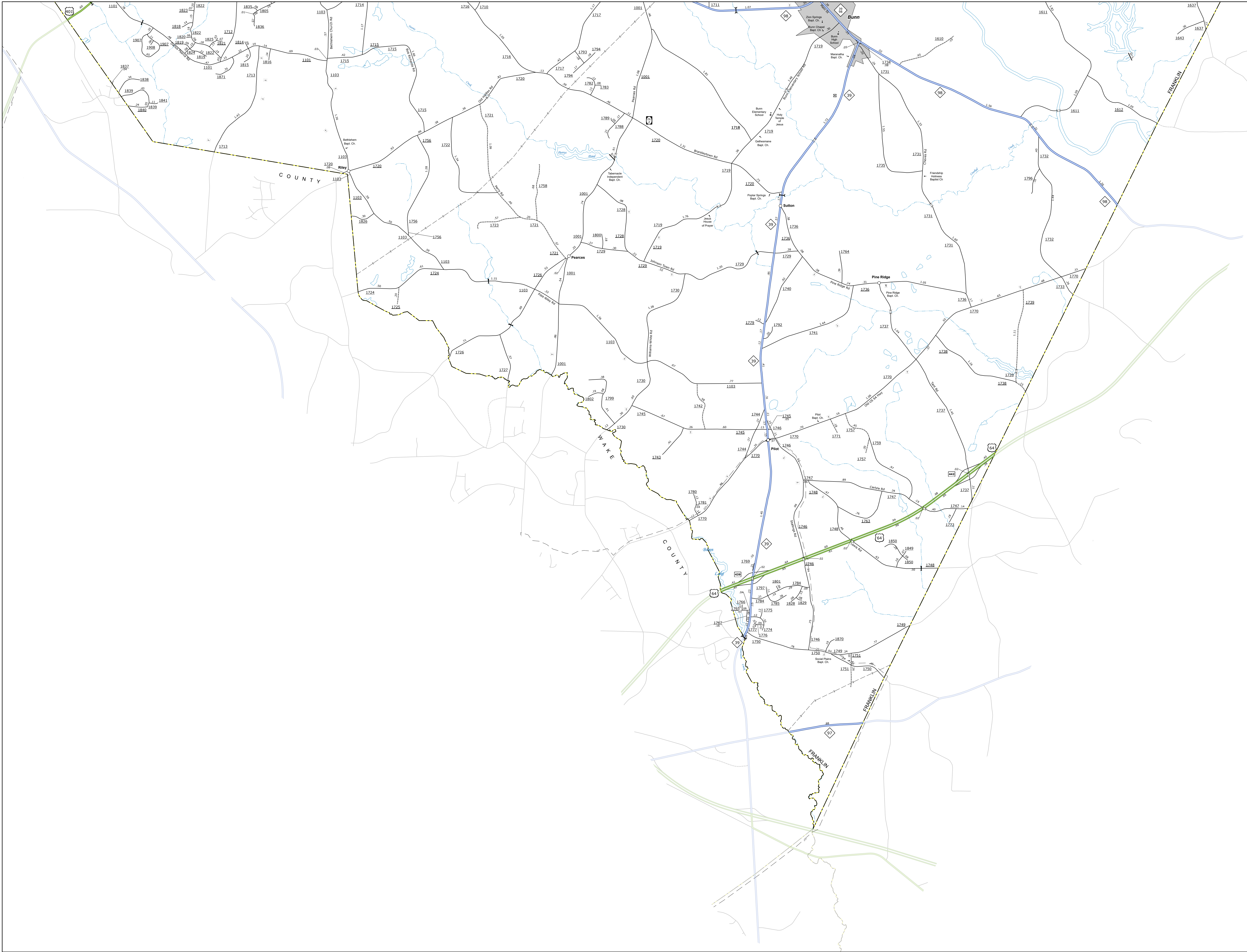

- LEGEND**
- INTERSTATE US NC Divided Hwy Undivided Hwy
 - BLUE RIDGE PARKWAY
 - UNIMPROVED/UNPAVED ROAD
 - HARD SURFACED ROAD
 - NON-SYSTEM ROAD
 - PROPOSEDLY DRAINAGE ROAD
 - PROJECTED LOCATION
 - INTERSECTION/INTERCHANGE
 - STANDARD ROAD BRIDGE
 - RAILROAD BRIDGE
 - DRAW SPAN ON BRIDGE
 - PEDESTRIAN BRIDGE
 - PEDESTRIAN WALKWAY
 - PEDESTRIAN UNDERPASS
 - VEHICULAR UNDERPASS
 - TUNNEL
 - CULVERT
 - WYE
 - INTERSTATE HIGHWAY
 - U.S. NUMBERED HIGHWAY
 - U.S. NUMBERED HIGHWAY
 - U.S. NUMBERED BI-CYCLE ROUTE
 - N.C. NUMBERED BI-CYCLE ROUTE
 - INTERSTATE INTERCHANGE NUMBER
 - SECONDARY ROAD NUMBER
 - UTILITY LINES
 - RAILROAD LINE
 - RAILROAD STATION
 - INSET AREA
 - STATE LINE
 - COUNTY LINE
 - CITY LIMITS
 - FERRY ROUTE
 - NARROW CREEK OR STREAM
 - WIDE RIVER OR CREEK
 - RESERVOIR, POND OR LAKE W/ ISLAND
 - DAM OR DAM WITH LOCK
 - WATERFALL
 - SWAMP
 - COMMUNITY, TOWN OR CITY CENTER
 - COUNTY SEAT
 - SCHOOL
 - COLLEGE OR UNIVERSITY
 - HOSPITAL
 - COAST GUARD STATION
 - CHURCH
 - CHURCH WITH CEMETERY
 - CEMETERY
 - POLICE STATION
 - CORRECTION OR PENAL INSTITUTION
 - QUARRY
 - WIND OR PET
 - HIGHWAY GARAGE OR MAINT. YARD
 - ROADWAY DIV. OR DIST. OFFICE
 - MILITARY POST
 - WEIGH STATION
 - HAZARDOUS
 - HISTORICAL SITE
 - POINT OF INTEREST
 - STATE FOREST
 - LIGHT HOUSE
 - MOUNTAIN SUMMIT
 - OVERLOOK
 - REST AREA
 - VISITOR CENTER AREA
 - WELCOME CENTER AREA
 - AIRPORT
 - MILITARY AIRPORT
 - WEL-PORT
 - NATIONAL STATE FOREST BOUNDARY
 - WILDLIFE REFUGE
 - NATIONAL STATE PARK BOUNDARY
 - GAME LANDS BOUNDARY
 - MILITARY RESERVATION BOUNDARY
 - INDIAN RESERVATION BOUNDARY



FRANKLIN COUNTY NORTH CAROLINA

PREPARED BY THE
NORTH CAROLINA DEPARTMENT OF TRANSPORTATION
OPERATIONS PROGRAM MANAGEMENT UNIT - MAPPING SECTION
IN COOPERATION WITH THE
U.S. DEPARTMENT OF TRANSPORTATION
FEDERAL HIGHWAY ADMINISTRATION

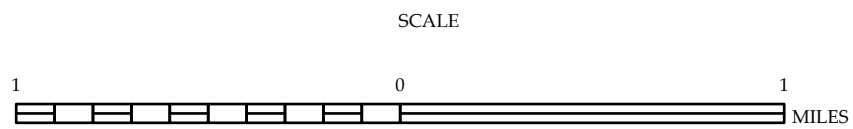

NORTH CAROLINA PLANE COORDINATE SYSTEM
LAMBERT CONFORMAL CONIC PROJECTION

TERMS OF USE: The Mapping Section's goal is to provide the most accurate and current information possible. Map data is compiled from numerous sources with varying degrees of accuracy and map accuracy standards. As a result, the accuracy, currency, and completeness of the information shown on this map cannot be guaranteed. This information is provided for informational purposes only and should not be used for any purpose other than that for which it was intended. The information shown on this map was last updated in July 2024.

COPIES OF THIS MAP ARE AVAILABLE TO THE PUBLIC AT NO CHARGE. CONTACT US TO ORDER: FRANKLIN COUNTY, NORTH CAROLINA
10000 STATE STREET, SUITE 100, FARMVILLE, NC 27834
(704) 771-0400

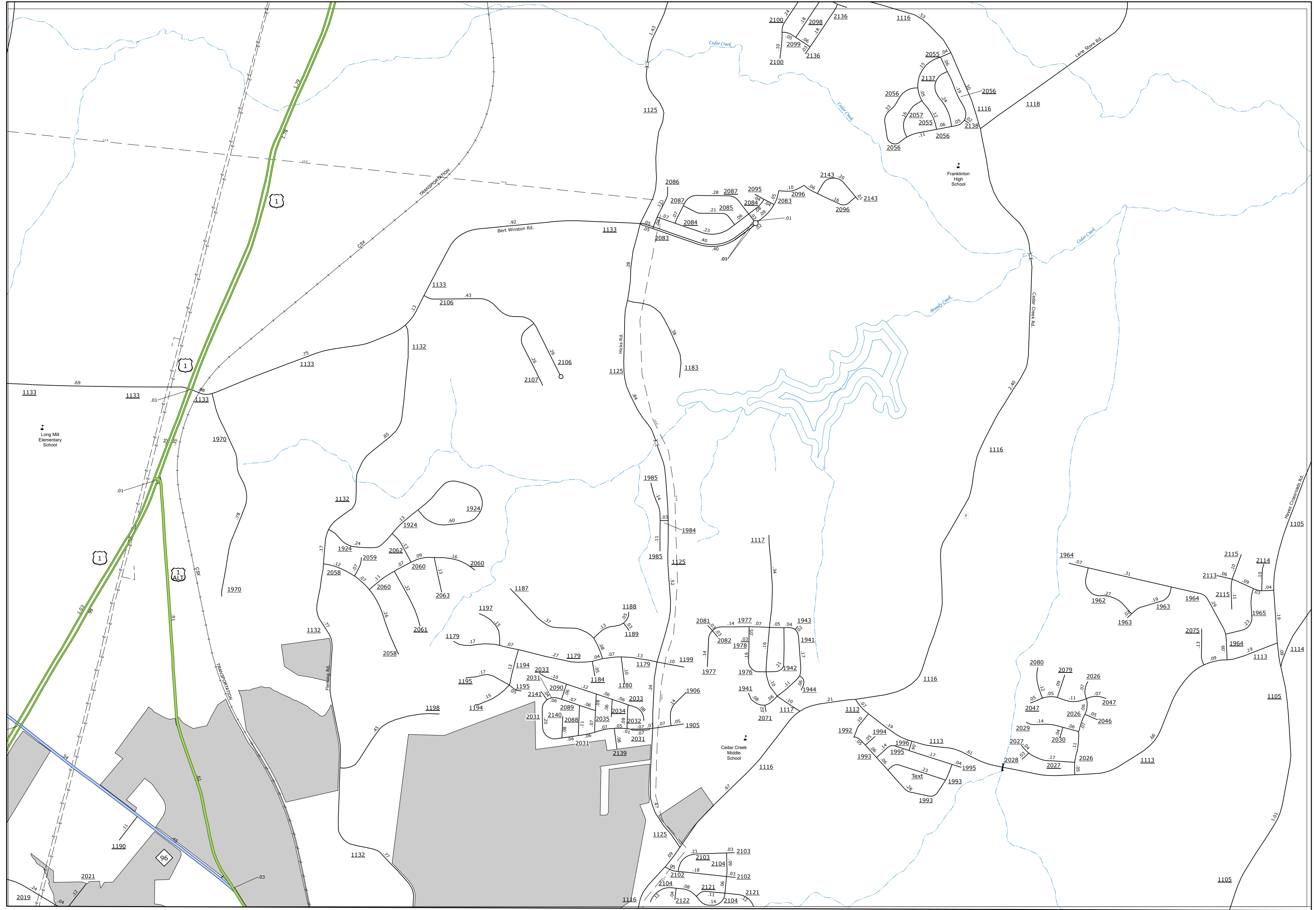
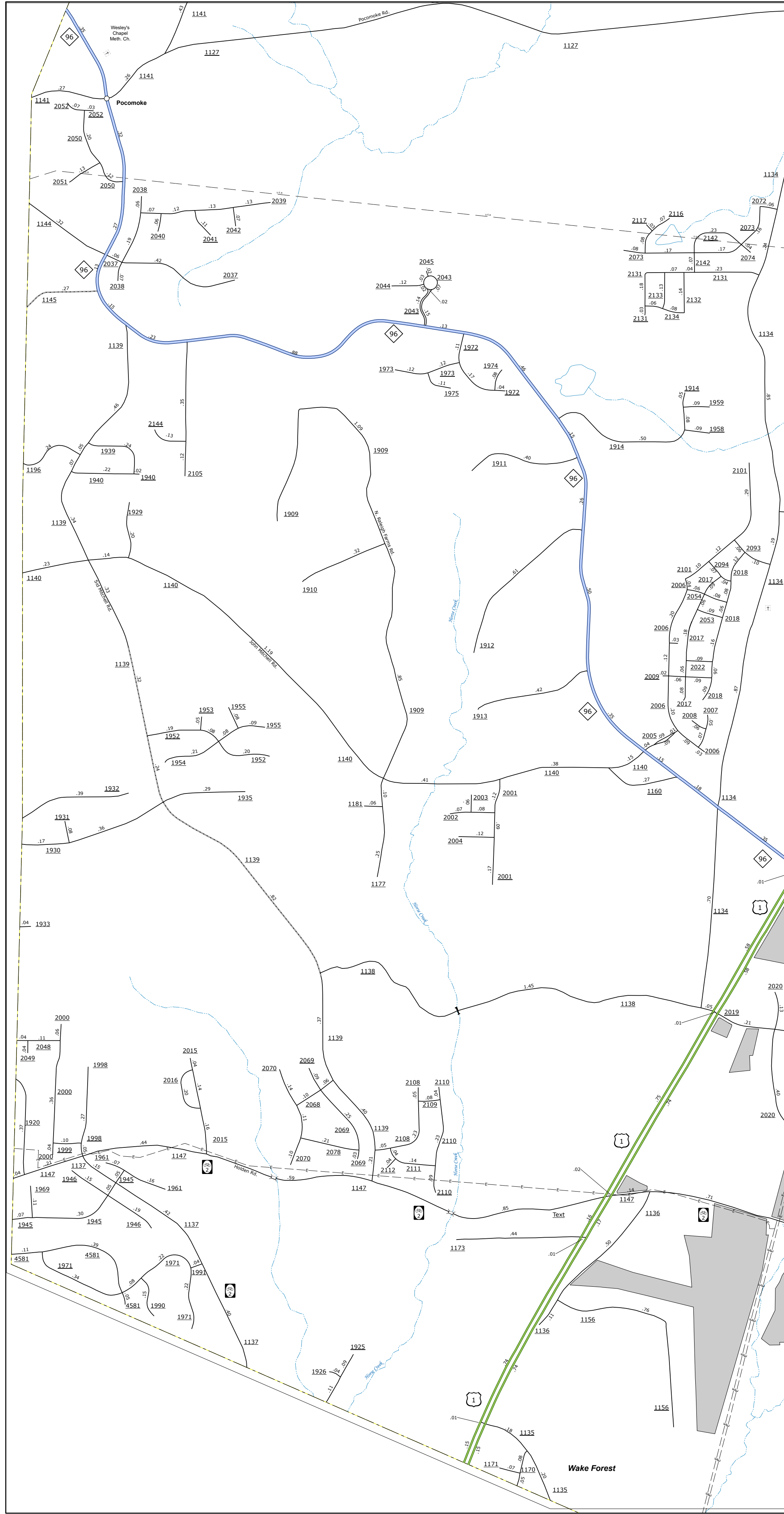

Sheet Key

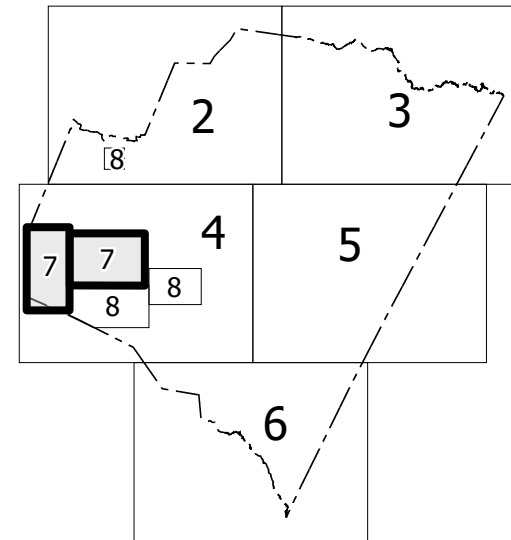

FRANKLIN COUNTY NORTH CAROLINA

PREPARED BY THE
NORTH CAROLINA DEPARTMENT OF TRANSPORTATION
OPERATIONS PROGRAM MANAGEMENT UNIT - MAPPING SECTION
IN COOPERATION WITH THE
U.S. DEPARTMENT OF TRANSPORTATION
FEDERAL HIGHWAY ADMINISTRATION
SCALE

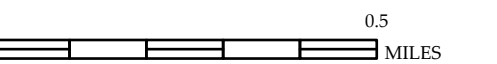

NORTH CAROLINA PLANE COORDINATE SYSTEM
LAMBERT CONFORMAL CONIC PROJECTION

COPIES OF THIS MAP ARE AVAILABLE TO THE
PUBLIC AT NOMINAL COST. CONTACT US TO ORDER:
mapping.support@ncdot.gov
<https://connect.ncdot.gov/resources/State-Mapping/Pages/Order-Maps.aspx>
(919) 834-8480

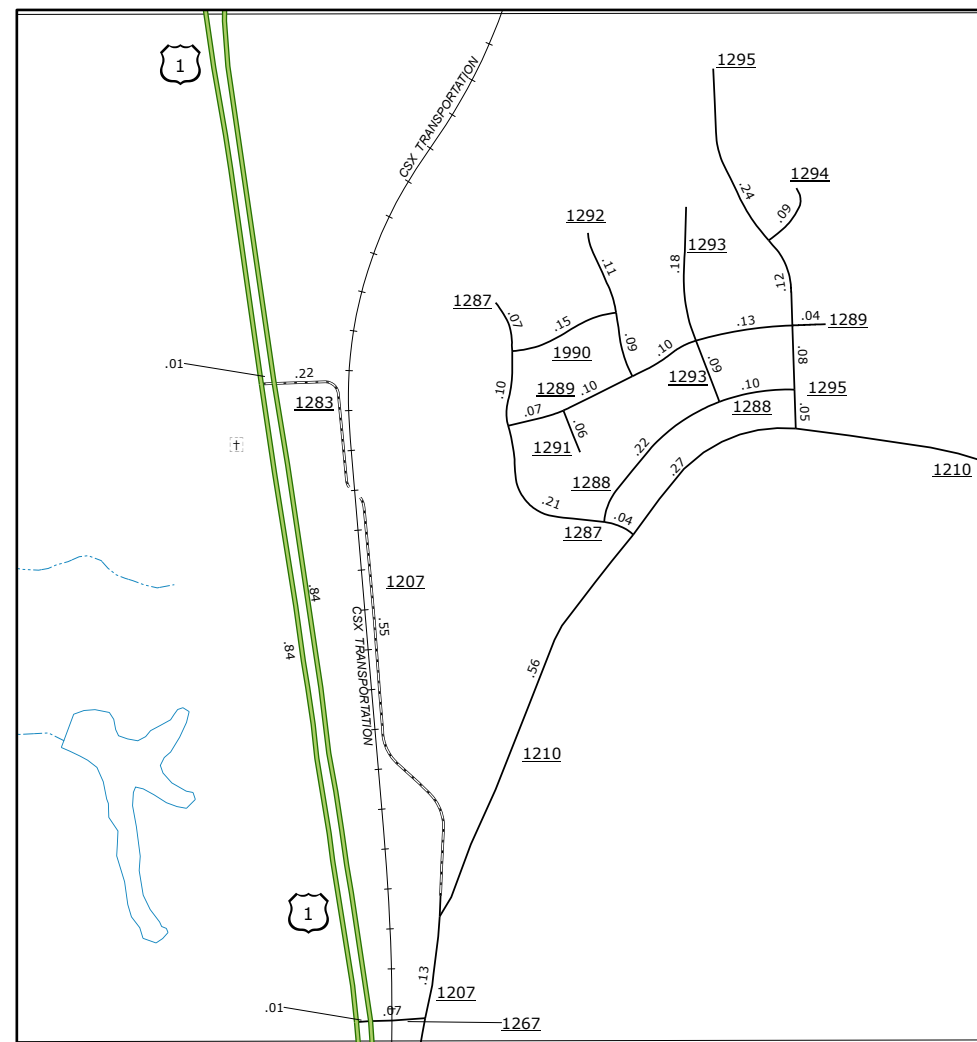
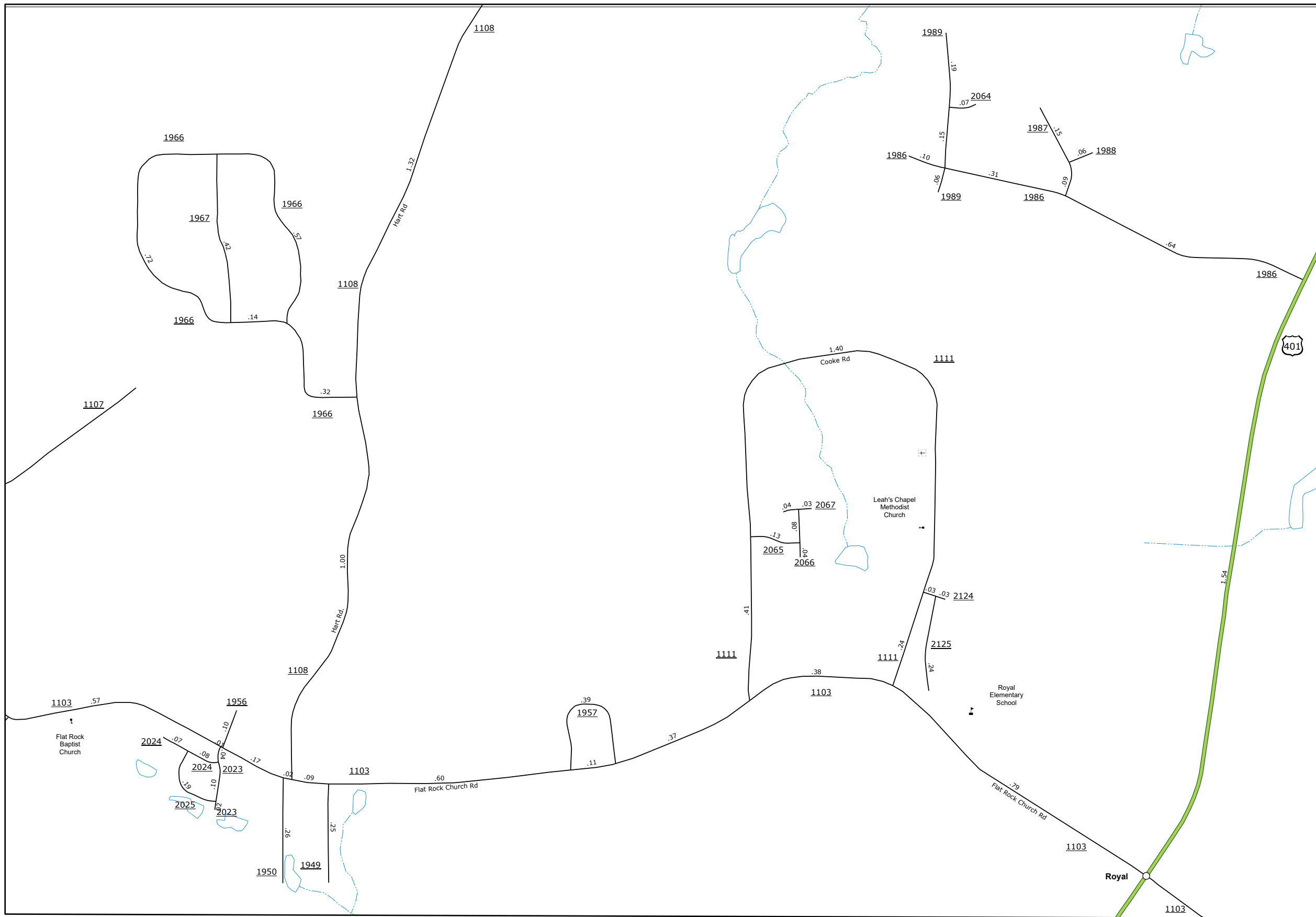
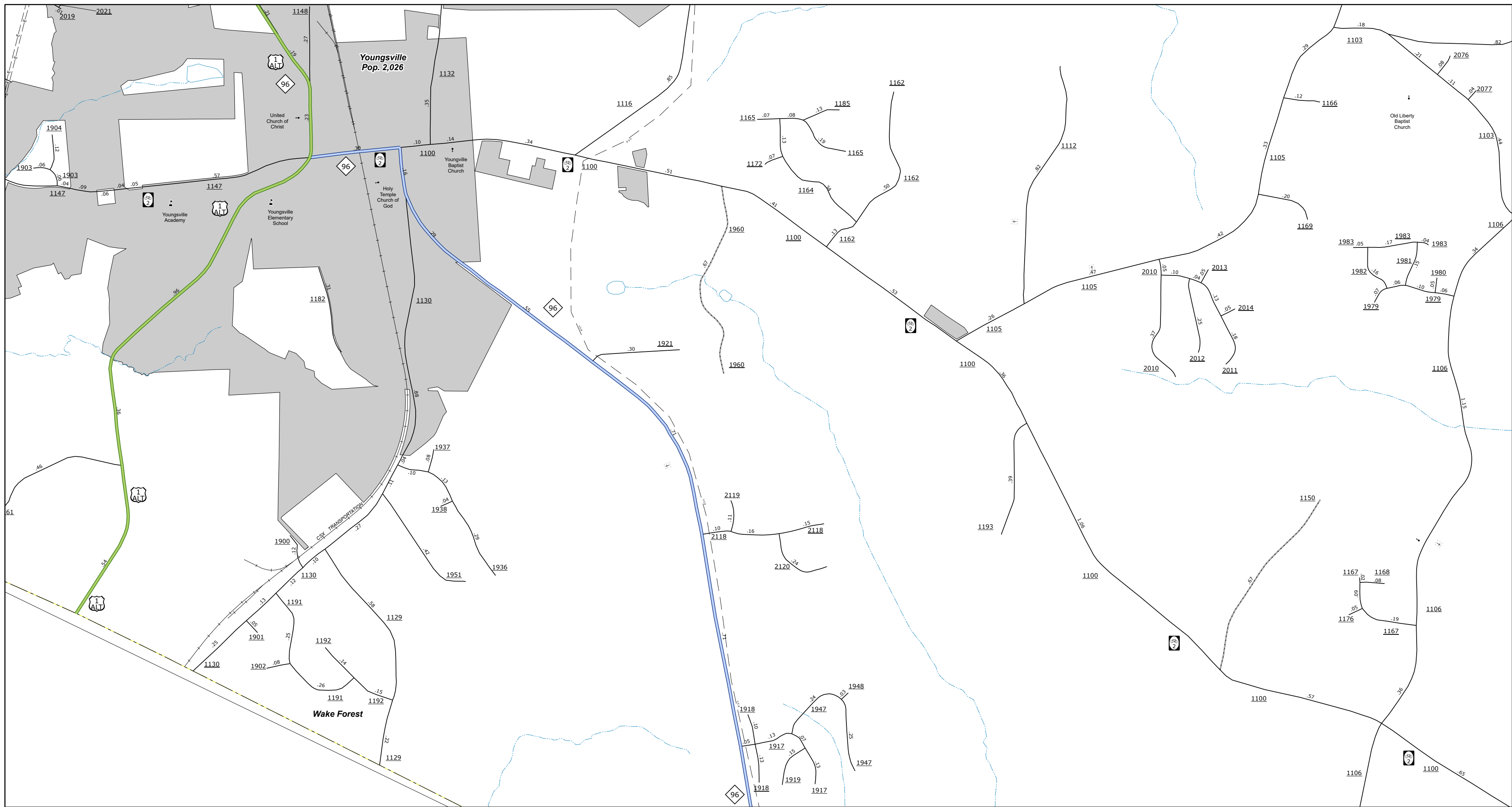

- [illegible]



FRANKLIN COUNTY
NORTH CAROLINA

PREPARED BY THE
NORTH CAROLINA DEPARTMENT OF TRANSPORTATION
OPERATIONS PROGRAM MANAGEMENT UNIT - MAPPING SECTION
IN COOPERATION WITH THE
U.S. DEPARTMENT OF TRANSPORTATION
FEDERAL HIGHWAY ADMINISTRATION

SCALE

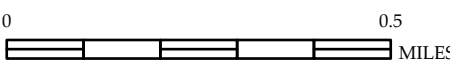

NORTH CAROLINA PLANE COORDINATE SYSTEM
LAMBERT CONFORMAL CONIC PROJECTION