

The Mapping Section's goal is to provide the most accurate and current information possible. Map data is compiled from numerous sources including aerial photography, ground surveys, and other data. As a result, the accuracy of the map cannot be guaranteed. The map is provided as a guide only. For more information, visit <http://www.ncdot.gov/travel/infomapping/> and click on Data Providers or contact us by phone at (919) 855-9440.

COPIES OF THIS MAP ARE AVAILABLE  
FOR PURCHASE AT A PUBLIC AT NOMINAL COST.  
ADDRESS: NORTH CAROLINA DEPARTMENT OF TRANSPORTATION  
MAILING: NORTH CAROLINA DEPARTMENT OF TRANSPORTATION  
4809 BERRY LANE  
Raleigh, NC 27609

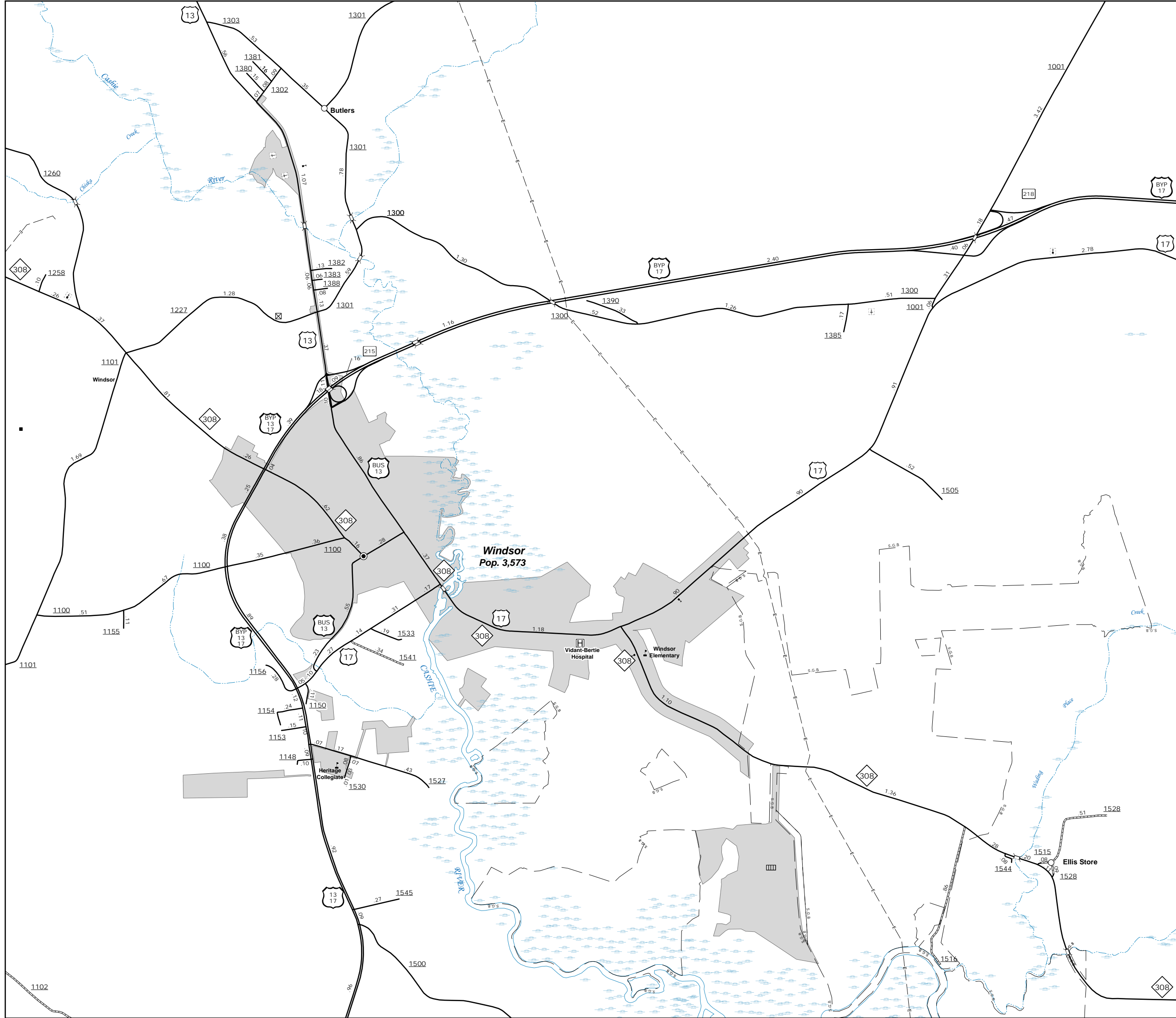

WINDSOR

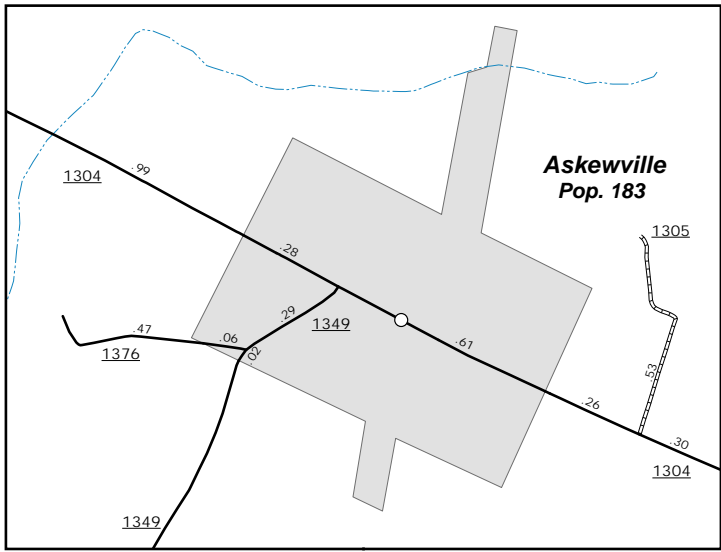

Askewville

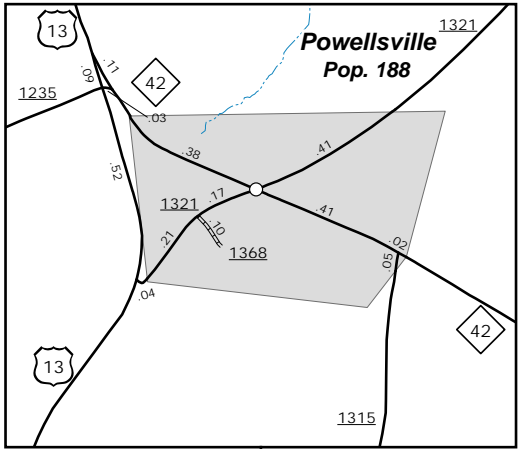

Powellsville

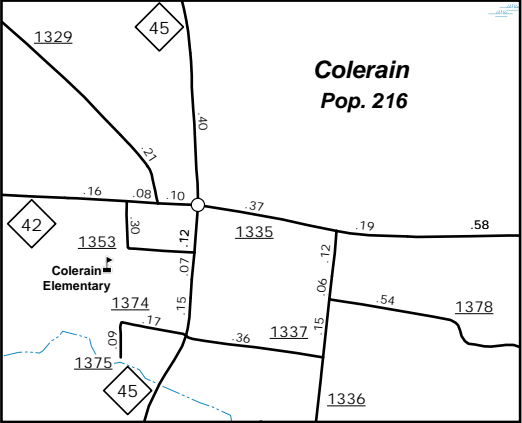

Colrain

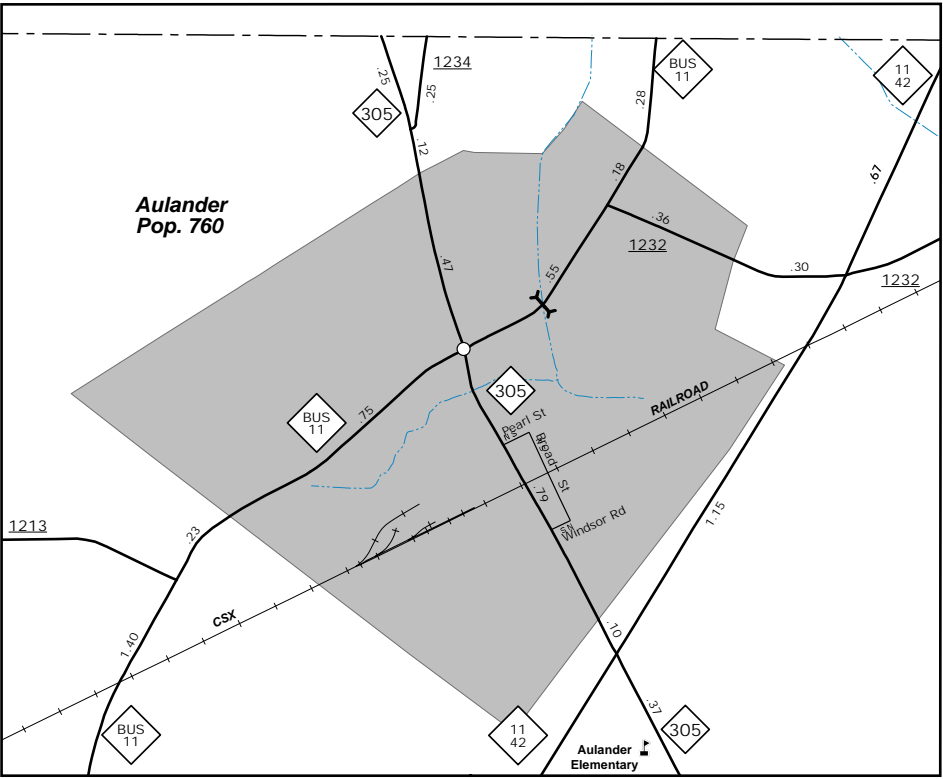

Aulander

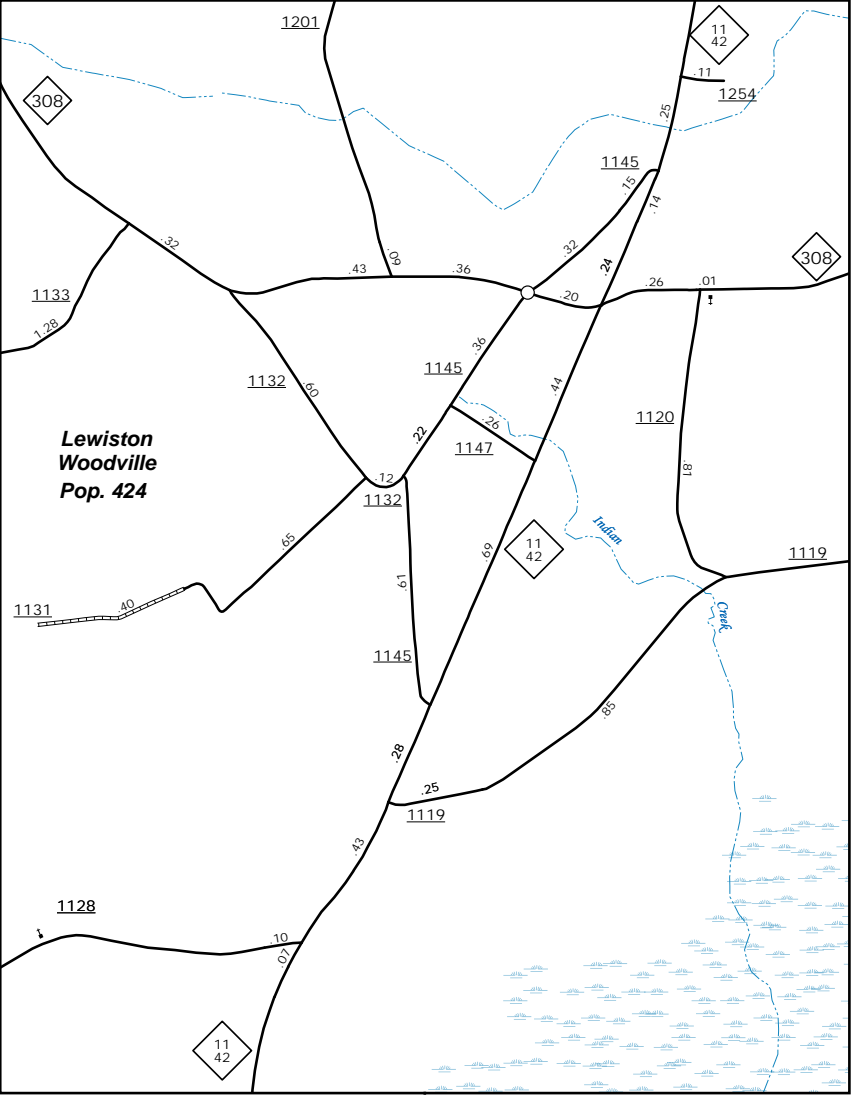

Lewiston Woodville

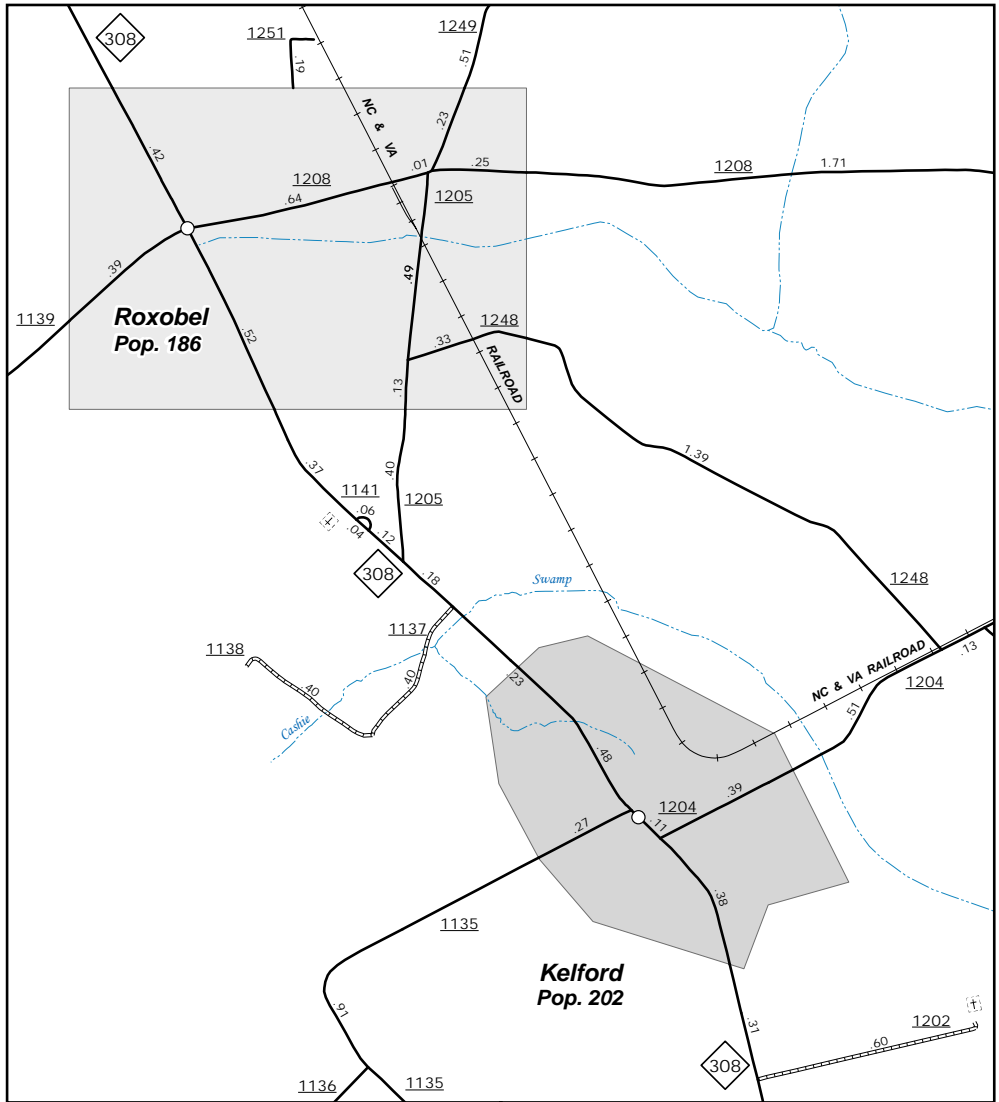

Roxobel and Kelford



ENLARGED MUNICIPAL AND SUBURBAN AREAS

## BERTIE COUNTY NORTH CAROLINA

PREPARED BY THE  
NORTH CAROLINA DEPARTMENT OF TRANSPORTATION  
OPERATIONS PROGRAM MANAGEMENT UNIT - MAPPING SECTION  
IN COOPERATION WITH THE  
U.S. DEPARTMENT OF TRANSPORTATION  
FEDERAL HIGHWAY ADMINISTRATION



10,000 FOOT GRID BASED ON NORTH CAROLINA PLANE COORDINATE SYSTEM  
LAMBERT CONFORMAL CONIC PROJECTION