

The Mapping Section's goal is to provide the most accurate and current information possible. Map data is compiled from numerous sources with varying degrees of accuracy. As a result, the accuracy of the map cannot be guaranteed. For more information on the accuracy of the map, please visit the following website: <http://www.ncdot.gov/transportation/mapping>. For additional information, visit <http://www.ncdot.gov/transportation/mapping>, and click on Data Providers or contact us by phone at (919) 855-6480.

COPIES OF THIS MAP ARE AVAILABLE  
FOR PURCHASE AT A PUBLIC COST.  
ADDRESS: N.C. DEPARTMENT OF TRANSPORTATION  
M&U - MAPPING SECTION  
4809 BERNI RD.  
RALEIGH, NC 27606

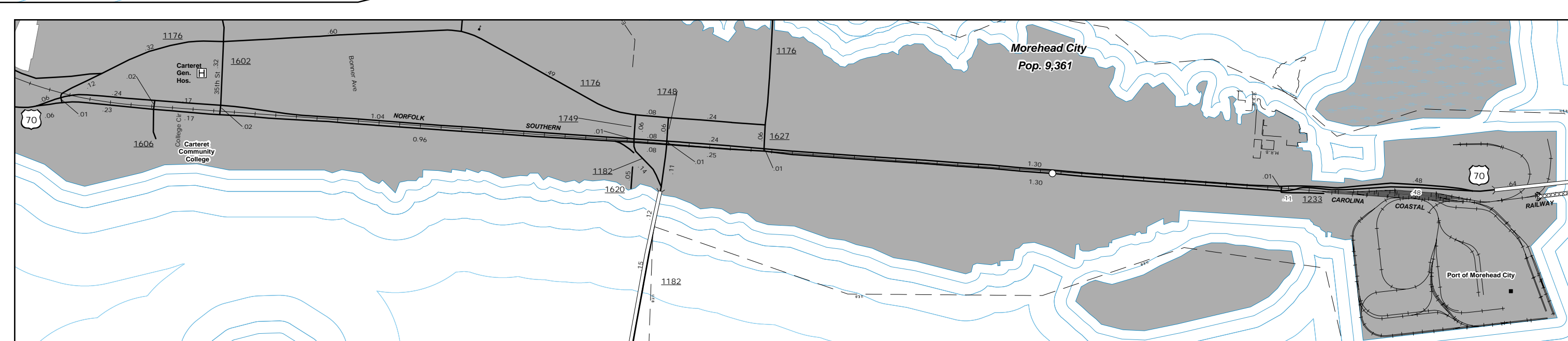
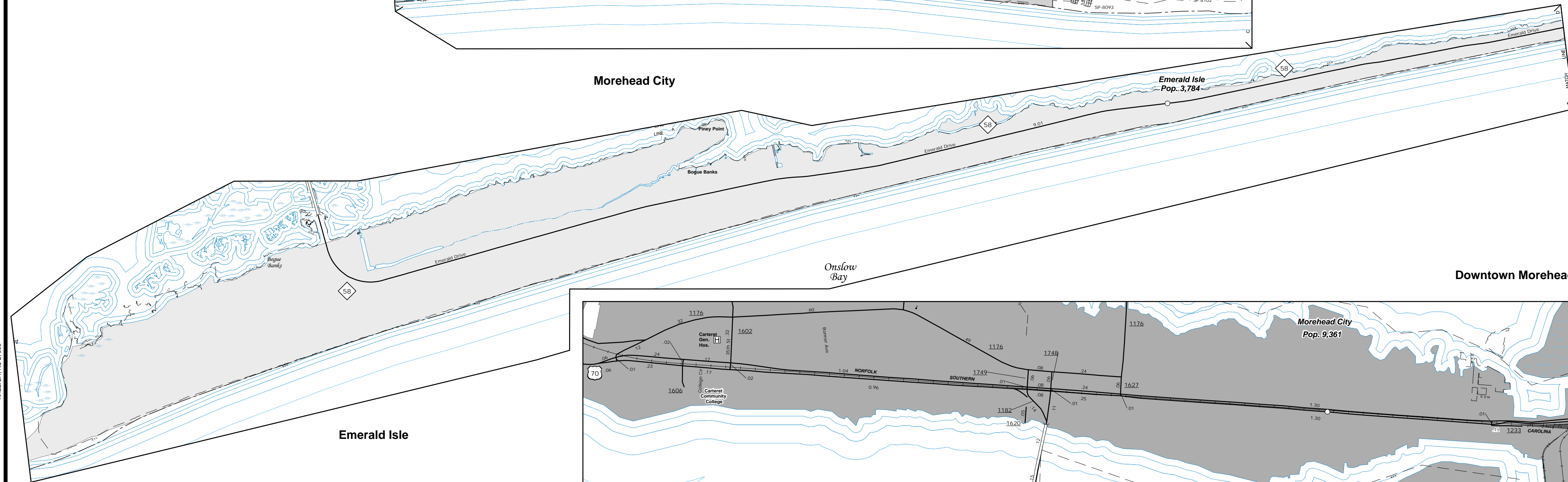
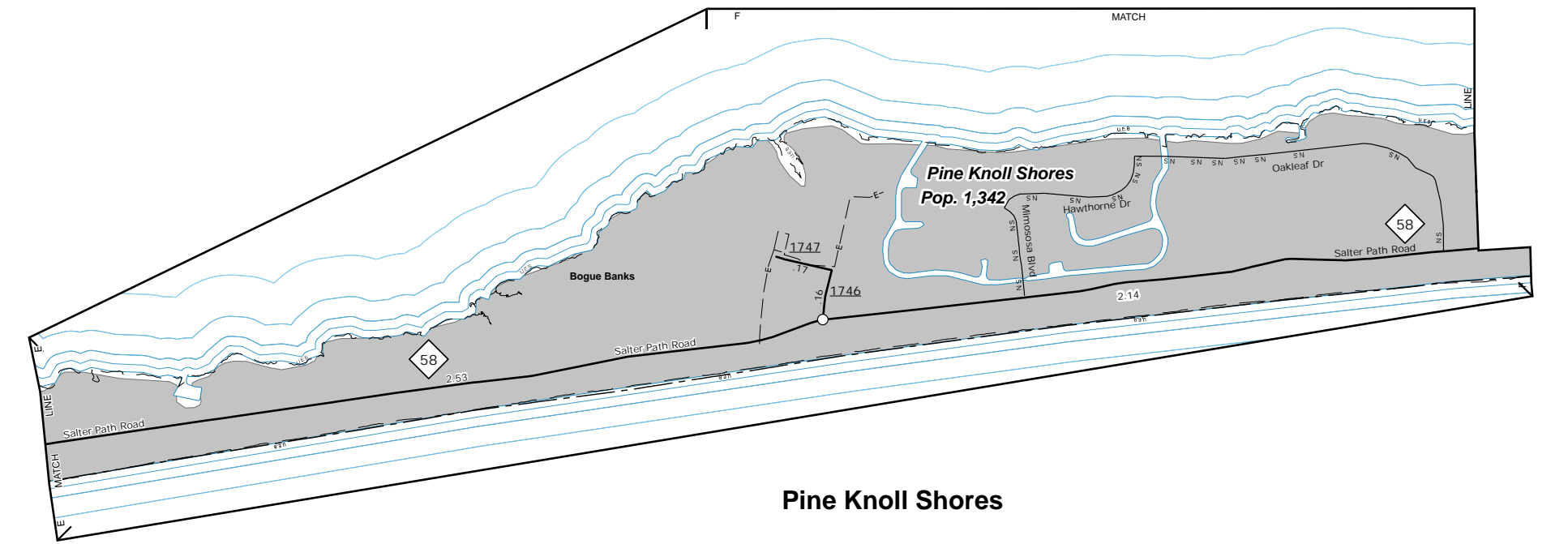
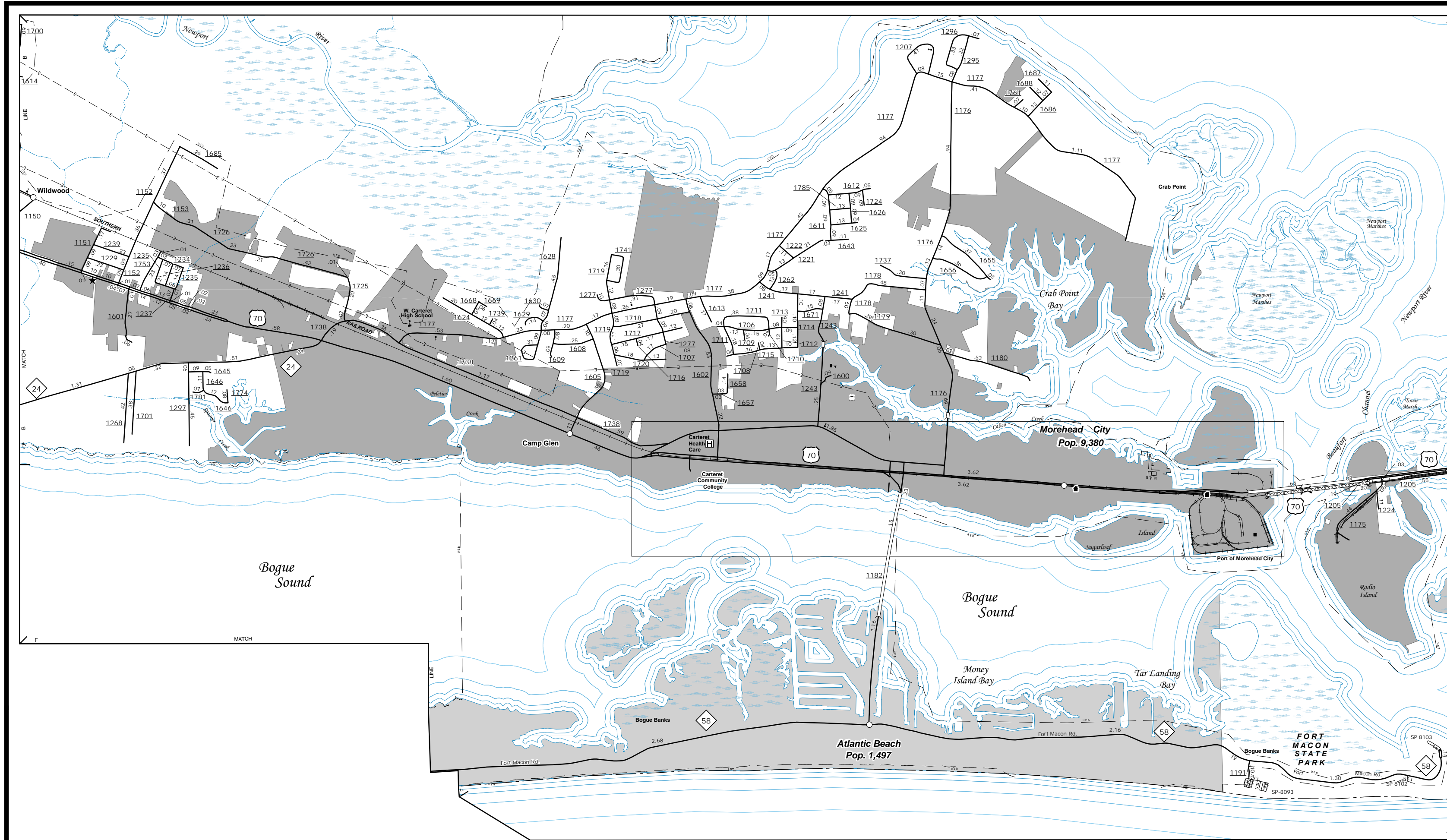

ENLARGED MUNICIPAL AND SUBURBAN AREAS

## CARTERET COUNTY NORTH CAROLINA

PREPARED BY THE  
NORTH CAROLINA DEPARTMENT OF TRANSPORTATION  
OPERATIONS PROGRAM MANAGEMENT UNIT - MAPPING SECTION  
IN COOPERATION WITH THE  
U.S. DEPARTMENT OF TRANSPORTATION  
FEDERAL HIGHWAY ADMINISTRATION

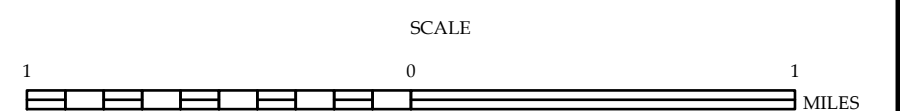

10,000 FOOT GRID BASED ON NORTH CAROLINA PLANE COORDINATE SYSTEM  
LAMBERT CONFORMAL CONIC PROJECTION

SHEET 4 OF 4