

The Mapping Section's goal is to provide the most accurate and current information possible. Map data is compiled from numerous sources with varying bases of data and accuracy. The Mapping Section does not warrant the accuracy or completeness of this information. For additional information, visit <http://www.ncdot.gov/travel/infomaps03a> and click on Data Providers or contact us by phone at (919) 835-8480.

COPIES OF THIS MAP ARE AVAILABLE  
FOR PURCHASE AT A  
REPUBLICAN NOMINAL COST  
ADDRESS:  
N.C. DEPARTMENT OF TRANSPORTATION  
MSAU - MAPPING SECTION  
4809 BERRY LANE  
RALEIGH, NC 27609

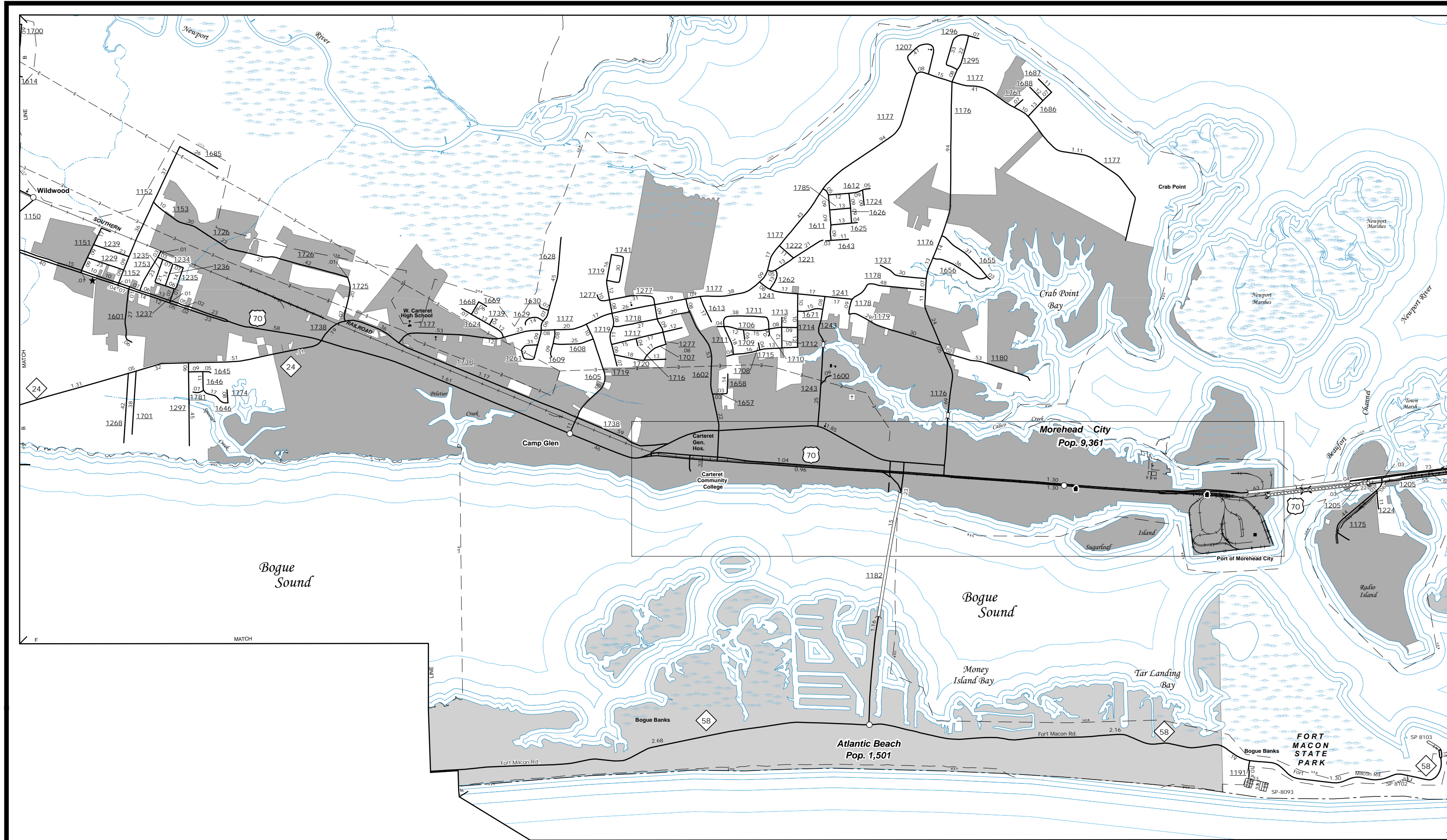

Morehead City

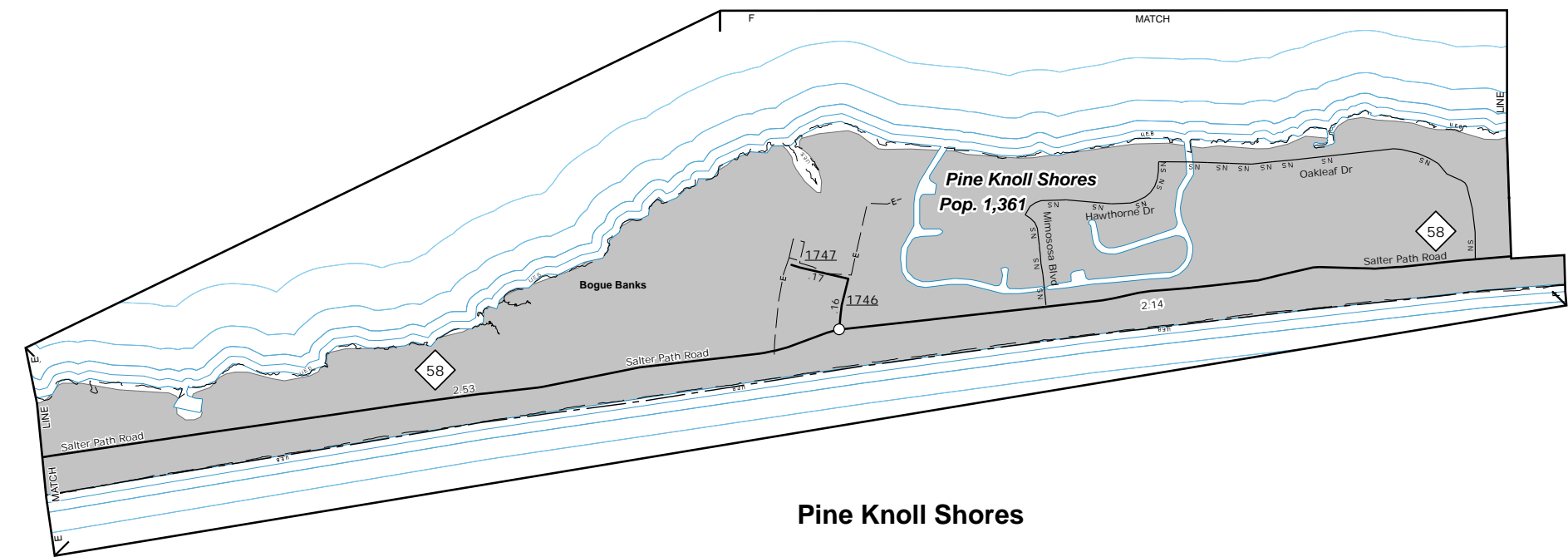

Pine Knoll Shores

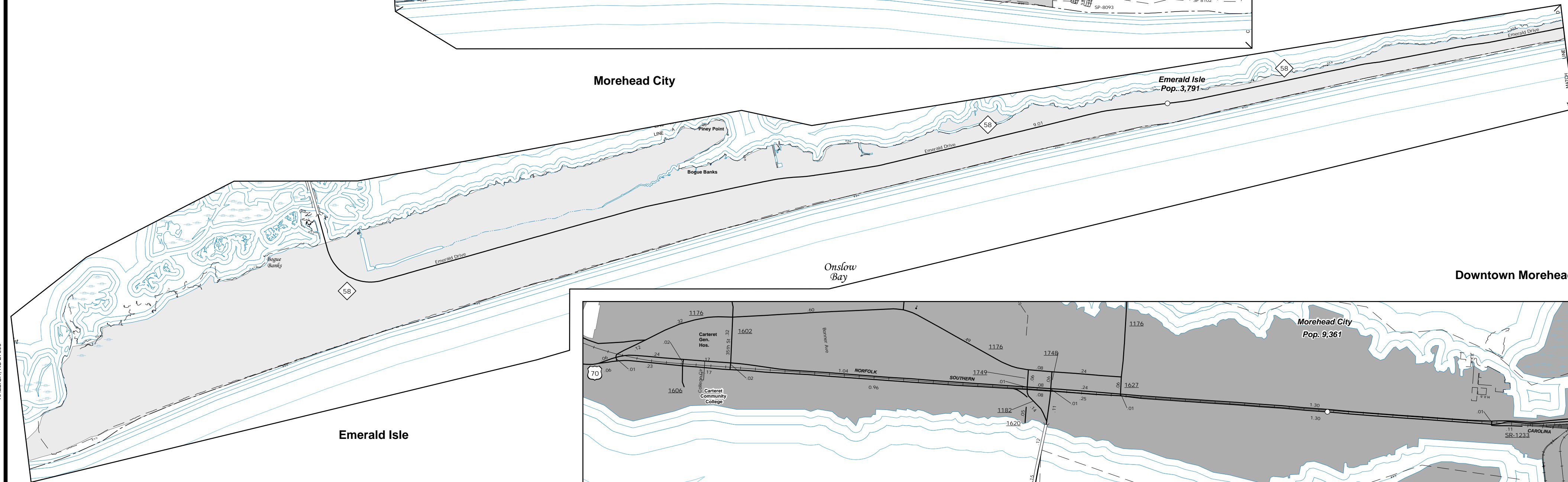

Emerald Isle

Downtown Morehead City

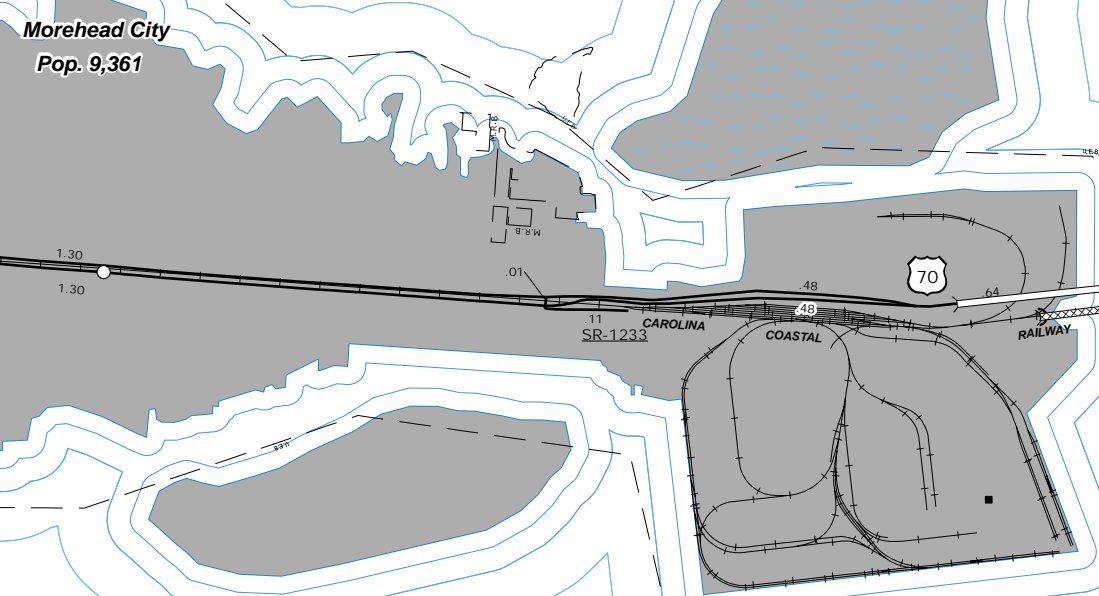
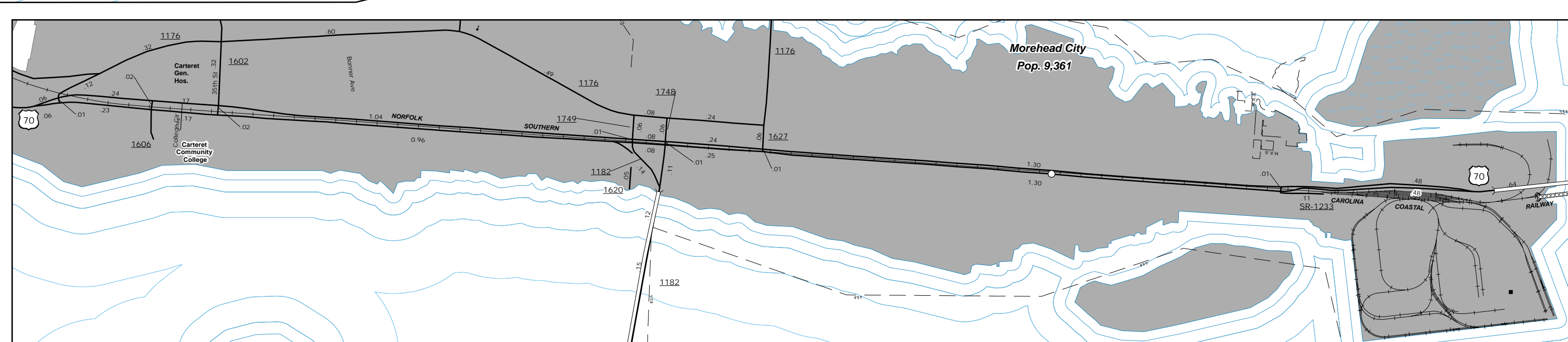

ENLARGED MUNICIPAL AND SUBURBAN AREAS

## CARTERET COUNTY NORTH CAROLINA

PREPARED BY THE  
NORTH CAROLINA DEPARTMENT OF TRANSPORTATION  
MANAGEMENT SYSTEMS AND ASSESSMENTS UNIT - MAPPING SECTION  
IN COOPERATION WITH THE  
U.S. DEPARTMENT OF TRANSPORTATION  
FEDERAL HIGHWAY ADMINISTRATION

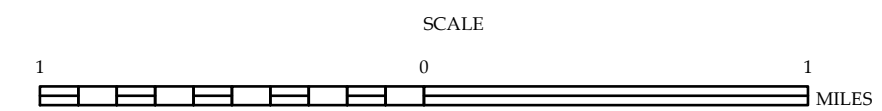

10,000 FOOT GRID BASED ON NORTH CAROLINA PLANE COORDINATE SYSTEM  
LAMBERT CONFORMAL CONIC PROJECTION

SHEET 4 OF 4