

The Mapping Section's goal is to provide the most accurate and current information possible. Map data is compiled from numerous sources with varying degrees of accuracy. Map accuracy standards. As a result, accuracy cannot be guaranteed. The data provided is for informational purposes only. The data is not intended for use in any important non-system roads.

The information shown on this map was last updated in June, 2018. For additional information, visit <http://www.ncdot.gov/travel/infomapping> and click on Data Providers or contact us by phone at (819) 830-8480.

COPIES OF THIS MAP ARE AVAILABLE
FOR PURCHASE AT A PUBLIC AT NOMINAL COST.
ADDRESS: N.C. DEPARTMENT OF TRANSPORTATION
MAILING: N.C. DEPARTMENT OF TRANSPORTATION
4809 BERTIE RD.
RAVENEL, NC 28385



WINDSOR

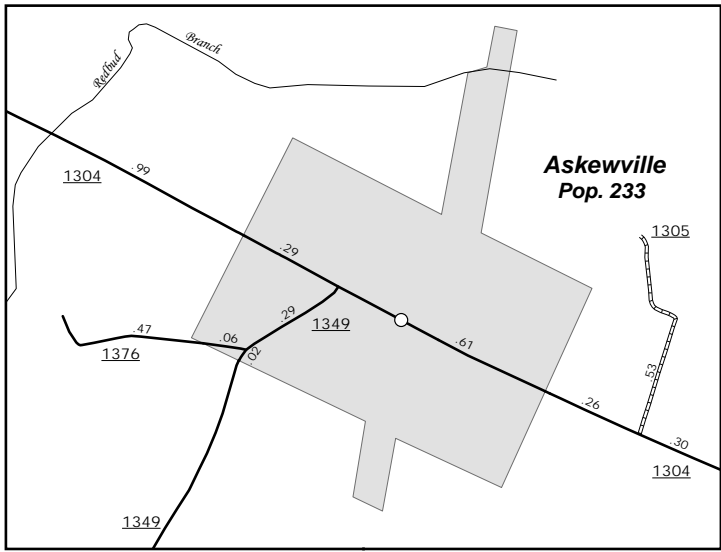

Askewville

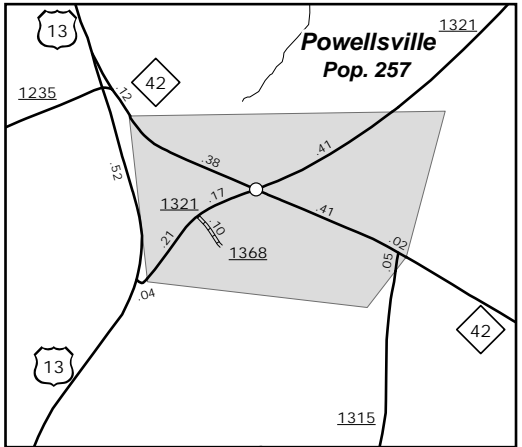

Powellsville

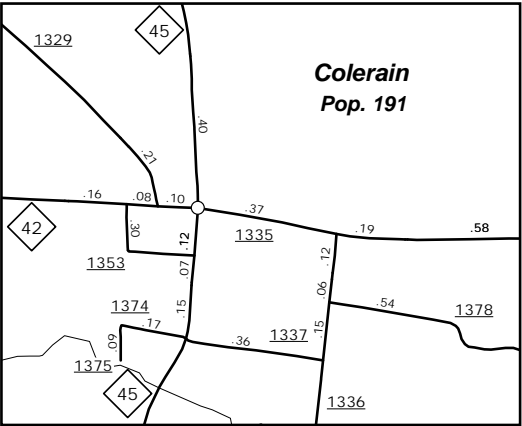

Colrain

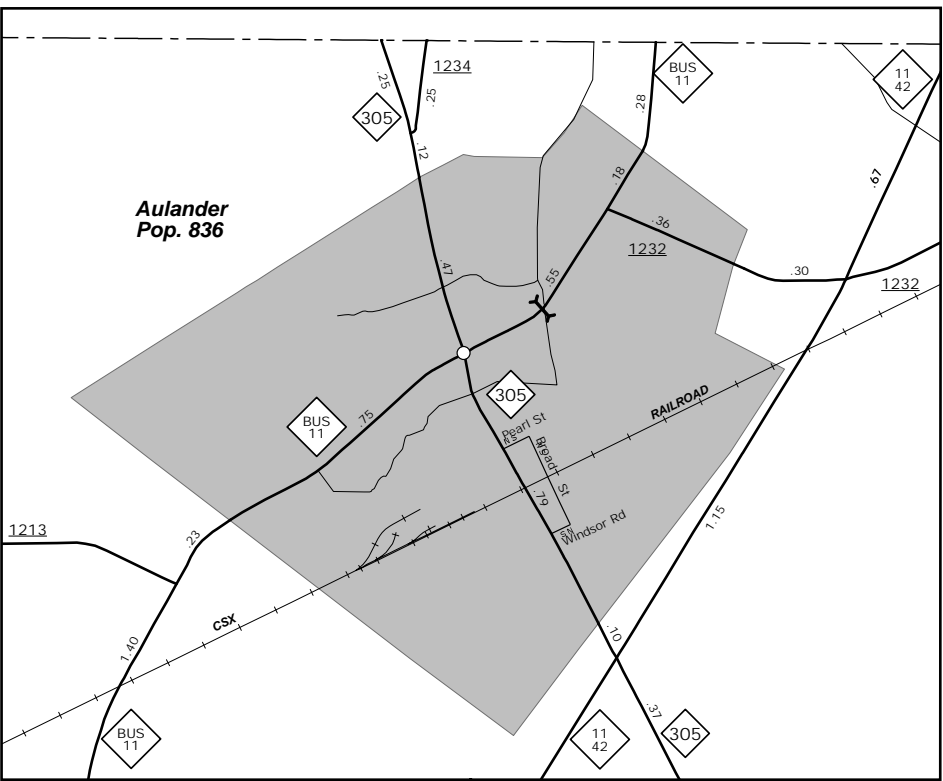

Aulander

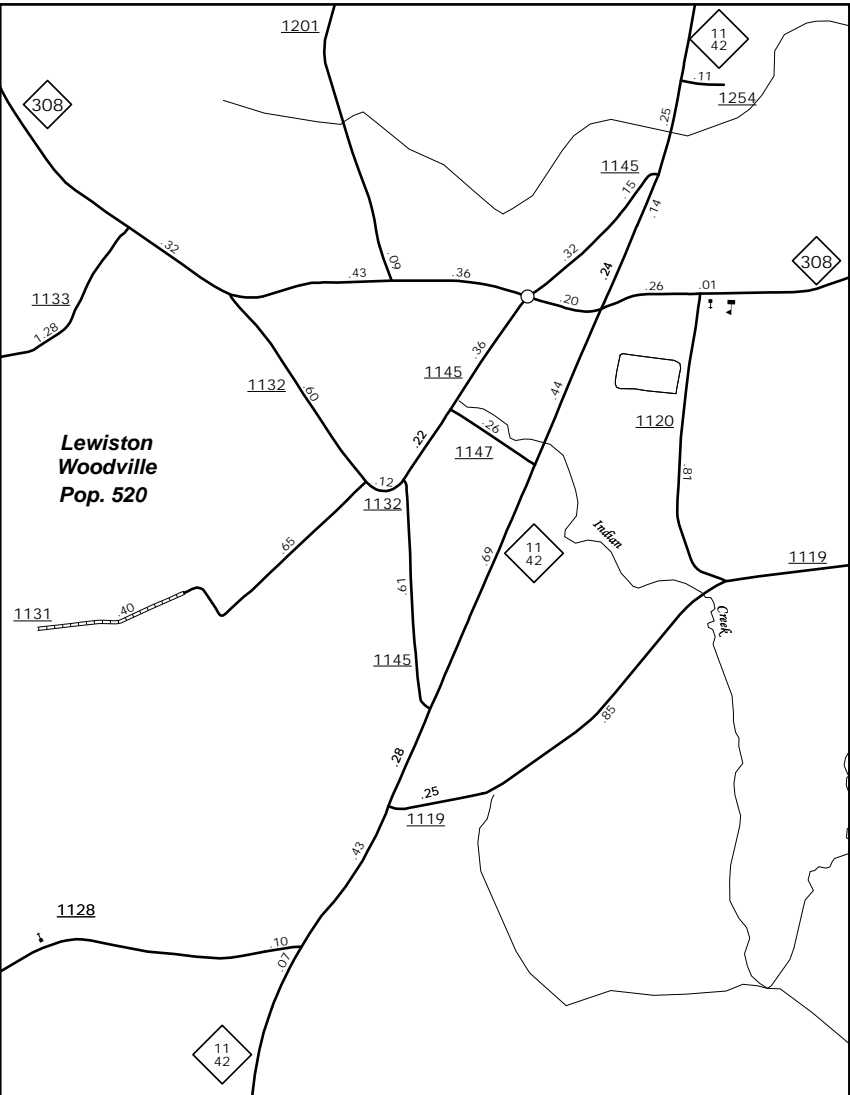

Lewiston Woodville

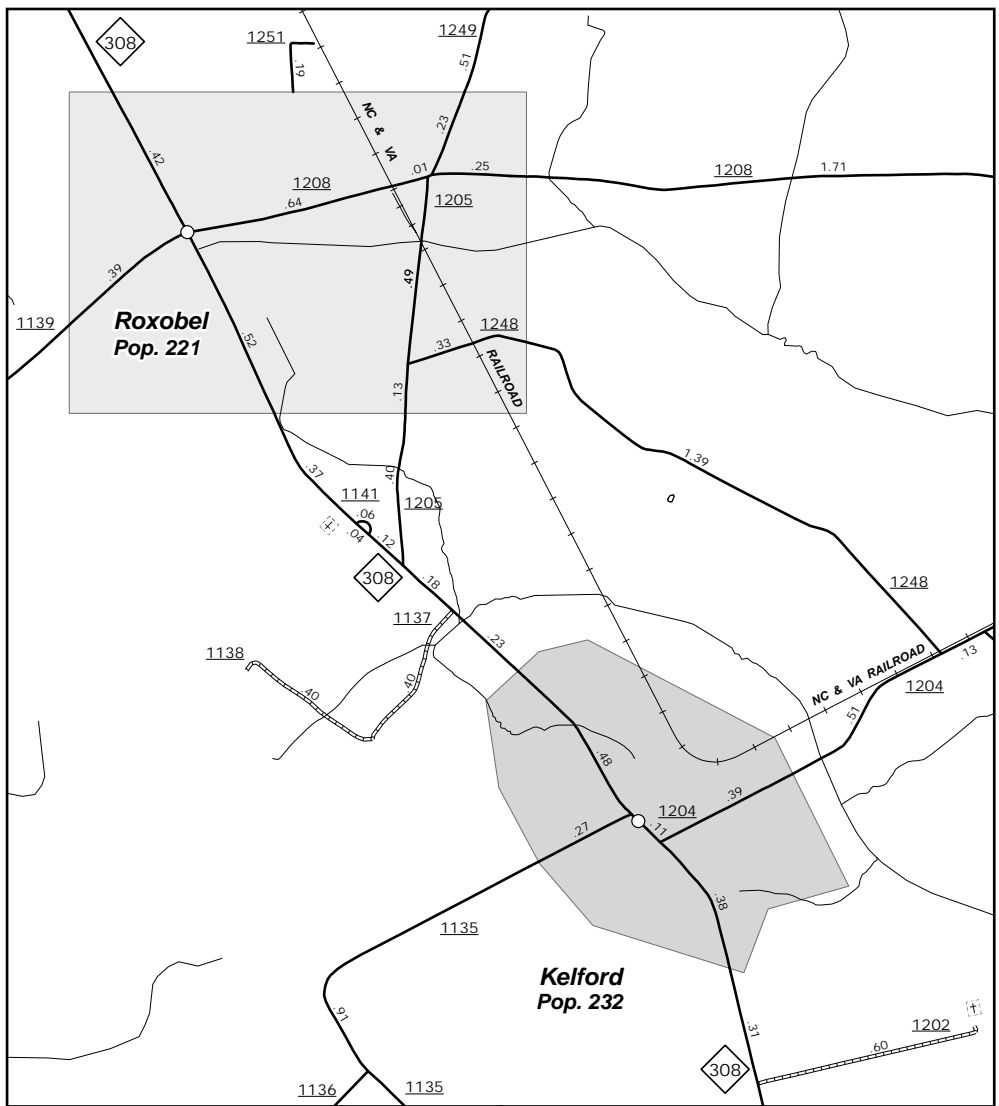

Roxobel and Kelford



ENLARGED MUNICIPAL AND SUBURBAN AREAS

BERTIE COUNTY NORTH CAROLINA

PREPARED BY THE
NORTH CAROLINA DEPARTMENT OF TRANSPORTATION
STATE ROAD MANAGEMENT UNIT - MAPPING SECTION
IN COOPERATION WITH THE
U.S. DEPARTMENT OF TRANSPORTATION
FEDERAL HIGHWAY ADMINISTRATION

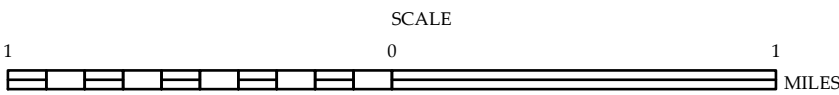

10,000 FOOT GRID BASED ON NORTH CAROLINA PLANE COORDINATE SYSTEM
LAMBERT CONFORMAL CONIC PROJECTION