

The Mapping Section's goal is to provide the most accurate and current information possible. Map data is compiled from numerous sources with varying degrees of accuracy. While every effort is made to ensure the accuracy of the data, the user should be aware that the data is not guaranteed to be 100% accurate. The information shown on this map was last updated in September, 2017. For additional information, visit <http://www.ncdot.gov/infrastructure/mapping> and click on Data Providers or contact us by phone at (919) 830-8440.

COPIES OF THIS MAP ARE AVAILABLE
FOR PURCHASE AT A PUBLIC UTILITY NOMINAL COST.
ADDRESS: N.C. DEPARTMENT OF TRANSPORTATION
MSAU - MAPPING SECTION
4809 BERT RD.
COLUMBIANA, NC 27838

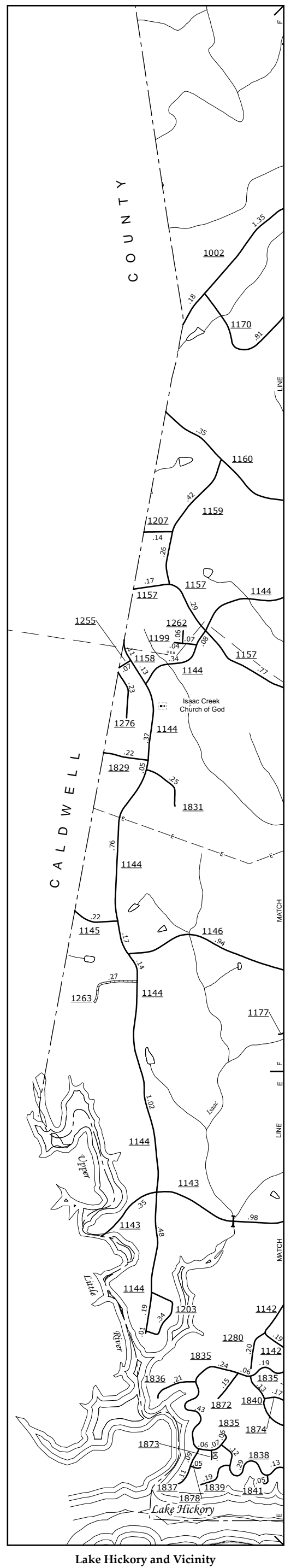

Lake Hickory and Vicinity

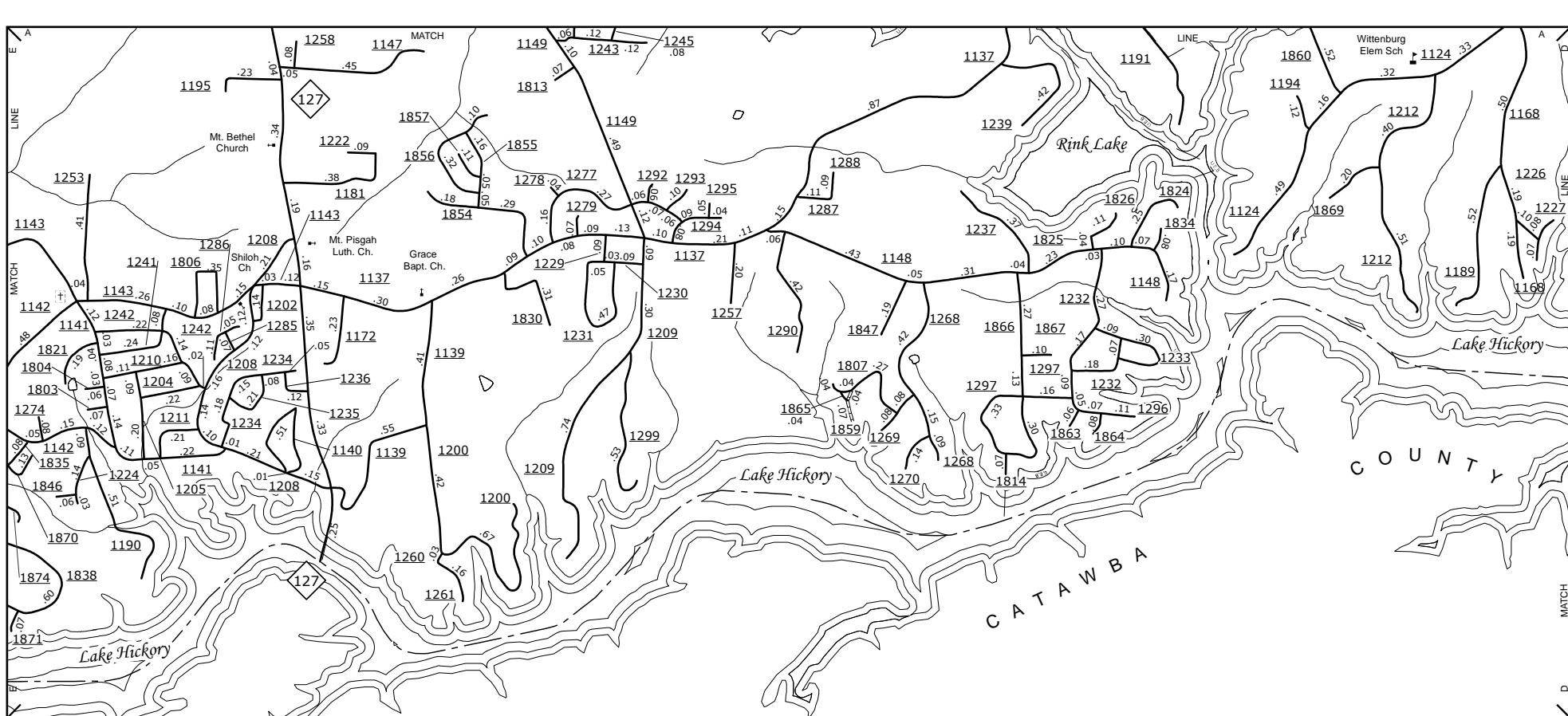

Rink Lake and Vicinity

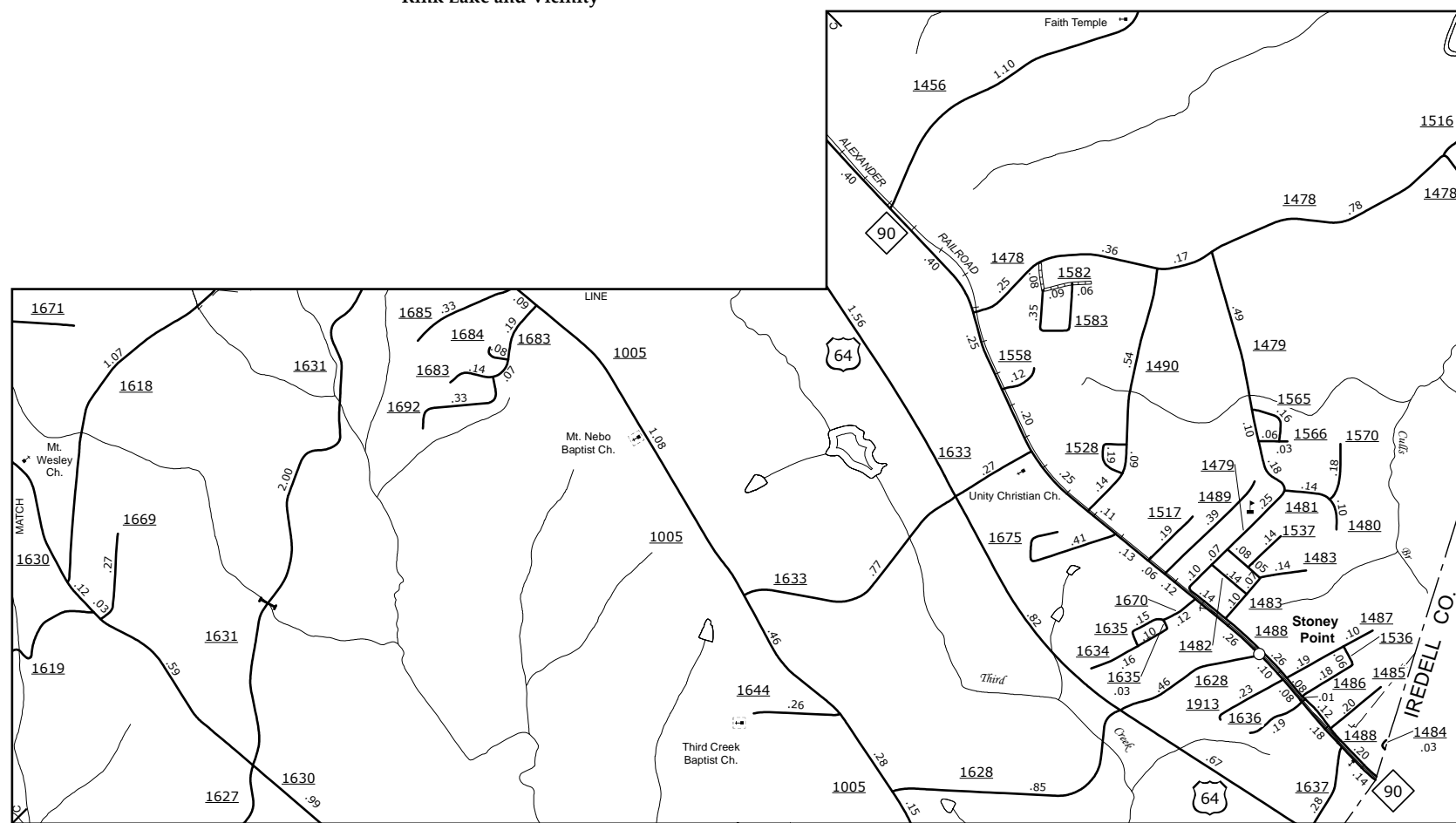

Stony Point

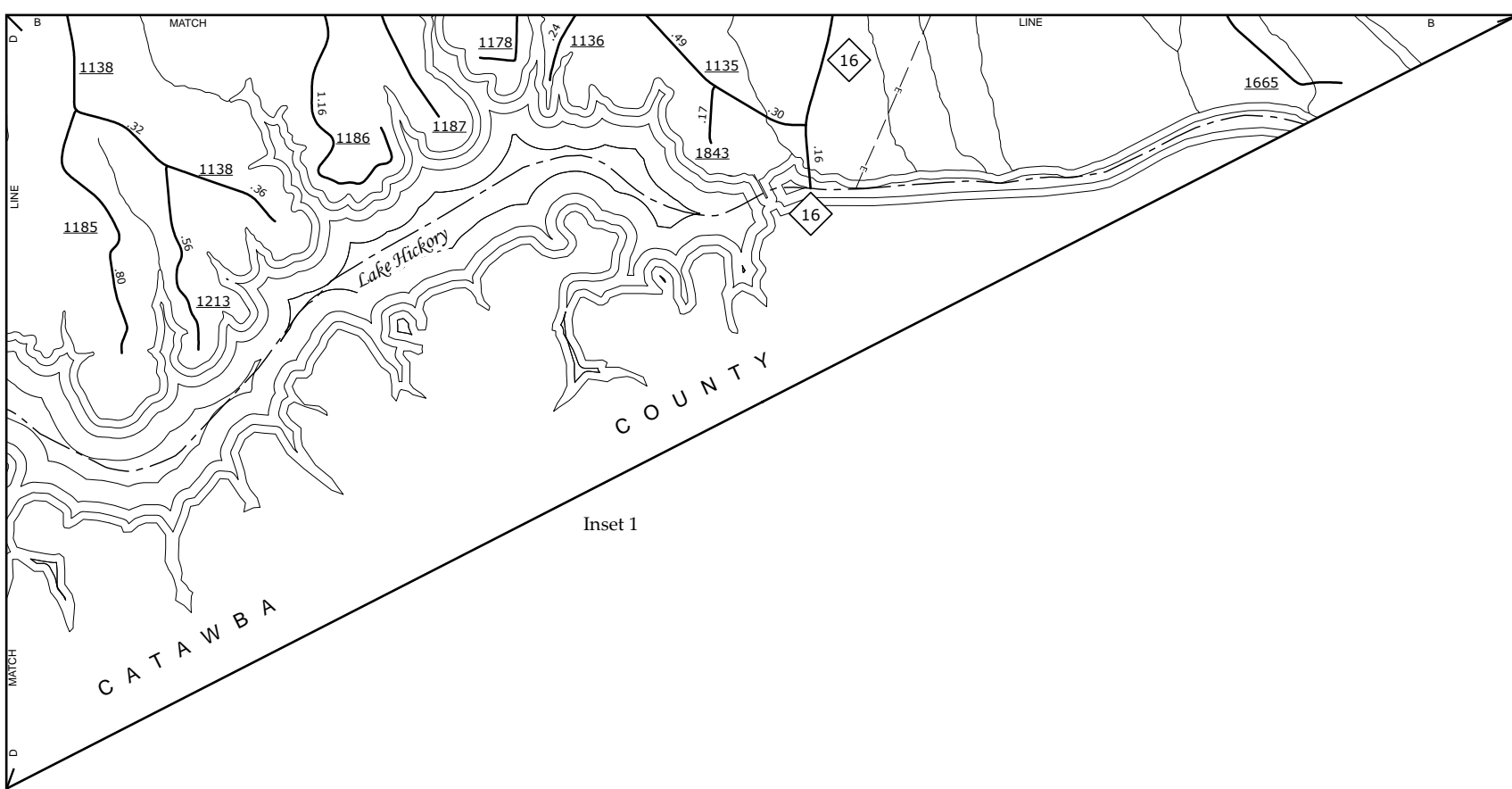

Inset 1

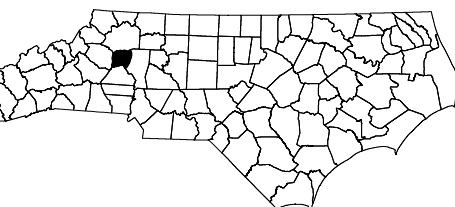

1,360,000

1,360,000

1,360,000

1,360,000

CALDWELL COUNTY

WILKES COUNTY

WILKES COUNTY

WILKES COUNTY

WILKES COUNTY



ALEXANDER COUNTY NORTH CAROLINA

PREPARED BY THE
NORTH CAROLINA DEPARTMENT OF TRANSPORTATION
MANAGEMENT SYSTEMS AND ASSESSMENT UNIT - MAPPING SECTION
IN COOPERATION WITH THE
U.S. DEPARTMENT OF TRANSPORTATION
FEDERAL HIGHWAY ADMINISTRATION

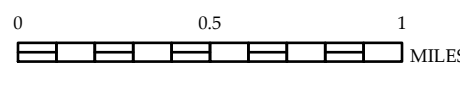
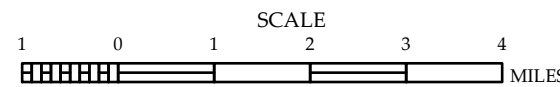

SCALE FOR ENLARGEMENTS

10,000 FOOT GRID BASED ON NORTH CAROLINA PLANE COORDINATE SYSTEM
LAMBERT CONFORMAL CONIC PROJECTION