

COPIES OF THIS MAP ARE AVAILABLE
FROM THE
N.C. DEPARTMENT OF TRANSPORTATION
ADDRESS: MAPS SECTION
4809 BERNY LANE
Raleigh, NC 27606

NOTE: Map includes only state-maintained roads
and important non-system roads. Map also includes
federal agencies, and are shown in their approximate
information on this map is current up to December, 2014.

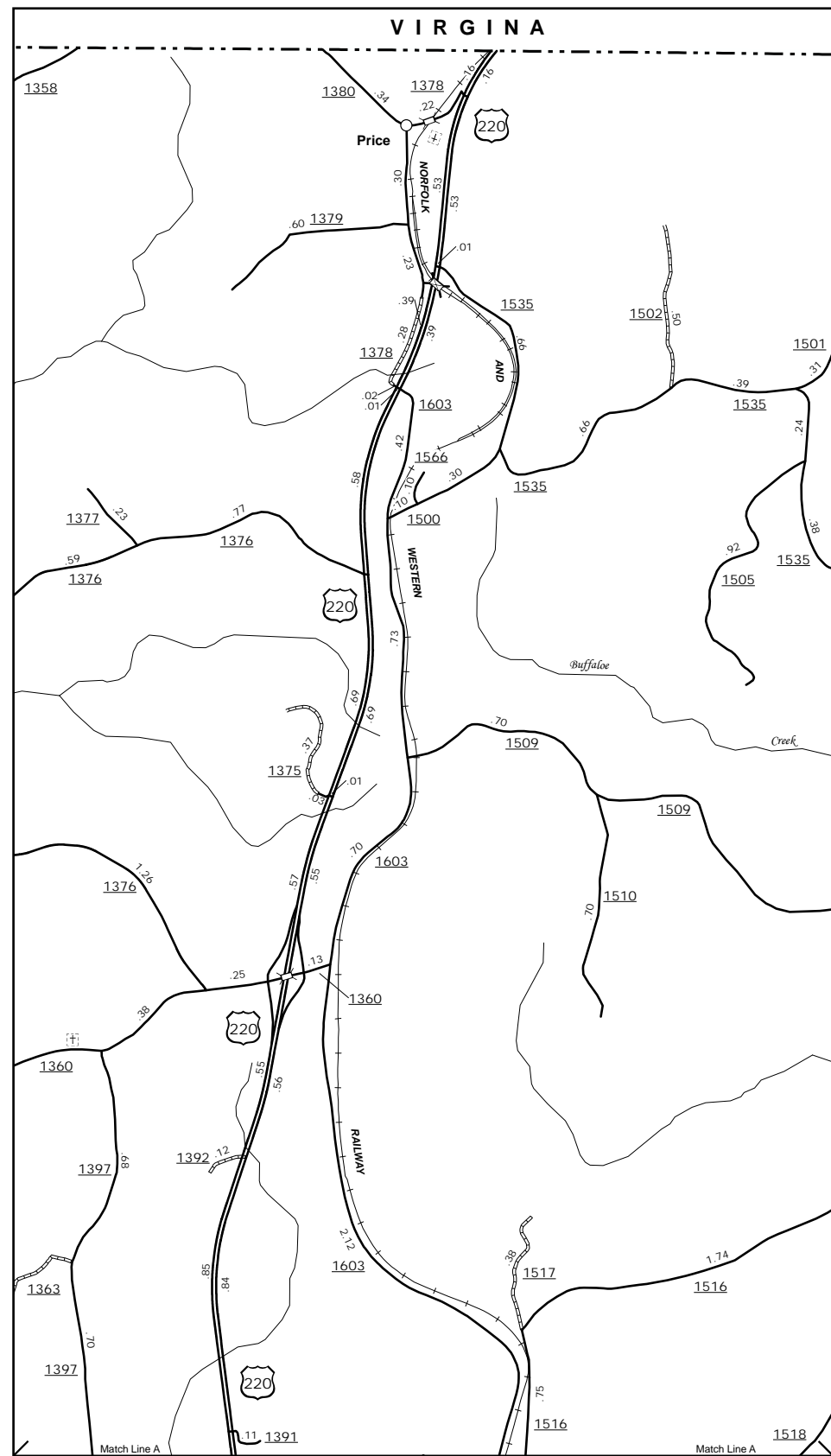

Price

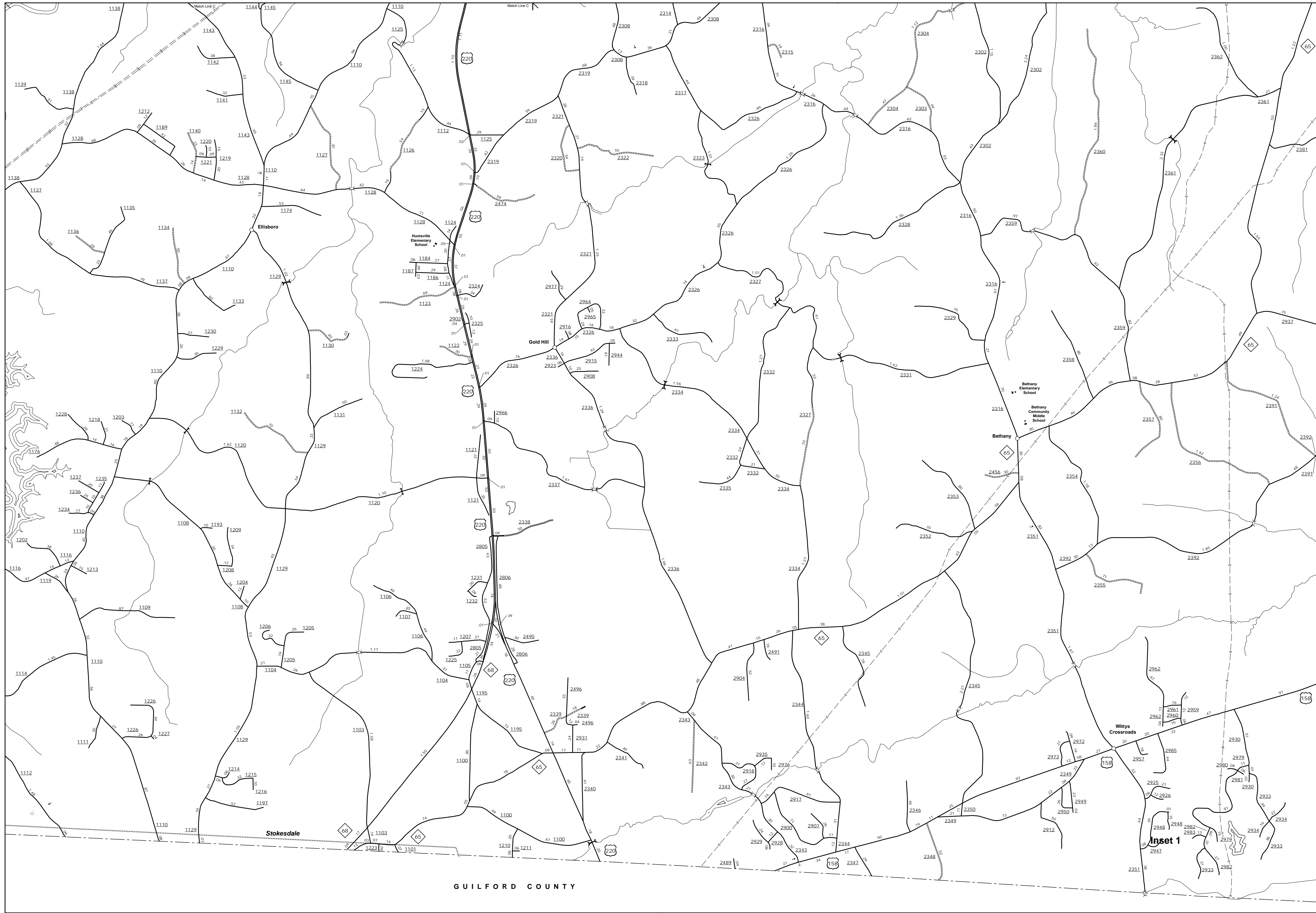
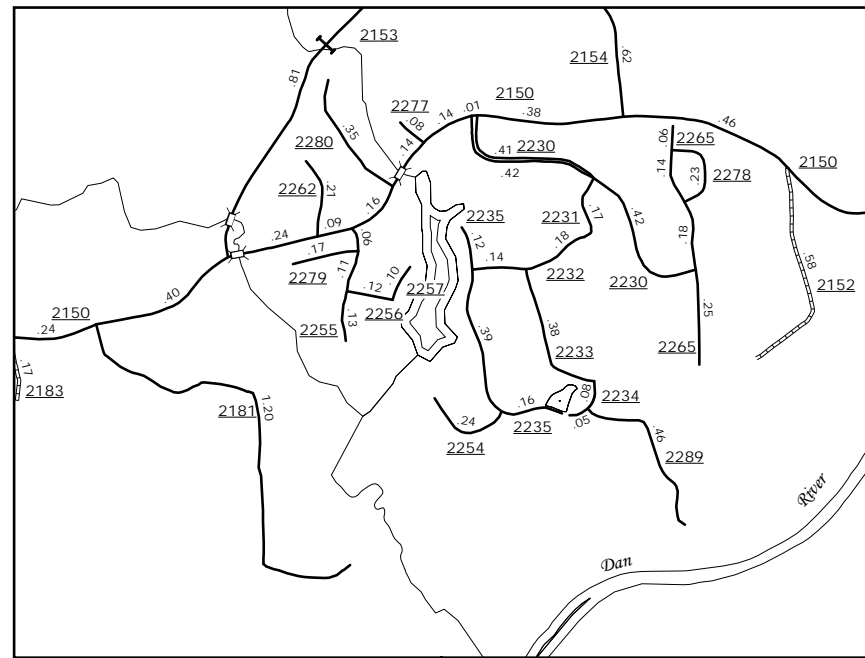

Inset 2

ENLARGED MUNICIPAL AND SUBURBAN AREAS
ROCKINGHAM COUNTY
NORTH CAROLINA

PREPARED BY THE
NORTH CAROLINA DEPARTMENT OF TRANSPORTATION
MANAGEMENT SYSTEMS AND ASSESSMENTS UNIT - MAPPING SECTION
IN COOPERATION WITH THE
U.S. DEPARTMENT OF TRANSPORTATION
FEDERAL HIGHWAY ADMINISTRATION

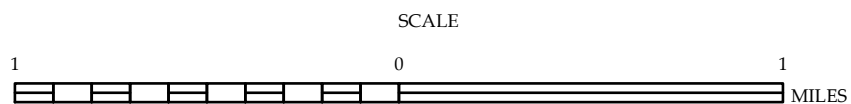

10,000 FOOT GRID BASED ON NORTH CAROLINA PLANE COORDINATE SYSTEM
LAMBERT CONFORMAL CONIC PROJECTION