

The MSA's goal is to provide the most accurate and current information possible. Map data is compiled from numerous sources with varying degrees of accuracy. As a result, roads and other features may not be shown in the exact location or at the exact scale as they appear in reality. The MSA is not responsible for any errors or omissions. For additional information, visit <http://www.ncdot.gov/infrastructure/mapping> and click on Data Providers or contact us at (919) 835-8480.

COPIES OF THIS MAP ARE AVAILABLE
AT THE PUBLIC INFORMATION
ADDRESS:
N.C. DEPARTMENT OF TRANSPORTATION
MSA - MAPPING SECTION
4809 BERT RD.
Raleigh, NC 27609

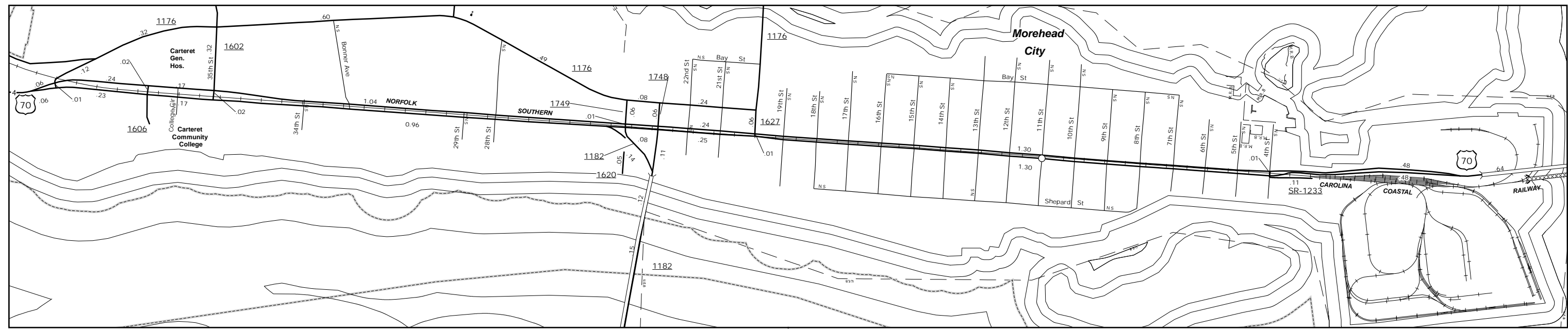
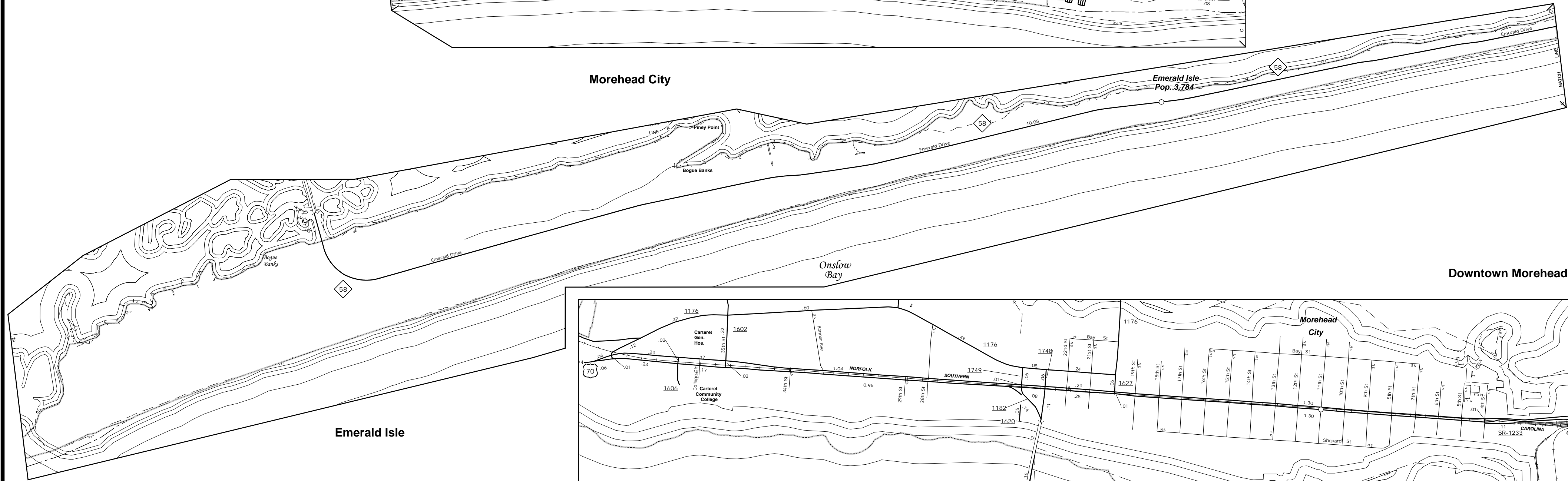
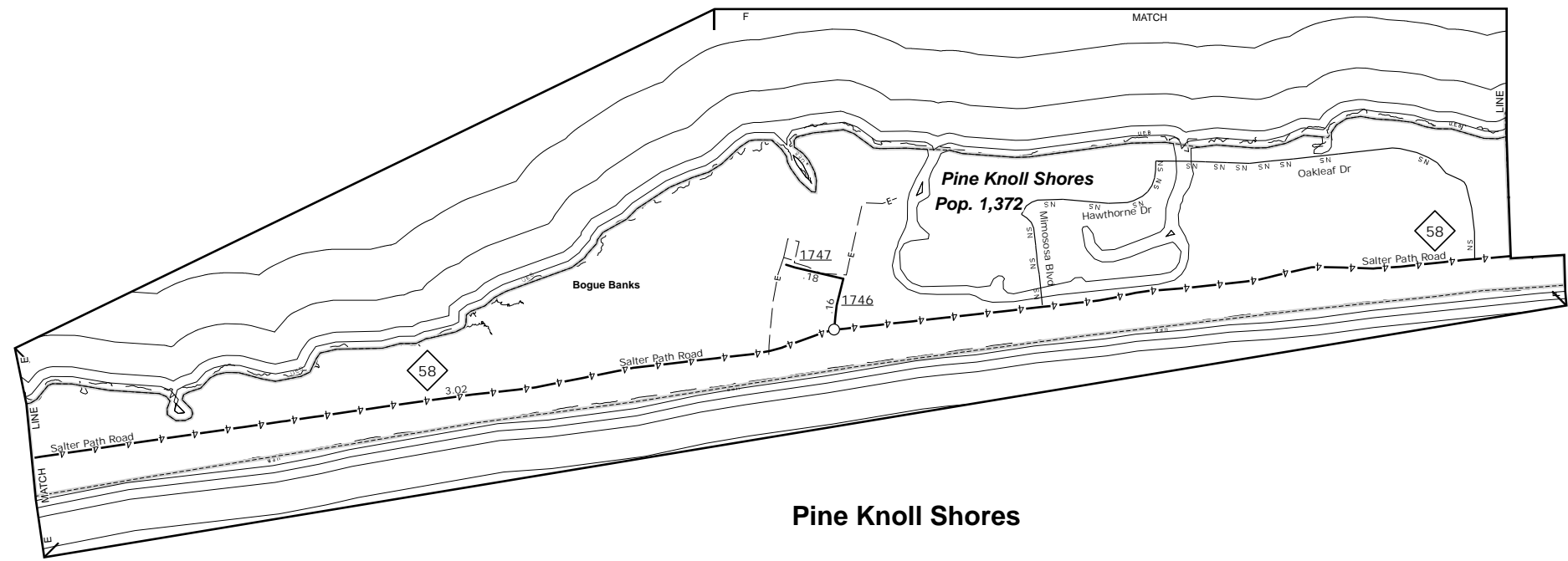
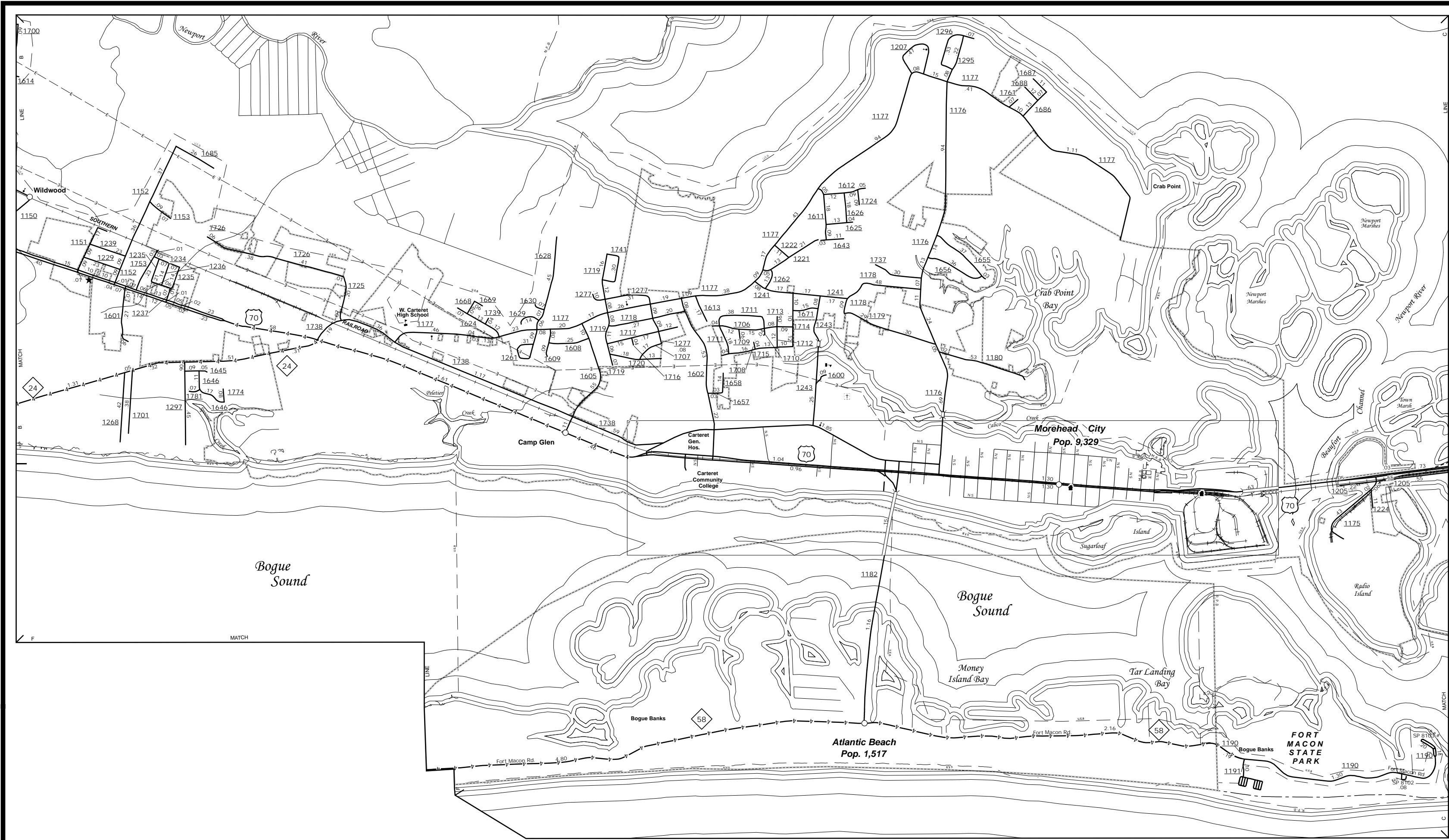

ENLARGED MUNICIPAL AND SUBURBAN AREAS

CARTERET COUNTY NORTH CAROLINA

PREPARED BY THE
NORTH CAROLINA DEPARTMENT OF TRANSPORTATION
MANAGEMENT SYSTEMS AND ASSESSMENTS UNIT - MAPPING SECTION
IN COOPERATION WITH THE
U.S. DEPARTMENT OF TRANSPORTATION
FEDERAL HIGHWAY ADMINISTRATION

SCALE

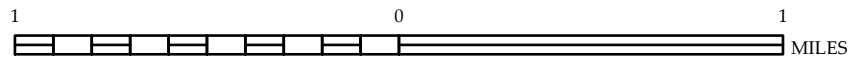

10,000 FOOT GRID BASED ON NORTH CAROLINA PLANE COORDINATE SYSTEM
LAMBERT CONFORMAL CONIC PROJECTION

SHEET 4 OF 4