

The MS&T's goal is to provide the most accurate and current information possible. Map data is compiled from numerous sources including aerial photography, ground surveys, and other data. As a result, roads and other features may not always be shown in the most accurate manner. Map data is not intended for use in navigation and is not a substitute for a map. For additional information, visit <http://www.ncdot.gov/transportation> and click on Data Providers or contact us at (810) 855-6440.

COPIES OF THIS MAP ARE AVAILABLE
AT A PUBLIC INFORMATION COST
ADDRESS:
N.C. DEPARTMENT OF TRANSPORTATION
MS&T - MAPPING SECTION
4809 BERT RD.
RALEIGH, NC 27609

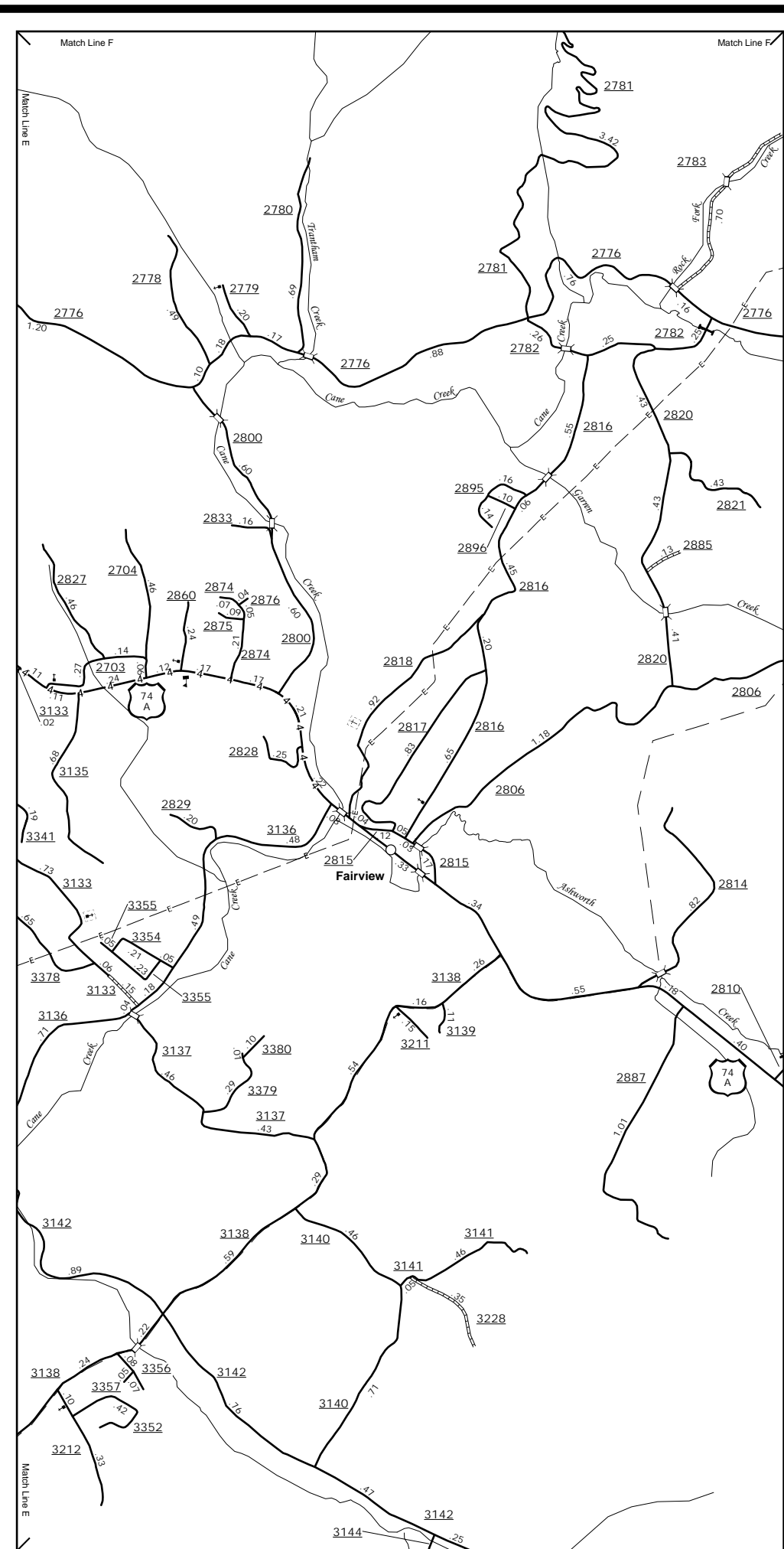

Fairview

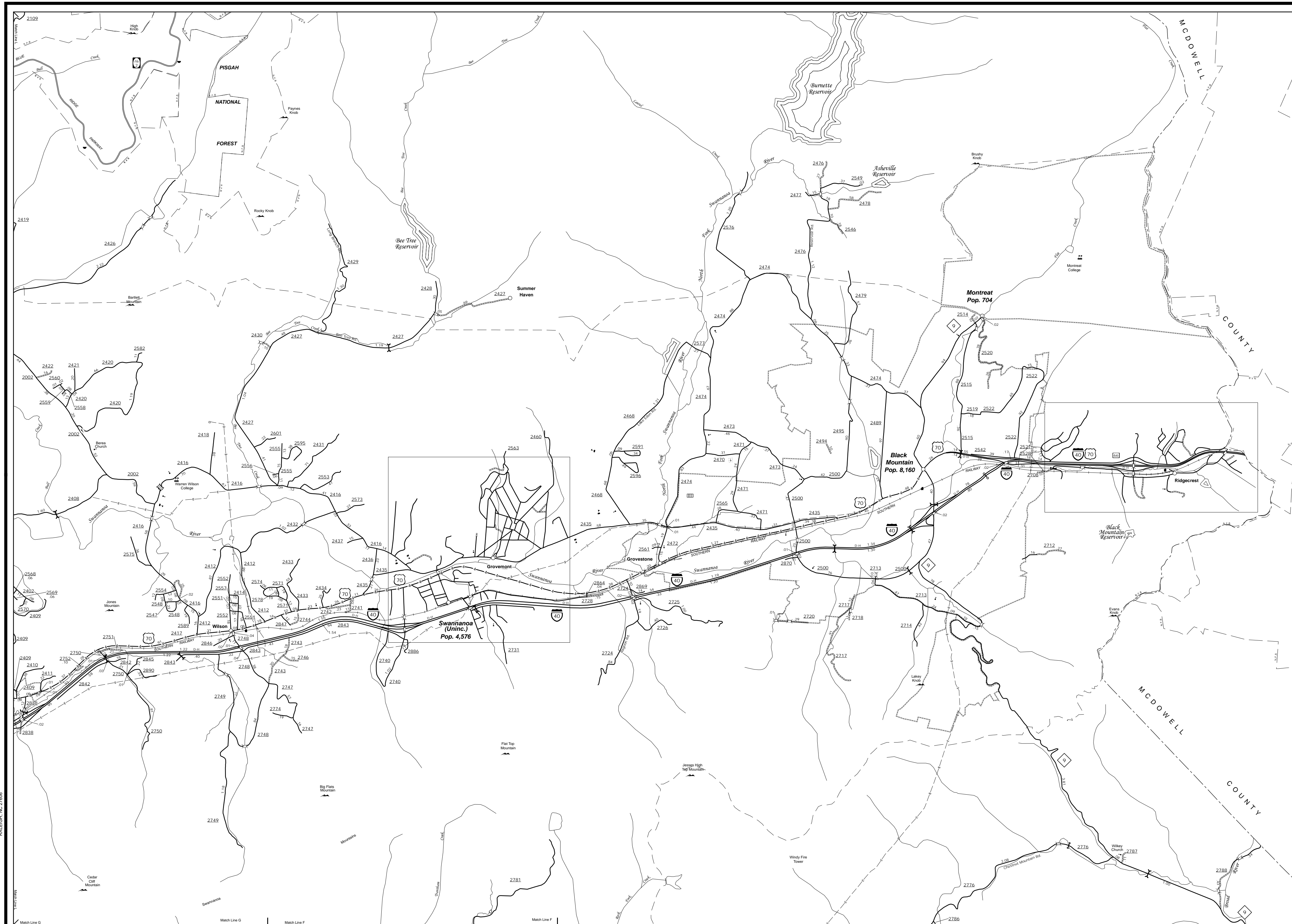

ENLARGED MUNICIPAL AND SUBURBAN AREAS

BUNCOMBE COUNTY NORTH CAROLINA

PREPARED BY THE
NORTH CAROLINA DEPARTMENT OF TRANSPORTATION
MANAGEMENT SYSTEMS AND ASSESSMENTS UNIT - MAPPING SECTION
IN COOPERATION WITH THE
U.S. DEPARTMENT OF TRANSPORTATION
FEDERAL HIGHWAY ADMINISTRATION

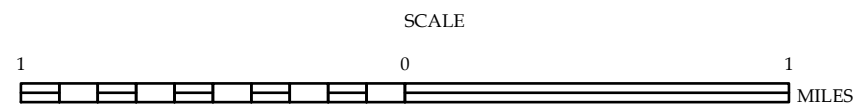

10,000 FOOT GRID BASED ON NORTH CAROLINA PLANE COORDINATE SYSTEM
LAMBERT CONFORMAL CONIC PROJECTION

SHEET 5 OF 7