

The MS&U's goal is to provide the most accurate and current information possible. Map data is compiled from numerous sources and is not a guarantee of accuracy. As a result, roads and other features may not be shown in the exact location or at the exact scale. The MS&U is not responsible for any errors or omissions. For additional information, visit <http://www.ncdot.gov/transportation/MS&U> and click on Data Providers or contact us at (819) 835-8460.

COPIES OF THIS MAP ARE AVAILABLE
FROM THE N.C. DEPARTMENT OF TRANSPORTATION
ADDRESS: N.C. DEPARTMENT OF TRANSPORTATION
MS&U - MAPPING SECTION
4809 BERT LEO
COLUMBIA, NC 28038

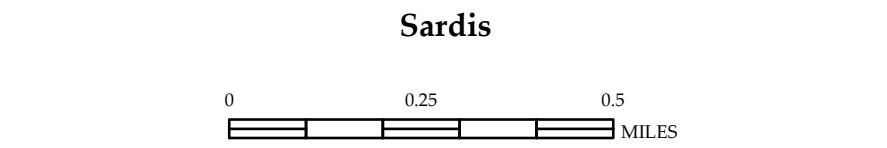

Fairview, Hemby Bridge, Lake Park and Unionville

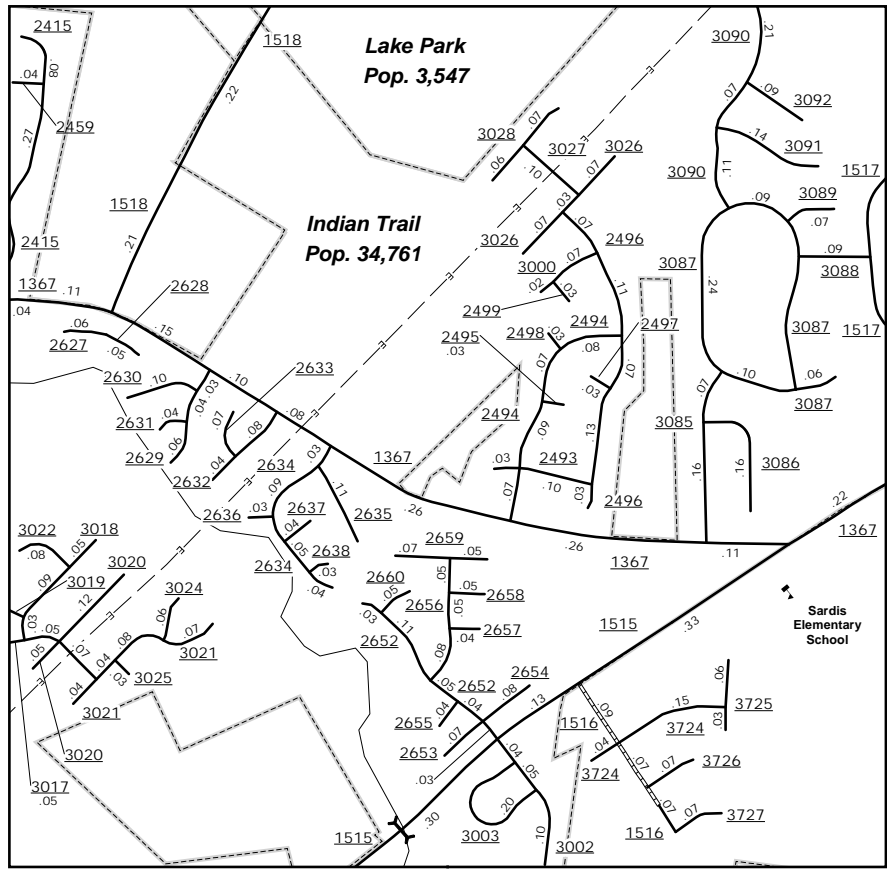
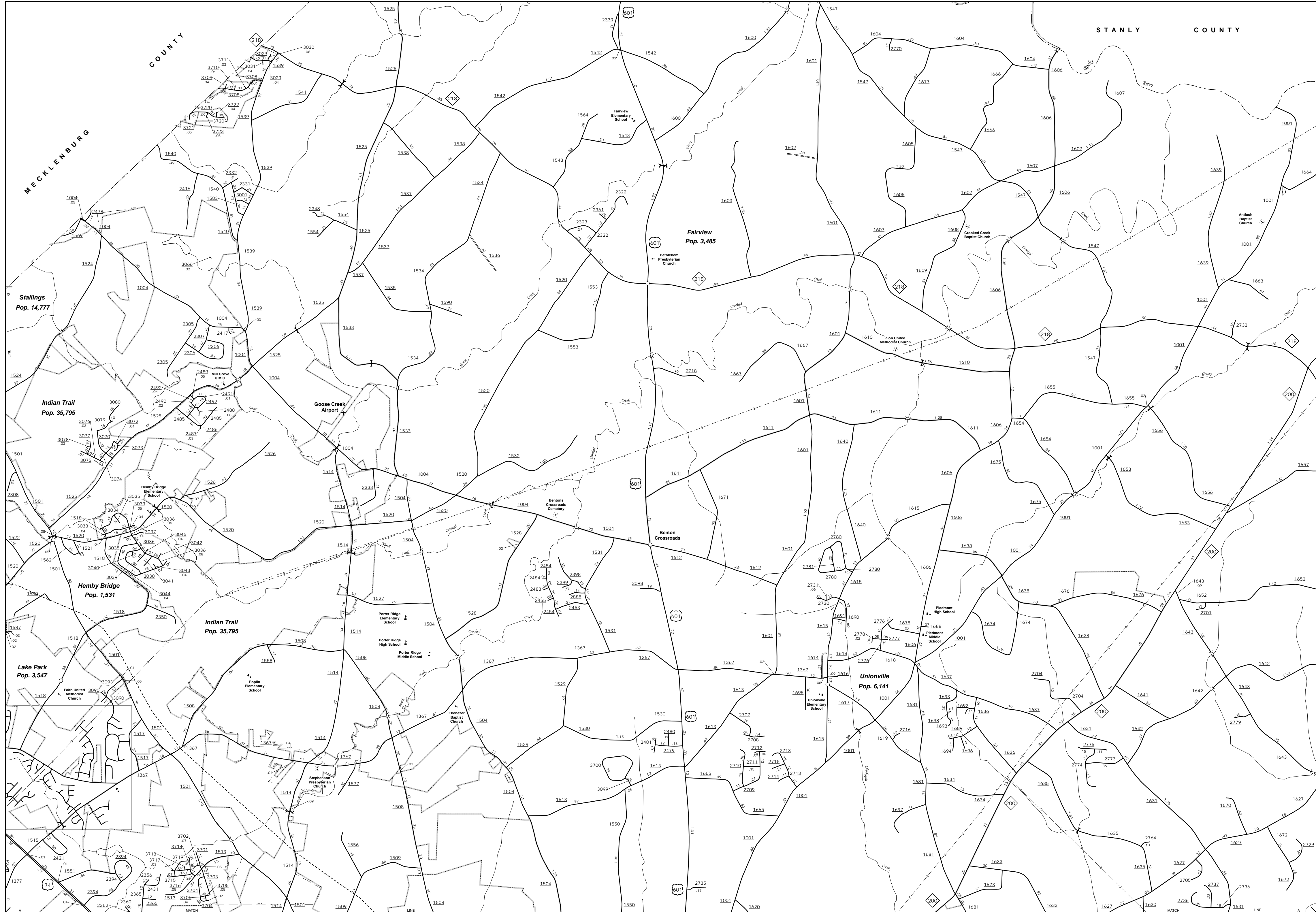
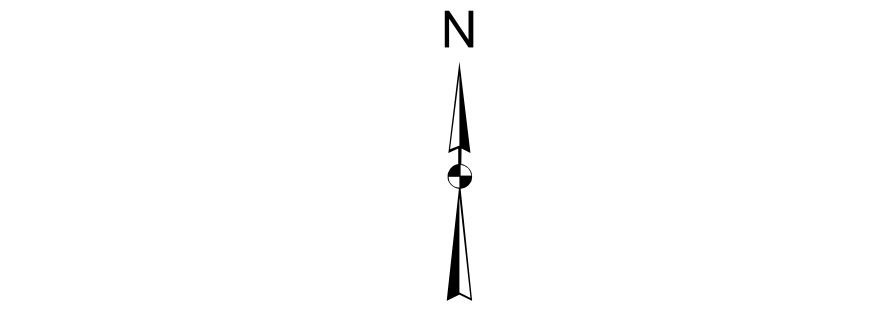

ENLARGED MUNICIPAL AND SUBURBAN AREAS
UNION COUNTY
NORTH CAROLINA
PREPARED BY THE
NORTH CAROLINA DEPARTMENT OF TRANSPORTATION
MANAGEMENT SYSTEMS AND ASSESSMENTS UNIT - MAPPING SECTION
IN COOPERATION WITH THE
U.S. DEPARTMENT OF TRANSPORTATION
FEDERAL HIGHWAY ADMINISTRATION

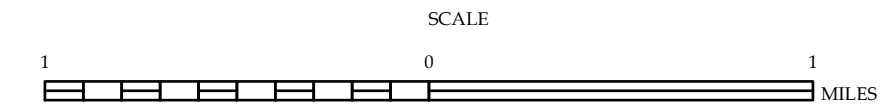

10,000 FOOT GRID BASED ON NORTH CAROLINA PLANE COORDINATE SYSTEM
LAMBERT CONFORMAL CONIC PROJECTION