

The MSALT's goal is to provide the most accurate and current information possible. Map data is compiled from numerous sources including aerial photography, ground surveys, and other data. As a result, roads and important non-system roads. MSALT's data was last updated on April 1, 2015. For additional information, visit <http://www.ncdot.gov/transportation/mapping>, and click on Data Providers or contact us at (819) 835-8480.

COPIES OF THIS MAP ARE AVAILABLE  
FROM THE NORTH CAROLINA  
ADDRESS MAPS SECTION  
N.C. DEPARTMENT OF TRANSPORTATION  
MSALT-MAPPING SECTION  
4809 BERT RD.  
RALEIGH, NC 27605

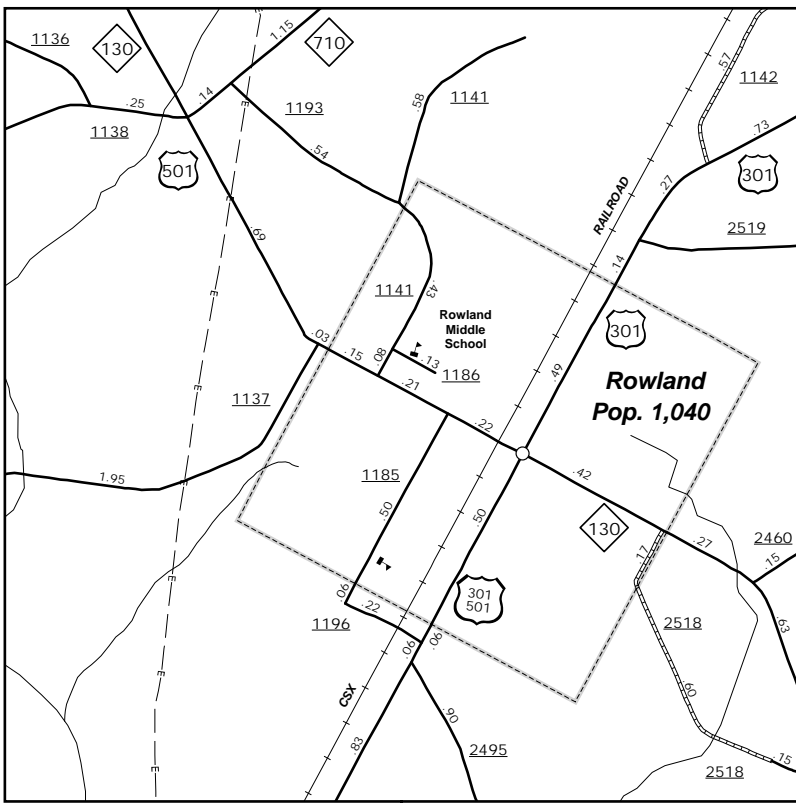
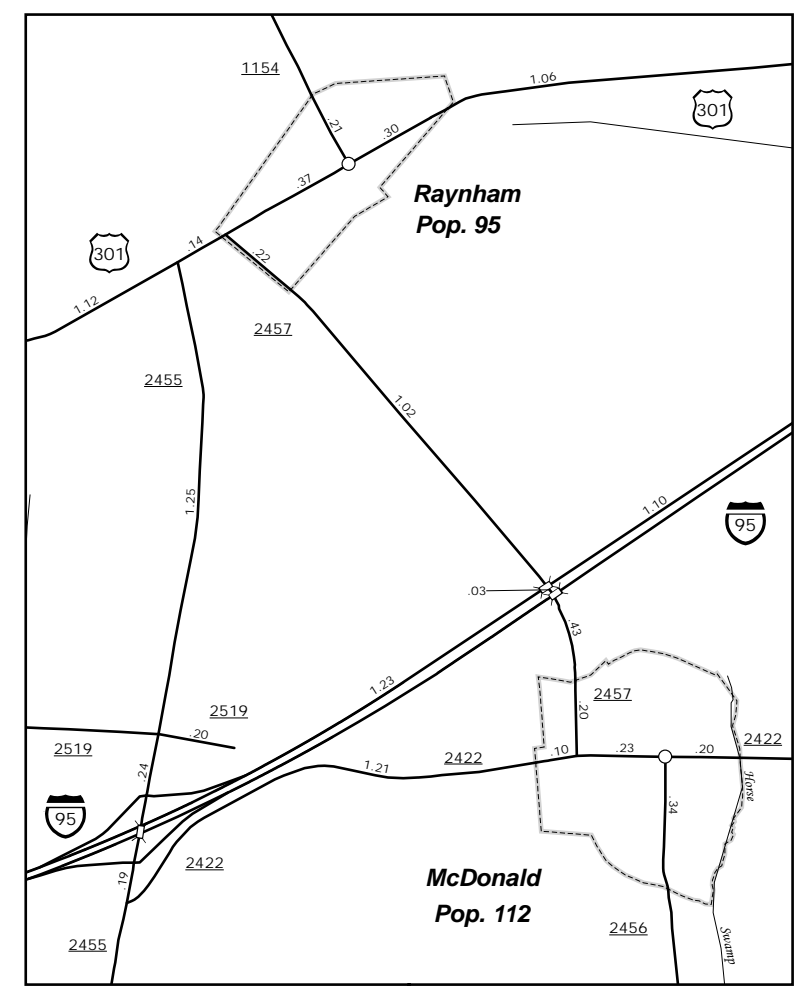
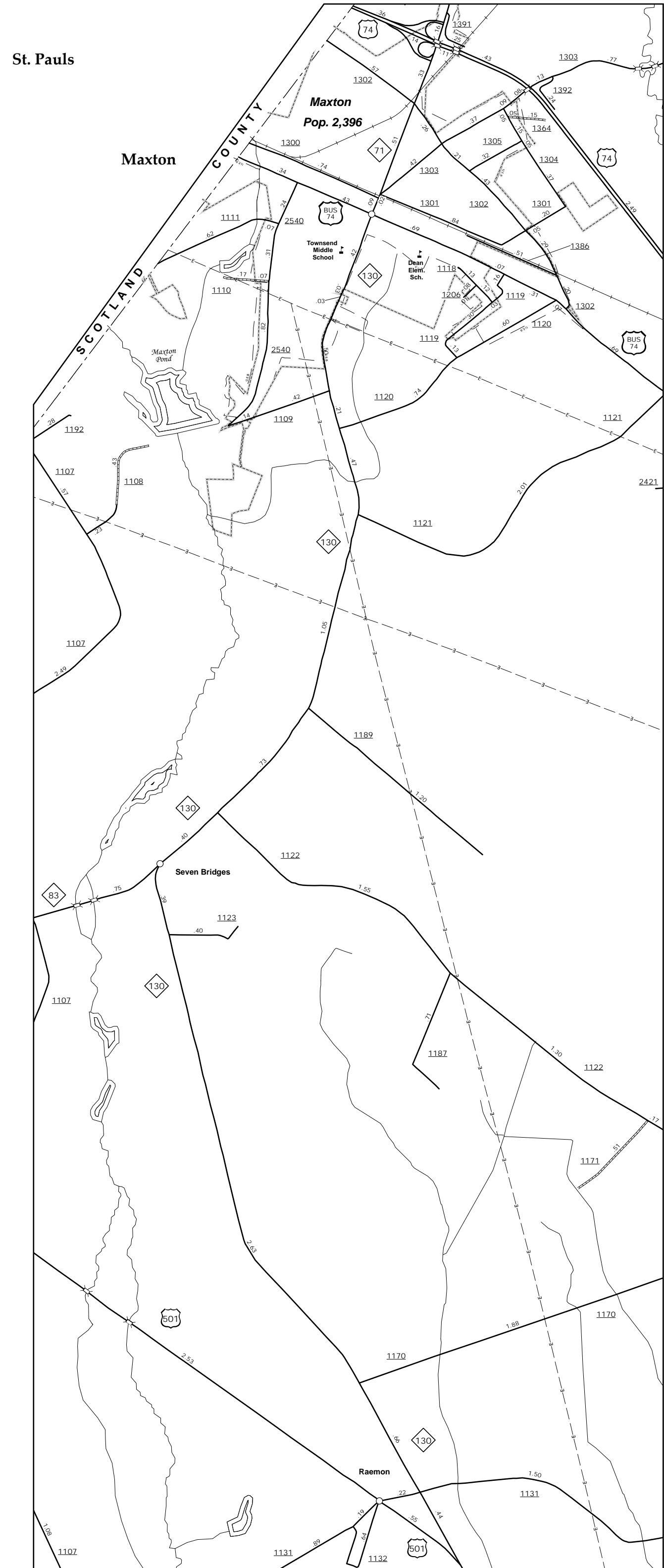

ENLARGED MUNICIPAL AND SUBURBAN AREAS

## ROBESON COUNTY NORTH CAROLINA

PREPARED BY THE  
NORTH CAROLINA DEPARTMENT OF TRANSPORTATION  
MANAGEMENT SYSTEMS AND ASSESSMENTS UNIT - MAPPING SECTION  
IN COOPERATION WITH THE  
U.S. DEPARTMENT OF TRANSPORTATION  
FEDERAL HIGHWAY ADMINISTRATION

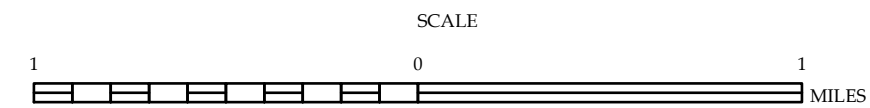

10,000 FOOT GRID BASED ON NORTH CAROLINA PLANE COORDINATE SYSTEM  
LAMBERT CONFORMAL CONIC PROJECTION

SHEET 4 OF 4