

The MS&T's goal is to provide the most accurate and current information possible. Map data is compiled from numerous sources and is subject to change. As a result, roads and other features may not be shown or may be shown in an approximate location. The MS&T's goal is to provide the most accurate and current information possible. Map data is compiled from numerous sources and is subject to change. As a result, roads and other features may not be shown or may be shown in an approximate location. The MS&T's goal is to provide the most accurate and current information possible. Map data is compiled from numerous sources and is subject to change. As a result, roads and other features may not be shown or may be shown in an approximate location.

COPIES OF THIS MAP ARE AVAILABLE  
FROM THE N.C. DEPARTMENT OF TRANSPORTATION  
ADDRESS: N.C. DEPARTMENT OF TRANSPORTATION  
MS&T - MAPPING SECTION  
4809 BERT RD.  
Raleigh, NC 27609

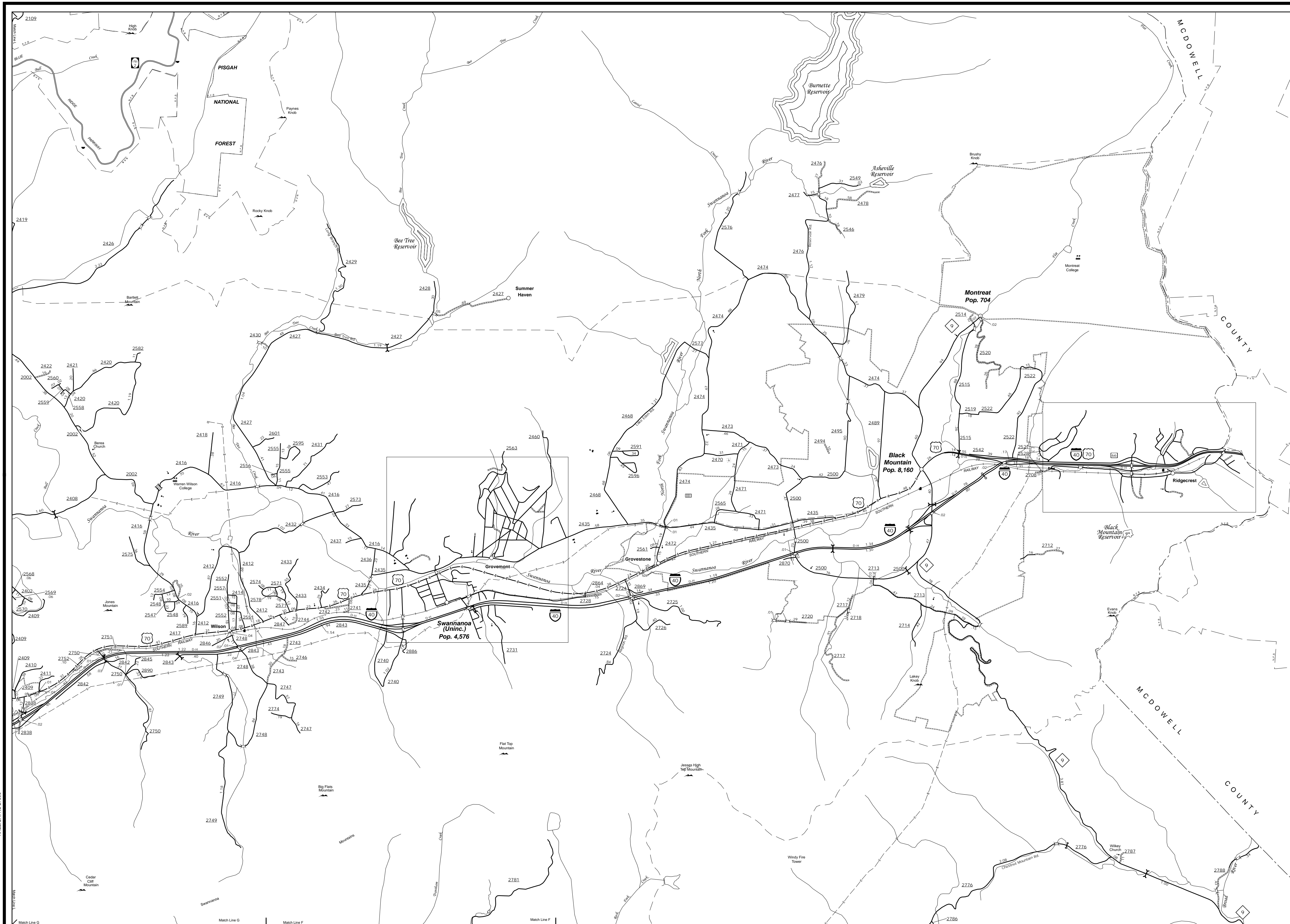

Black Mountain and Vicinity

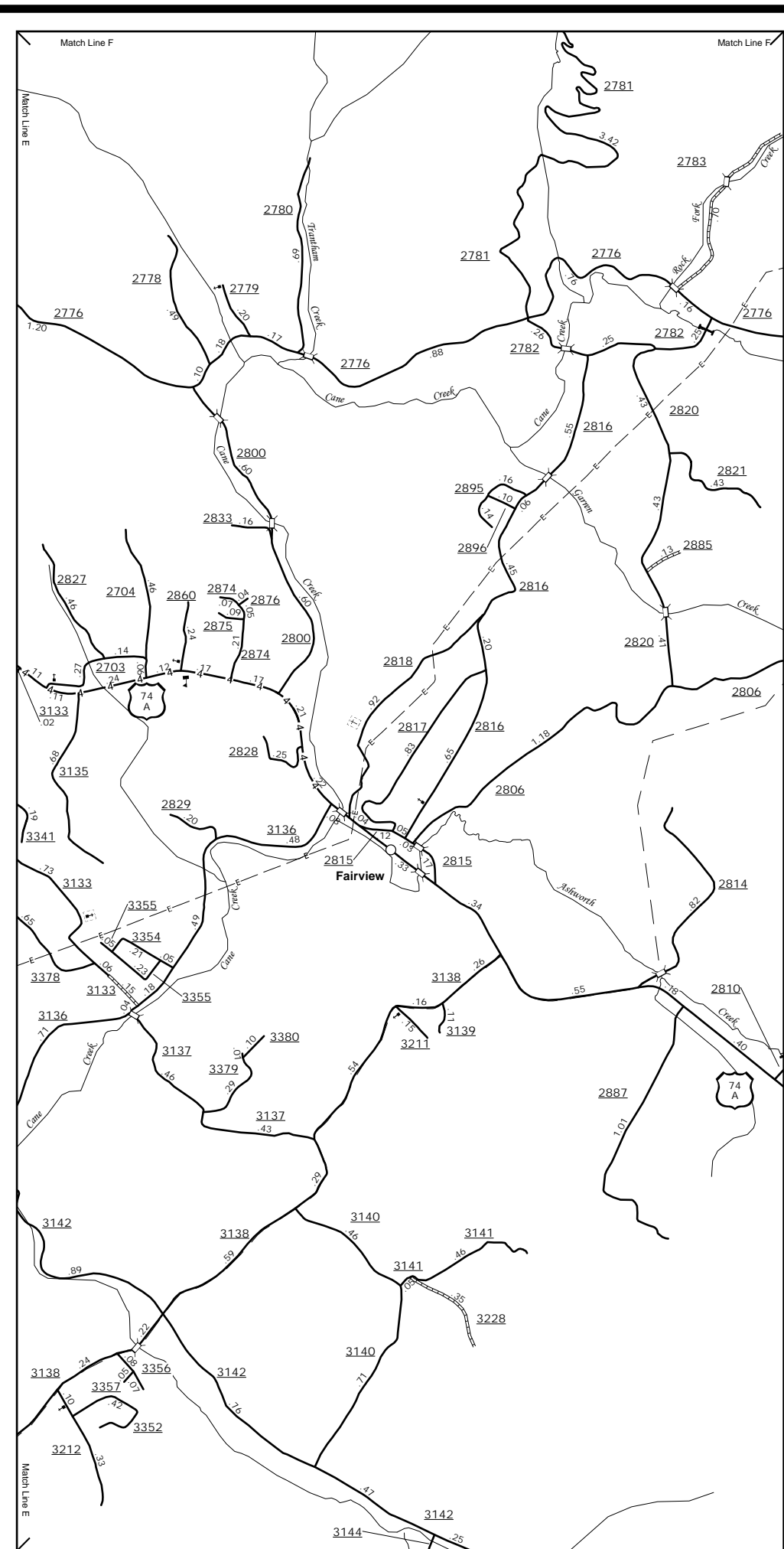

Fairview



ENLARGED MUNICIPAL AND SUBURBAN AREAS

## BUNCOMBE COUNTY NORTH CAROLINA

PREPARED BY THE  
NORTH CAROLINA DEPARTMENT OF TRANSPORTATION  
MANAGEMENT SYSTEMS AND ASSESSMENTS UNIT - MAPPING SECTION  
IN COOPERATION WITH THE  
U.S. DEPARTMENT OF TRANSPORTATION  
FEDERAL HIGHWAY ADMINISTRATION

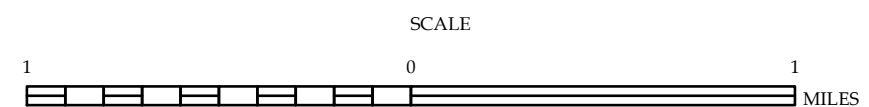

10,000 FOOT GRID BASED ON NORTH CAROLINA PLANE COORDINATE SYSTEM  
LAMBERT CONFORMAL CONIC PROJECTION

SHEET 5 OF 7