

The MS&U's goal is to provide the most accurate and current information possible. Map data is compiled from numerous sources with varying degrees of accuracy and is not guaranteed. As a result, roads and important non-system roads. MS&U Mapping Section has been updated on June 1, 2014. For additional information, visit <http://www.ncdot.gov/infrastructure/infrastructure> and click on Data Providers or contact us at (819) 335-8480.

COPIES OF THIS MAP ARE AVAILABLE  
AT THE PUBLIC INFORMATION COST  
ADDRESS:  
N.C. DEPARTMENT OF TRANSPORTATION  
MS&U-MAPPING SECTION  
489 BERN LEO  
COLUMBIA, NC 28038

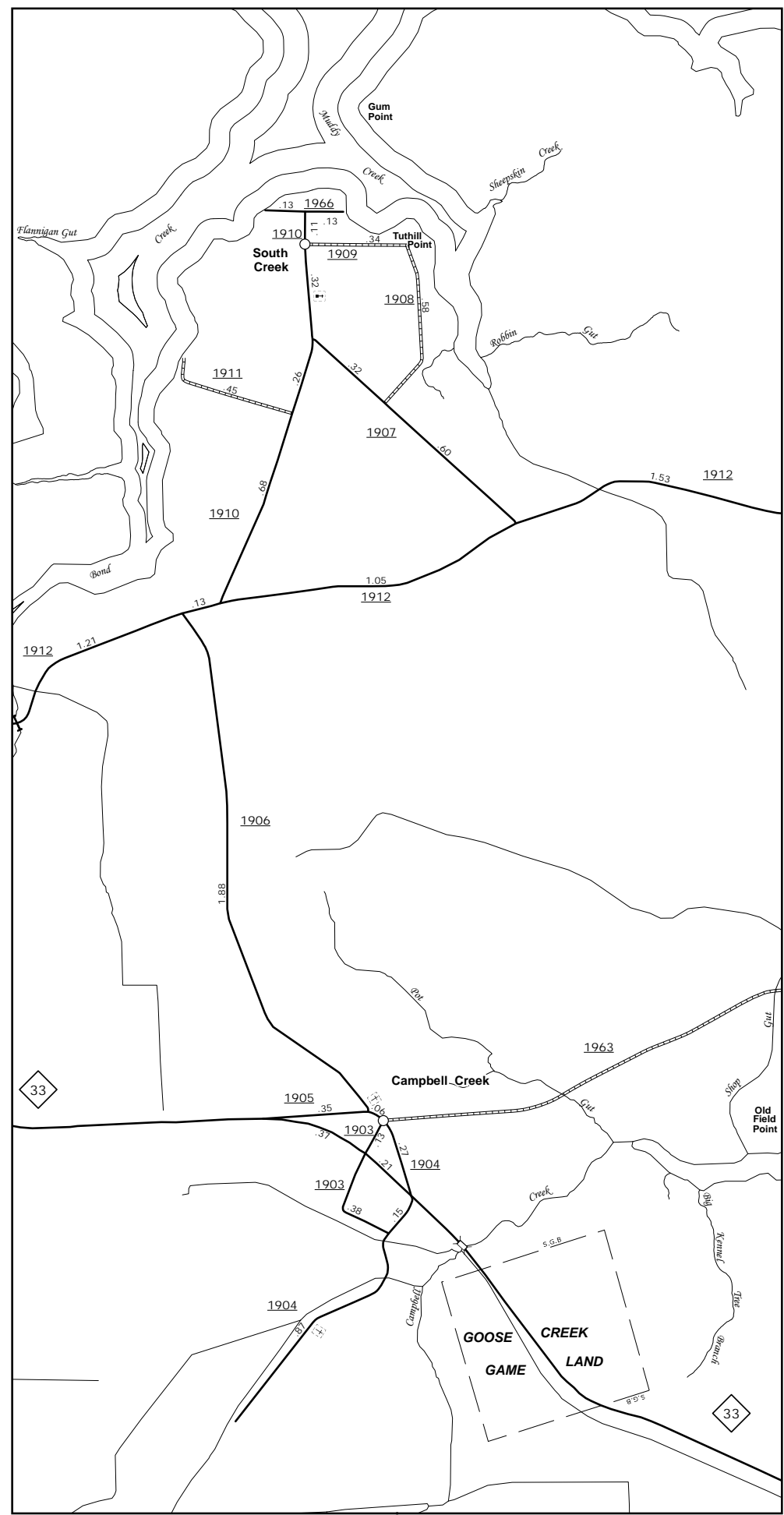

Campbell and Vicinity

Washington and Vicinity



ENLARGED MUNICIPAL AND SUBURBAN AREAS

## BEAUFORT COUNTY NORTH CAROLINA

PREPARED BY THE  
NORTH CAROLINA DEPARTMENT OF TRANSPORTATION  
MANAGEMENT SYSTEMS AND ASSESSMENTS UNIT - MAPPING SECTION  
IN COOPERATION WITH THE  
U.S. DEPARTMENT OF TRANSPORTATION  
FEDERAL HIGHWAY ADMINISTRATION

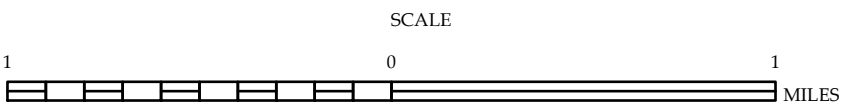

10,000 FOOT GRID BASED ON NORTH CAROLINA PLANE COORDINATE SYSTEM  
LAMBERT CONFORMAL CONIC PROJECTION

SHEET 2 OF 4