

Disclaimer: The SRMU's goal is to provide the most accurate information as possible. The magnitude of the data prevents any guarantee of accuracy or completeness. If you find any information that is incorrect, please send your request to the SRMU Section Chief.

COPIES OF THIS MAP ARE AVAILABLE TO THE PUBLIC AT A NOMINAL COST.

ADDRESS:
N.C. DEPARTMENT OF TRANSPORTATION
STATE ROAD MANAGEMENT UNIT
3801 CARE SANDHURST CT
RALEIGH, NC 27603

SHEET 3

CARTERET

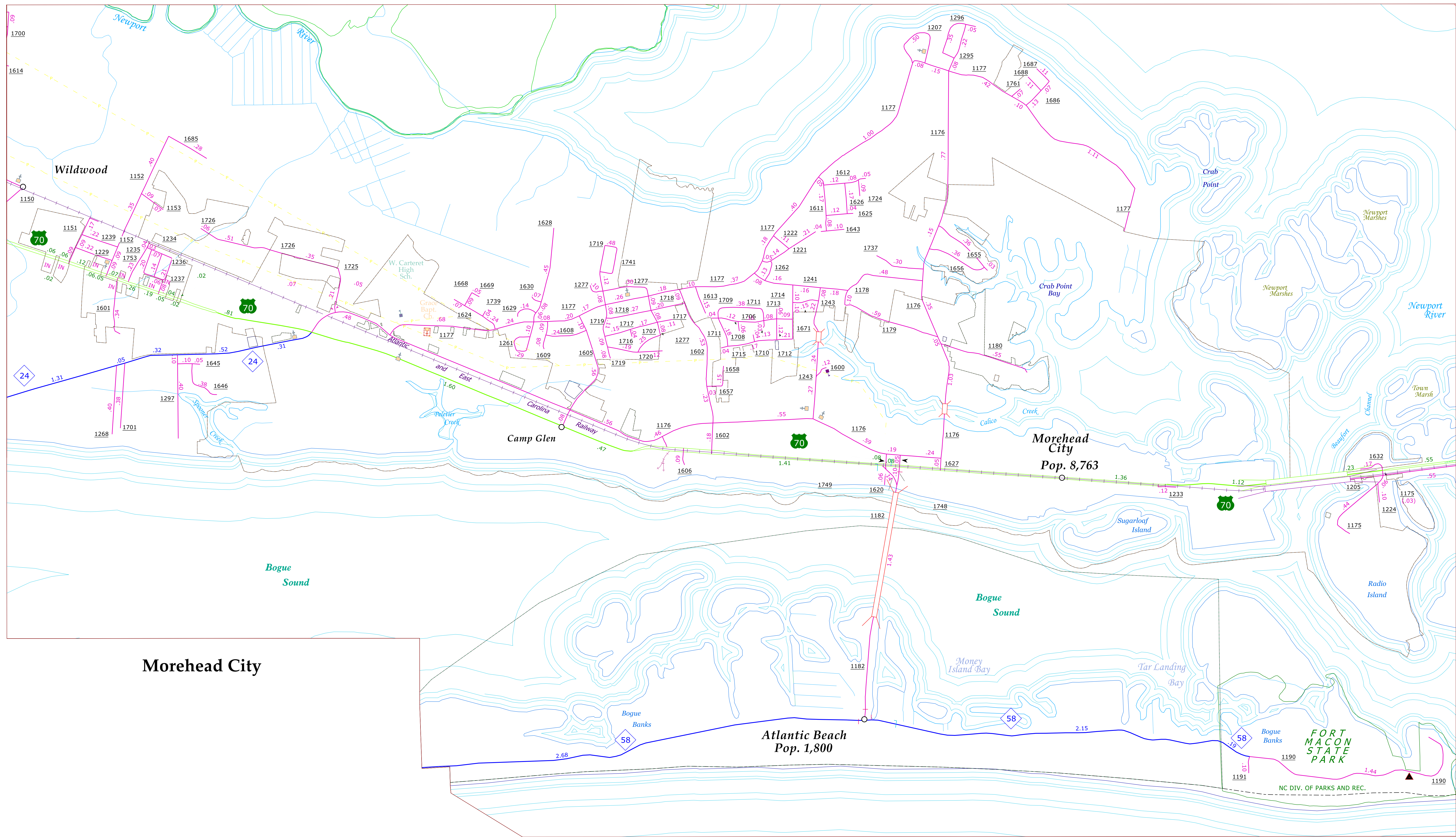

Morehead City

Atlantic Beach
Pop. 1,800

Morehead City
Pop. 8,763

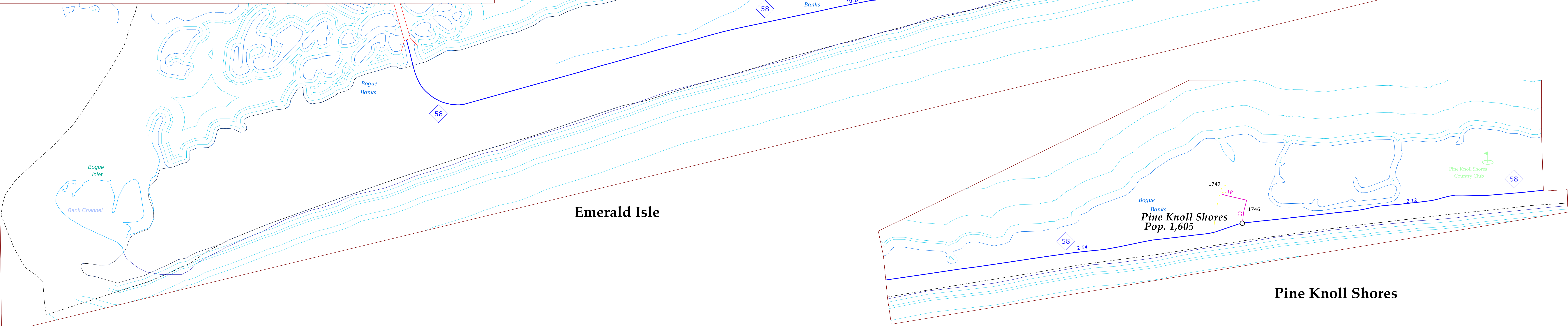

Emerald Isle

Pine Knoll Shores
Pop. 1,605

Pine Knoll Shores

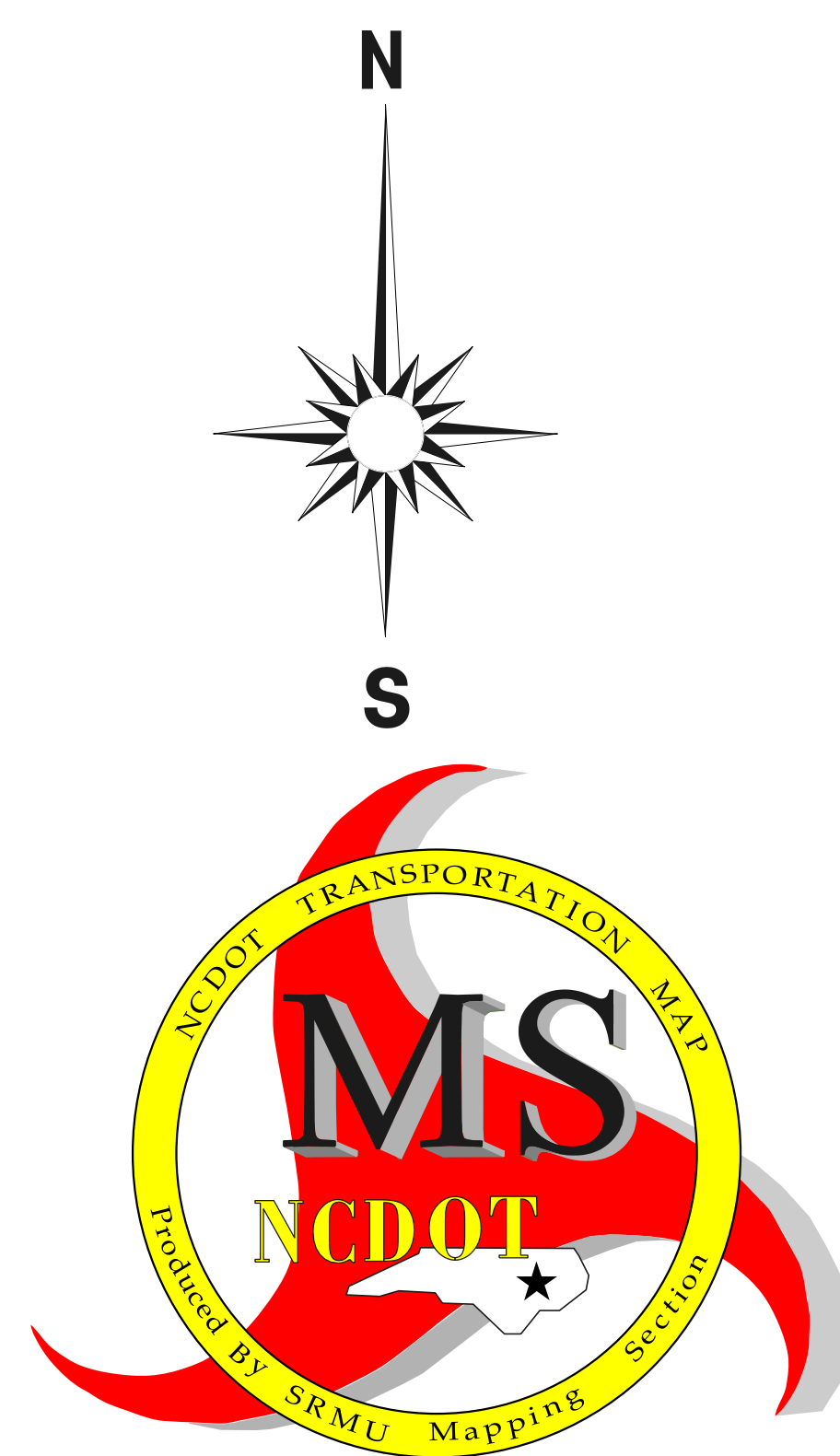

ENLARGED MUNICIPAL AND SUBURBAN AREAS
CARTERET COUNTY
NORTH CAROLINA
PREPARED BY THE
NORTH CAROLINA DEPARTMENT OF TRANSPORTATION
STATE ROAD MANAGEMENT UNIT - MAPPING SECTION
IN COOPERATION WITH THE
U.S. DEPARTMENT OF TRANSPORTATION
FEDERAL HIGHWAY ADMINISTRATION

SCALE
1 0 1
MILE
10,000 FOOT GRID BASED ON NORTH CAROLINA STATE PLANE COORDINATE SYSTEM
NAD 83 FEET
LAMBERT CONFORMAL CONIC