

COPIES OF THIS MAP ARE AVAILABLE
TO THE PUBLIC AT A NOMINAL COST
ADDRESS:

N.C. DEPARTMENT OF TRANSPORTATION
INFORMATION SERVICES
3401 CARI SANDHURST CT.
RALEIGH, N.C. 27603

REVISION
11/16/92 MSG
3/17/93 MSG
3/19/93 MSG
11/14/93 MSG
5/3/94 MSG
5/5/94 MSG
1/25/95 MSG
7/8/96 BDG
10/31/96 FLD
11/30/96 FLD
6/16/98 BDG

WASHINGTON

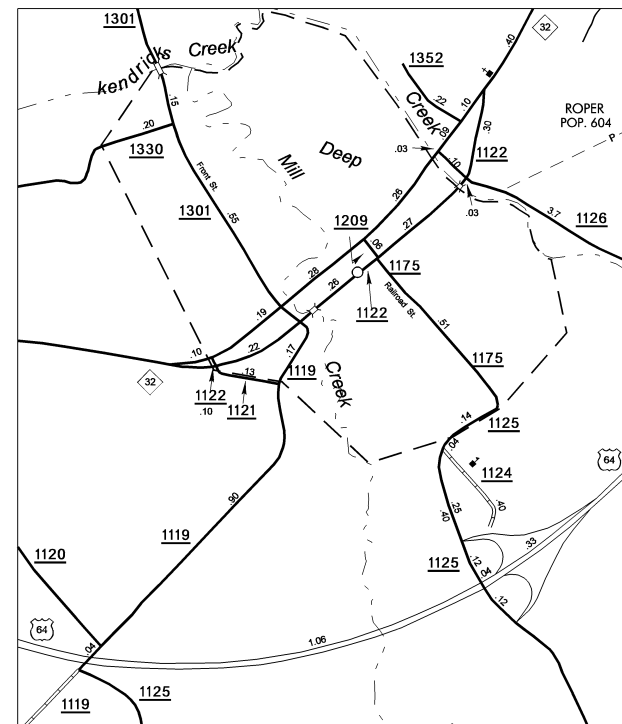
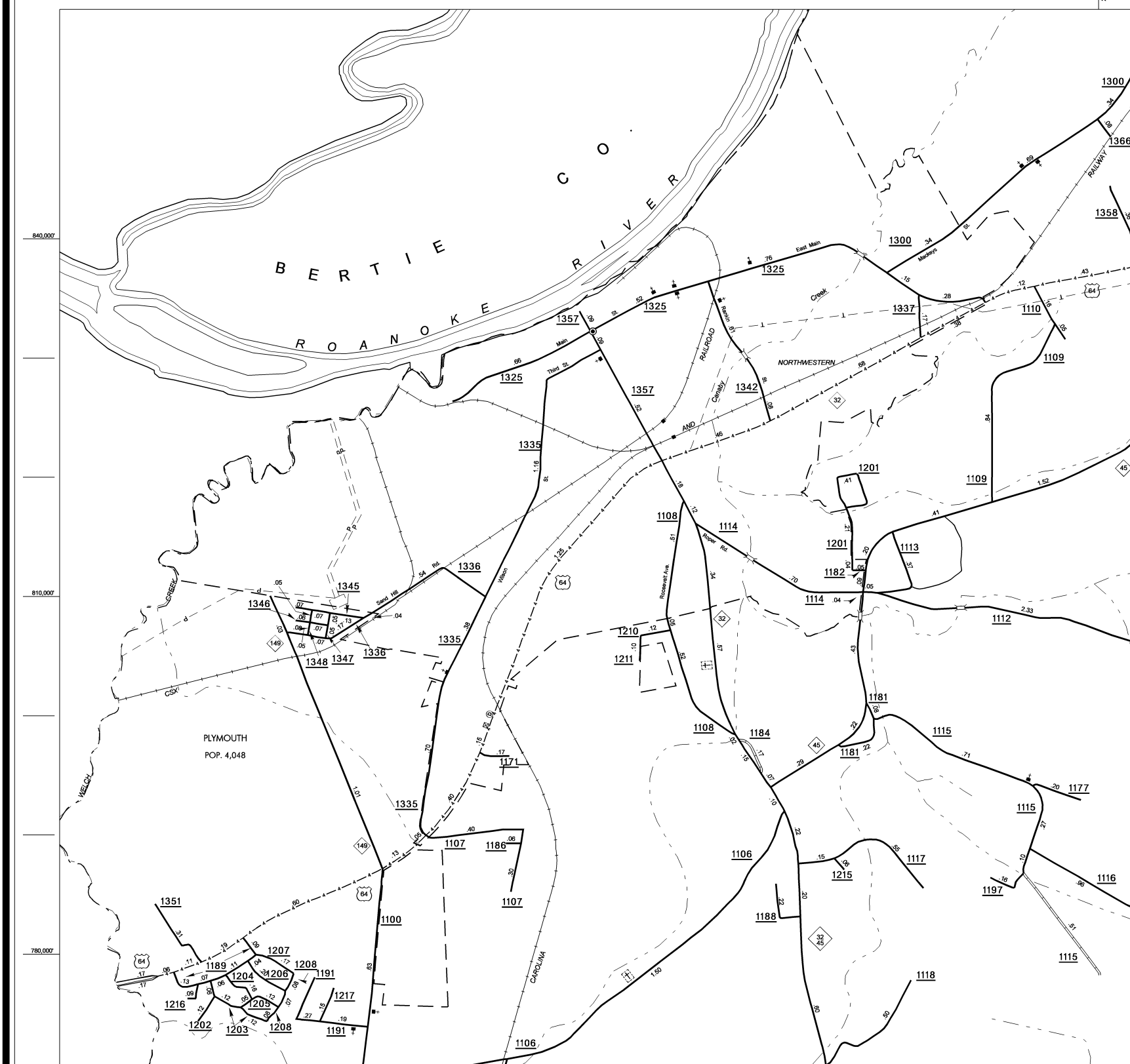

WASHINGTON COUNTY
NORTH CAROLINA
PREPARED BY THE
NORTH CAROLINA DEPARTMENT OF TRANSPORTATION
INFORMATION TECHNOLOGY - IMG UNIT
IN COOPERATION WITH THE
U.S. DEPARTMENT OF TRANSPORTATION
FEDERAL HIGHWAY ADMINISTRATION

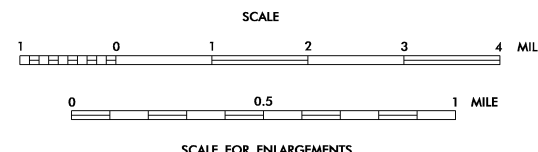

County Boundary alignments are based on
information provided by State and Federal
agencies, and are shown in their approximate
locations.

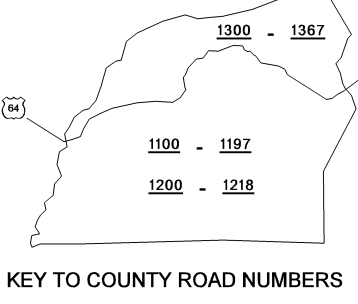

NOTE : MAP INCLUDES ONLY STATE MAINTAINED ROADS
OR IMPORTANT NON-SYSTEM ROADS
ROADS SHOWN AS OF JUNE 16, 2008

10,000 FOOT GRID BASED ON NORTH CAROLINA PLANE COORDINATE SYSTEM
POLYCONIC PROJECTION