

COPIES OF THIS MAP ARE AVAILABLE
TO THE PUBLIC AT A NOMINAL COST
ADDRESS:
N.C. DEPARTMENT OF TRANSPORTATION
INFORMATION TECHNOLOGY AND SERVICES
3401 CARI SANDERS CT.
RALEIGH, N.C. 27603

REVISED
11/13/06 TRP
7/12/06 TRP
12/20/06 TRP
02/01/07 TRP
6/06/08 TRP
6/25/08 TRP

GUILFORD

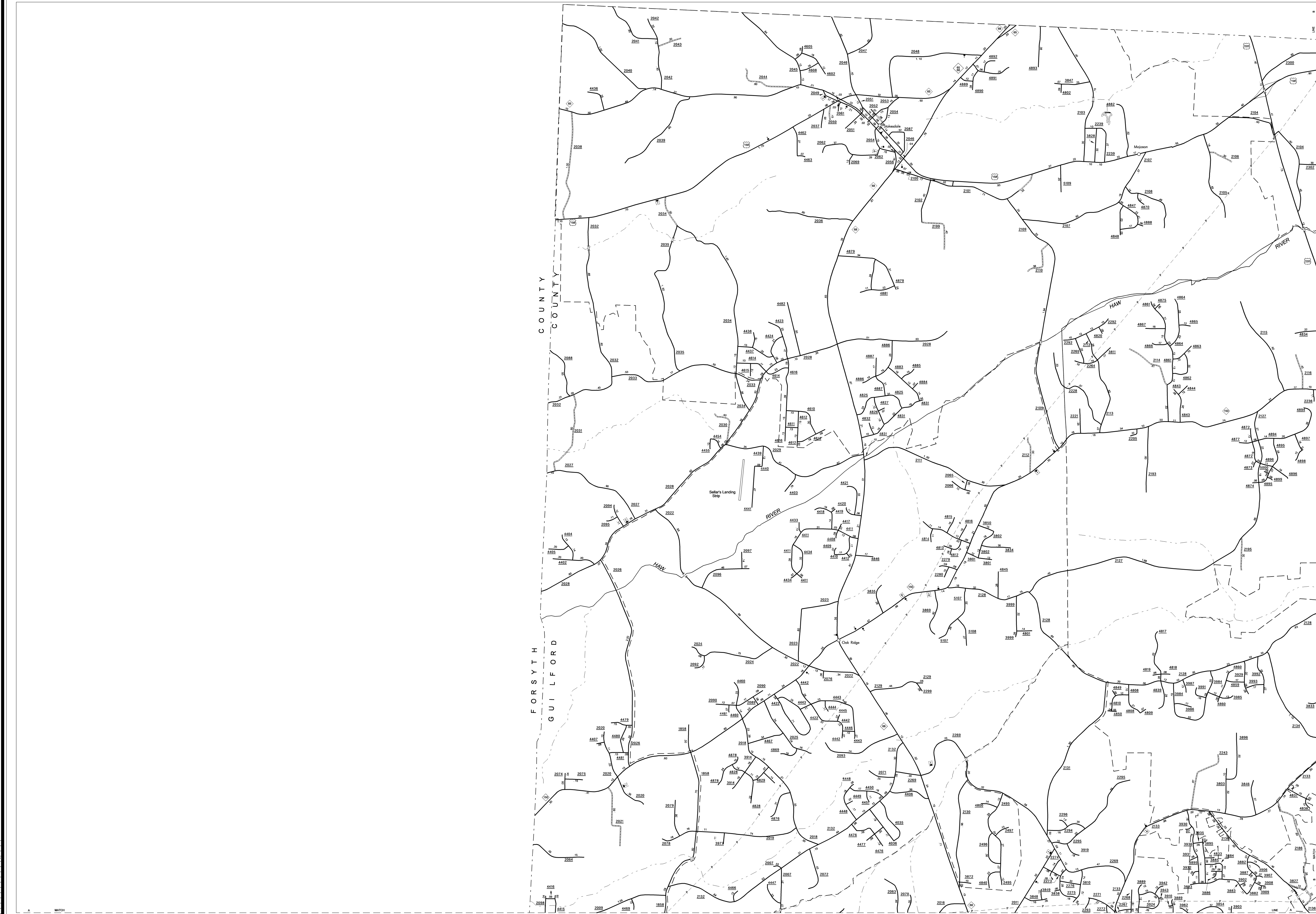

ENLARGED MUNICIPAL AND SUBURBAN AREAS

GUILFORD COUNTY

NORTH CAROLINA

PREPARED BY THE
NORTH CAROLINA DEPARTMENT OF TRANSPORTATION
INFORMATION TECHNOLOGY - IMG UNIT

IN COOPERATION WITH THE
U.S. DEPARTMENT OF TRANSPORTATION
FEDERAL HIGHWAY ADMINISTRATION

SCALE
0 1 MILE

15,000 FOOT GRID BASED ON NORTH CAROLINA PLANE COORDINATE SYSTEM
POLYCONIC PROJECTION

SHEET 2 OF 10