

COPIES OF THIS MAP ARE AVAILABLE
TO THE PUBLIC AT A NOMINAL COST
ADDRESS:
N.C. DEPARTMENT OF TRANSPORTATION
PLANNING AND RESEARCH DIVISION
3401 CHASE SANDHURST CT.
RALEIGH, N.C. 27603

REVISED
11/2006 PLM
6/16/08 BDG

GATES

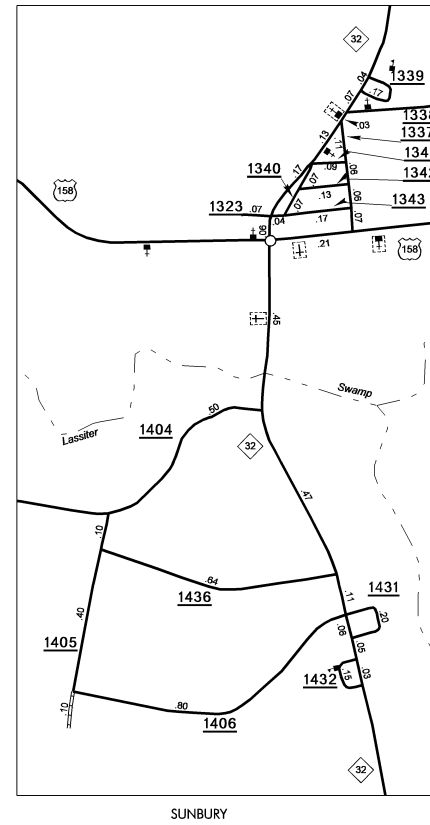

SUNBURY

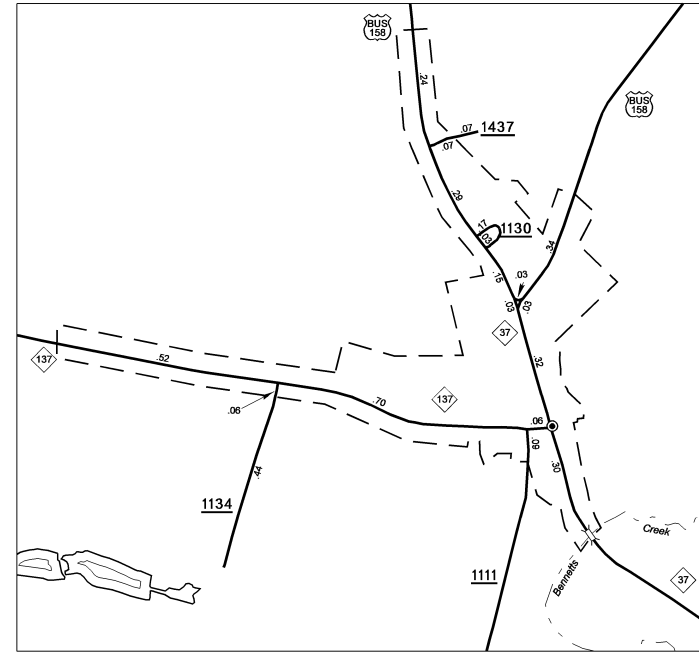

GATESVILLE
POP. 280

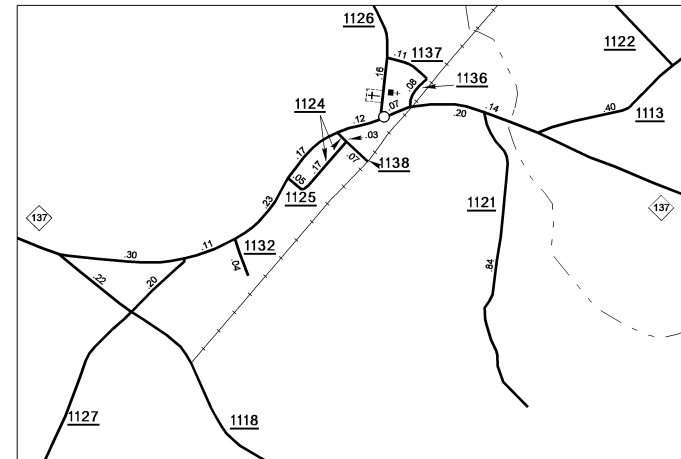

EURE

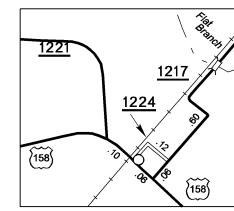

RODUCCO

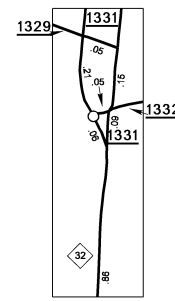

CORNPEAKE

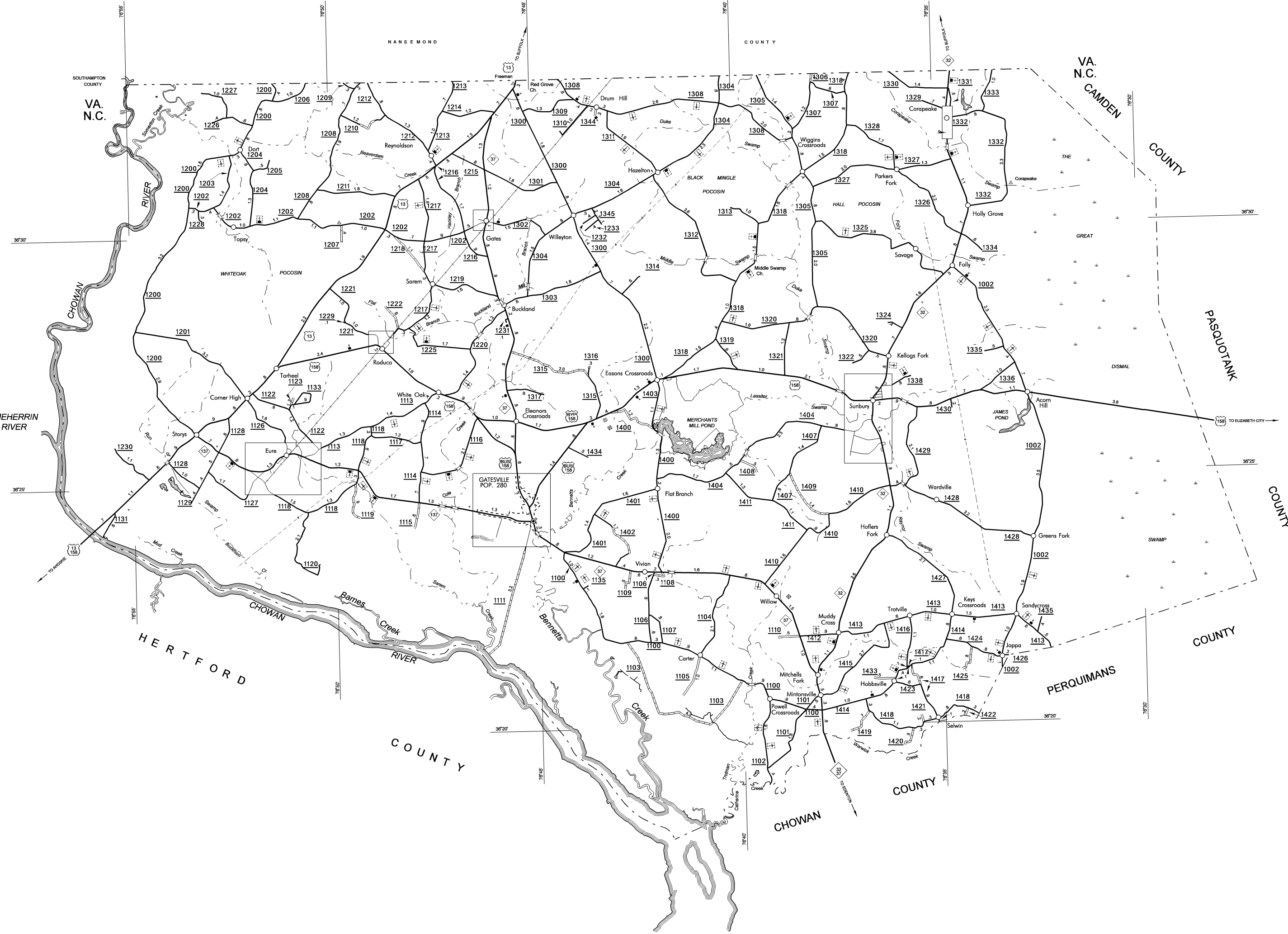

County Boundary alignments are based on
information provided by State and Federal
agencies, and are shown in their approximate
locations.



KEY TO COUNTY ROAD NUMBERS
Also Number 1002

NOTE: MAP INCLUDES ONLY STATE MAINTAINED ROADS
OR IMPORTANT NON-SYSTEM ROADS.
ROADS SHOWN AS OF JUNE 16, 2008



GATES COUNTY

NORTH CAROLINA

PREPARED BY THE
NORTH CAROLINA DEPARTMENT OF TRANSPORTATION
INFORMATION TECHNOLOGY - IMG UNIT

IN COOPERATION WITH THE
U.S. DEPARTMENT OF TRANSPORTATION
FEDERAL HIGHWAY ADMINISTRATION

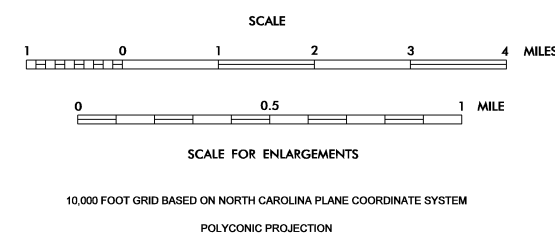

10,000 FOOT GRID BASED ON NORTH CAROLINA PLANE COORDINATE SYSTEM
POLYCONIC PROJECTION