

COPIES OF THIS MAP ARE AVAILABLE
TO THE PUBLIC AT A NOMINAL COST
ADDRESS:
N.C. DEPARTMENT OF TRANSPORTATION
3401 CARL SANDERS CT.
RALEIGH, N.C. 27603

REVISED
2/12/08 MG
6/9/08 MG
8/6/08 MG

CRAVEN SUP 2

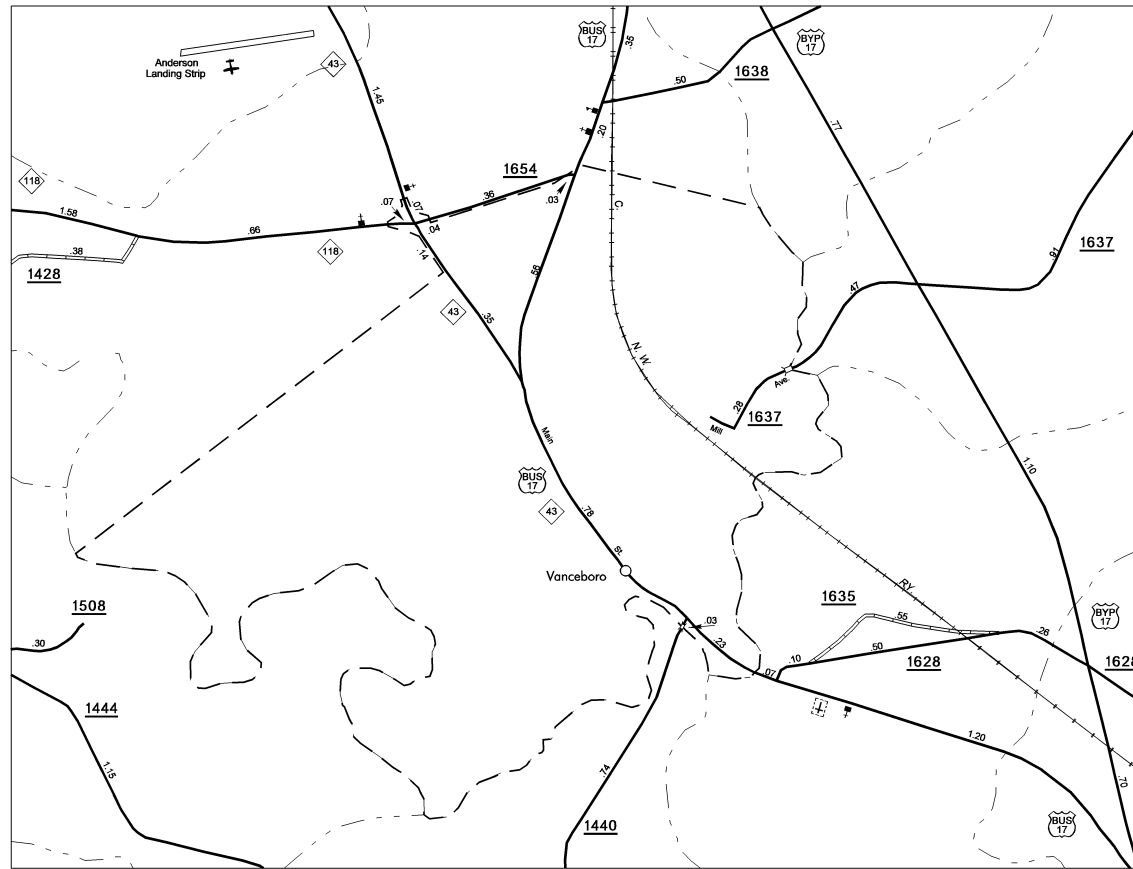

Vancleboro
Pop. 889

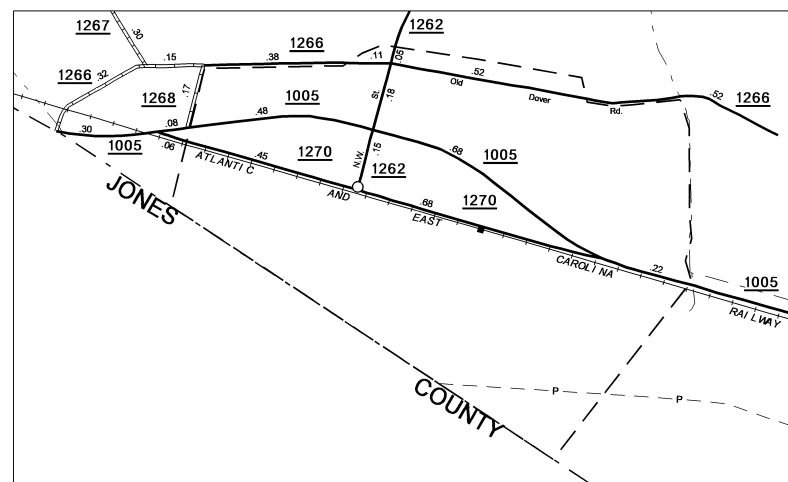

Dover
Pop. 441

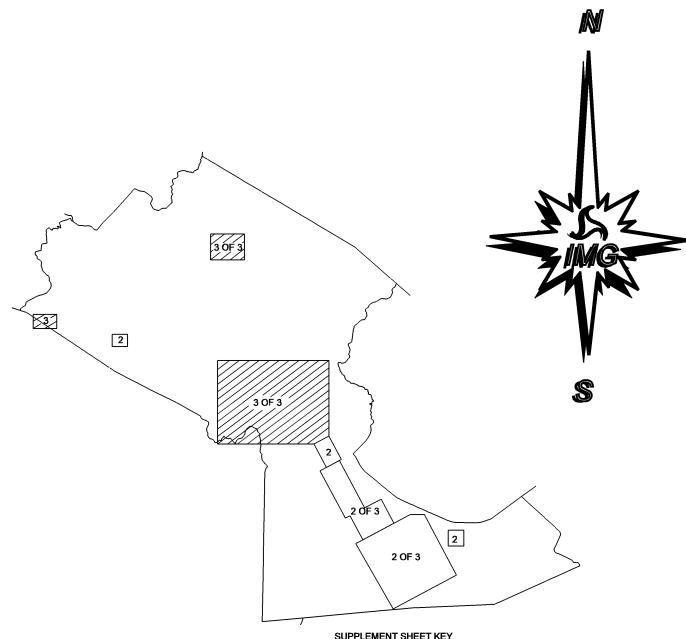

ENLARGED MUNICIPAL AND SUBURBAN AREAS

CRAVEN COUNTY

NORTH CAROLINA

PREPARED BY THE
NORTH CAROLINA DEPARTMENT OF TRANSPORTATION
INFORMATION TECHNOLOGY - IMG UNIT

IN COOPERATION WITH THE
U.S. DEPARTMENT OF TRANSPORTATION
FEDERAL HIGHWAY ADMINISTRATION

SCALE
1 0 1 MILE

10,000 FOOT GRID BASED ON NORTH CAROLINA PLANE COORDINATE SYSTEM
POLYCONIC PROJECTION

SHEET 3 OF 3