

COPIES OF THIS MAP ARE AVAILABLE  
TO THE PUBLIC AT A NOMINAL COST  
ADDRESS:  
N.C. DEPARTMENT OF TRANSPORTATION  
GIS/COMMUNICATIONS INFORMATION SYSTEMS  
3000 W. GARRISON STREET  
RALEIGH, N.C. 27610

REVISED  
17/03 RLN  
2/6/03 RLN  
3/31/03 RLN  
6/26/03 RLN  
11/17/03 RLN  
2/17/04 RLN  
4/14/04 RLN  
4/28/04 RLN  
8/13/04 RLN  
8/20/04 RLN  
1/31/05 RLN

GUILFORD

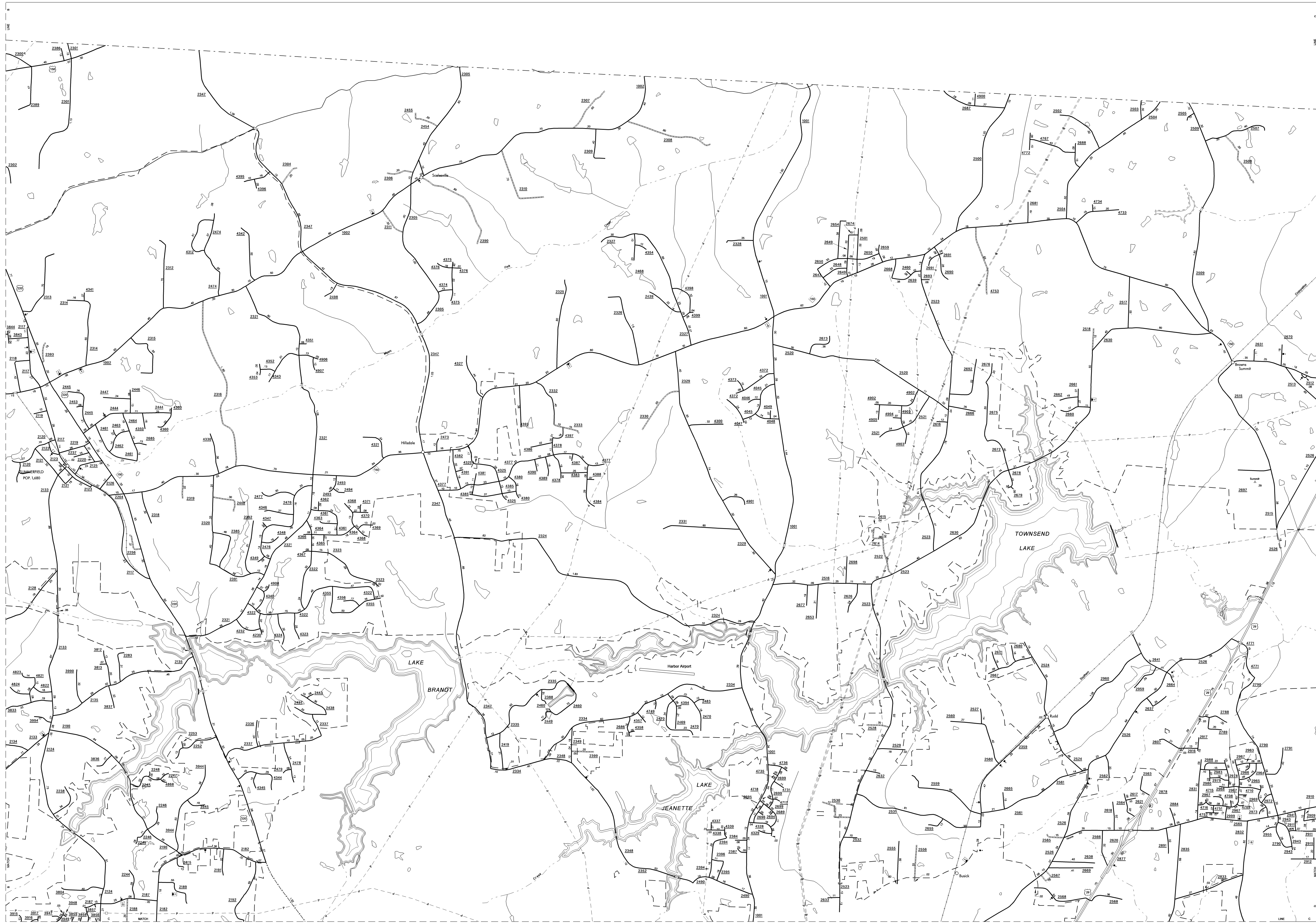

ENLARGED MUNICIPAL AND SUBURBAN AREAS

# GUILFORD COUNTY

## NORTH CAROLINA

PREPARED BY THE  
NORTH CAROLINA DEPARTMENT OF TRANSPORTATION  
DIVISION OF HIGHWAYS - GIS UNIT

IN COOPERATION WITH THE  
U.S. DEPARTMENT OF TRANSPORTATION  
FEDERAL HIGHWAY ADMINISTRATION

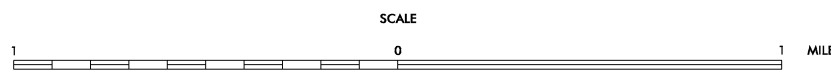

10,000 FOOT GRID BASED ON NORTH CAROLINA PLANE COORDINATE SYSTEM  
POLYCONIC PROJECTION

SHEET 3 OF 10