

COPY OF THIS MAP ARE AVAILABLE
TO THE PUBLIC AT A NOMINAL COST
ADDRESS:
N.C. DEPARTMENT OF TRANSPORTATION
GIS/CARTOGRAPHIC INFORMATION SYSTEMS
100 SOUTH PARKWAY
RALEIGH, N.C. 27610

REVISED
17/03 RLN
2/03 RLN
3/03 RLN
6/03 RLN
11/17/03 RLN
2/17/04 RLN
4/15/04 RLN
6/28/04 RLN
8/13/04 RLN
9/30/04 RLN
1/31/05 RLN

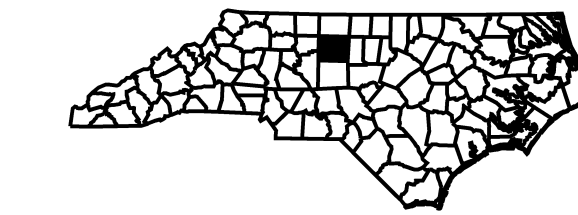

NOTE: MAP INCLUDES ONLY STATE MAINTAINED ROADS
OR IMPORTANT NON-SYSTEM ROADS.
ROADS SHOWN AS OF JAN 30, 2005

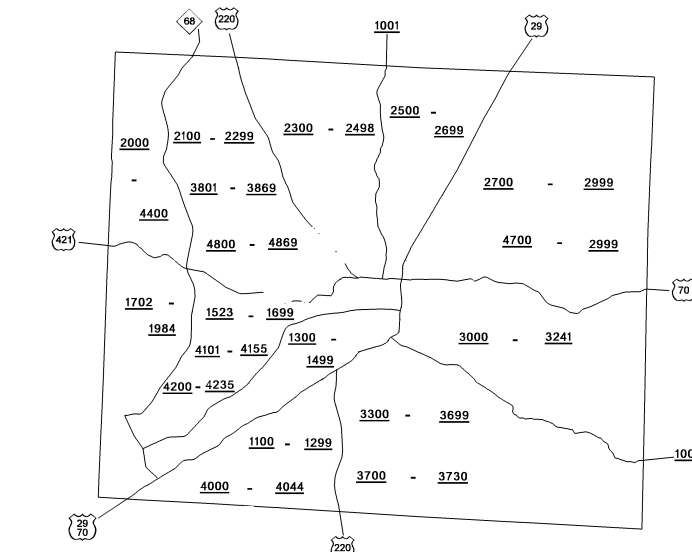
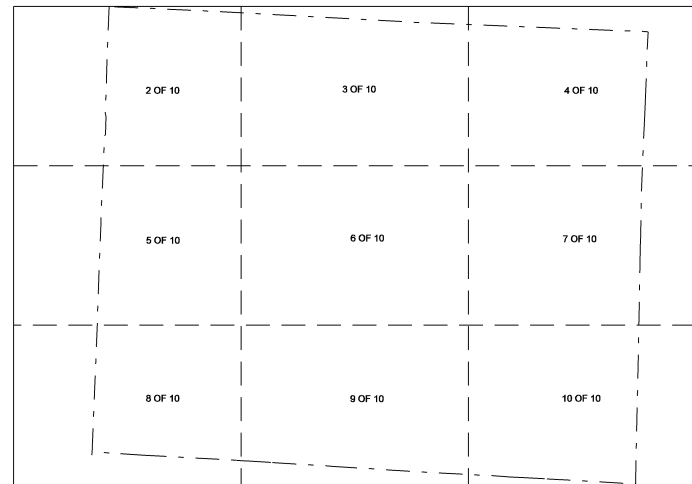
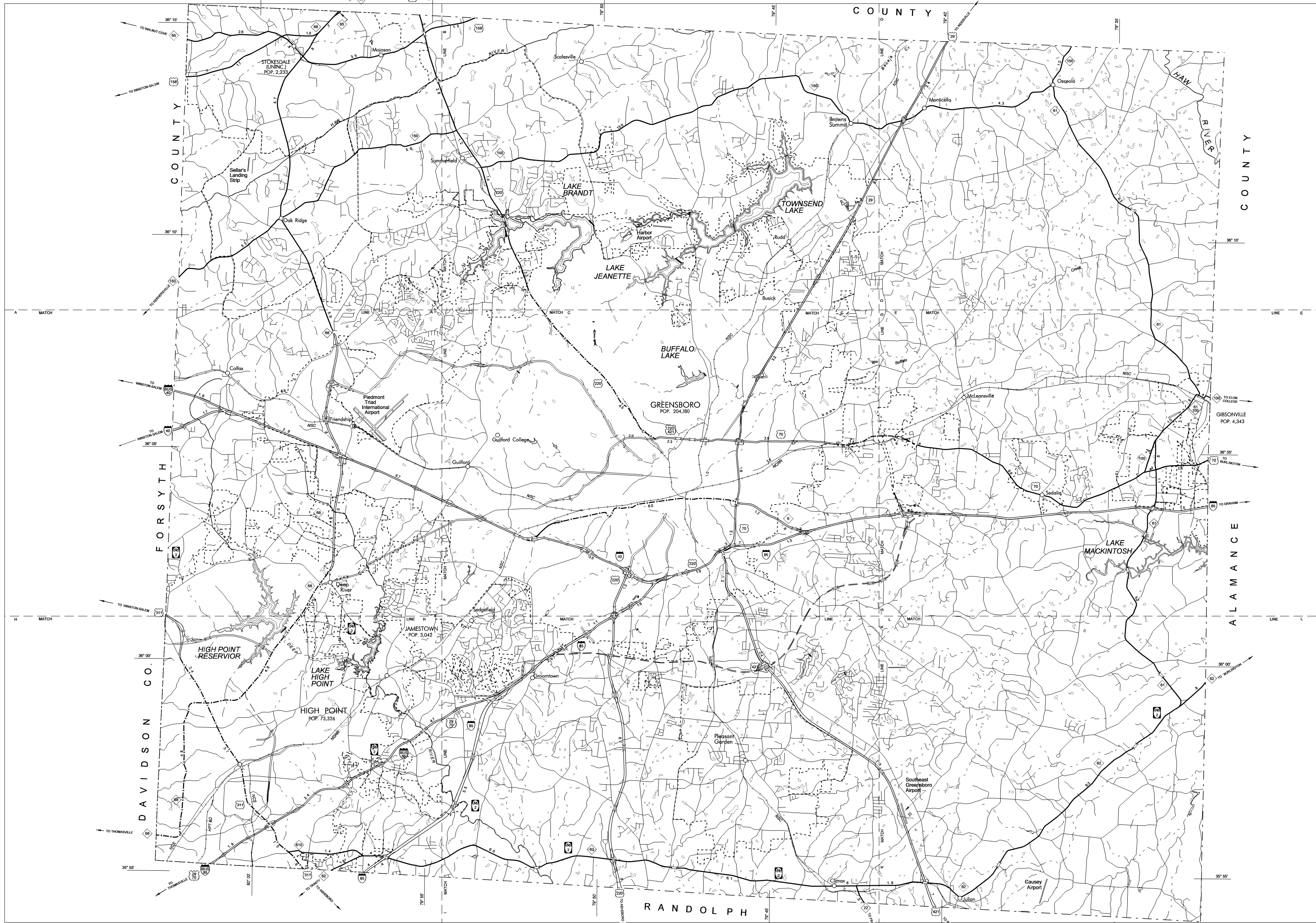

GUILFORD COUNTY

NORTH CAROLINA

PREPARED BY THE
NORTH CAROLINA DEPARTMENT OF TRANSPORTATION
DIVISION OF HIGHWAYS - GIS UNIT
IN COOPERATION WITH THE
U.S. DEPARTMENT OF TRANSPORTATION
FEDERAL HIGHWAY ADMINISTRATION

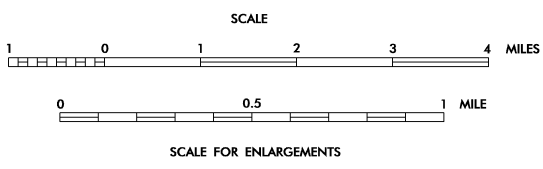

10,000 FOOT GRID BASED ON NORTH CAROLINA PLANE COORDINATE SYSTEM
POLYCONIC PROJECTION