

Copies of this map are available  
to the public at a nominal cost.  
N.C. DEPARTMENT OF TRANSPORTATION  
GIS DATA INFORMATION SYSTEMS  
ADDRESS:  
RALEIGH, N.C. 27610

REVISED  
4/7/02 R/LN  
6/18/02 R/LN  
11/19/02 R/LN  
1/7/03 R/LN  
2/12/03 R/LN  
3/28/03 R/LN  
6/28/03 R/LN  
2/17/04 R/LN  
6/14/04 R/LN  
6/23/04 R/LN  
8/20/04 R/LN  
10/18/04 R/LN

ALAMANCE



Burlington - Gibsonville - Graham vicinity

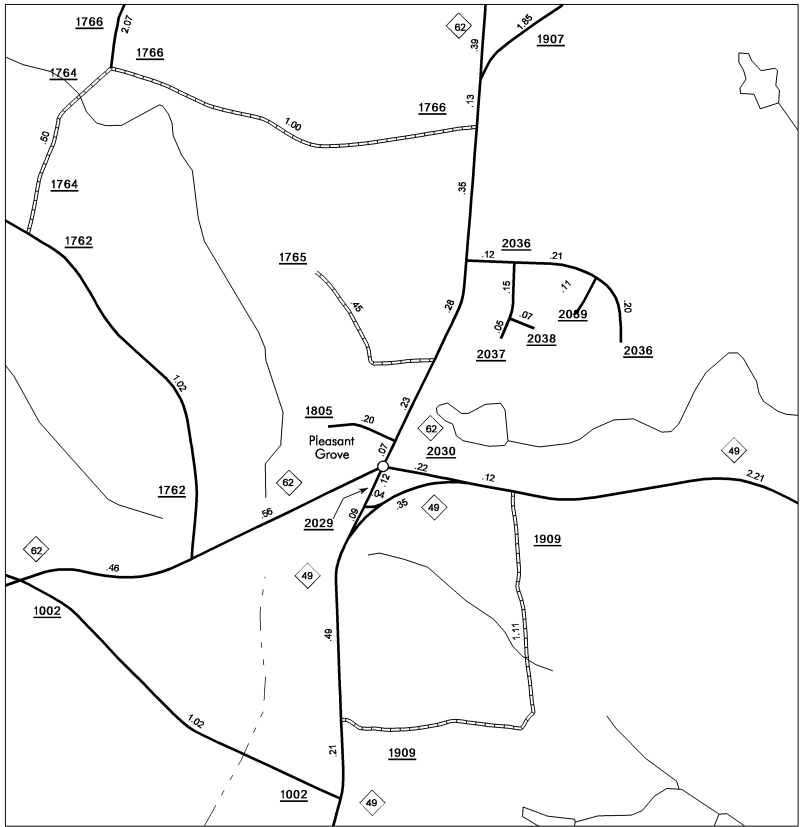

Pleasant Grove

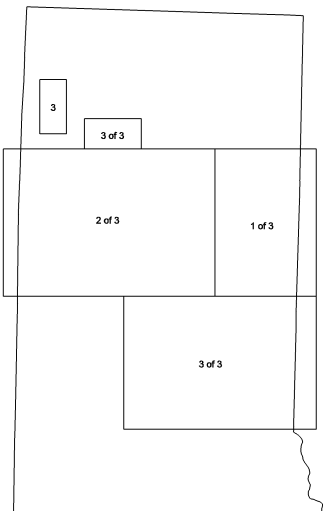

SUPPLEMENT KEY



ENLARGED MUNICIPAL AND SUBURBAN AREAS

# ALAMANCE COUNTY

## NORTH CAROLINA

PREPARED BY THE  
NORTH CAROLINA DEPARTMENT OF TRANSPORTATION  
DIVISION OF HIGHWAYS - GIS UNIT

IN COOPERATION WITH THE  
U.S. DEPARTMENT OF TRANSPORTATION  
FEDERAL HIGHWAY ADMINISTRATION

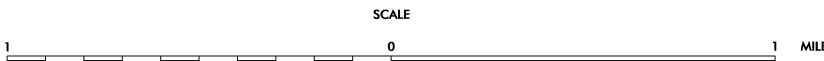

10,000 FOOT GRID BASED ON NORTH CAROLINA PLANE COORDINATE SYSTEM

POLYCONIC PROJECTION

SHEET 2 OF 3