

ADDRESS: MAPS, N.C. DEPARTMENT OF TRANSPORTATION  
DIVISION OF HIGHWAYS  
RALEIGH, NORTH CAROLINA, 27611

REVISED
1/1/95 JMB
1/7/97 DDR
10/1/97 DDR
1/1/98 DDR
6/1/98 DDR
12/1/98
9/6/00
2/25/02 MEM

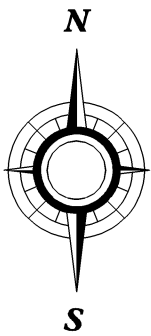
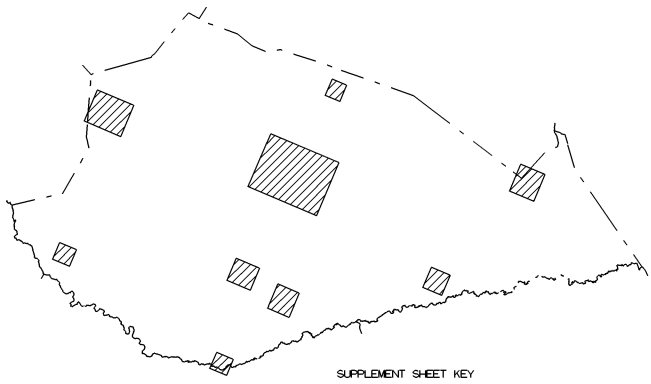
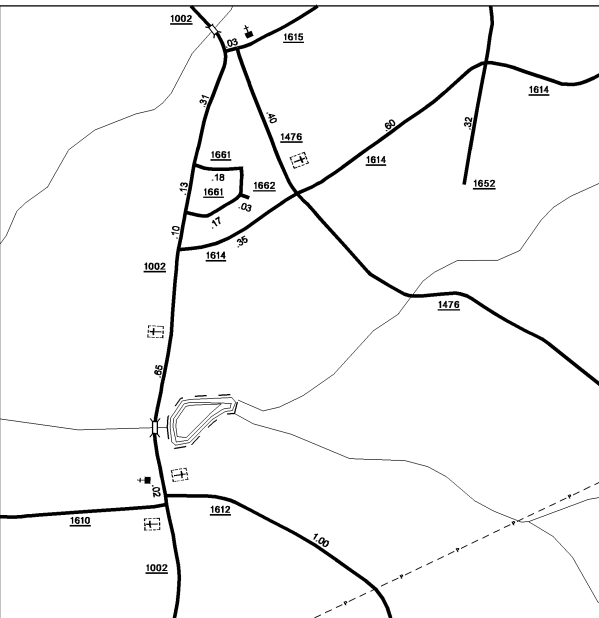
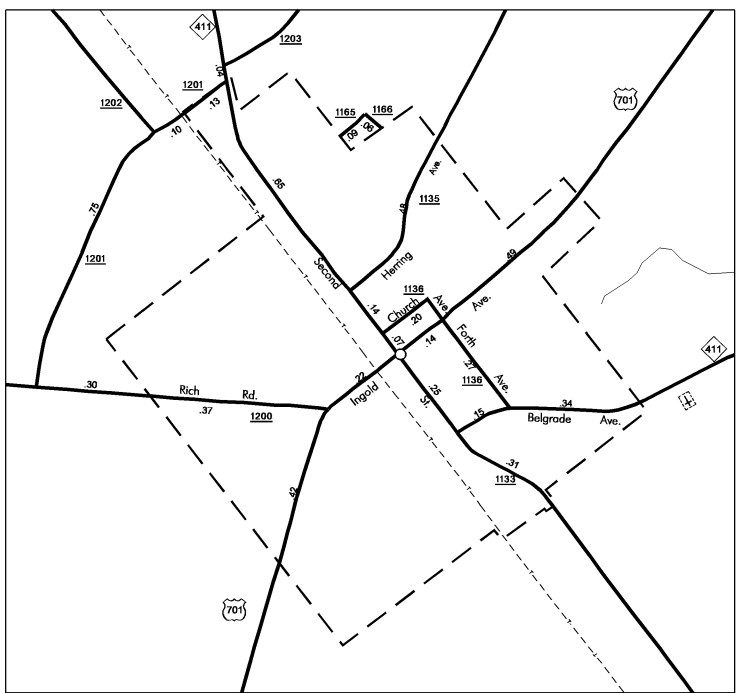
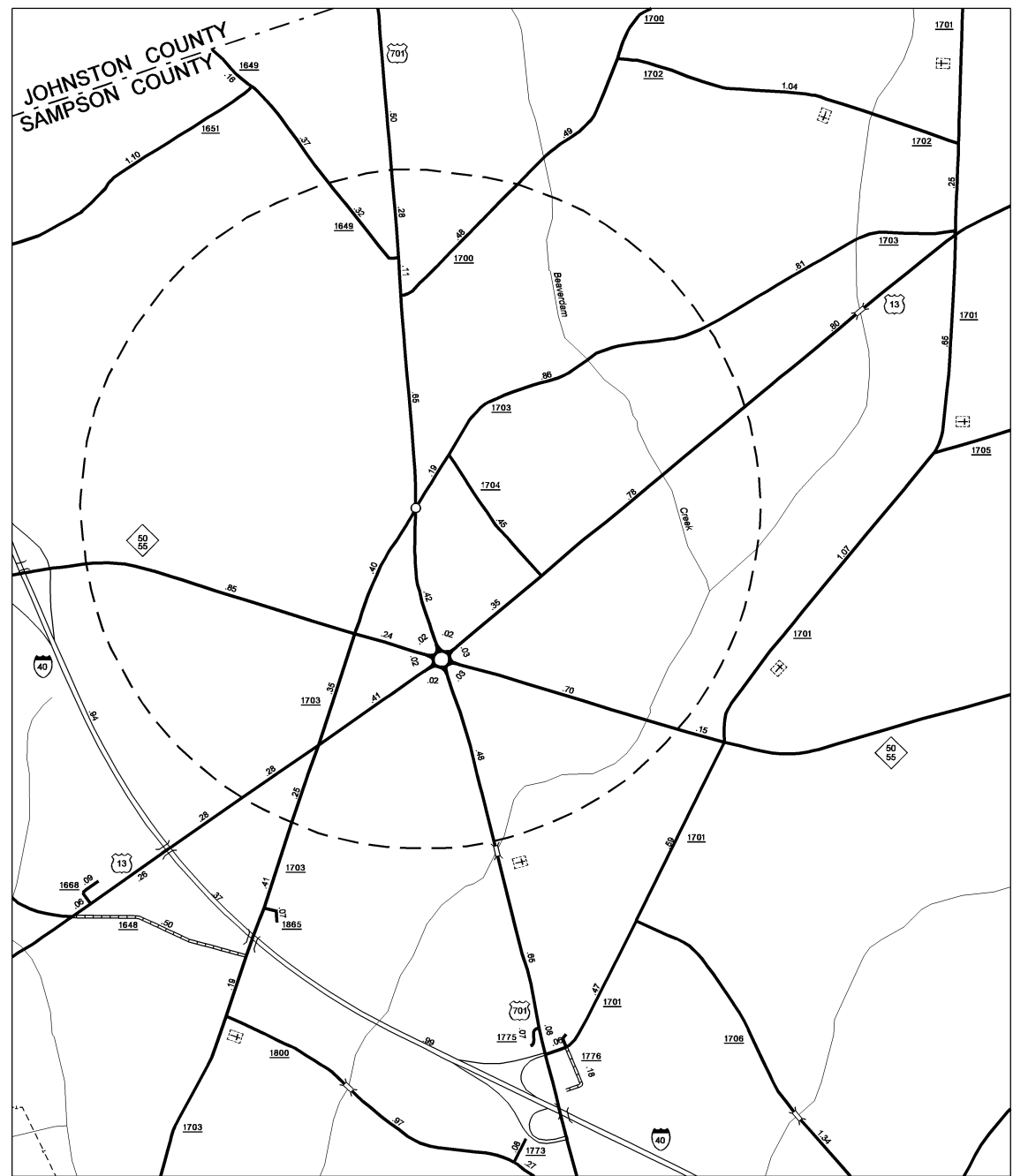
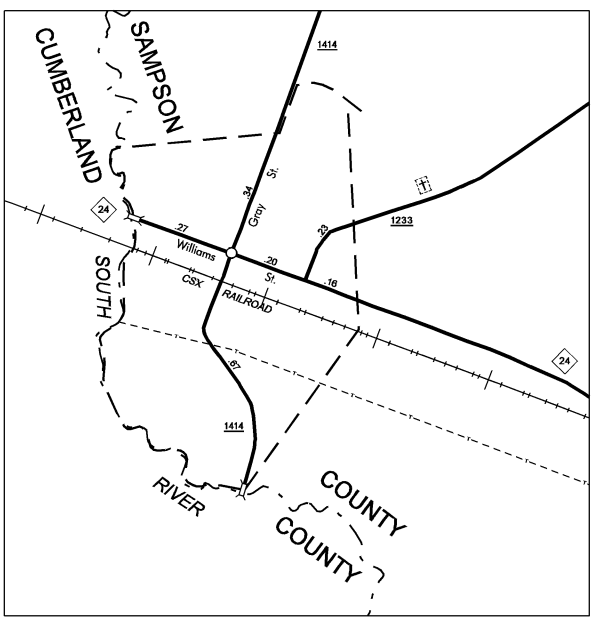
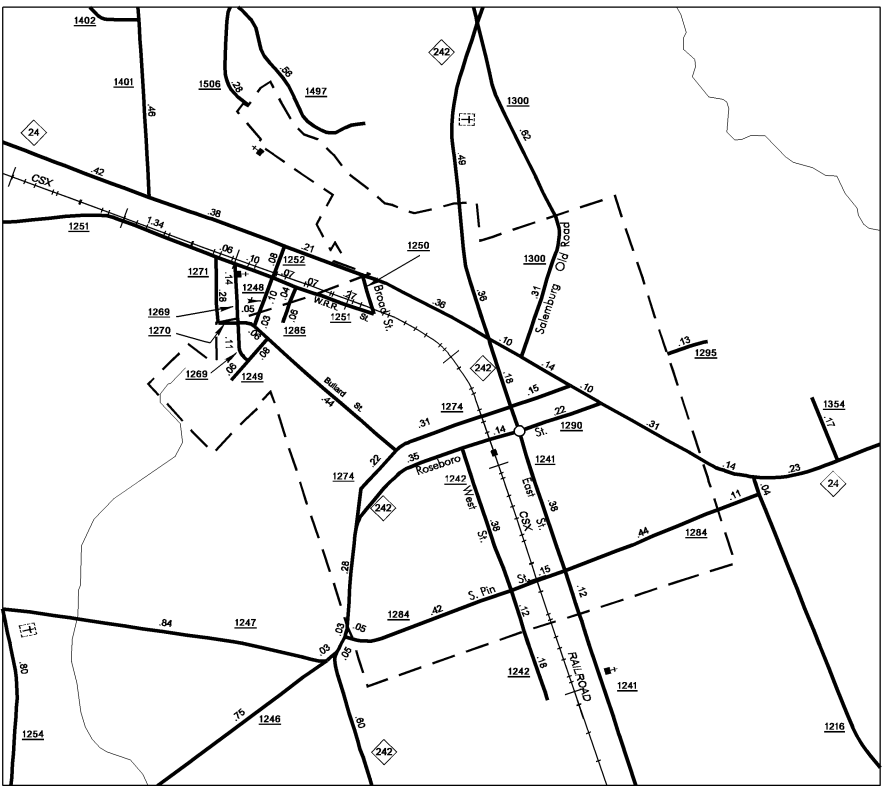
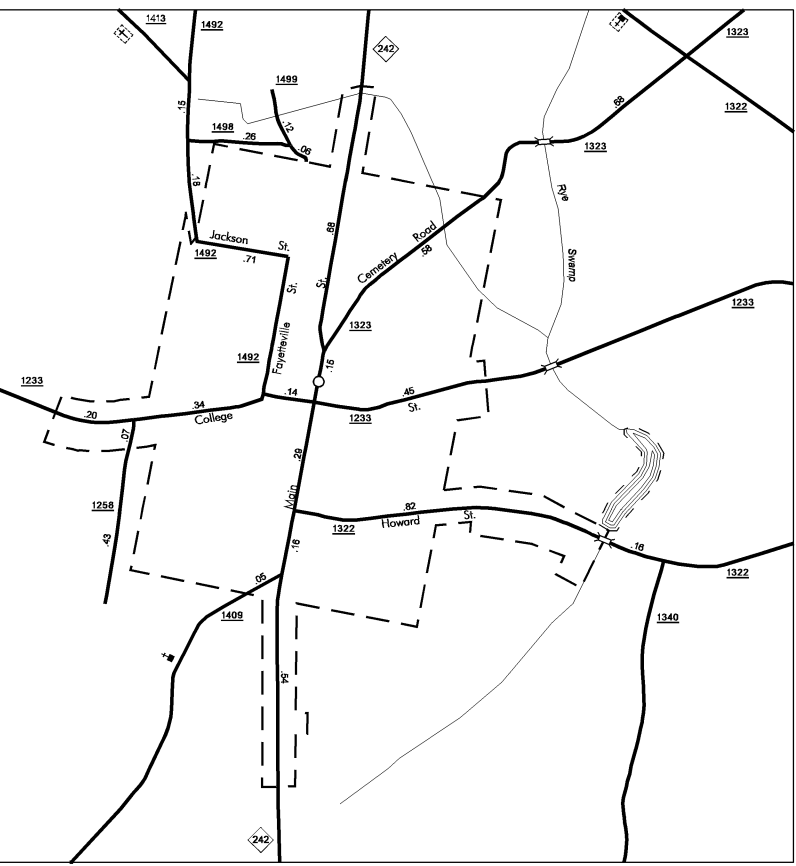
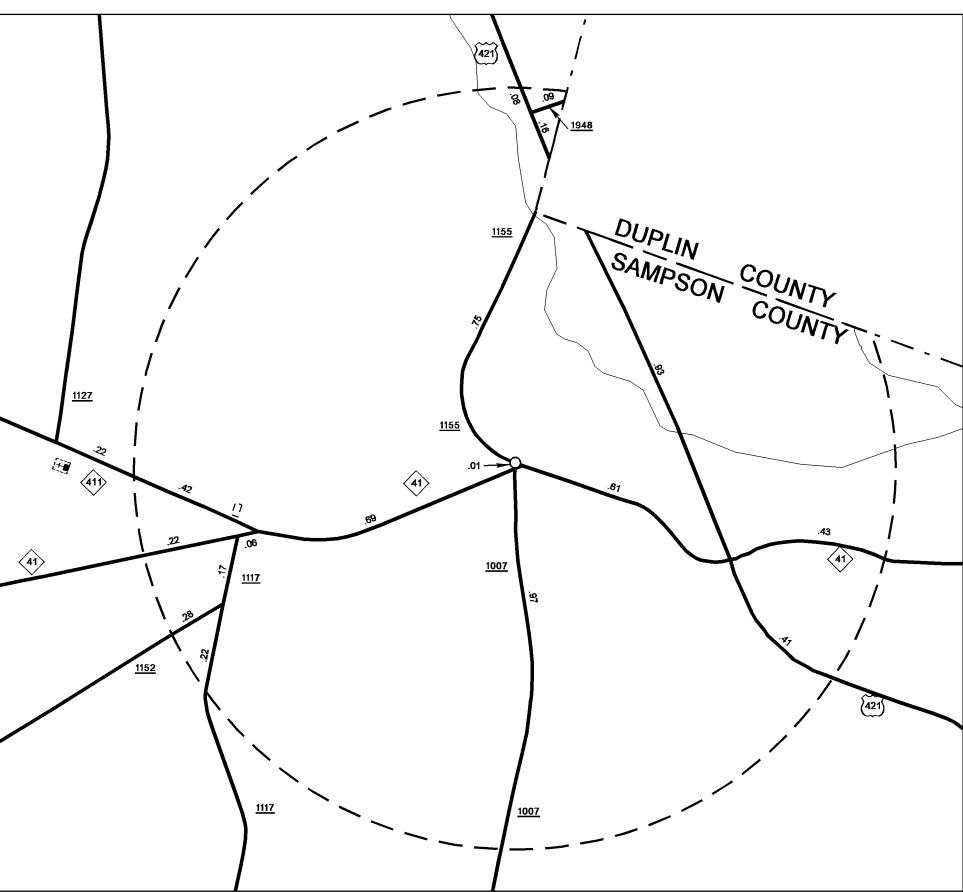
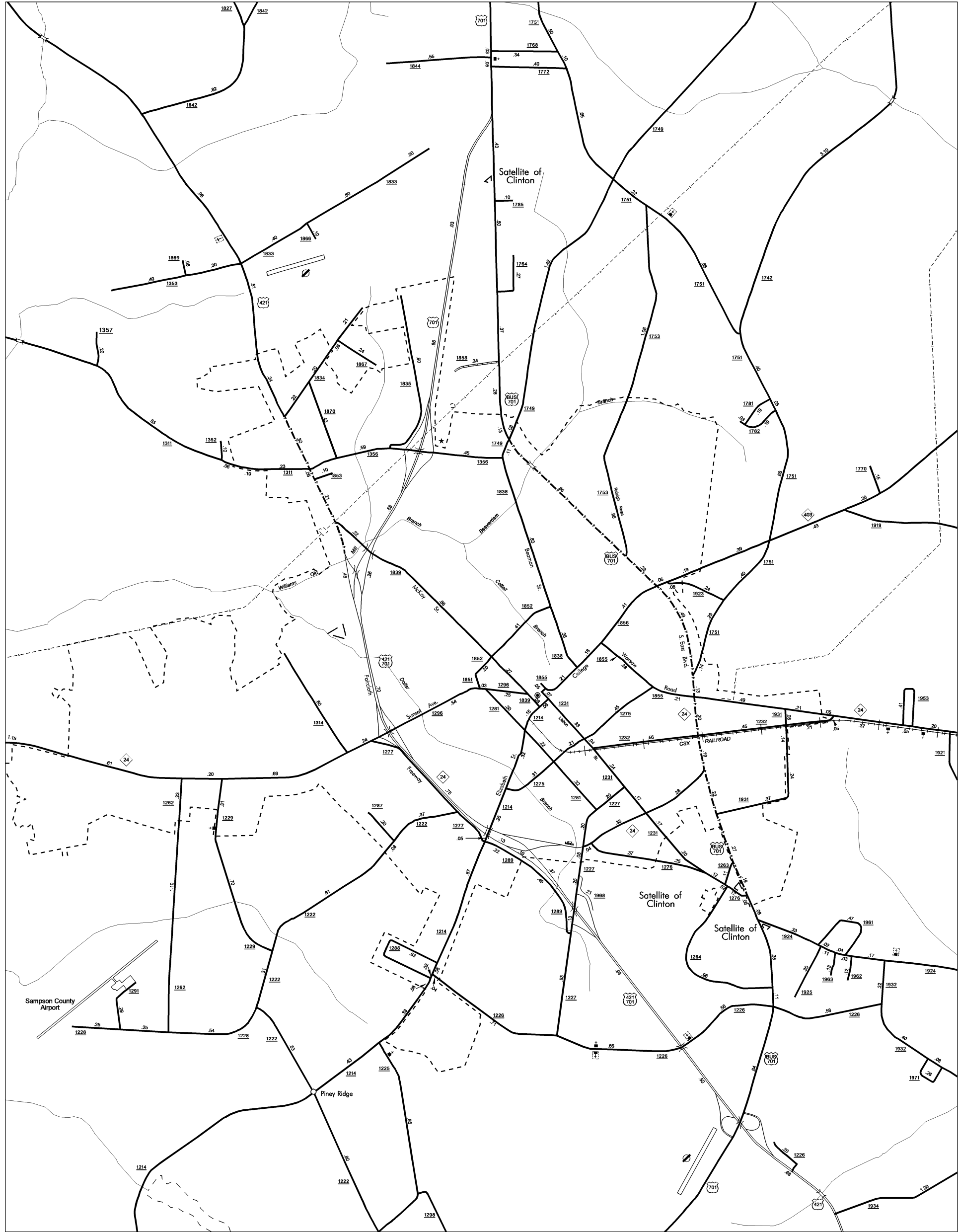

ENLARGED MUNICIPAL AND SUBURBAN AREAS

# SAMPSON COUNTY

## NORTH CAROLINA

PREPARED BY THE

NORTH CAROLINA DEPARTMENT OF TRANSPORTATION  
DIVISION OF HIGHWAYS - GIS UNIT

IN COOPERATION WITH THE

U.S.DEPARTMENT OF TRANSPORTATION  
FEDERAL HIGHWAY ADMINISTRATION

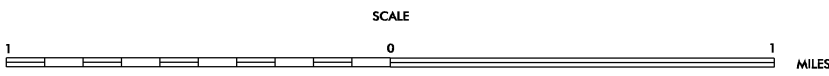

POLYCONIC PROJECTION