

ROBESON

SUP - 1

COPIES OF THIS MAP ARE AVAILABLE
TO THE PUBLIC AT A NOMINAL COST.
ADDRESS: MAPS, N.C. DEPARTMENT OF TRANSPORTATION
DIVISION OF HIGHWAYS
RALEIGH, NORTH CAROLINA 27611

REVISED
7/1/97 RLN
2/2/99 RLN
9/9/99 RLN
12/6/00 RLN
10/17/01 BCS
1/8/02 BCS
2/7/02 BCS
6/13/02 BCS
11/01/02 BCS
01/02/03 BCS
01/30/03 BCS
03/20/03 BCS

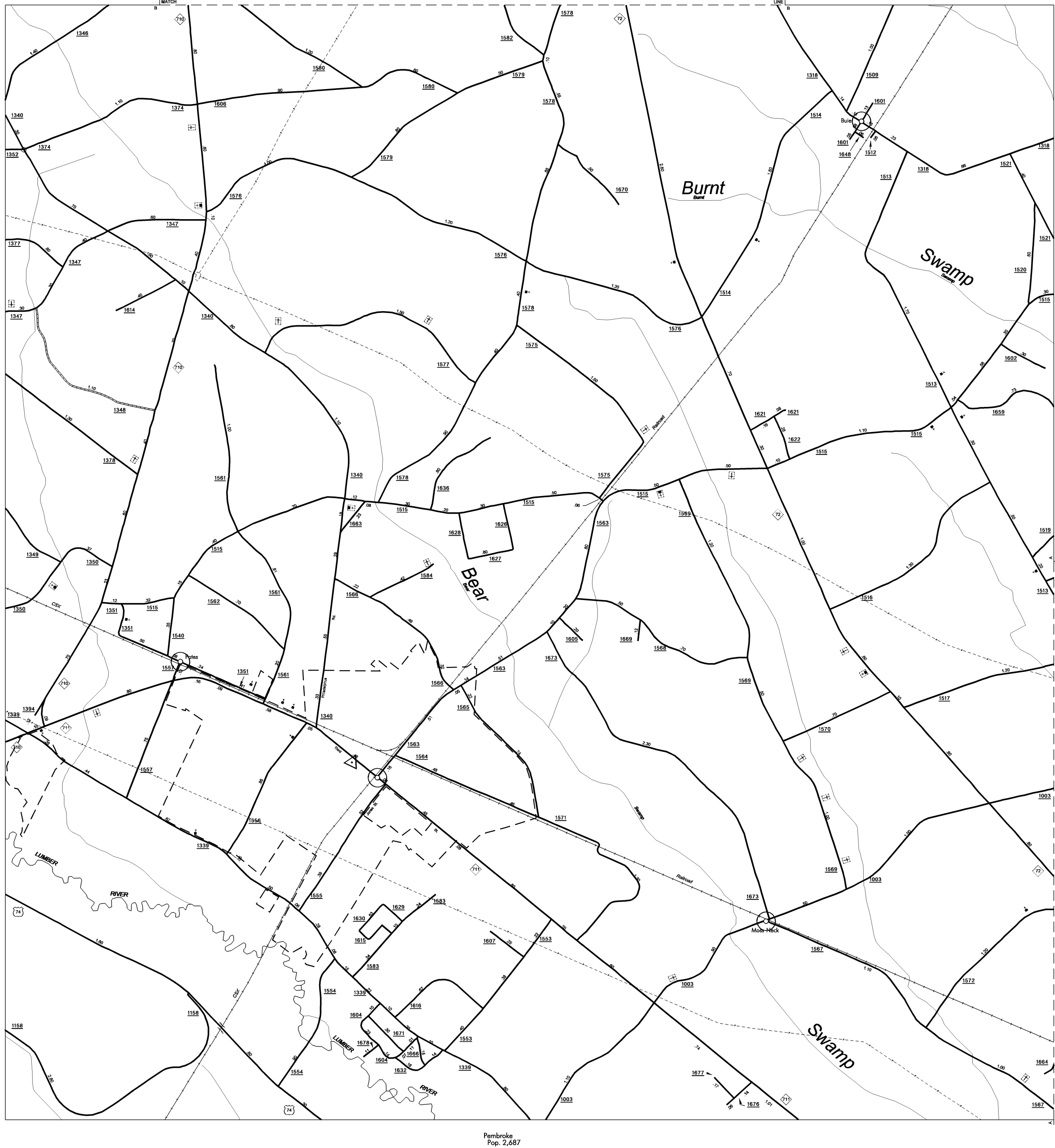

Pembroke
Pop. 2,687

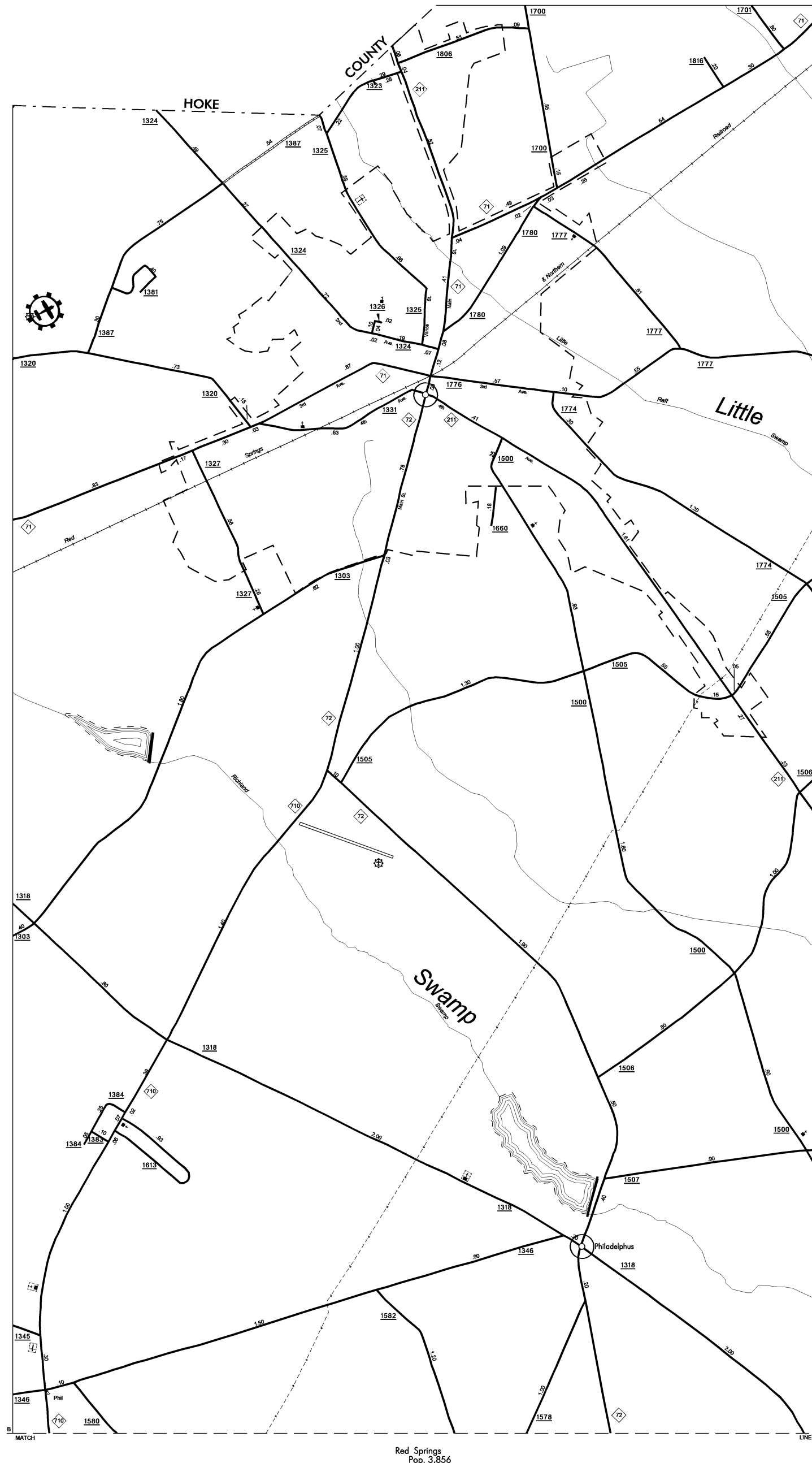

Red Springs
Pop. 3,956



Proctorville
Pop. 173

Orum
Pop. 167

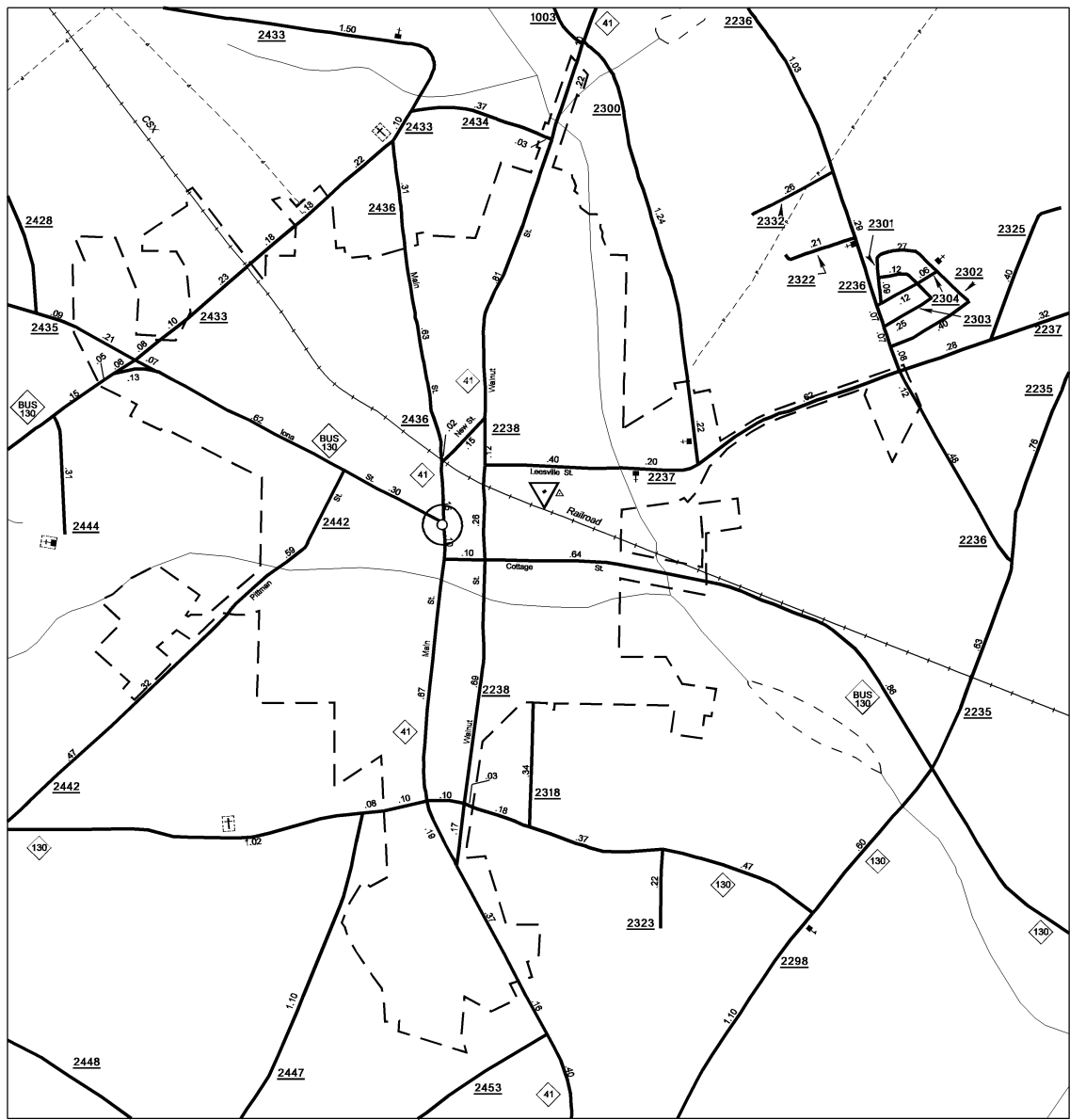

Fairmont
Pop. 2,855

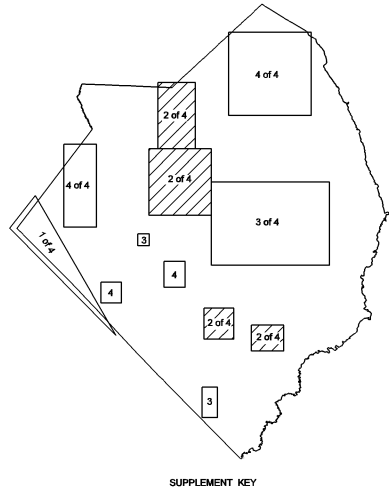

SUPPLEMENT KEY

ENLARGED MUNICIPAL AND SUBURBAN AREAS

ROBESON COUNTY

NORTH CAROLINA

PREPARED BY THE
NORTH CAROLINA DEPARTMENT OF TRANSPORTATION
DIVISION OF HIGHWAYS - GIS UNIT

IN COOPERATION WITH THE
U.S. DEPARTMENT OF TRANSPORTATION
FEDERAL HIGHWAY ADMINISTRATION

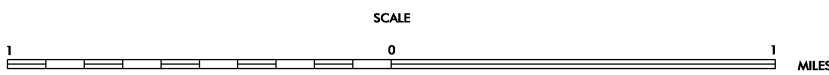

10,000 FOOT GRID BASED ON NORTH CAROLINA PLANE COORDINATE SYSTEM
POLYCONIC PROJECTION

SHEET 2 OF 4