

JACKSON

SUP. 2

COPIES OF THIS MAP ARE AVAILABLE
TO THE PUBLIC AT A NOMINAL COST.
ADDRESS: MAPS, N.C. DEPARTMENT OF TRANSPORTATION
DIVISION OF HIGHWAYS
RALEIGH, NORTH CAROLINA 27611

REVISED
1/1/95 RLJ/N
1/29/96 JMB
1/29/96 JMB
3/15/99 JMB
9/30/99 JMB
5/23/02 BDG
1/8/03 BDG
3/17/03 BDG

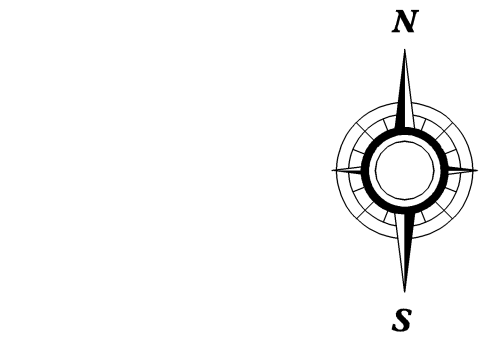
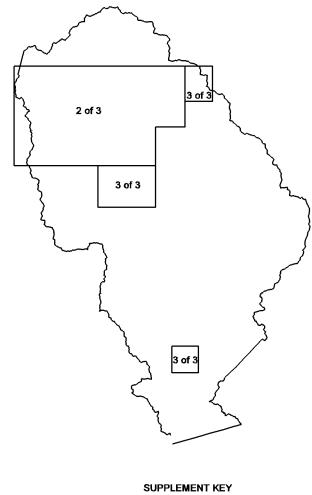
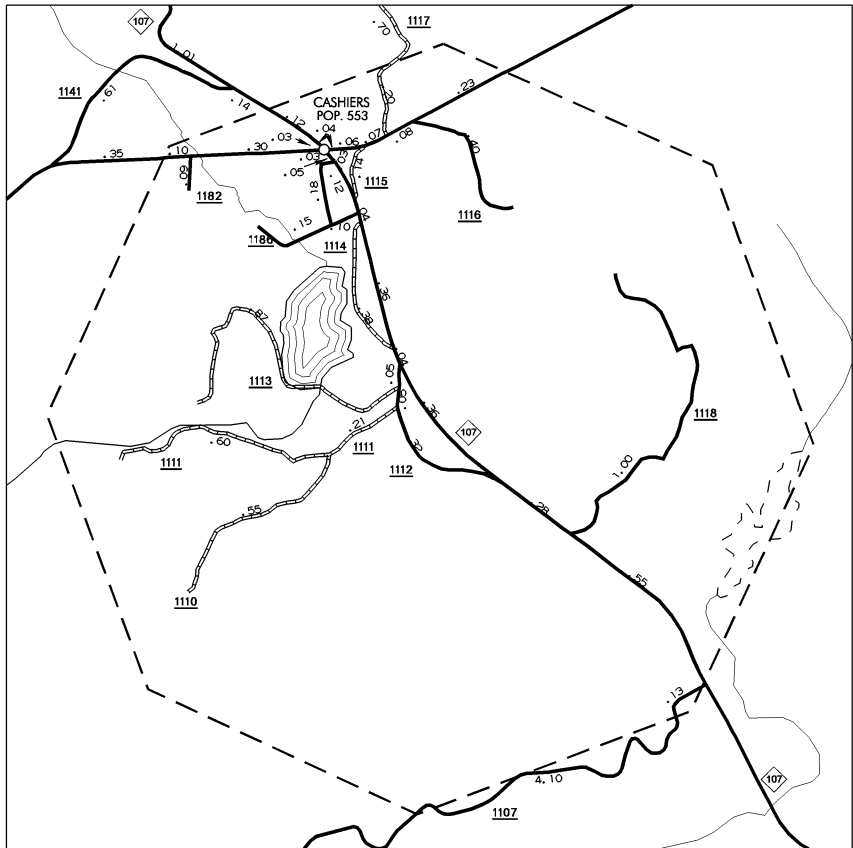
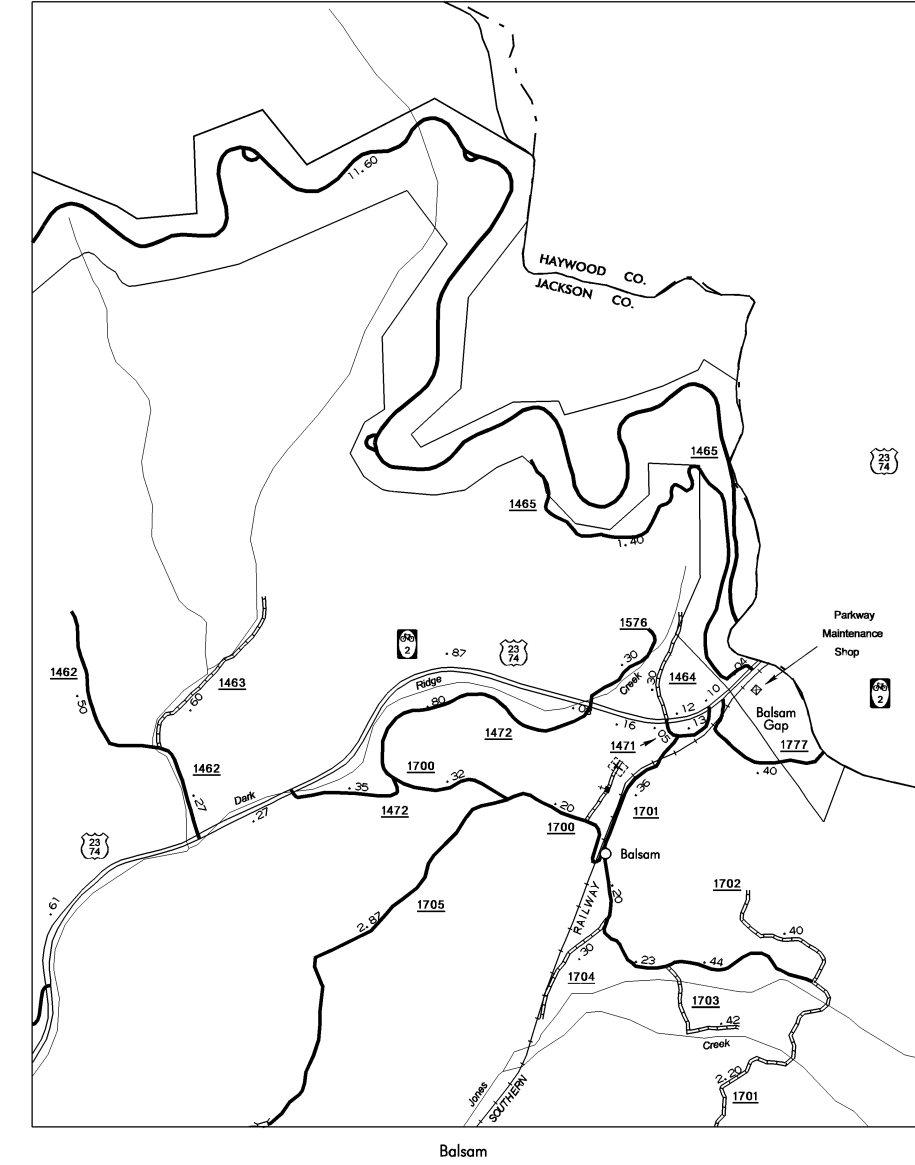
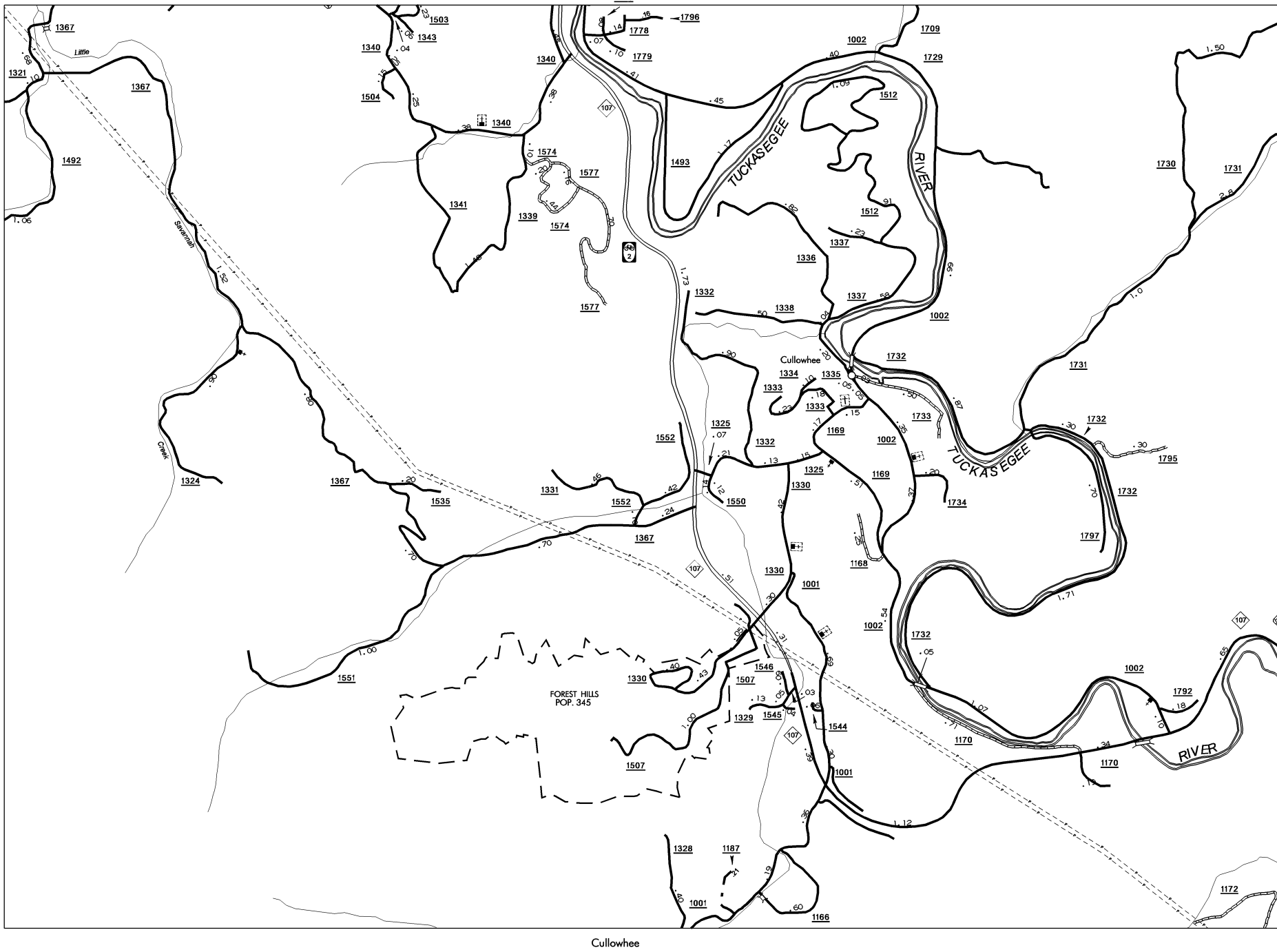

ENLARGED MUNICIPAL AND SUBURBAN AREAS

JACKSON COUNTY

NORTH CAROLINA

PREPARED BY THE
NORTH CAROLINA DEPARTMENT OF TRANSPORTATION
DIVISION OF HIGHWAYS - GIS UNIT

IN COOPERATION WITH THE
U.S. DEPARTMENT OF TRANSPORTATION
FEDERAL HIGHWAY ADMINISTRATION

SCALE
1 0 1 MILES