

HYDE COUNTY SUP-1

COPIES OF THIS MAP ARE AVAILABLE
TO THE PUBLIC AT A NOMINAL COST.
ADDRESS: MAPS, N.C. DEPARTMENT OF TRANSPORTATION
DIVISION OF HIGHWAYS
RALEIGH, NORTH CAROLINA 27611

REVISED
1/1/95 EOR
1/10/97 JOT
3/5/98 ABR
12/1/98 ABR
10/1/99 CH
6/7/00 CH
3/30/01 MSH
1/14/02 MSG
3/11/03 MSG
3/17/03 MSG

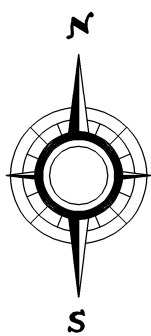
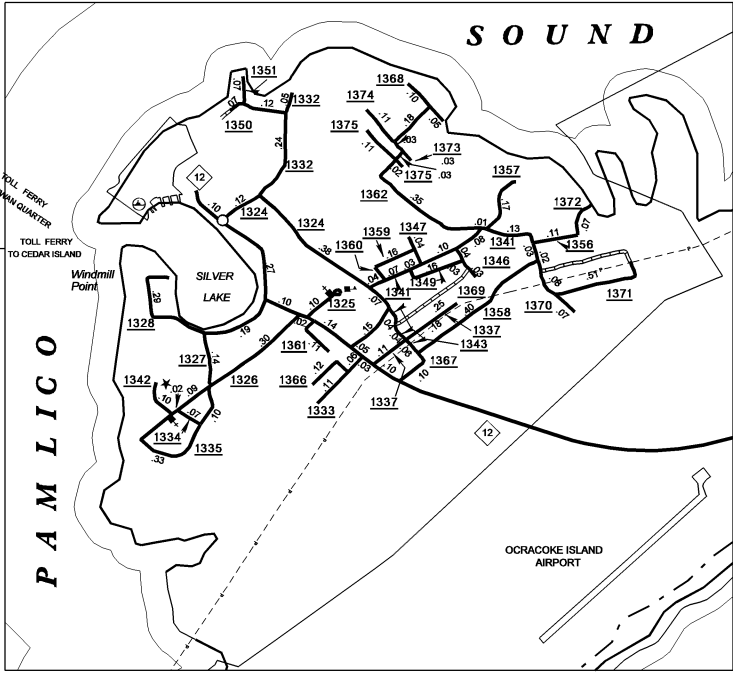
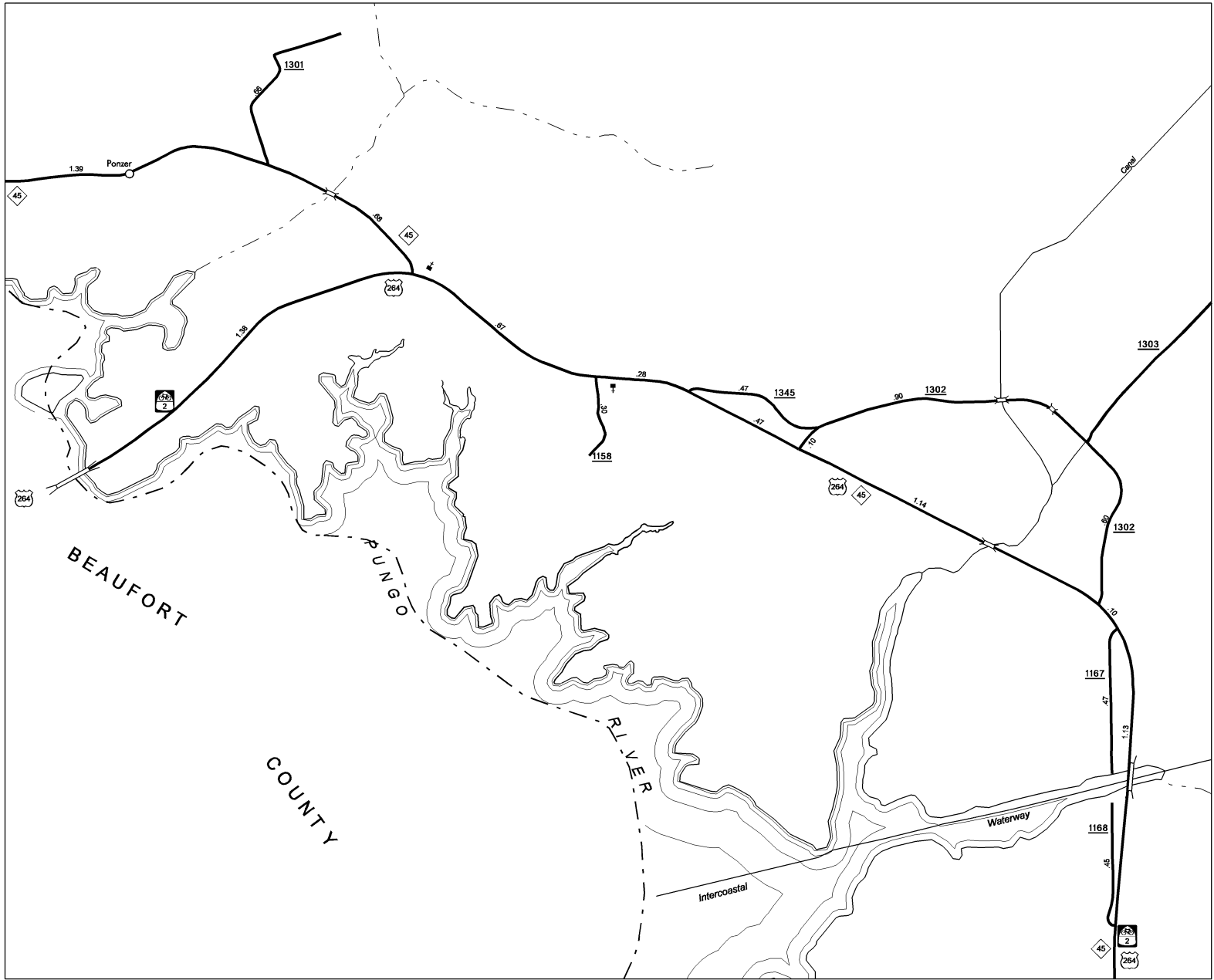
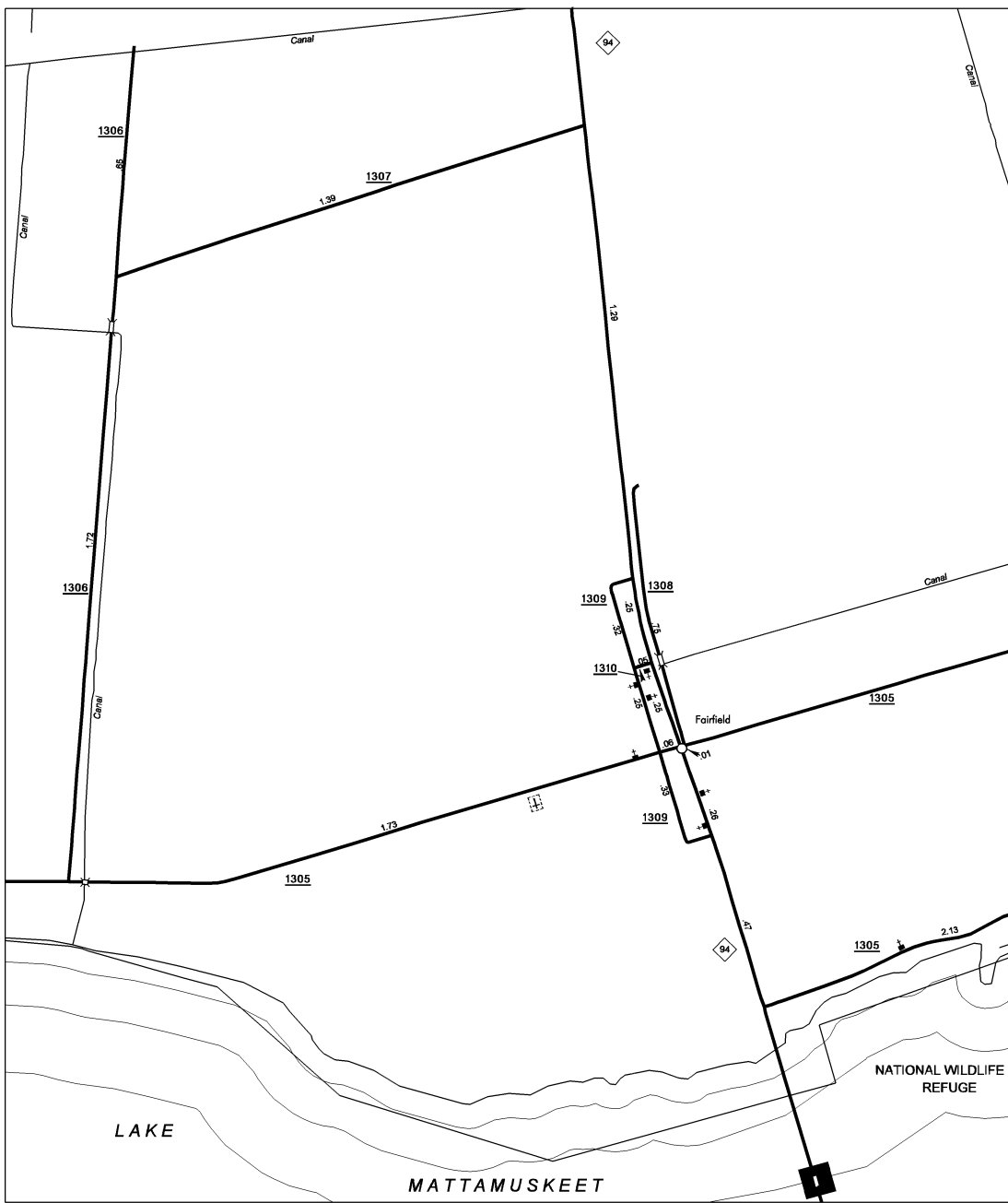
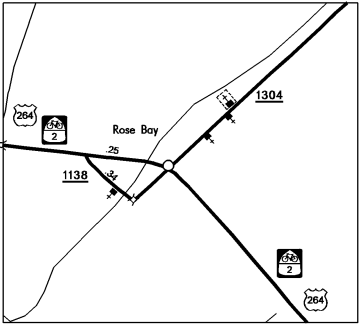
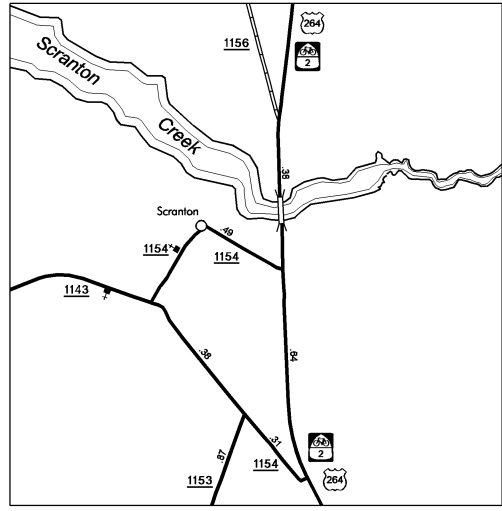

ENLARGED MUNICIPAL AND SUBURBAN AREAS

HYDE COUNTY NORTH CAROLINA

PREPARED BY THE
NORTH CAROLINA DEPARTMENT OF TRANSPORTATION
DIVISION OF HIGHWAYS - GIS UNIT

IN COOPERATION WITH THE
U.S. DEPARTMENT OF TRANSPORTATION
FEDERAL HIGHWAY ADMINISTRATION

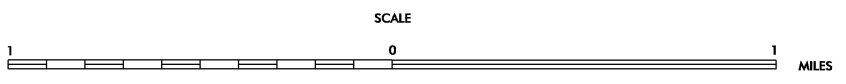

10,000 FOOT GRID BASED ON NORTH CAROLINA PLANE COORDINATE SYSTEM

PROJONIC PROJECTION

SHEET 2 OF 2