

COPIES OF THIS MAP ARE AVAILABLE
TO THE PUBLIC AT A NOMINAL COST
ADDRESS: N.C. DEPARTMENT OF TRANSPORTATION
RALEIGH, NORTH CAROLINA 27611

CLEVELAND SUP 2

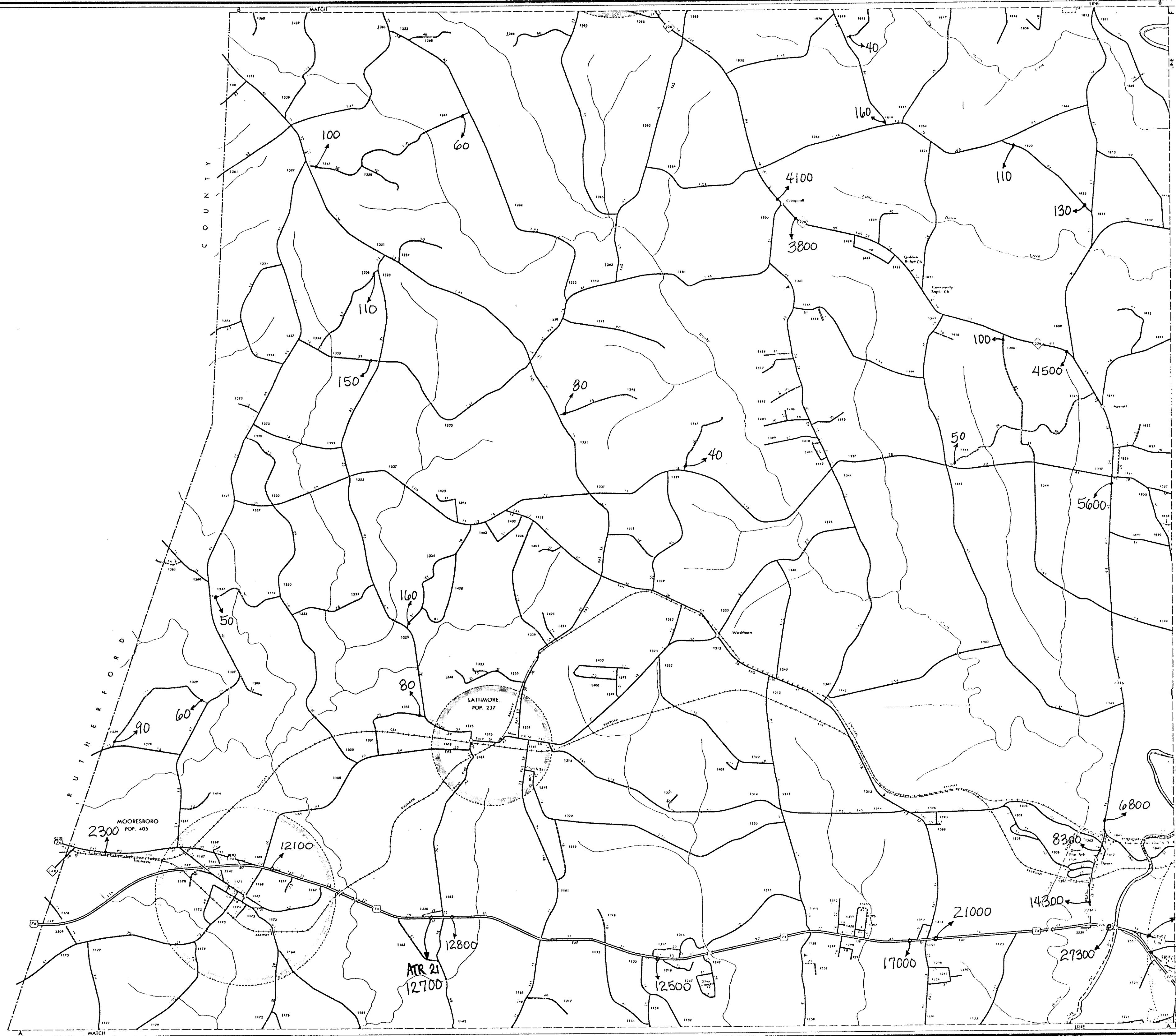

N.C. Department of Transportation
Statewide Planning Branch
Traffic Surveys
P.O. Box 75201
Raleigh, NC 27611

1996
ANNUAL
AVERAGE
DAILY
TRAFFIC

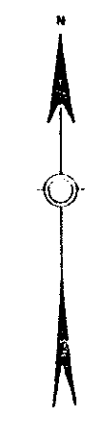
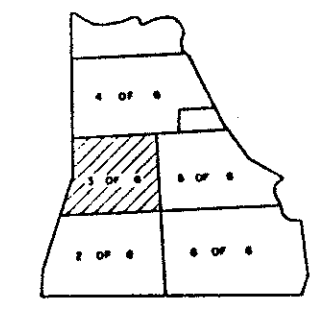

ENLARGED MUNICIPAL AND SUBURBAN AREAS
CLEVELAND COUNTY
NORTH CAROLINA

PREPARED BY THE
NORTH CAROLINA DEPARTMENT OF TRANSPORTATION
DIVISION OF HIGHWAYS—PLANNING AND RESEARCH BRANCH
IN COOPERATION WITH THE
U.S. DEPARTMENT OF TRANSPORTATION
FEDERAL HIGHWAY ADMINISTRATION



54
SHEET 3 OF 6