

COPIES OF THIS MAP ARE AVAILABLE  
FROM THE NORTH CAROLINA DEPARTMENT OF TRANSPORTATION  
DIVISION OF HIGHWAYS  
Raleigh, North Carolina, 27611

REVISED
1 - 1 - 47
1 - 1 - 48
1 - 1 - 49
1 - 1 - 50
1 - 1 - 51
1 - 1 - 52
1 - 1 - 53
1 - 1 - 54
1 - 1 - 55
1 - 1 - 56
1 - 1 - 57
1 - 1 - 58
1 - 1 - 59
1 - 1 - 60
1 - 1 - 61
1 - 1 - 62
1 - 1 - 63
1 - 1 - 64
1 - 1 - 65
1 - 1 - 66

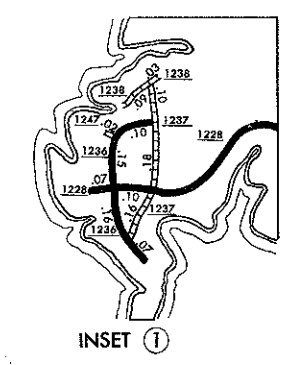

INSET ①

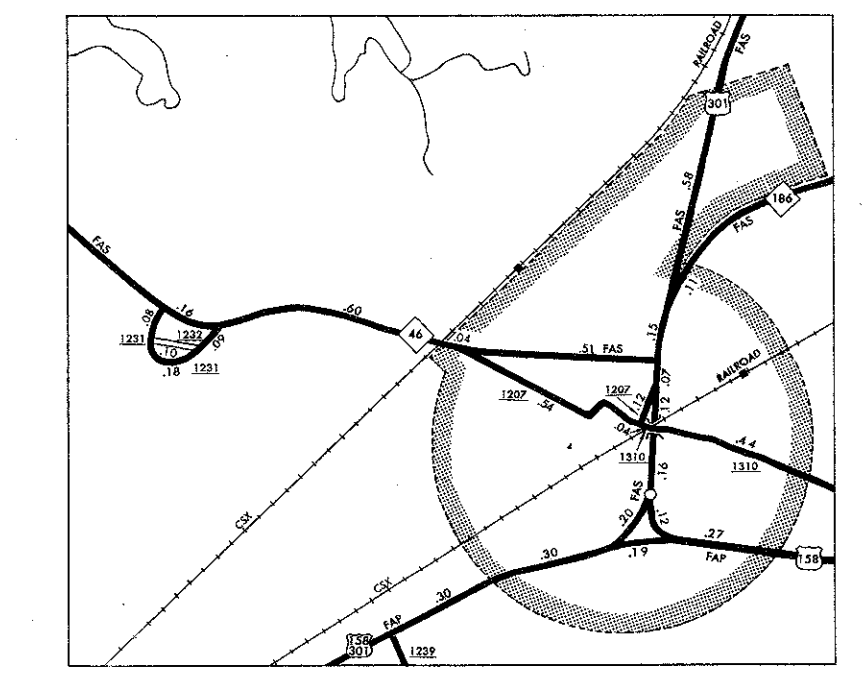

GARYSBURG  
POP. 1,434

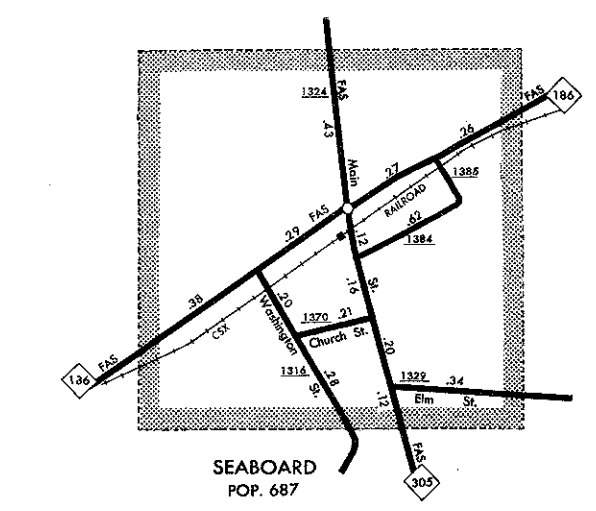

SEABOARD  
POP. 687

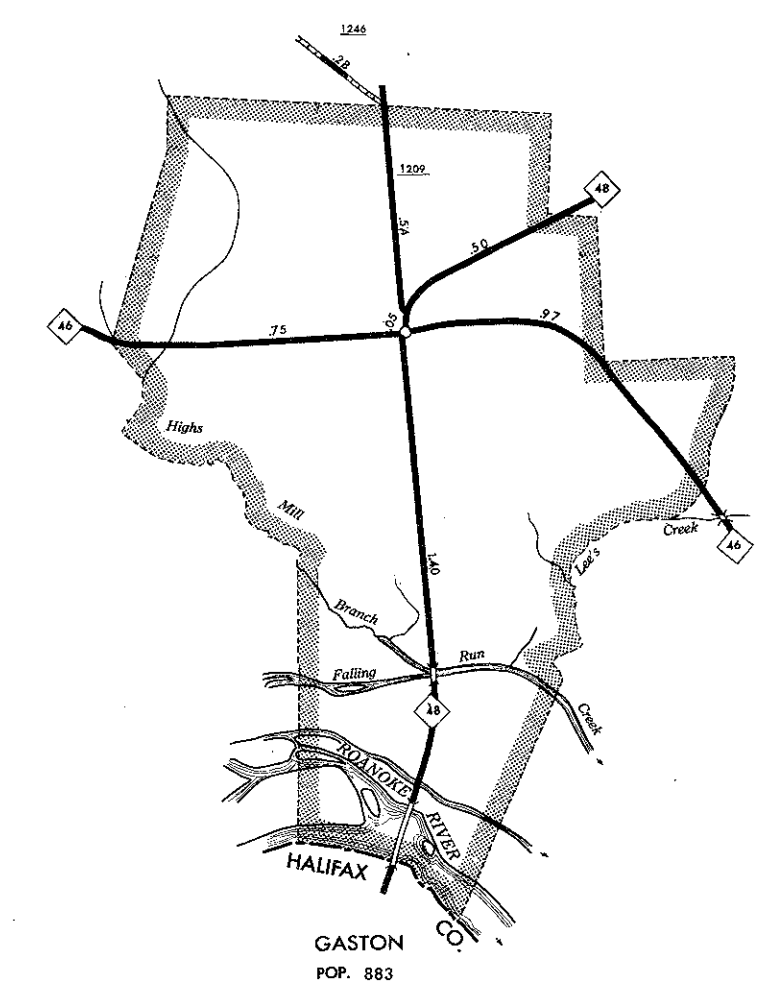

GASTON  
POP. 883

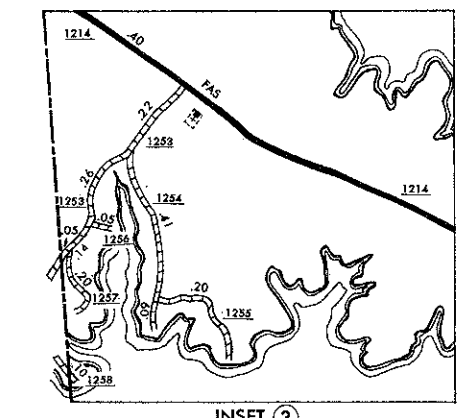

INSET ③

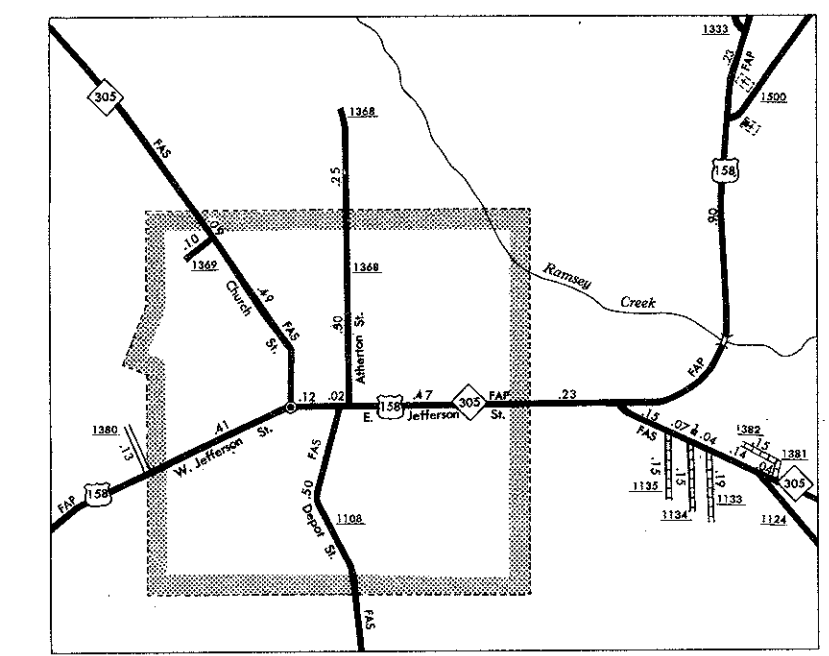

JACKSON  
POP. 720

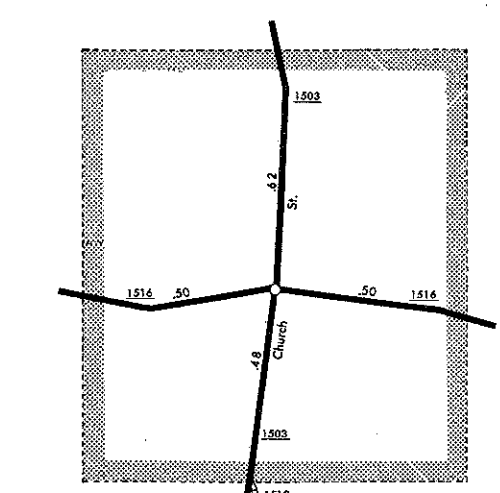

LASKER  
POP. 96

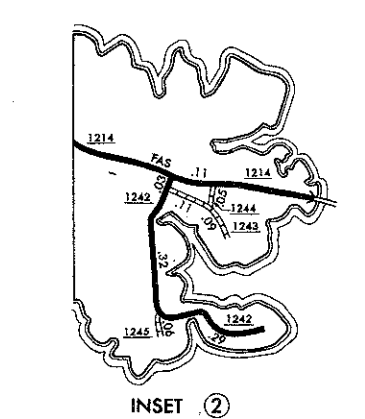

INSET ②

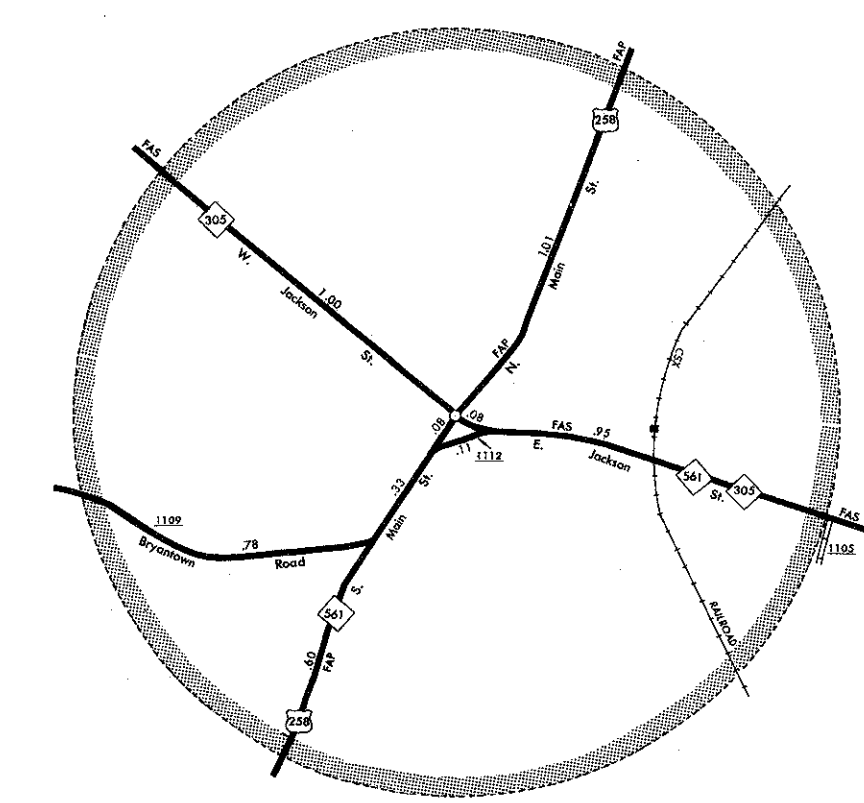

RICH SQUARE  
POP. 1,057

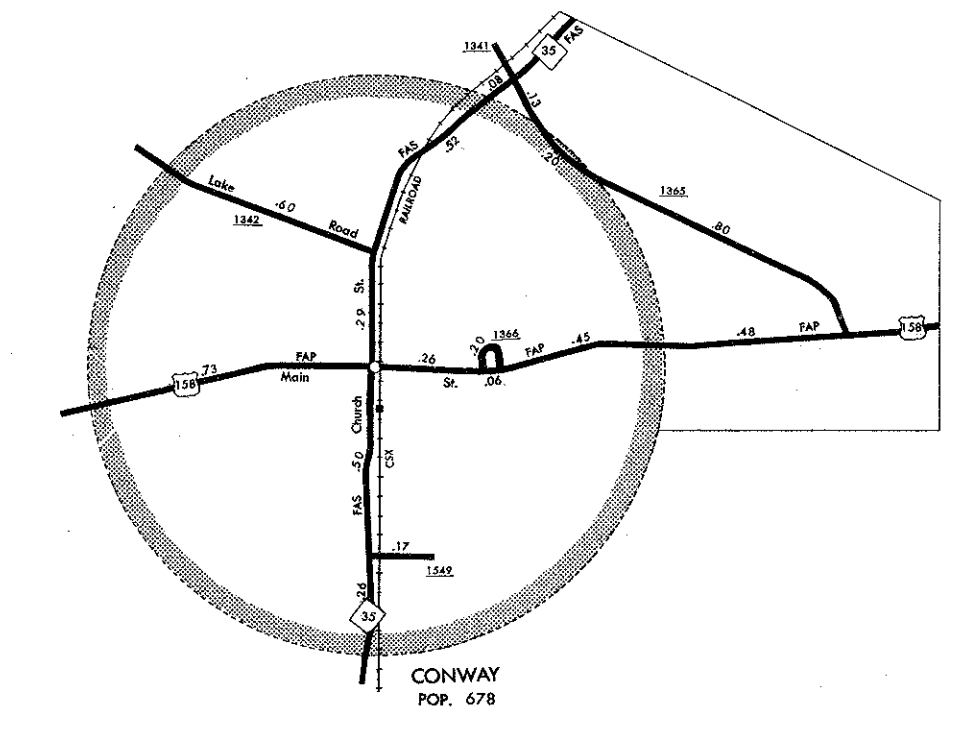

CONWAY  
POP. 678

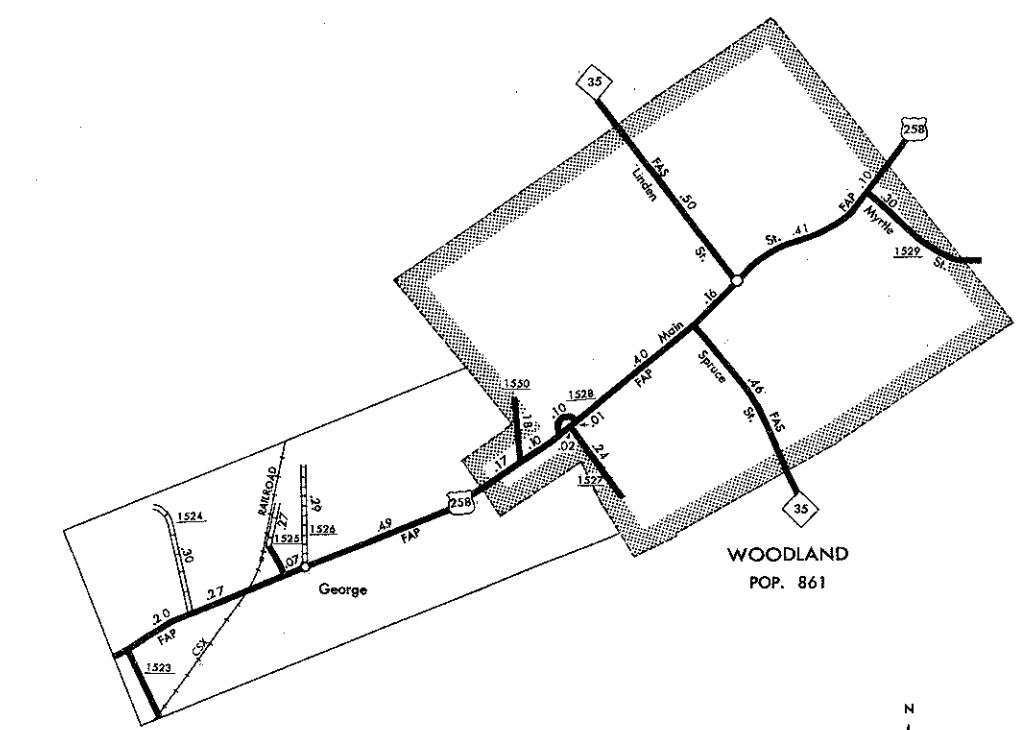

WOODLAND  
POP. 861

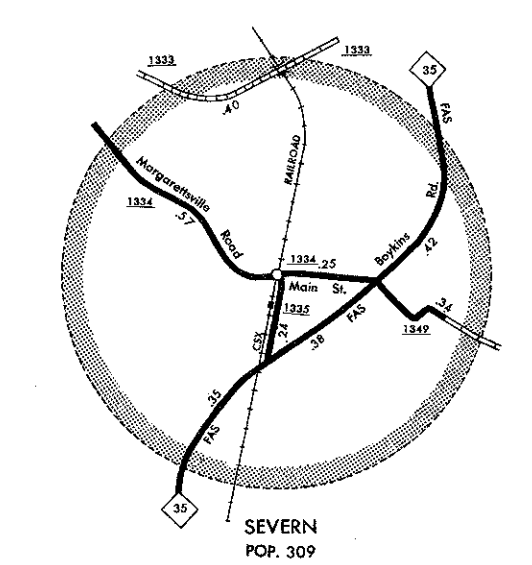

SEVERN  
POP. 309

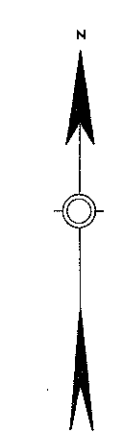

ENLARGED MUNICIPAL AND SUBURBAN AREAS  
**NORTHAMPTON COUNTY**  
NORTH CAROLINA

PREPARED BY THE  
NORTH CAROLINA DEPARTMENT OF TRANSPORTATION  
DIVISION OF HIGHWAYS—PLANNING AND RESEARCH BRANCH  
IN COOPERATION WITH THE  
U.S. DEPARTMENT OF TRANSPORTATION  
FEDERAL HIGHWAY ADMINISTRATION

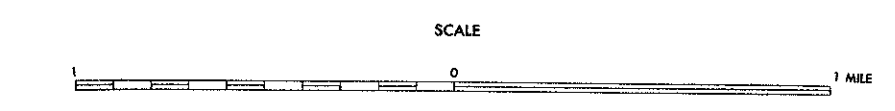

POLYCONIC PROJECTION

SHEET 2 OF 2