

COPIES OF THIS MAP ARE AVAILABLE
TO THE PUBLIC AT A NOMINAL COST.
FOR INFORMATION, CONTACT THE
DIVISION OF HIGHWAYS
RALEIGH, NORTH CAROLINA, 27611

REVISION
1 - 1-62
2 - 1-64
3 - 1-65
4 - 1-66
5 - 1-67
6 - 1-68
7 - 1-69
8 - 1-70
9 - 1-71
10 - 1-72
11 - 1-73
12 - 1-74
13 - 1-75
14 - 1-76
15 - 1-77
16 - 1-78
17 - 1-79
18 - 1-80
19 - 1-81
20 - 1-82
21 - 1-83
22 - 1-84
23 - 1-85

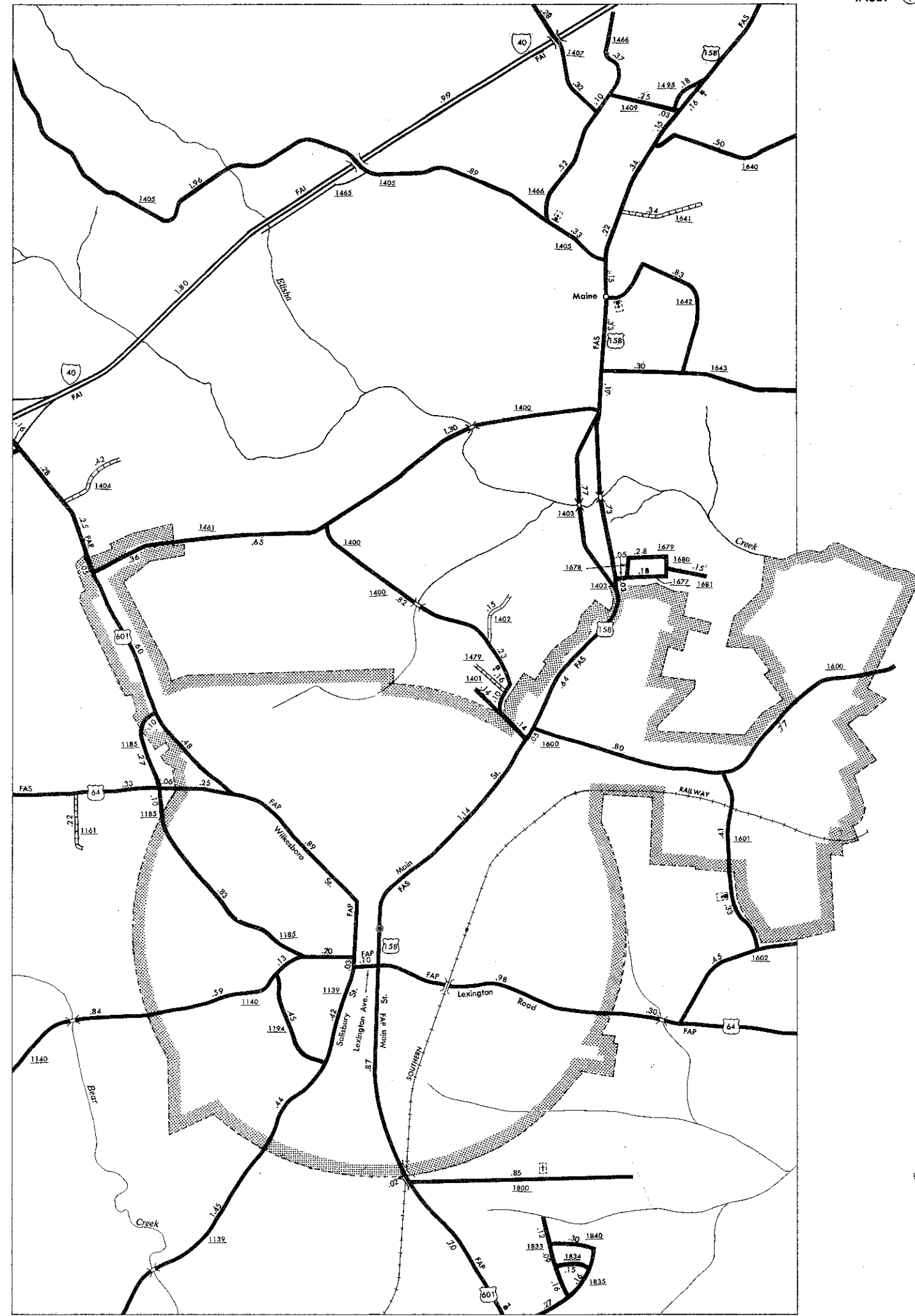

MOCKSVILLE
POP. 2,637

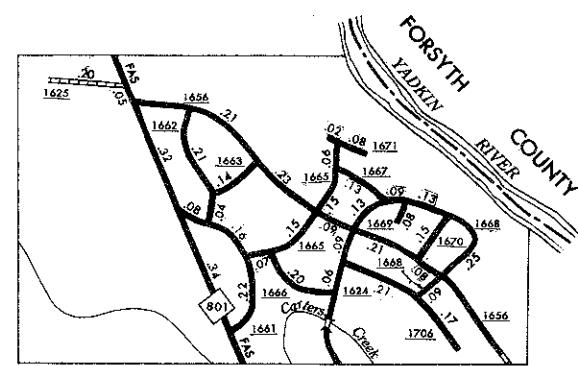

INSET 1

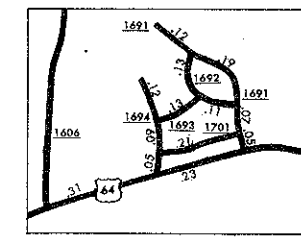

INSET 2

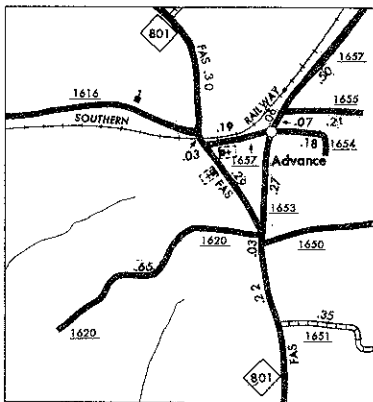

INSET 3

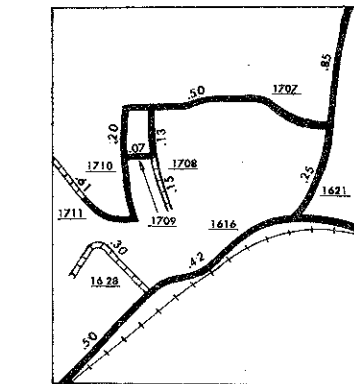

INSET 4

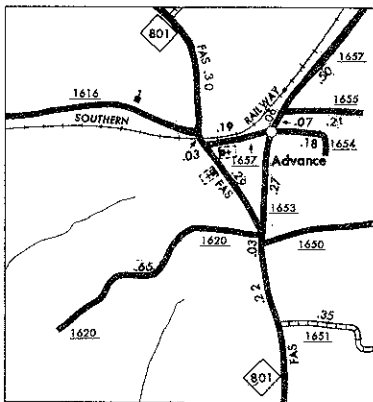

INSET 5

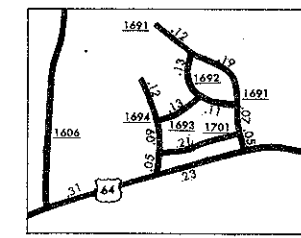

INSET 6

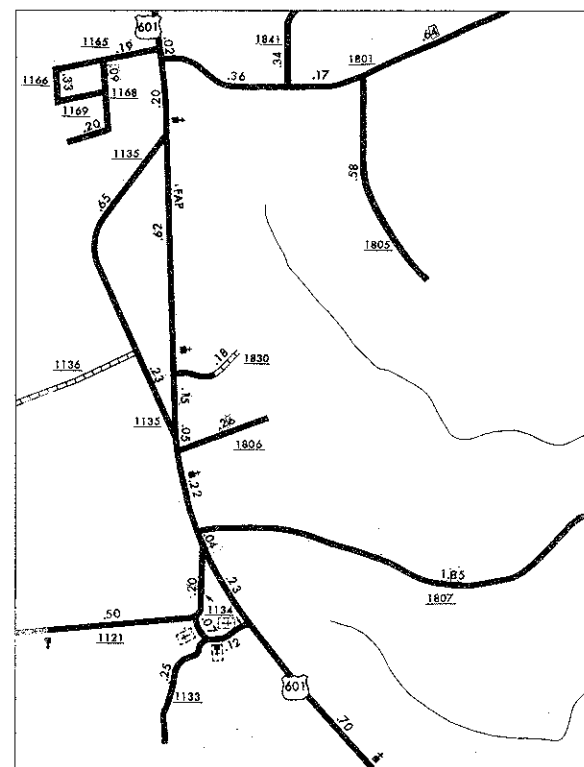

INSET 7

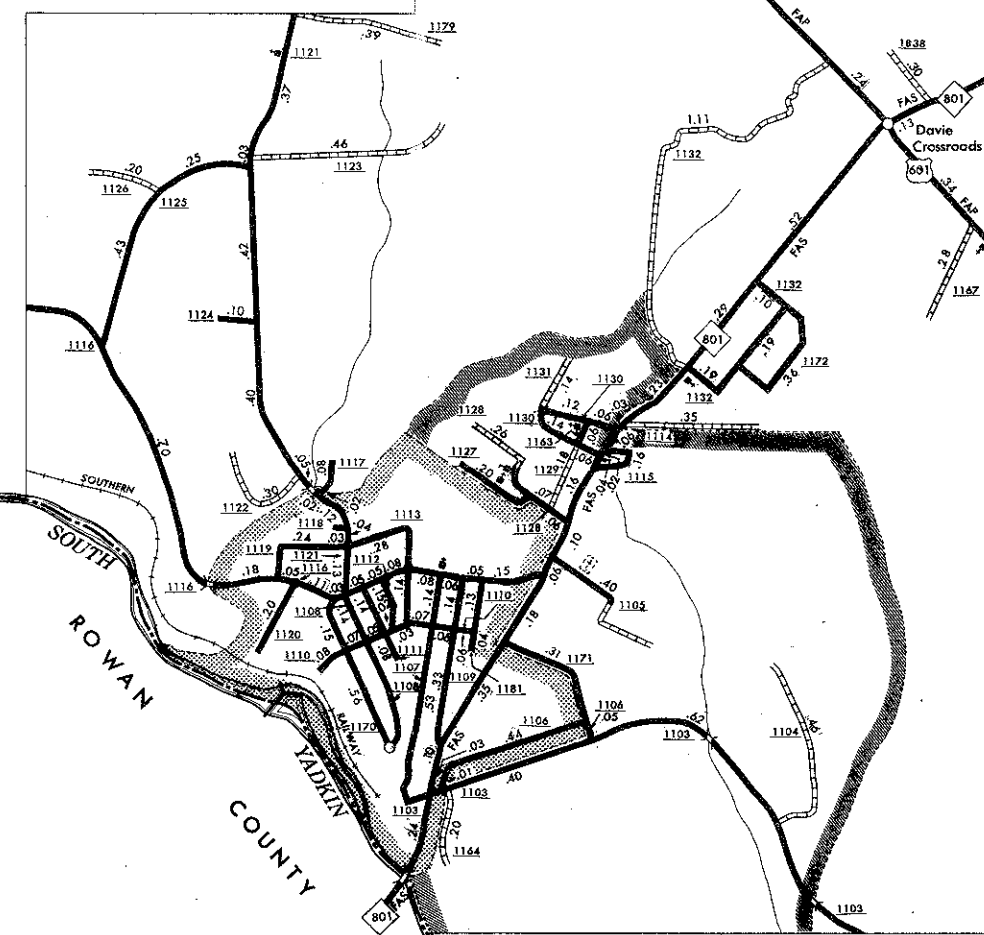

INSET 8

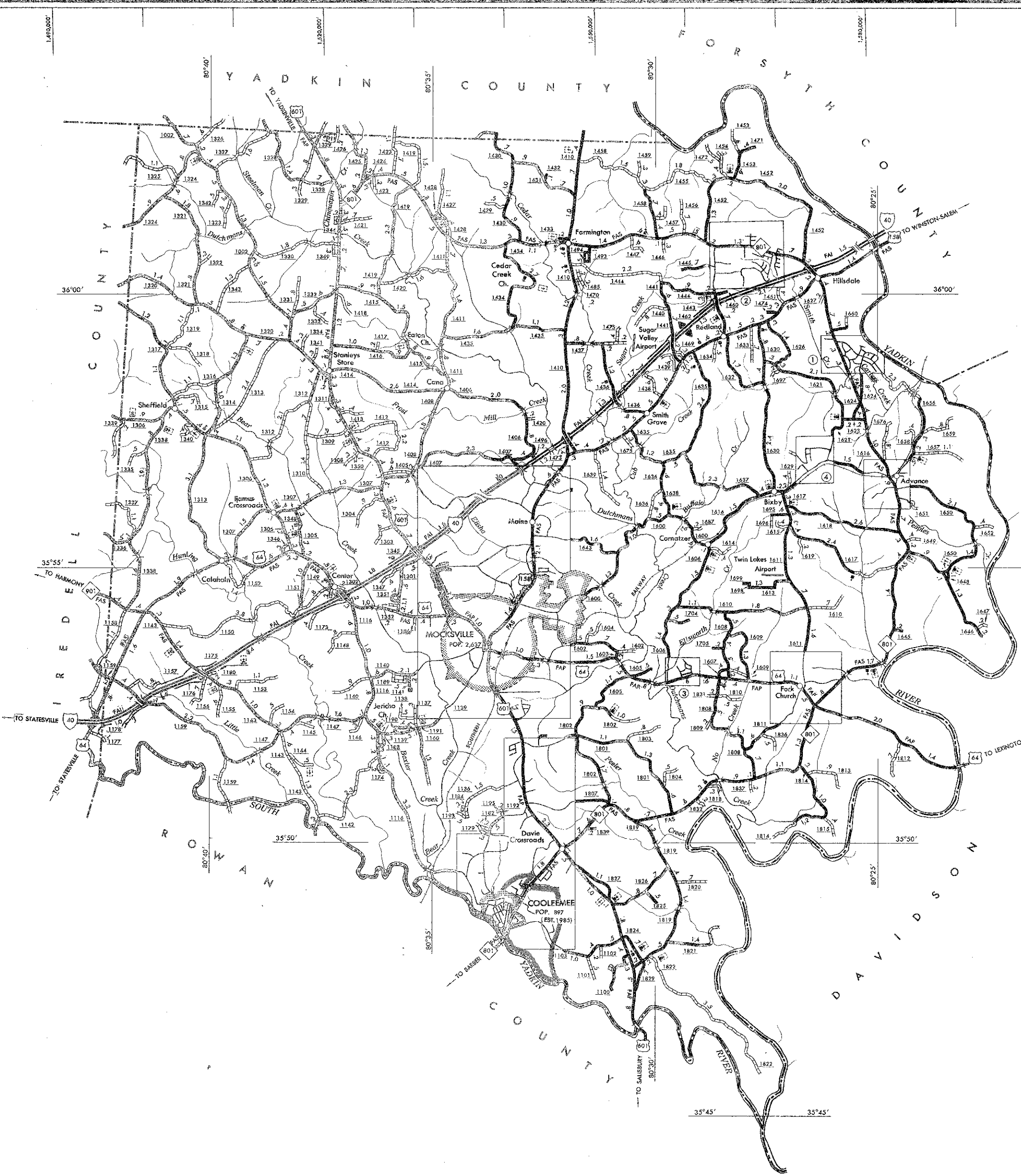

YADKIN RIVER

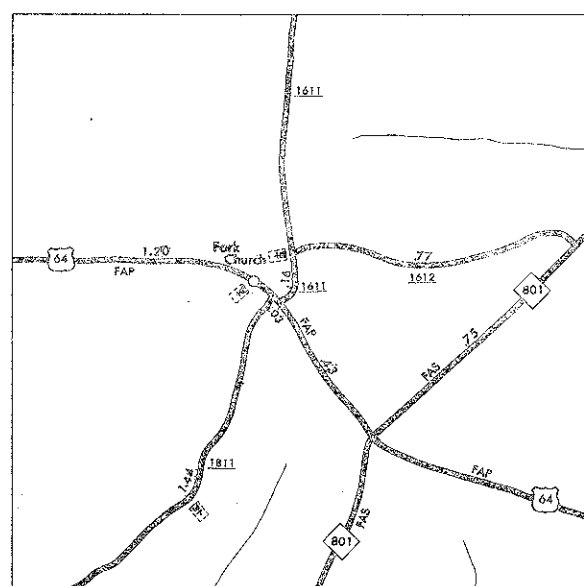

INSET 9

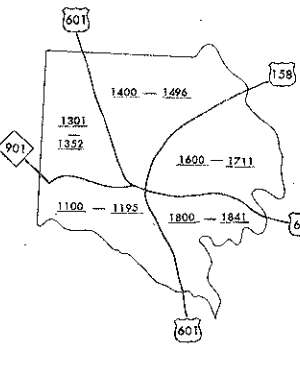

INSET 10

DAVIE COUNTY NORTH CAROLINA

PREPARED BY THE
NORTH CAROLINA DEPARTMENT OF TRANSPORTATION
DIVISION OF HIGHWAYS—PLANNING AND RESEARCH BRANCH
IN COOPERATION WITH THE
U. S. DEPARTMENT OF TRANSPORTATION
FEDERAL HIGHWAY ADMINISTRATION

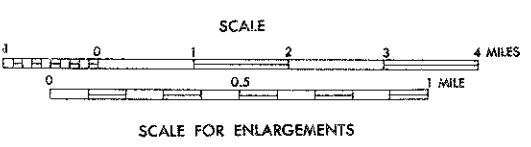

SCALE
1 INCH = 1 MILE
1:62,500

16,000 FOOT GRID BASED ON NORTH CAROLINA PLANE COORDINATE SYSTEM
POLYCONIC PROJECTION