

COPIES OF THIS MAP ARE AVAILABLE
TO THE PUBLIC AT A NOMINAL COST.
ADDRESS: DIVISION OF HIGHWAYS
RALEIGH, NORTH CAROLINA 27611

REVISED
1 - 1-63
2 - 1-64
3 - 1-65
4 - 1-66
5 - 1-67
6 - 1-68
7 - 1-69
8 - 1-70
9 - 1-71
10 - 1-72
11 - 1-73
12 - 1-74
13 - 1-75
14 - 1-76
15 - 1-77
16 - 1-78
17 - 1-79
18 - 1-80
19 - 1-81
20 - 1-82
21 - 1-83
22 - 1-84

CHOWAN



EDENTON
POP. 5,357

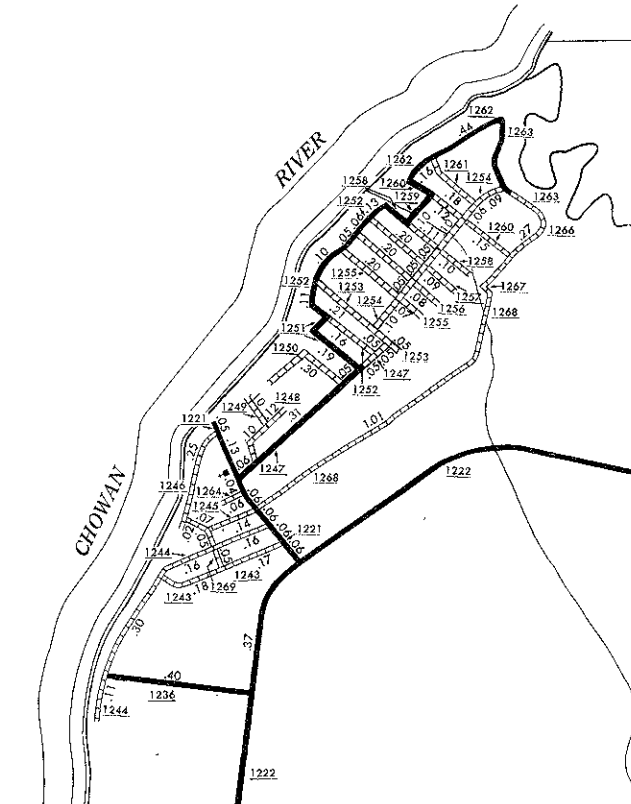
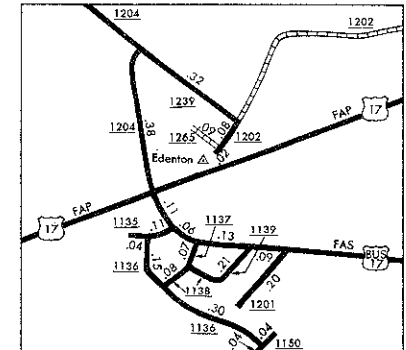
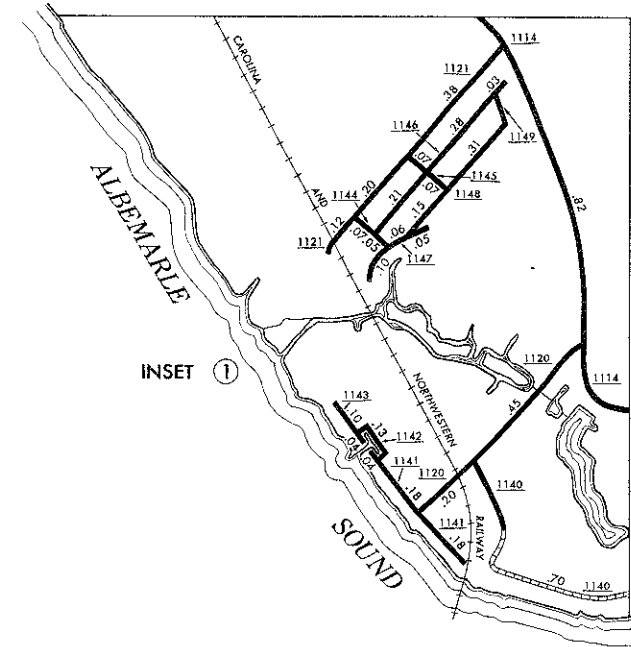

CHOWAN COUNTY NORTH CAROLINA

PREPARED BY THE
NORTH CAROLINA DEPARTMENT OF TRANSPORTATION
DIVISION OF HIGHWAYS—PLANNING AND RESEARCH BRANCH
IN COOPERATION WITH THE
U.S. DEPARTMENT OF TRANSPORTATION
FEDERAL HIGHWAY ADMINISTRATION

SCALE
1 INCH = 1 MILE
SCALE FOR ENLARGEMENTS
10,000 FOOT GRID BASED ON NORTH CAROLINA PLANE COORDINATE SYSTEM
POLYCONIC PROJECTION

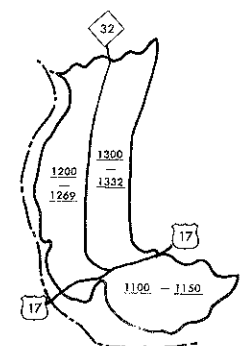
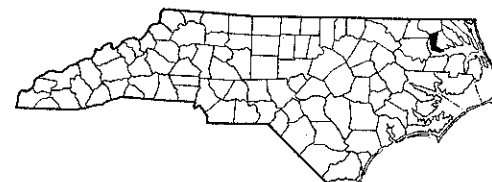

NOTE: MAP INCLUDES ONLY STATE MAINTAINED ROADS
OR IMPORTANT NON-STATE MAINTAINED ROADS.
MILEAGE NOT SHOWN ON FRONTAGE ROADS.
ROADS SHOWN AS OF JAN. 1, 1984.