

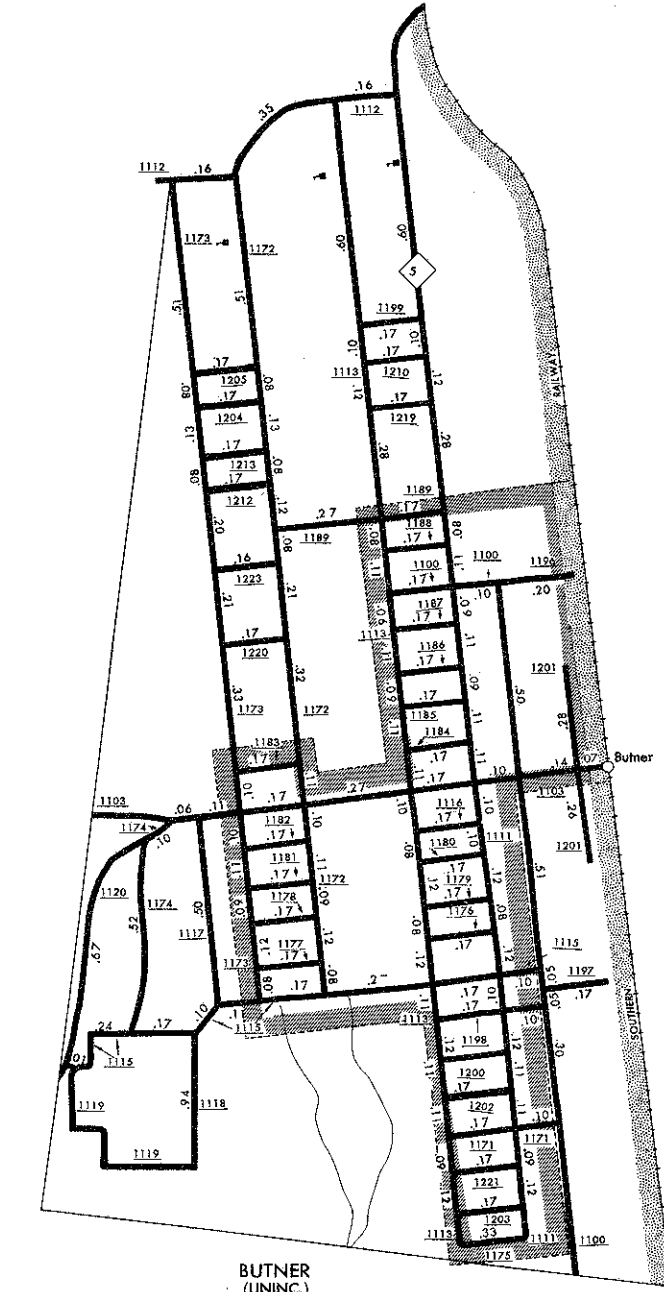

- LEGEND**
- PRIMITIVE OR UNIMPROVED ROAD
 - GRAVEL AND DRAINAGE ROAD
 - SOL. GRAVEL OR STONE SURFACED ROAD
 - PAVED SURFACED ROAD
 - 4 LANE UNIMPROVED HIGHWAY
 - DIVIDED HIGHWAY
 - HIGHWAY WITH FRONTAGE ROADS
 - FUEL CONTROL ACCESS
 - FEDERAL AID INTERSTATE ROAD
 - FEDERAL AID PRIMARY ROAD
 - FEDERAL AID SECONDARY ROAD
 - NON-FEDERAL ROAD
 - PROJECTED LOCATION
 - INTERSECTION DISTANCE
 - TRAFFIC CIRCLE
 - HIGHWAY INTERCHANGE
 - DETAILED HIGHWAY INTERCHANGE
 - INTERSTATE HIGHWAY
 - U.S. NUMBERED HIGHWAY
 - N.C. NUMBERED HIGHWAY
 - SECONDARY ROAD NUMBER
 - UNINCORPORATED CENSUS
 - BASED ON ANY NUMBER OF TRACES
 - USED BY SINGLE OPERATING COMPANY
 - BASED ON ANY NUMBER OF TRACES
 - USED BY MORE THAN ONE OPERATING COMPANY OR LANE OR ADJACENT
 - RIGHTS OF WAY
 - RAILROAD STATION
 - GRADE CROSSING
 - OVERPASS
 - RAILROAD TUNNEL
 - RAIL. NAVY OR MARINE CORPS FIELD
 - COMM. OR MUNICIPAL AIRPORT
 - NAMED AIRPORT FIELD
 - MANUAL OR FIELD "Y" IN SYMBOL
 - DOCK, PIER OR LANDING
 - FREE OR TOLL FERRY
 - LIGHT, NAUTICAL
 - LIGHTHOUSE
 - COAST GUARD STATION
 - CANAL
 - NARROW STREAM
 - WIDE STREAM
 - DAM WITH LOCK
 - DAM
 - RESERVOIR, POND OR LAKE
 - PERMANENT FISH WEIR/WEIR
 - INDICATE ELEVATION
 - ROAD THROUGH MOUNTAIN PASS
 - HIGHWAY BRIDGE OVER 20 FT.
 - GRAVE SHED OR BRIDGE
 - HIGHWAY TUNNEL
 - FORD
 - RAIL LINE
 - COUNTY LINE
 - CITY LIMITS
 - RESERVATION OR PARK BOUNDARY
 - POSS. AREA
 - DELETED AREA, POPULATION EST.
 - COUNTY SEAT
 - OTHER TOWNS AND VILLAGES
 - TRIANGULATION STATION
 - INCORPORATED CITY OR VILLAGE
 - UNINCORPORATED
 - SCHOOL
 - CHURCH
 - CHURCH WITH CEMETERY
 - COUNTRY
 - HOSPITAL
 - CORRECTIONAL OR PENIT. INST.
 - HIGHWAY GARAGE, OR MAINT. YARD
 - HIGHWAY DIV. OR DIST. OFFICE
 - WEIGHT STATION
 - PATROL STATION
 - REST AREA
 - MONUMENT--SMALL HISTORICAL SITE



GRANVILLE COUNTY

NORTH CAROLINA

PREPARED BY THE
NORTH CAROLINA DEPARTMENT OF TRANSPORTATION
DIVISION OF HIGHWAYS—PLANNING AND RESEARCH BRANCH
IN COOPERATION WITH THE
U.S. DEPARTMENT OF TRANSPORTATION
FEDERAL HIGHWAY ADMINISTRATION

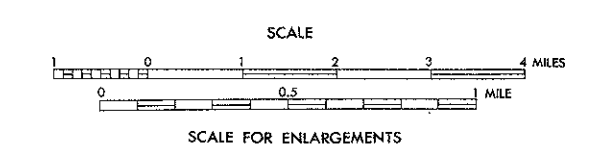

NOTE: MAP INCLUDES ONLY STATE MAINTAINED ROADS
OR IMPORTANT NON-SYSTEM ROADS.
MILEAGE NOT SHOWN ON FRONTAGE ROADS.
ROADS SHOWN AS OF JAN. 1, 1976

CORNER OF THIS MAP ARE AVAILABLE
REFERENCE AT A NOMINAL COST
FROM THE
DIVISION OF HIGHWAYS
RALEIGH, NORTH CAROLINA, 27611