

1-1-42
1-1-43
1-1-44
1-1-45
1-1-46
1-1-47
1-1-48
1-1-49
1-1-50
1-1-51
1-1-52
1-1-53
1-1-54
1-1-55
1-1-56
1-1-57
1-1-58
1-1-59
1-1-60
1-1-61
1-1-62
1-1-63
1-1-64
1-1-65
1-1-66
1-1-67
1-1-68
1-1-69
1-1-70
1-1-71
1-1-72
1-1-73
1-1-74
1-1-75
1-1-76
1-1-77
1-1-78
1-1-79
1-1-80
1-1-81
1-1-82
1-1-83
1-1-84
1-1-85
1-1-86
1-1-87
1-1-88
1-1-89
1-1-90
1-1-91
1-1-92
1-1-93
1-1-94
1-1-95
1-1-96
1-1-97
1-1-98
1-1-99
1-1-100

COPIES OF THIS MAP ARE AVAILABLE
TO THE PUBLIC AT A NOMINAL COST.
ADDRESS: MAPS, N. C. STATE HIGHWAY COMMISSION
RALEIGH, NORTH CAROLINA 27601

STANLY

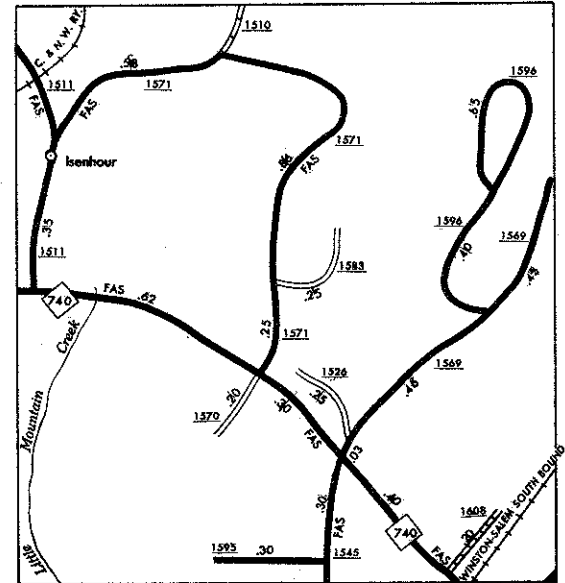

ISENHOUR

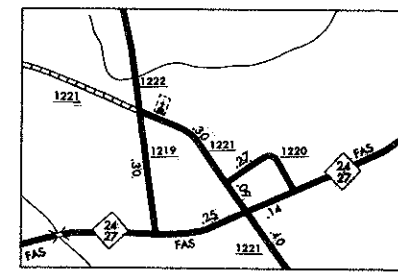

INSET ②

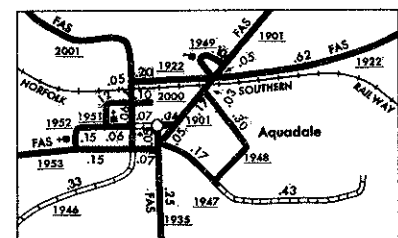

AQUADALE

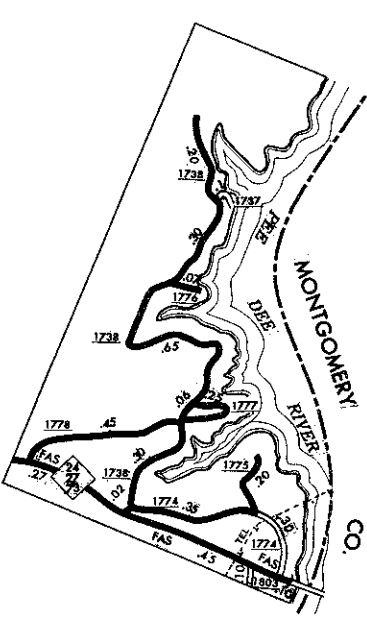

INSET ①

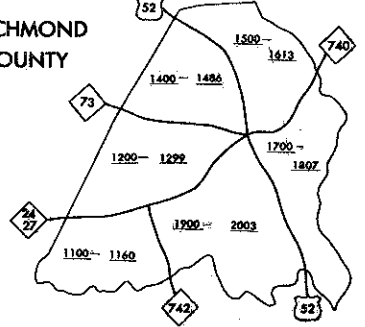

KEY TO COUNTY ROAD NUMBERS
ALSO NUMBERS 1001, 1004, 1005

NOTE: MAP INCLUDES ONLY STATE MAINTAINED ROADS
OR IMPORTANT NON-STATE MAINTAINED ROADS.
MILEAGE NOT SHOWN ON FRONTAGE ROADS.
ROADS SHOWN AS OF JAN. 1, 1972.

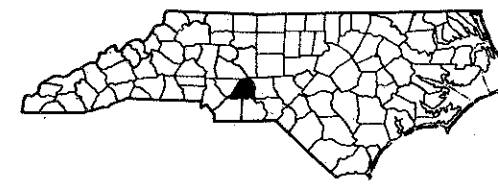

STANLY COUNTY NORTH CAROLINA

PREPARED BY THE
NORTH CAROLINA STATE HIGHWAY COMMISSION
PLANNING AND RESEARCH DEPARTMENT
IN COOPERATION WITH THE
U.S. DEPARTMENT OF TRANSPORTATION
FEDERAL HIGHWAY ADMINISTRATION

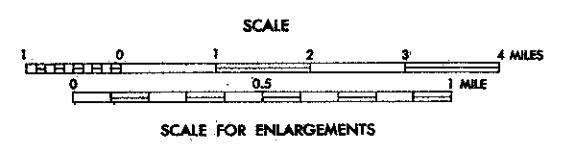

POLYCONIC PROJECTION

SHEET 1 OF 2