



STATE OF NORTH CAROLINA  
DEPARTMENT OF TRANSPORTATION

MICHAEL F. EASLEY  
GOVERNOR

Thursday, January 17, 2008

LYNDO TIPPETT  
SECRETARY

**MEMORANDUM TO:** Mr. J. Wally Bowman , PE  
Division Engineer  
Division 5

**FROM:** Information, Mapping, and Graphics Unit

**SUBJECT:** 2007 District 1 Road System Changes

The Road Inventory Information Section has been authorized to make the following changes to the state road system as indicated below. We request that you make similar changes to the related maps and files in your Division and District offices, and install appropriate road number signs if necessary. We have updated our records and county maps accordingly. If our system changes do not conform to the actual conditions in the field, please return this memorandum with recommendations.

Project Number	County	Approval Date
R-2809C	WAKE	1/17/2005

Inquires about changes should be referred to one of the following: Ron Tucker at (919) 212-6080 or Tom Schroder at (919) 212-6090. If you have further questions, please contact Hardee Cox, Road Inventory Information Section Manager at (919) 212-6060. Thank you for your assistance.

HRC  
enclosures ( )

cc: BSIP  
Bridge Maintenance  
Division Right of Way  
GIS  
Pavement Management  
Permit Unit  
State Road Maintenance  
Traffic Engineering  
Traffic Surveys

# 2007 ROAD SYSTEM CHANGES

PROJECT NUMBER	COUNTY	APPROVAL DATE	NEW NUMBER	EXISTING NUMBER	STREET NAME	LENGTH (miles)	TYPE OF CHANGE	REMARKS (See Attached Map)
R-2809C	WAKE	1/17/2005		SR 2053	JONES DAIRY ROAD	0.24	SYSTEM DELETION VIA PROJECT	MAP A, SEGMENT
R-2809C	WAKE	1/17/2005		SR 2053	JONES DAIRY ROAD	0.18	SYSTEM ADDITION VIA PROJECT	MAP A, SEGMENT
R-2809C	WAKE	1/17/2005	SR 5165			3.10	SYSTEM ADDITION VIA PROJECT	MAP B, SEGMENT
R-2809C	WAKE	1/17/2005	SR 5166			0.11	SYSTEM ADDITION VIA PROJECT	MAP C, SEGMENT
R-2809C	WAKE	1/17/2005		NC 98		0.33	SYSTEM DELETION VIA PROJECT	MAP C, SEGMENT
R-2809C	WAKE	1/17/2005		NC 98		0.35	SYSTEM ADDITION VIA PROJECT	MAP D, SEGMENT
R-2809C	WAKE	1/17/2005		SR 4535		0.09	SYSTEM DELETION VIA PROJECT	MAP E, SEGMENT
R-2809C	WAKE	1/17/2005		SR 4534	GALAXY DR	0.15	SYSTEM DELETION VIA PROJECT	MAP E, SEGMENT
R-2809C	WAKE	1/17/2005		SR 4534	GALAXY DR	0.38	SYSTEM ADDITION VIA PROJECT	MAP E, SEGMENT

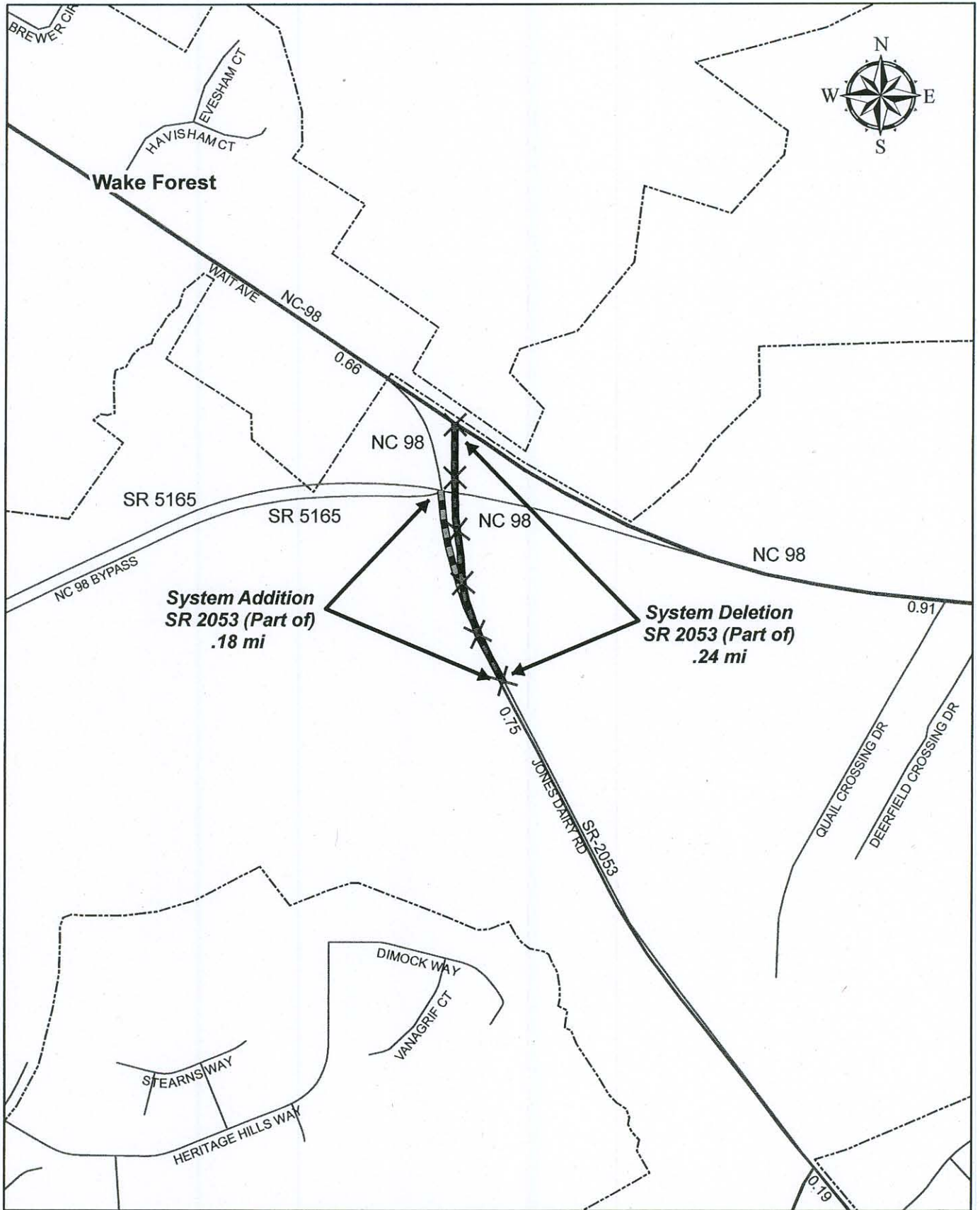

**WAKE COUNTY**  
**R-2809 B/C**  
**Map "A"**

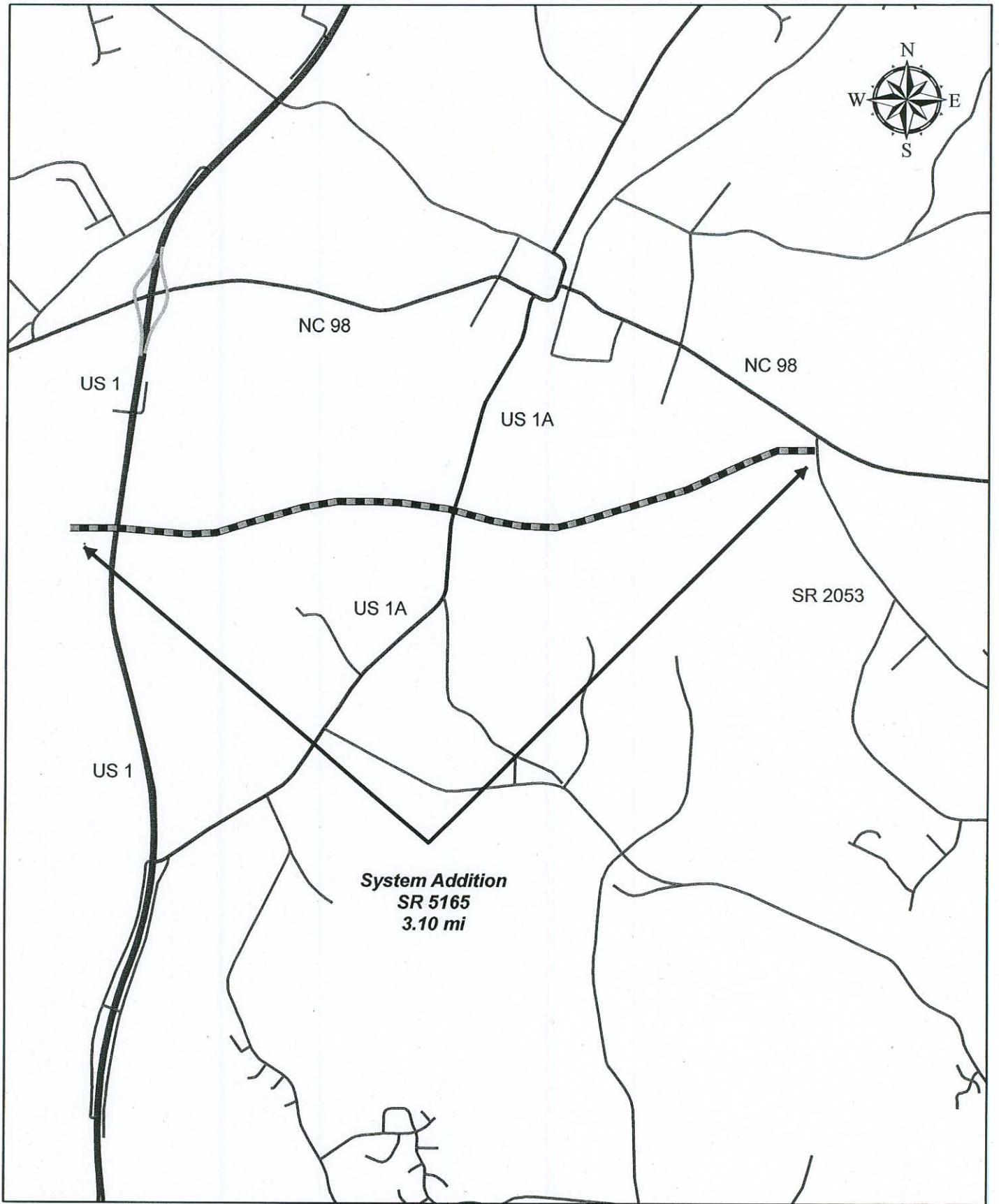

**WAKE COUNTY**  
**R-2809 B/C**  
**Map "B"**

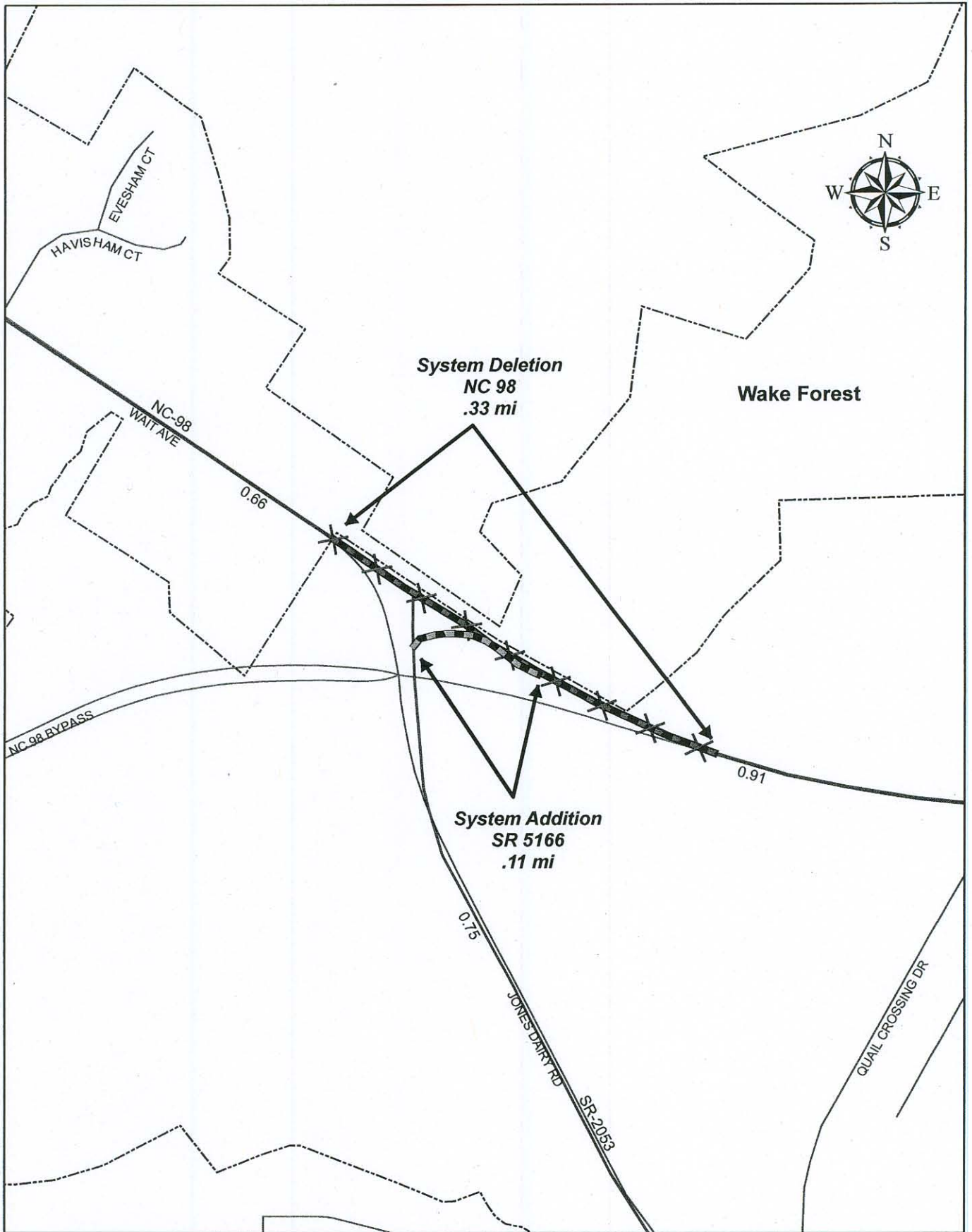

**WAKE COUNTY  
R-2809 B/C  
Map "C"**

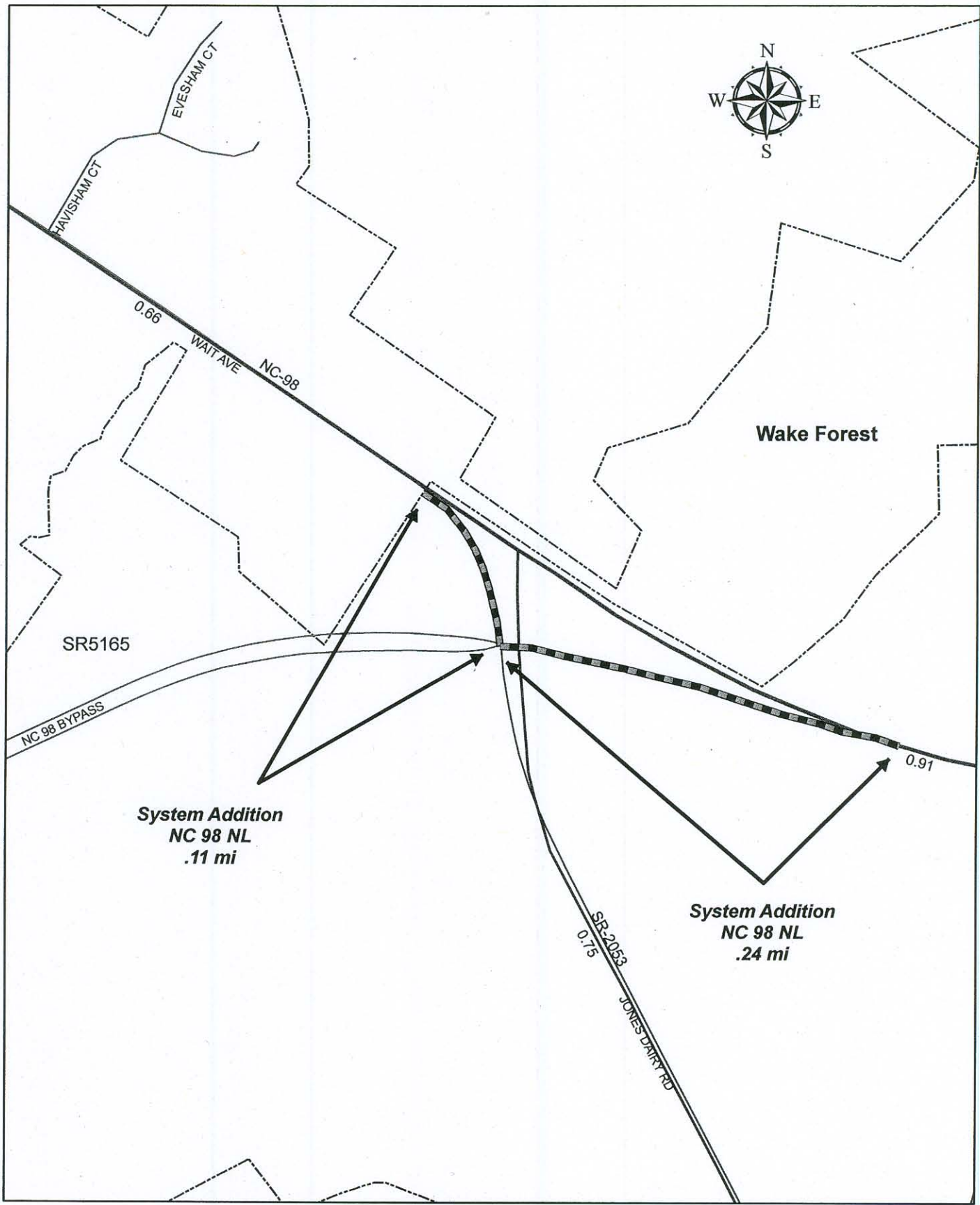

**WAKE COUNTY  
R-2809 B/C  
Map "D"**

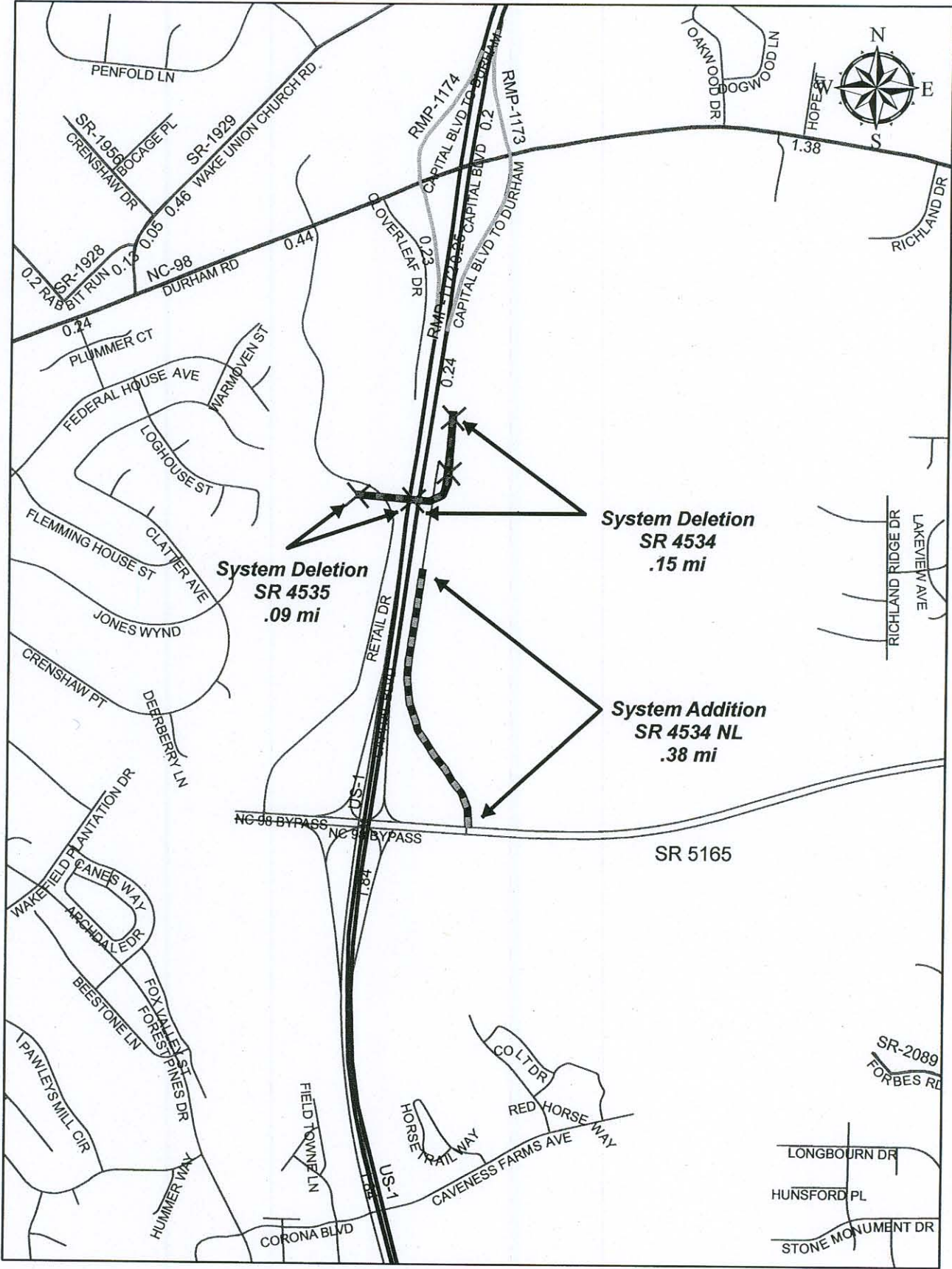

**WAKE COUNTY**  
**R-2809 B/C**  
**Map "E"**