

The Mapping Section's goal is to provide the most accurate and current information possible. Map data is compiled from various sources and is subject to change. The information is provided as a service and is not intended to be used for legal purposes. The information is provided as a service and is not intended to be used for legal purposes. The information is provided as a service and is not intended to be used for legal purposes.

COPIES OF THIS MAP ARE AVAILABLE AT A FEE FROM THE PUBLIC WORKS DEPARTMENT. ADDRESS: N.C. DEPARTMENT OF TRANSPORTATION, 4609 BERRY, C.D., RALEIGH, NC 27699.

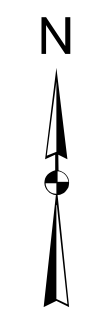
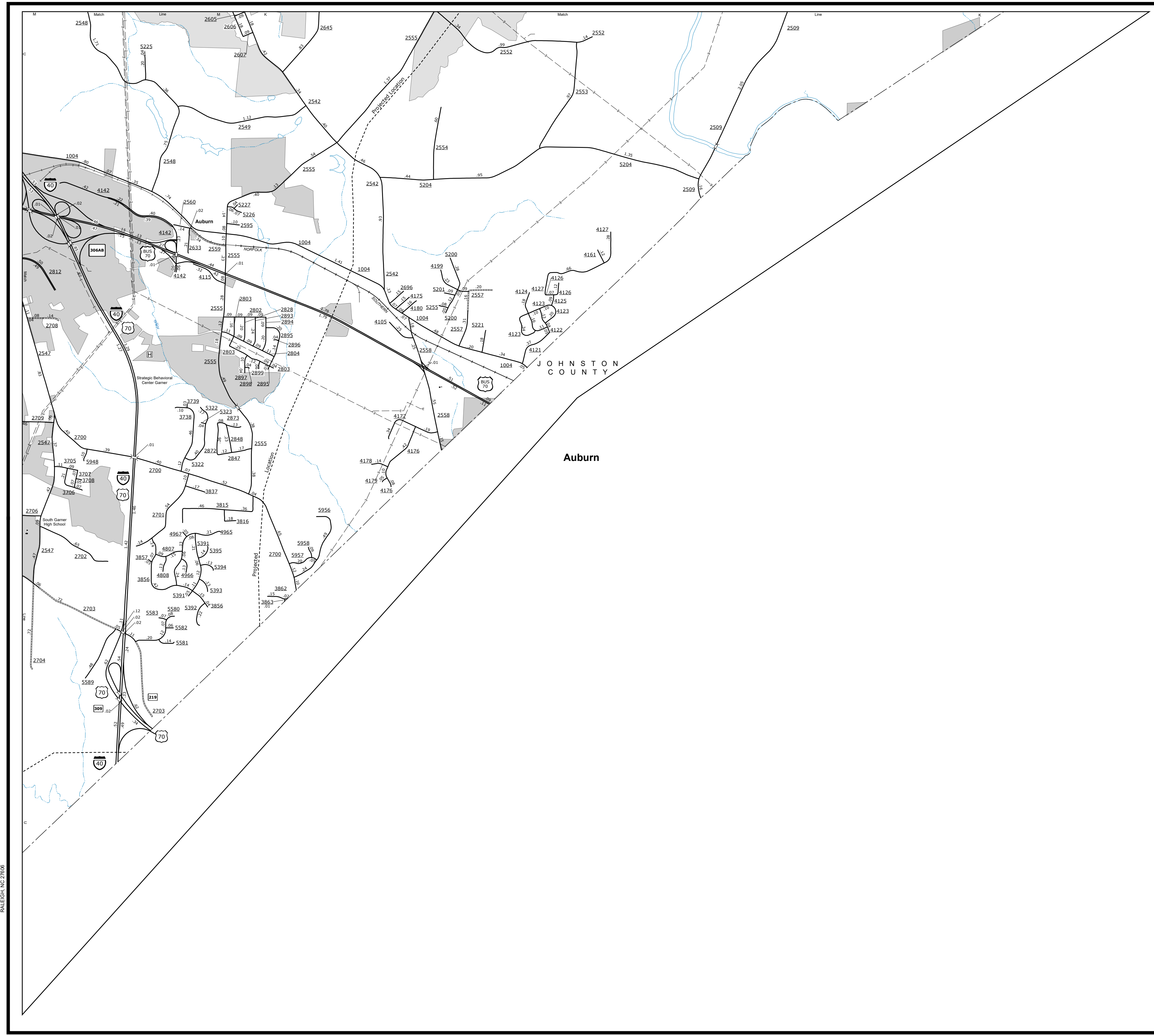

ENLARGED MUNICIPAL AND SUBURBAN AREAS

WAKE COUNTY NORTH CAROLINA

PREPARED BY THE
NORTH CAROLINA DEPARTMENT OF TRANSPORTATION
OPERATIONS PROGRAM MANAGEMENT UNIT - MAPPING SECTION
IN COOPERATION WITH THE
U.S. DEPARTMENT OF TRANSPORTATION
FEDERAL HIGHWAY ADMINISTRATION

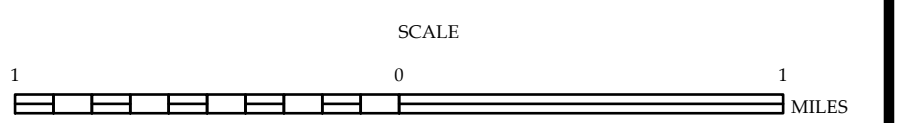

10,000 FOOT GRID BASED ON NORTH CAROLINA PLANE COORDINATE SYSTEM
LAMBERT CONFORMAL CONIC PROJECTION