

The Mapping Section's goal is to provide the most accurate and current information possible. Map data is compiled from various sources and is subject to change. The information is provided for informational purposes only and is not intended to be used for legal or other purposes. The information is provided as a service to the public and is not a warranty. The information is provided as a service to the public and is not a warranty. The information is provided as a service to the public and is not a warranty.

COPIES OF THIS MAP ARE AVAILABLE AT THE ADDRESS LISTED BELOW.
N.C. DEPARTMENT OF TRANSPORTATION
M&U - MAPPING SECTION
4609 BERNI, C.D.
RALEIGH, NC 27609

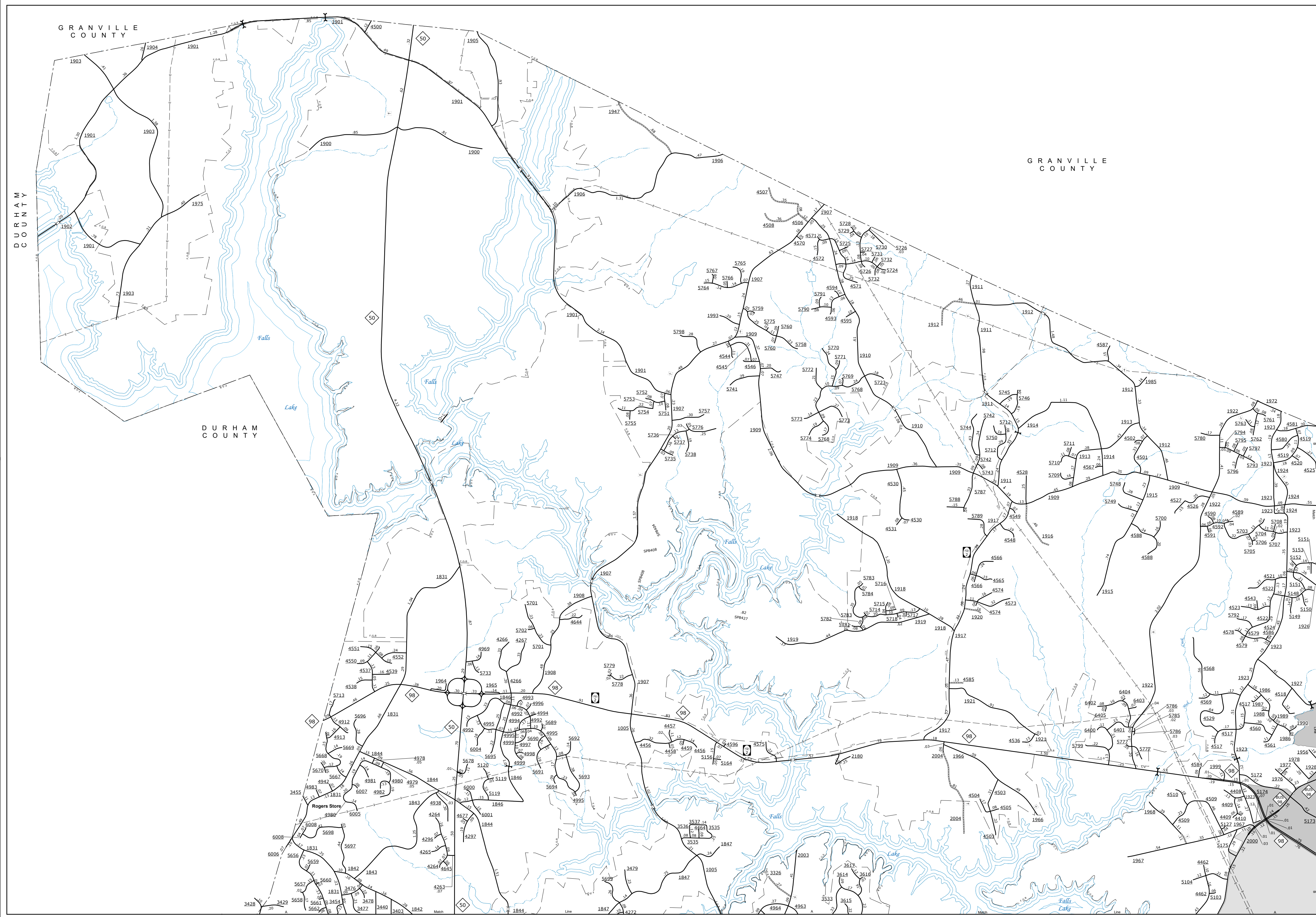

Falls Lake



ENLARGED MUNICIPAL AND SUBURBAN AREAS

WAKE COUNTY NORTH CAROLINA

PREPARED BY THE
NORTH CAROLINA DEPARTMENT OF TRANSPORTATION
OPERATIONS PROGRAM MANAGEMENT UNIT - MAPPING SECTION
IN COOPERATION WITH THE
U.S. DEPARTMENT OF TRANSPORTATION
FEDERAL HIGHWAY ADMINISTRATION

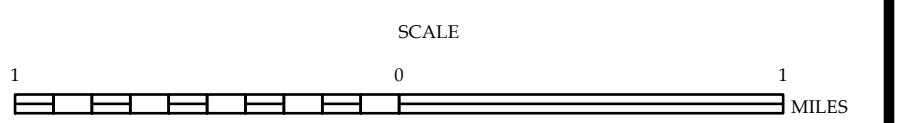

10,000 FOOT GRID BASED ON NORTH CAROLINA PLANE COORDINATE SYSTEM
LAMBERT CONFORMAL CONIC PROJECTION