

COPIES OF THIS MAP ARE AVAILABLE
 AT A FEE FROM THE N.C. DEPARTMENT OF TRANSPORTATION
 ADDRESS: N.C. DEPARTMENT OF TRANSPORTATION
 MSAU - MAPPING SECTION
 4809 BERTHOLD
 RALEIGH, NC 27606

The Mapping Section's goal is to provide the most accurate and current information possible. Map data is compiled from a variety of sources, including aerial photography, ground surveys, and other data. The data is processed and compiled into a digital format. The data is then used to create a map. The map is printed on a standard size paper. The map is available in a variety of formats, including paper and digital. The map is available for purchase from the N.C. Department of Transportation. For additional information, visit www.ncdot.gov or call 1-800-368-6848.

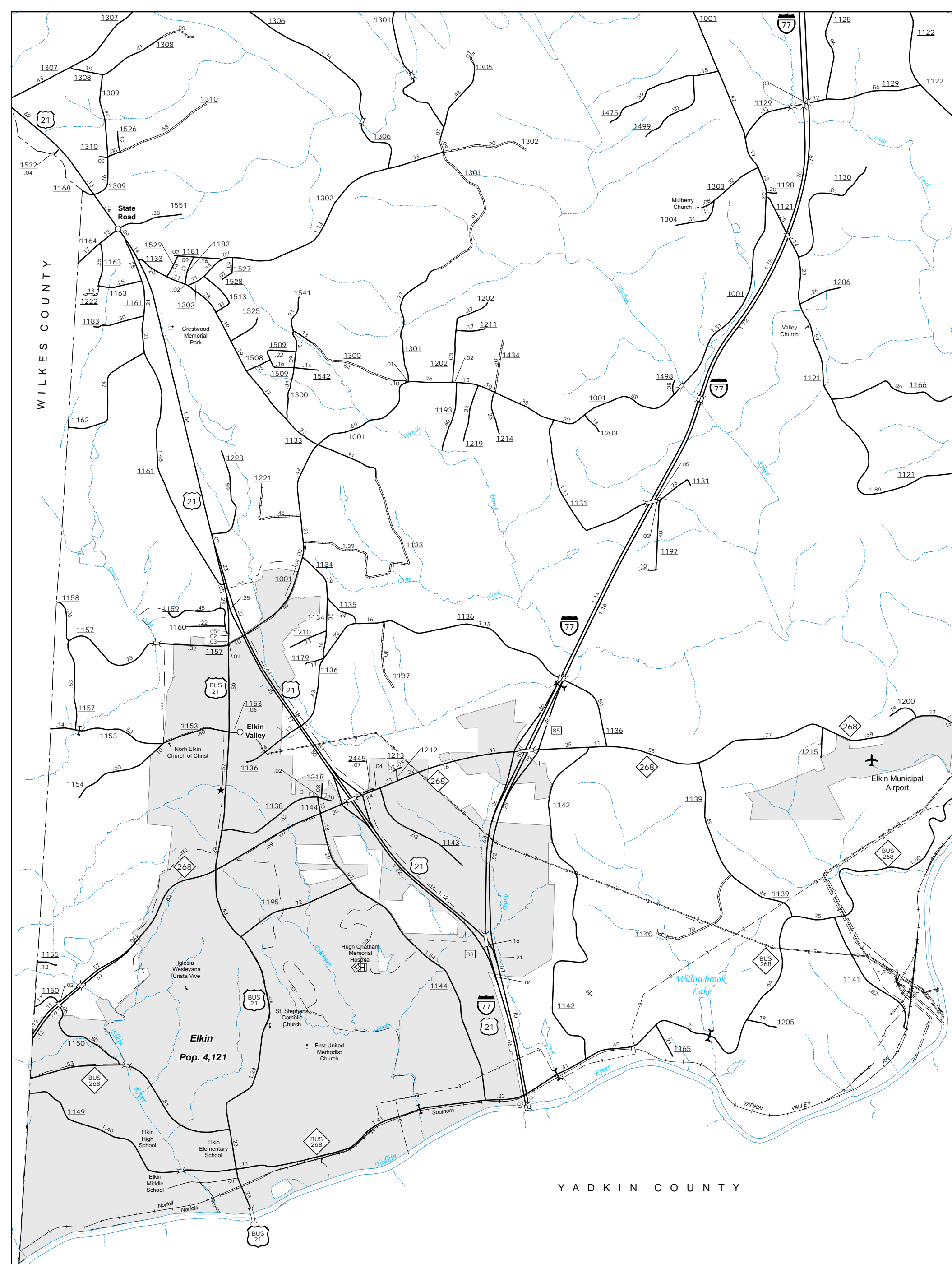

Elkin and Vicinity

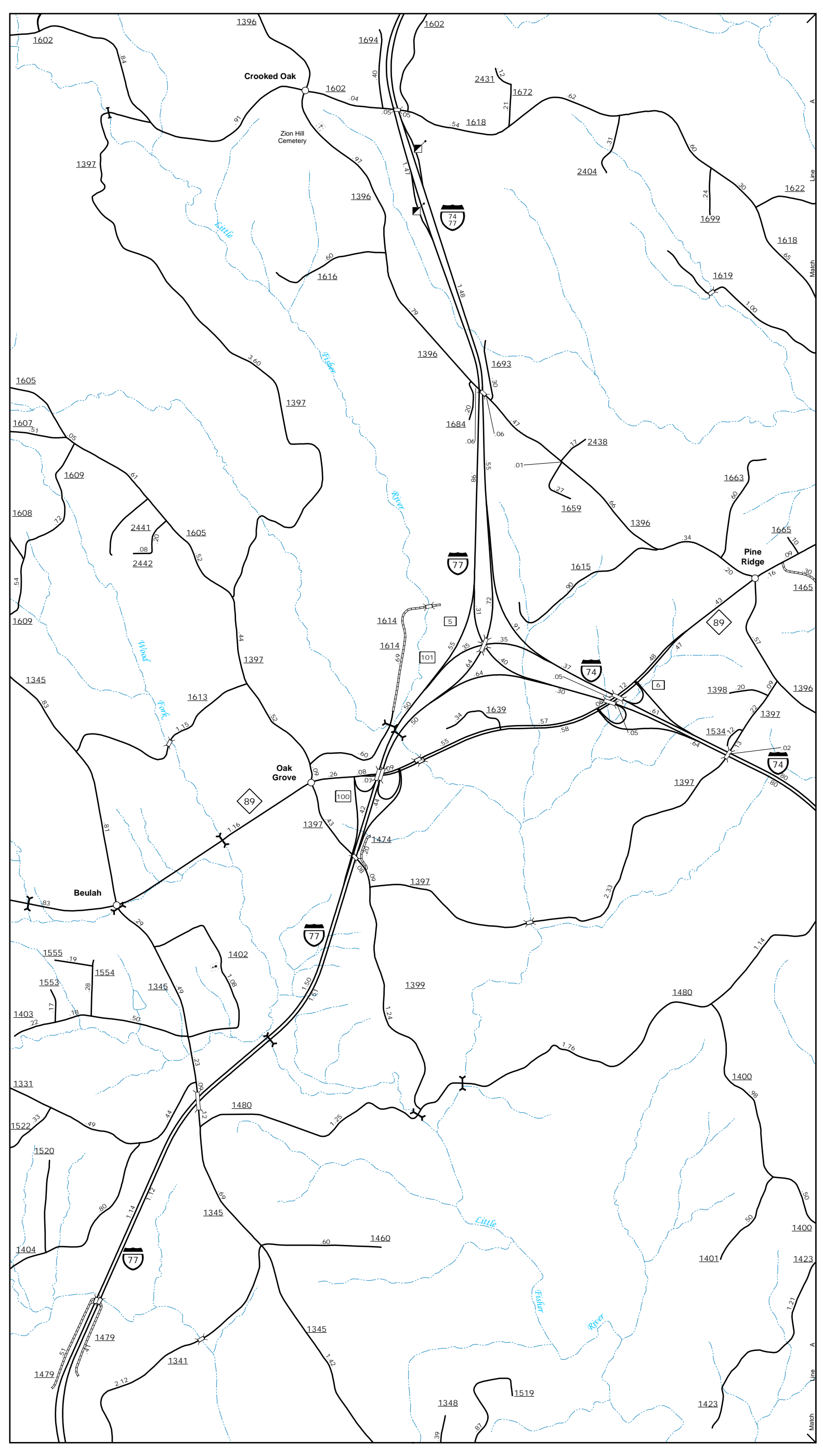

Oak Grove

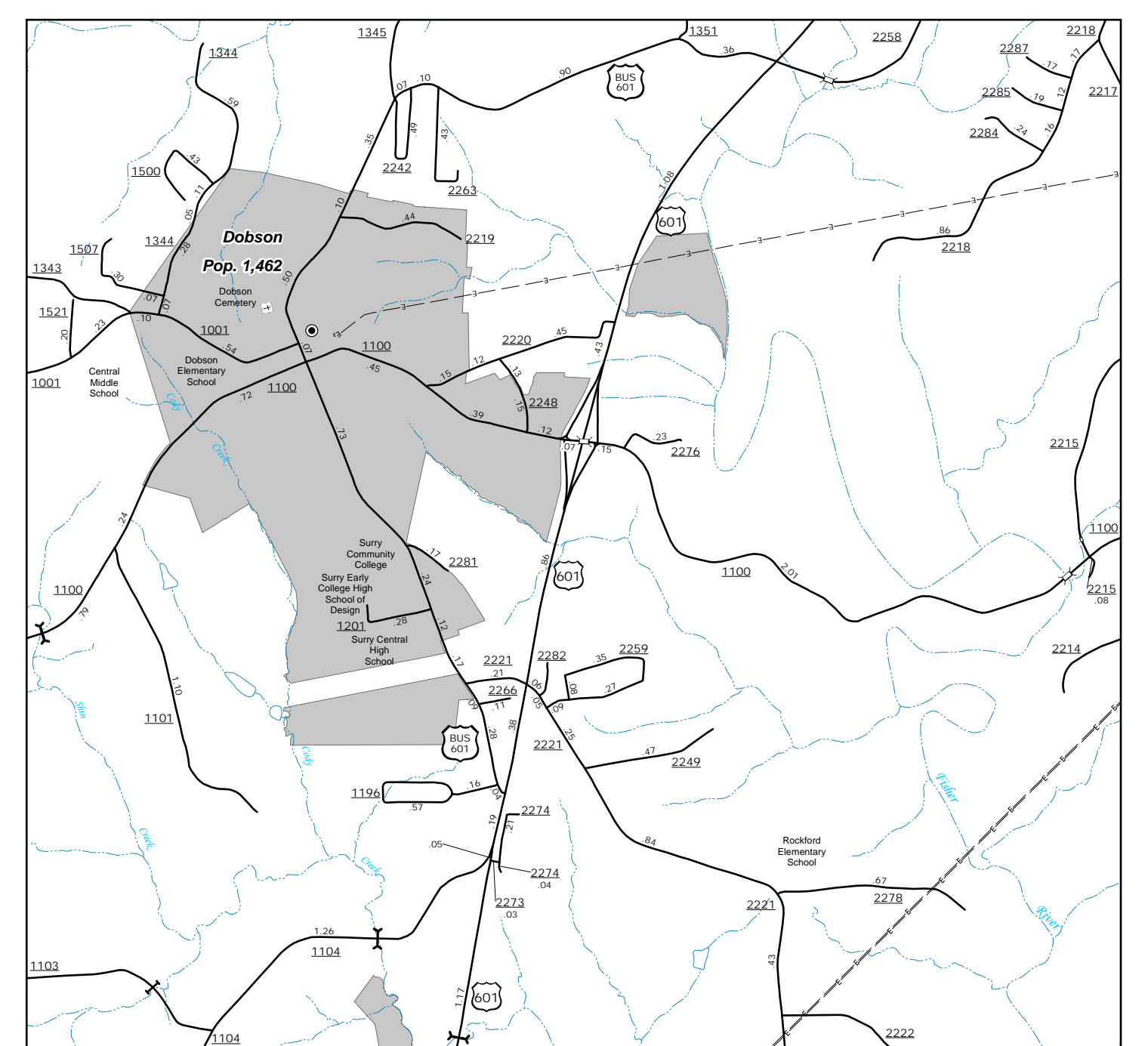

Dobson and Vicinity

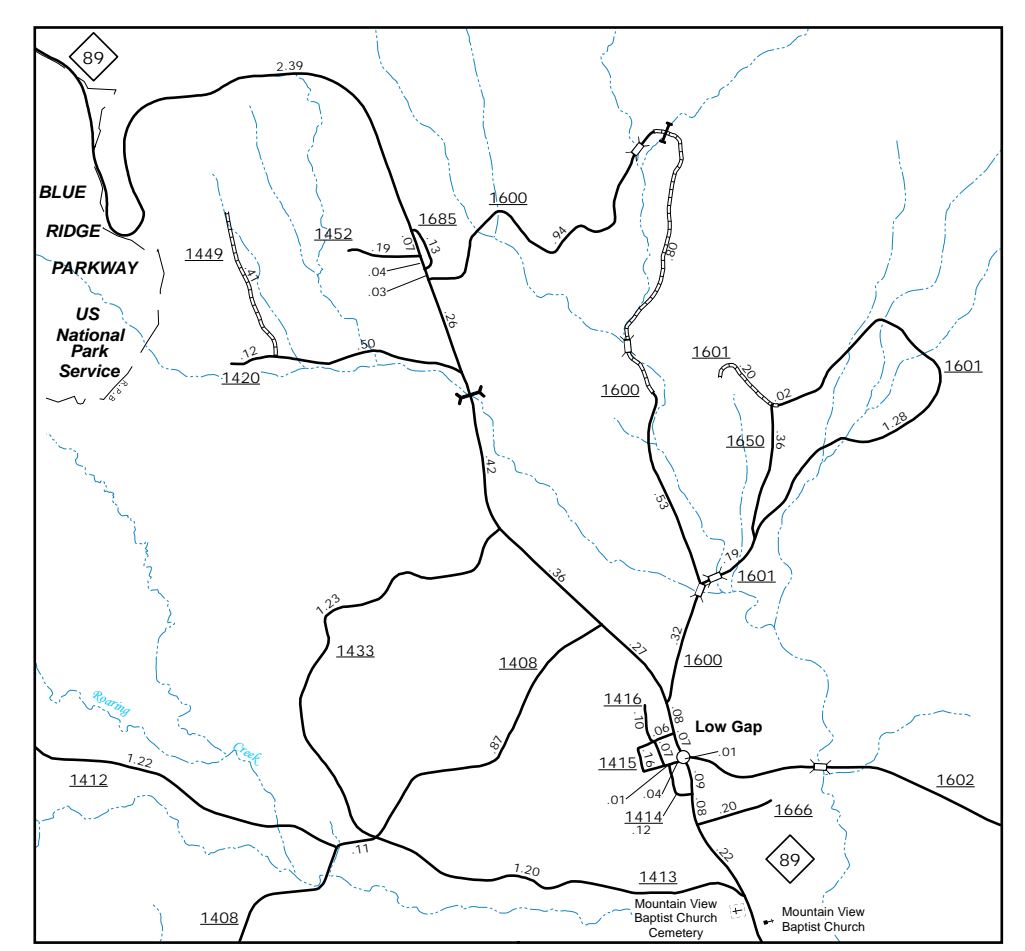

Lowgap and Vicinity

ENLARGED MUNICIPAL AND SUBURBAN AREAS
SURRY COUNTY
 NORTH CAROLINA

PREPARED BY THE
 NORTH CAROLINA DEPARTMENT OF TRANSPORTATION
 OPERATIONS PROGRAM MANAGEMENT UNIT - MAPPING SECTION
 IN COOPERATION WITH THE
 U.S. DEPARTMENT OF TRANSPORTATION
 FEDERAL HIGHWAY ADMINISTRATION

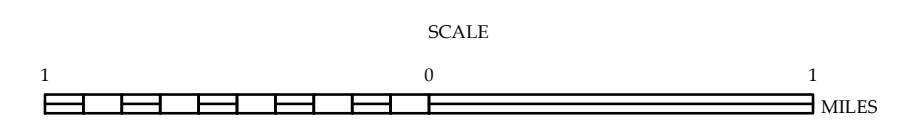

10,000 FOOT GRID BASED ON NORTH CAROLINA PLANE COORDINATE SYSTEM
 LAMBERT CONFORMAL CONIC PROJECTION