

The Mapping Section's goal is to provide the most accurate and current information possible. Map data is compiled from various sources and is subject to change. The information shown on this map is for informational purposes only and is not intended to be used for legal or other purposes. The information shown on this map is not a warranty, representation, or agreement by the State of North Carolina or any of its agencies. The information shown on this map is not to be used for any purpose other than that for which it was prepared. For additional information, visit <http://www.nc.gov> and click on Data Providers or contact us by phone at (919) 855-8480.

COPIES OF THIS MAP ARE AVAILABLE FOR PURCHASE AT A PUBLIC NOMINAL COST. ADDRESS: N.C. DEPARTMENT OF TRANSPORTATION, MSAU-MAPPING SECTION, 4809 BERNI, C.D., RALEIGH, NC 27606

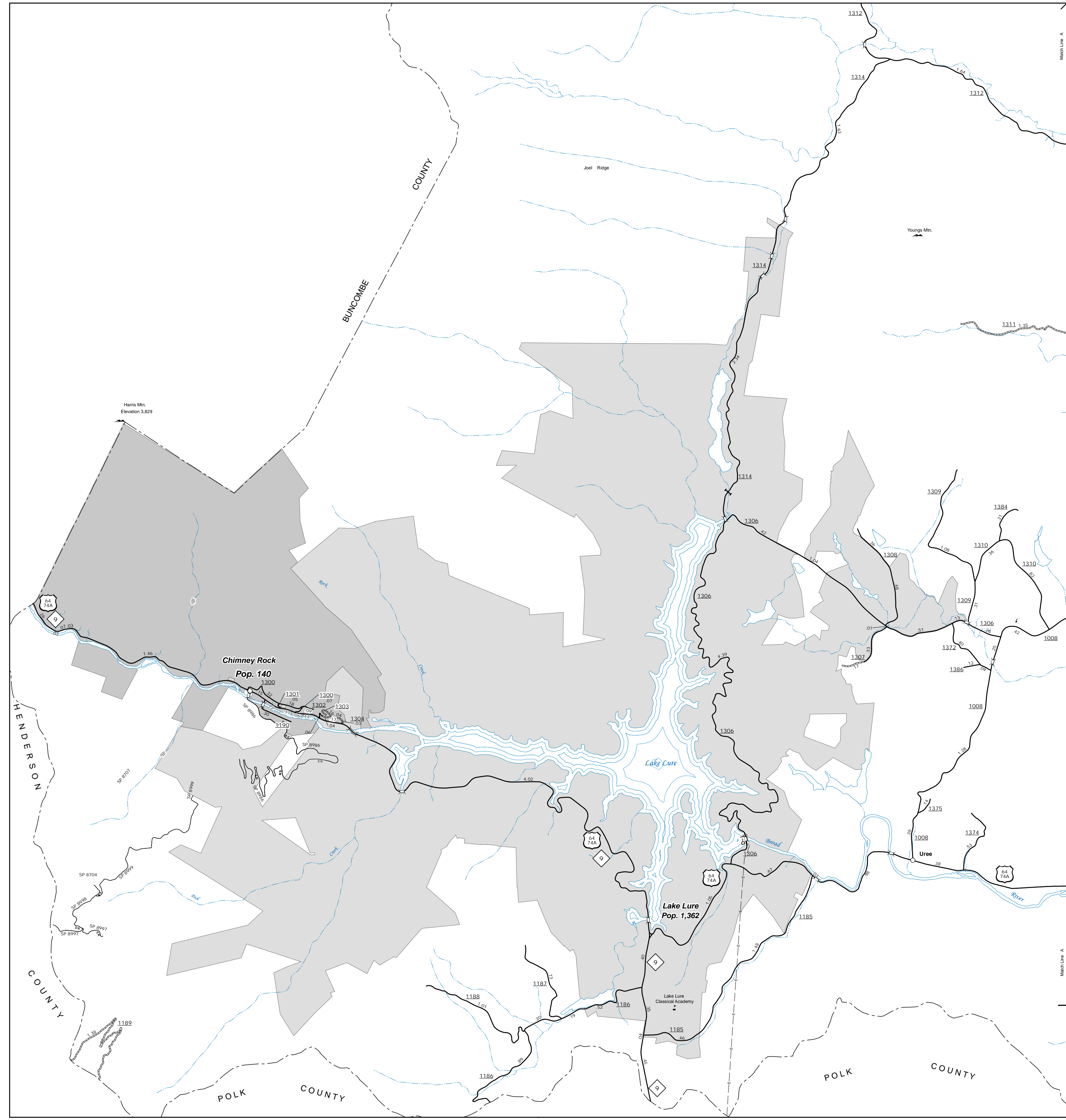

Lake Lure and Vicinity

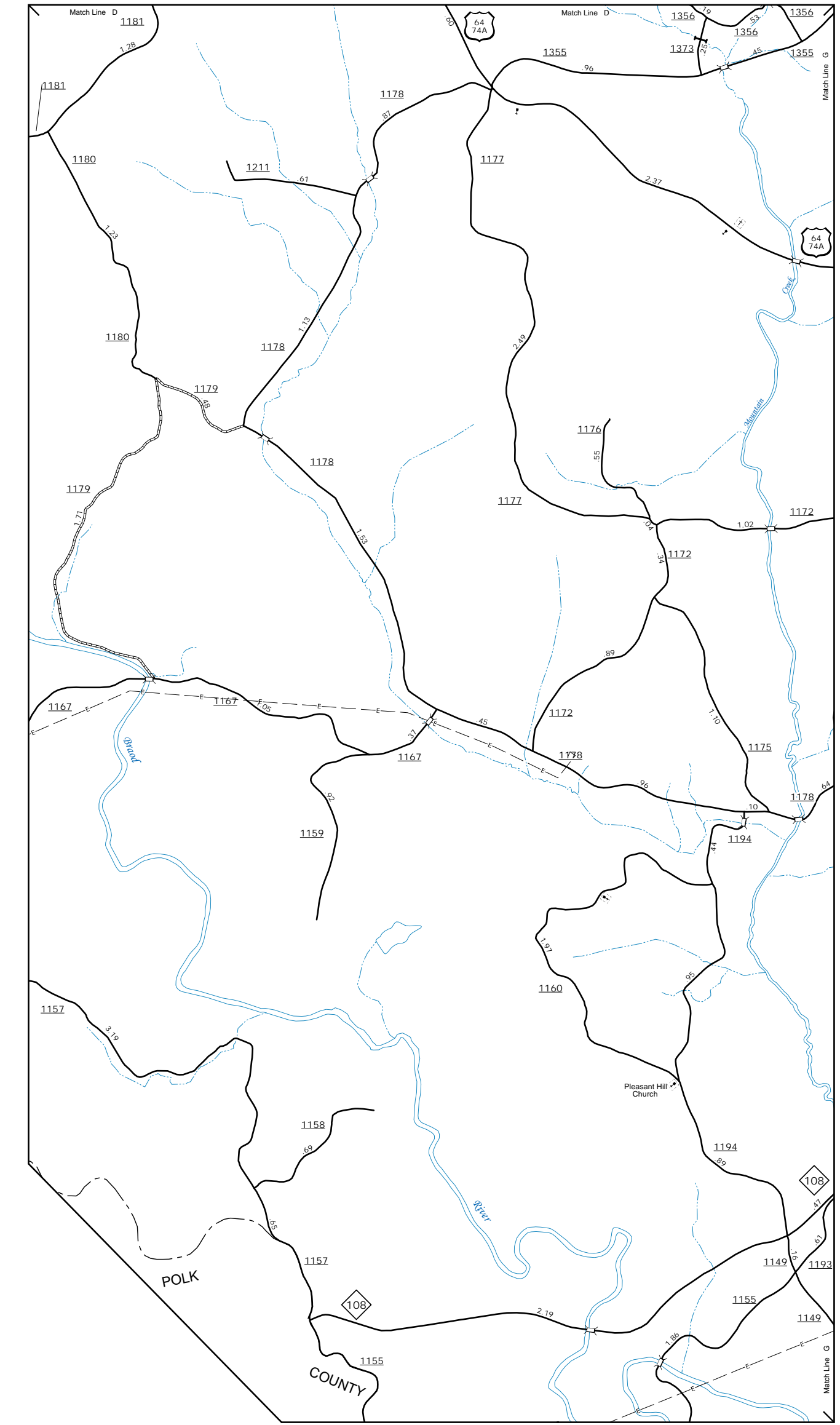

Pleasant Hill Church and Vicinity



ENLARGED MUNICIPAL AND SUBURBAN AREAS  
**RUTHERFORD COUNTY**  
 NORTH CAROLINA

PREPARED BY THE  
 NORTH CAROLINA DEPARTMENT OF TRANSPORTATION  
 OPERATIONS PROGRAM MANAGEMENT UNIT - MAPPING SECTION  
 IN COOPERATION WITH THE  
 U.S. DEPARTMENT OF TRANSPORTATION  
 FEDERAL HIGHWAY ADMINISTRATION

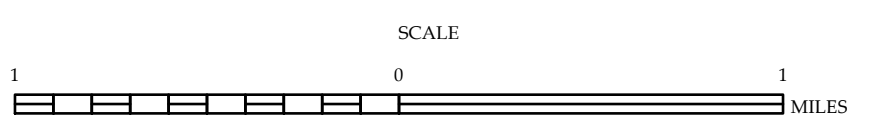

10,000 FOOT GRID BASED ON NORTH CAROLINA PLANE COORDINATE SYSTEM  
 LAMBERT CONFORMAL CONIC PROJECTION