

The Mapping Section's goal is to provide the most accurate and current information possible. Map data is compiled from various sources and is subject to change. The accuracy of the information is not guaranteed. The accuracy of the information is dependent on the accuracy of the data provided to the Mapping Section. The Mapping Section is not responsible for any errors or omissions in the information. For more information, please visit our website at <http://www.ncdot.gov/infrastructure/mapping> and click on Data Providers or contact us by phone at (919) 855-8480.

COPIES OF THIS MAP ARE AVAILABLE AT THE PUBLIC INFORMATION CENTER, ADDRESS: NORTH CAROLINA DEPARTMENT OF TRANSPORTATION, 600 BERNI, LENOIR, NC 28645

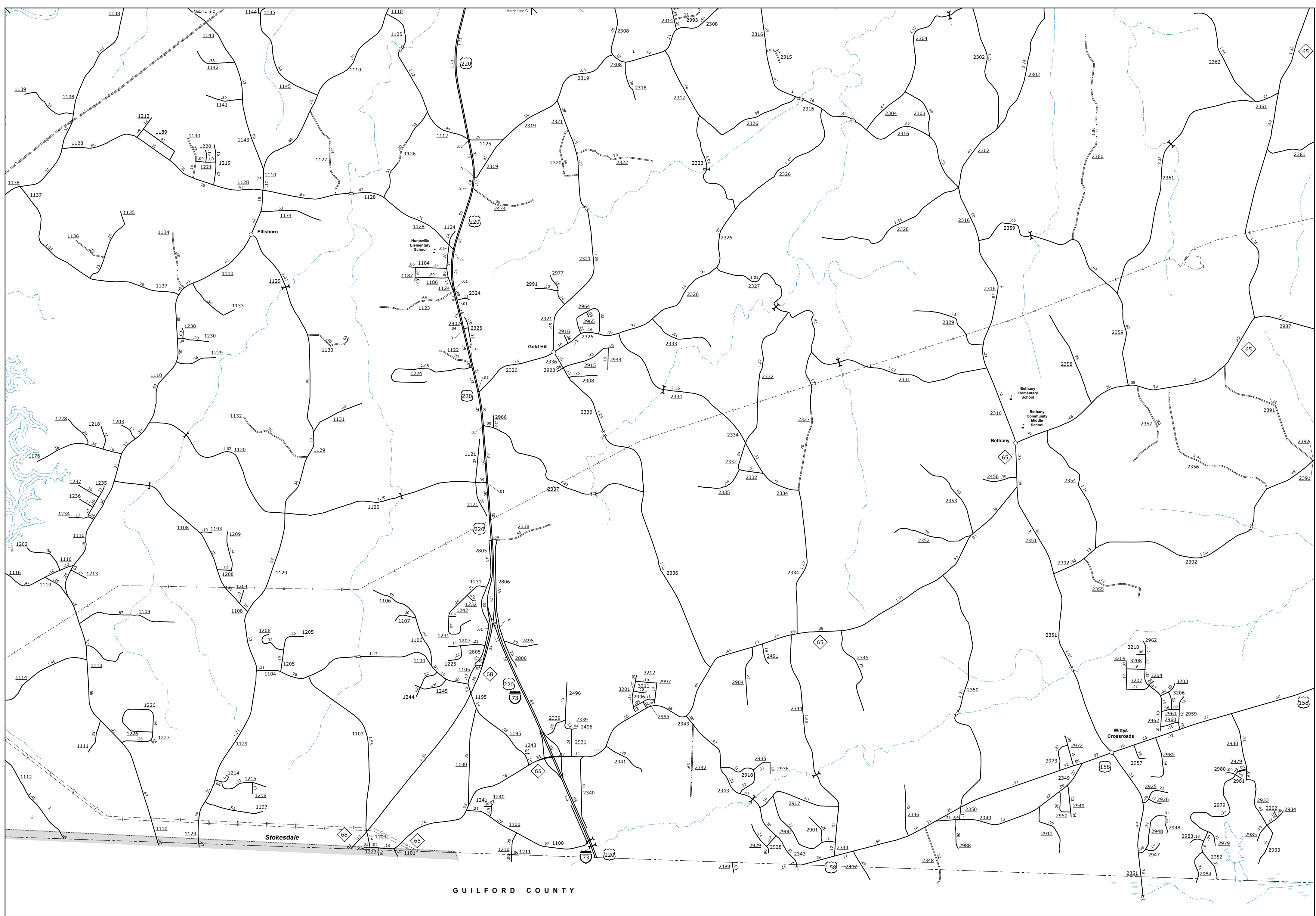

Bethany, Witty's Crossroads and Vicinity

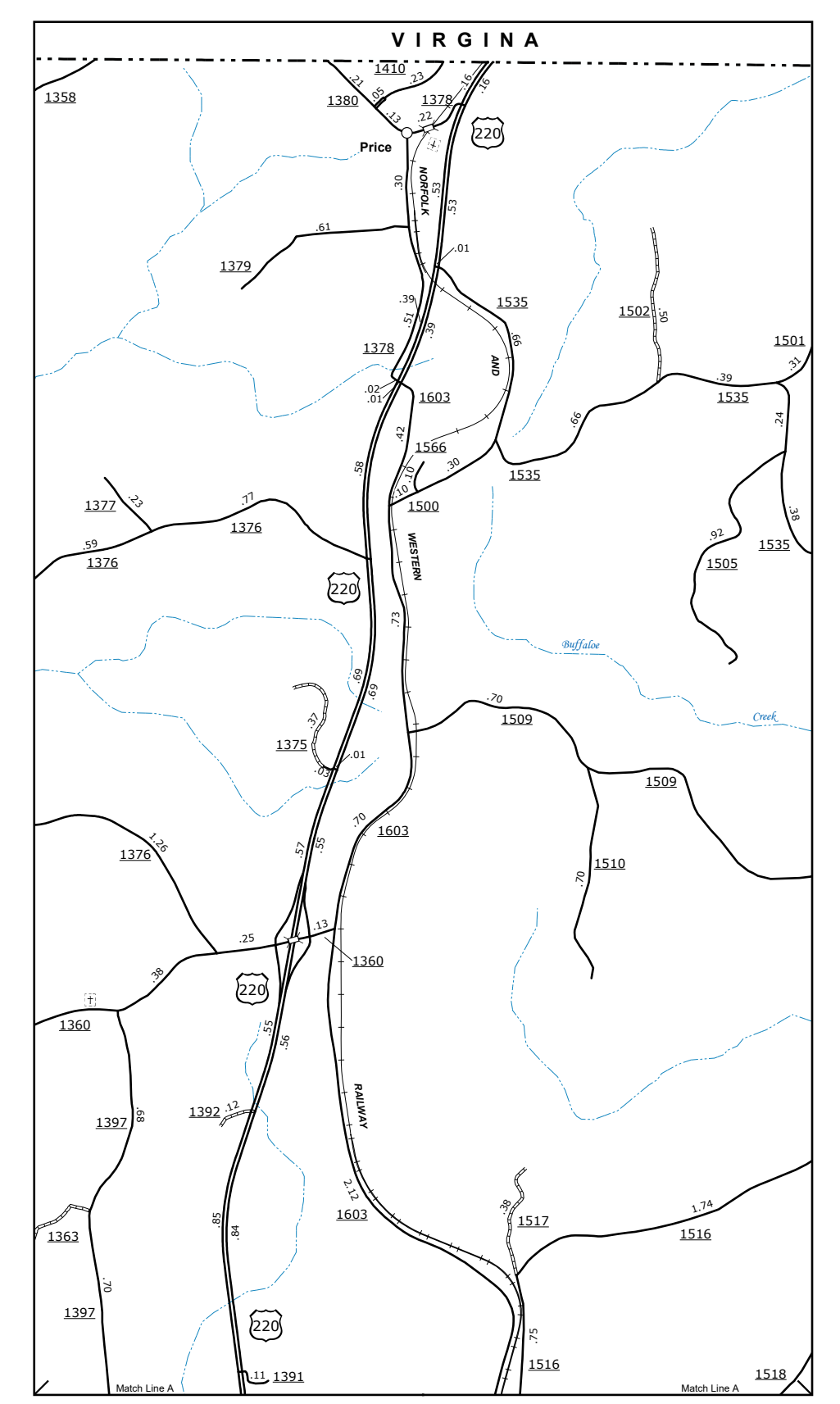

Price

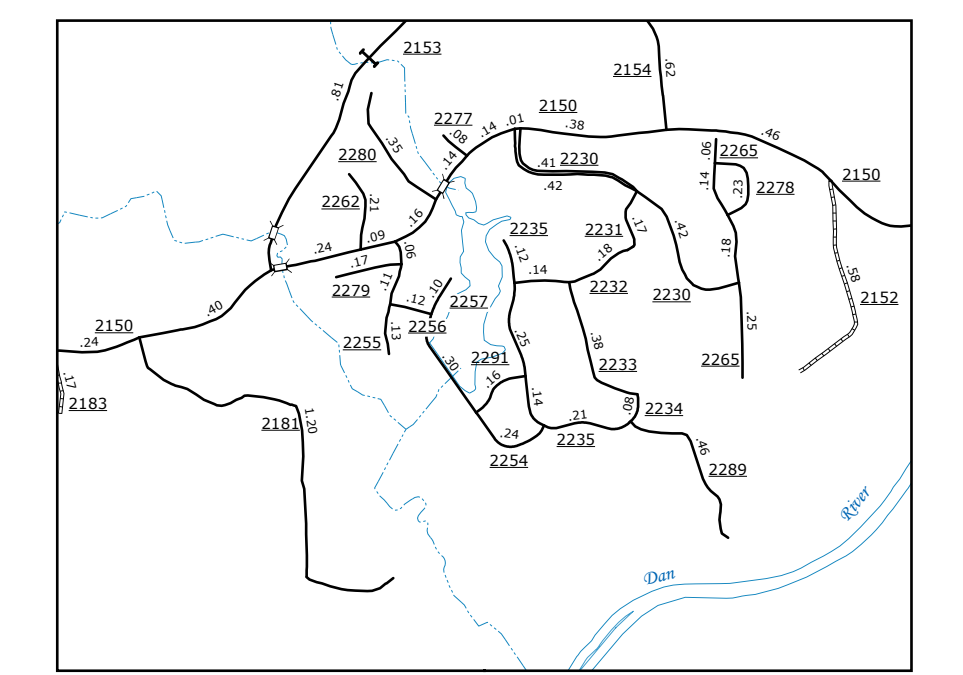

Inset 2

ENLARGED MUNICIPAL AND SUBURBAN AREAS  
**ROCKINGHAM COUNTY**  
 NORTH CAROLINA

PREPARED BY THE  
 NORTH CAROLINA DEPARTMENT OF TRANSPORTATION  
 OPERATIONS PROGRAM MANAGEMENT UNIT - MAPPING SECTION  
 IN COOPERATION WITH THE  
 U.S. DEPARTMENT OF TRANSPORTATION  
 FEDERAL HIGHWAY ADMINISTRATION

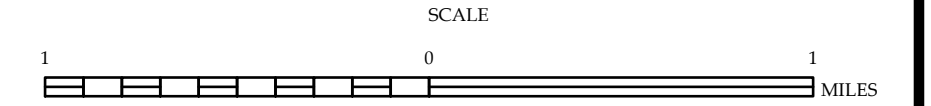

10,000 FOOT GRID BASED ON NORTH CAROLINA PLANE COORDINATE SYSTEM  
 LAMBERT CONFORMAL CONIC PROJECTION