

The Mapping Section's goal is to provide the most accurate and current information possible. Map data is compiled from various sources and is subject to change. The information is provided as a service and is not intended to be used for any purpose other than that for which it was intended. The information is provided as a service and is not intended to be used for any purpose other than that for which it was intended. For additional information, visit <http://www.ncdot.gov/transportation/operations/management/unit/mapping> and click on Data Providers or contact us by phone at (919) 835-8480.

COPIES OF THIS MAP ARE AVAILABLE AT A PUBLIC NOMINAL COST. ADDRESS: N.C. DEPARTMENT OF TRANSPORTATION, MSAU-MAPPING SECTION, 609 BERRY LANE, RALEIGH, NC 27605

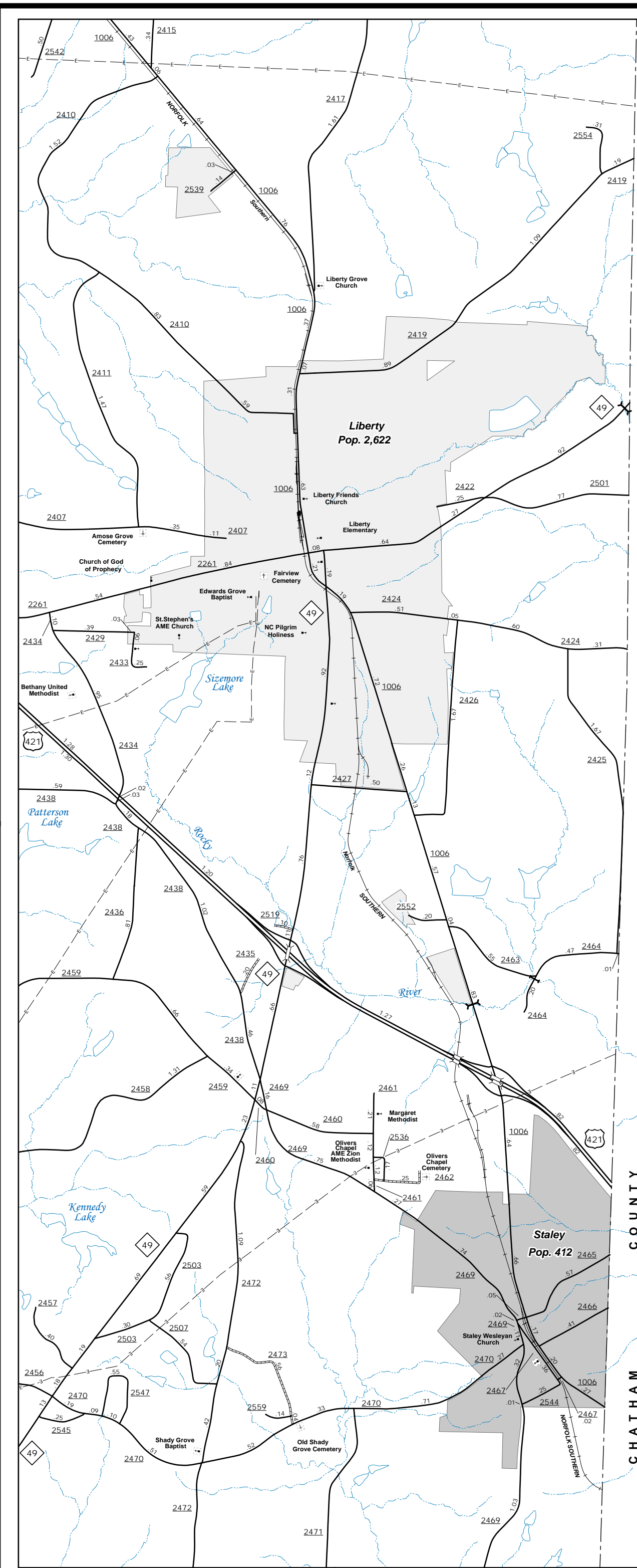

Liberty, Staley and Vicinity

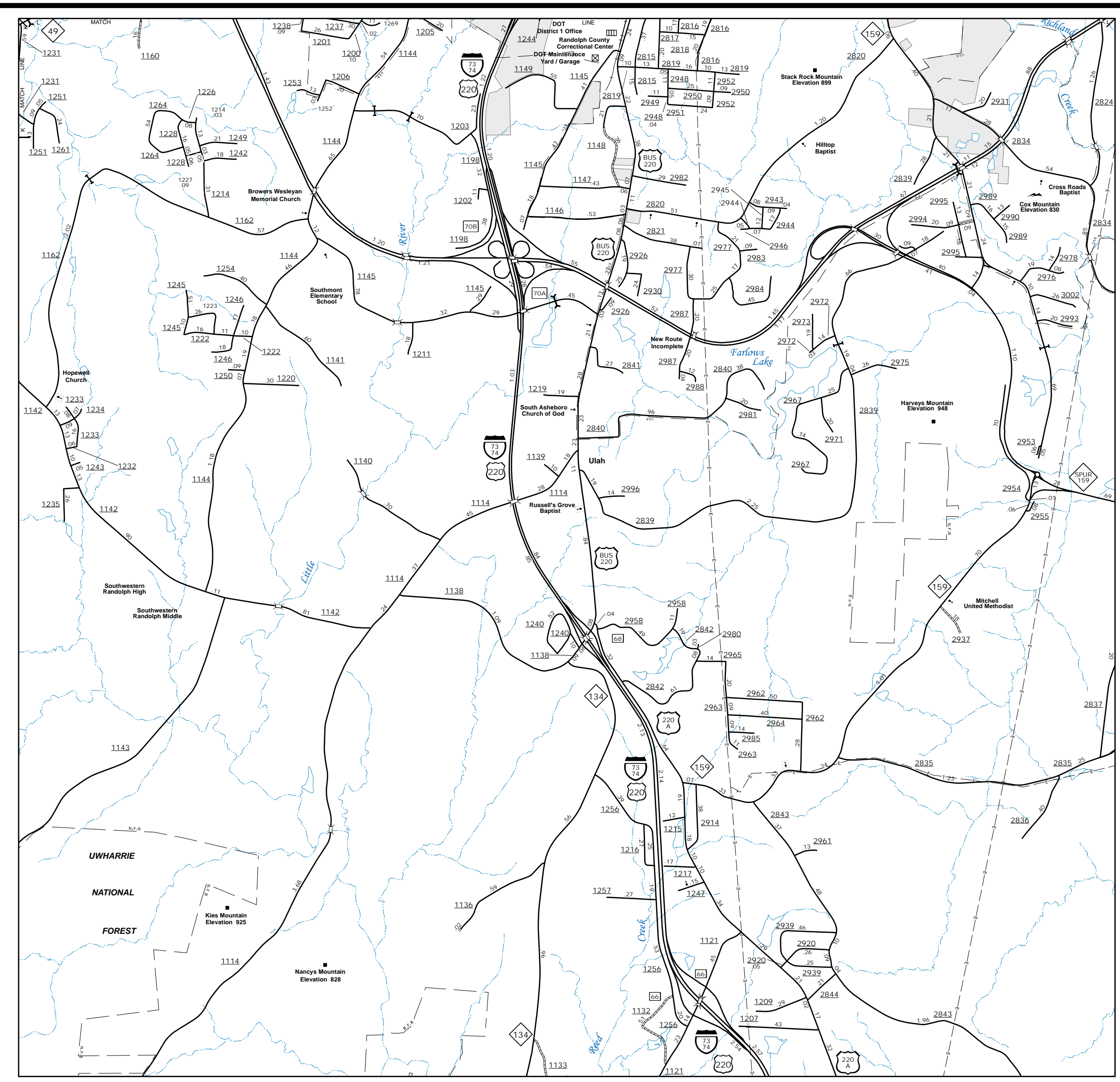

Ulah

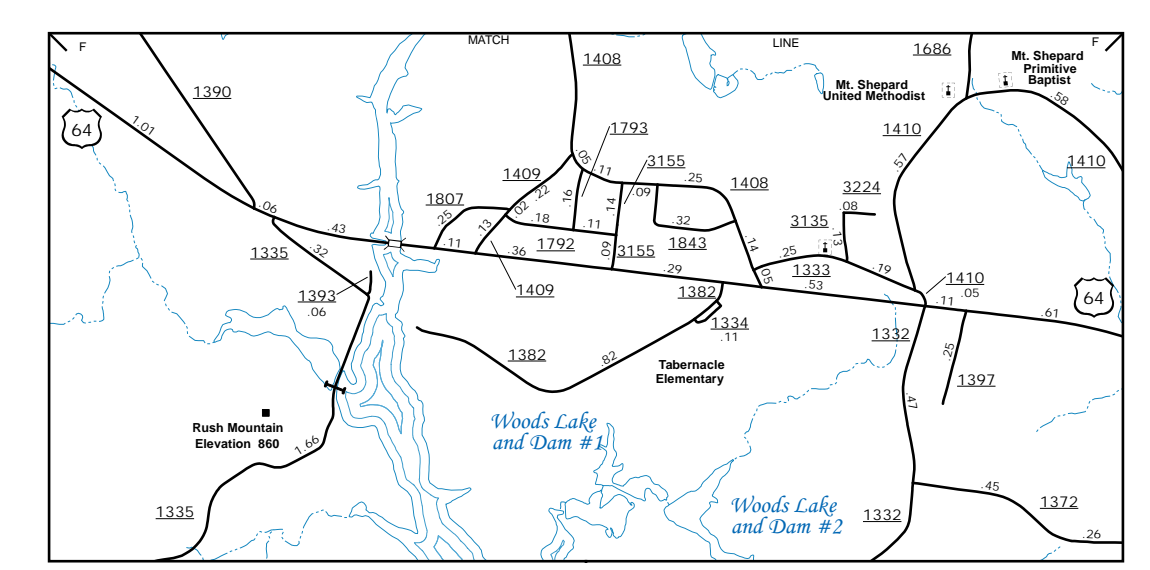

US-64 & Lake Reece Area

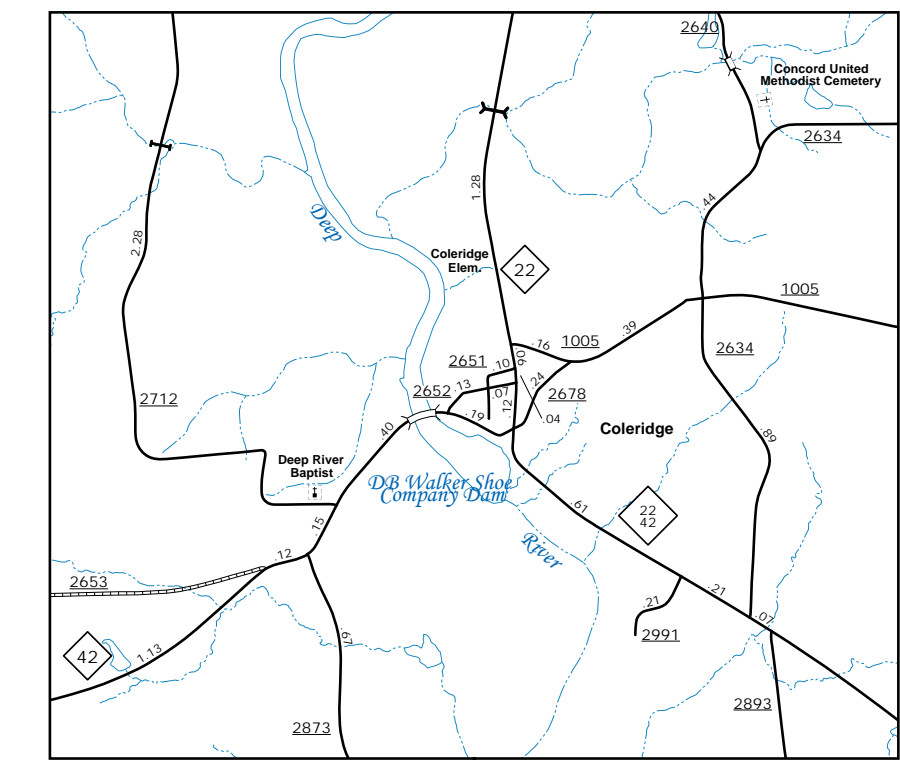

Coleridge

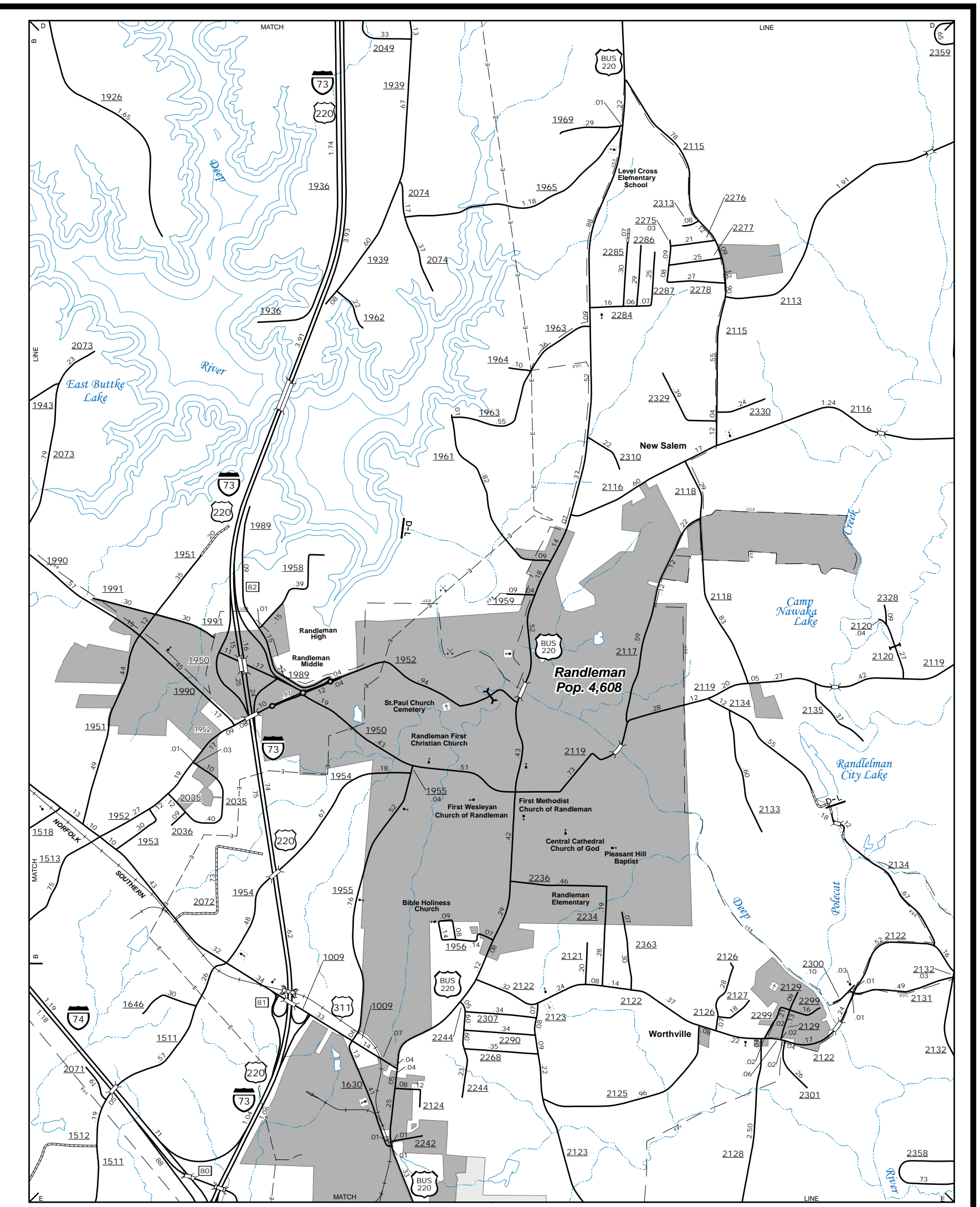

Randleman

ENLARGED MUNICIPAL AND SUBURBAN AREAS RANDOLPH COUNTY NORTH CAROLINA

PREPARED BY THE
NORTH CAROLINA DEPARTMENT OF TRANSPORTATION
OPERATIONS PROGRAM MANAGEMENT UNIT - MAPPING SECTION
IN COOPERATION WITH THE
U.S. DEPARTMENT OF TRANSPORTATION
FEDERAL HIGHWAY ADMINISTRATION

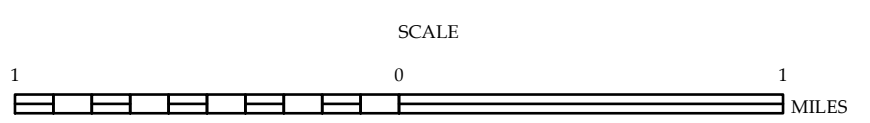

10,000 FOOT GRID BASED ON NORTH CAROLINA PLANE COORDINATE SYSTEM
LAMBERT CONFORMAL CONIC PROJECTION