

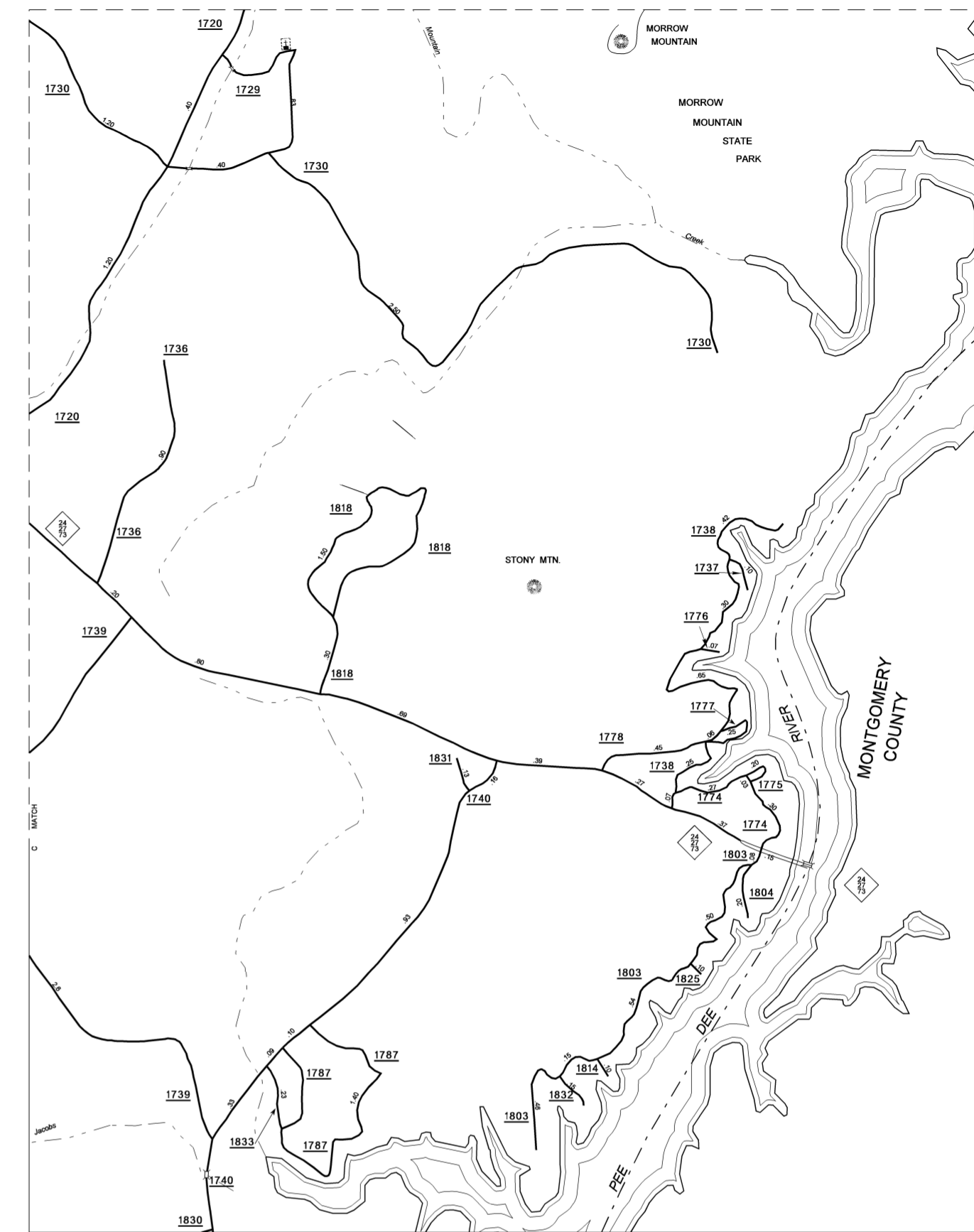

Stanfield, Locust, and Oakboro

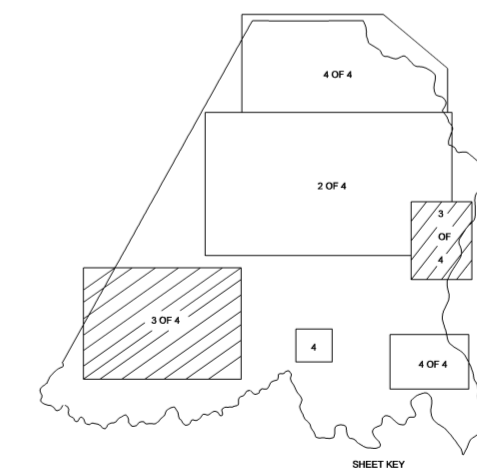

Inset 1



ENLARGED MUNICIPAL AND SUBURBAN AREAS

STANLY COUNTY

NORTH CAROLINA

PREPARED BY THE
NORTH CAROLINA DEPARTMENT OF TRANSPORTATION
STATE ROAD MAINTENANCE UNIT - MAPPING AND INFORMATION SECTION

IN COOPERATION WITH THE
U.S. DEPARTMENT OF TRANSPORTATION
FEDERAL HIGHWAY ADMINISTRATION

SCALE
0 1 MILE

167

COPIES OF THIS MAP ARE AVAILABLE
TO THE PUBLIC AT A NOMINAL COST
ADDRESS:
N.C. DEPARTMENT OF TRANSPORTATION
STATE ROAD MAINTENANCE UNIT - MAPPING AND INFORMATION SECTION
3401 CAREL SANDERS BLVD.
RALEIGH, N.C. 27610

REVISED
4/2009 MEMO
10/09 MEMO
10/30/09 MEMO

STANLY SUP. 2