

Disclaimer: The SRMU's goal is to provide the most accurate information as possible. The magnitude of the data prevents any guarantee of accuracy or completeness. If you find any information that is incorrect, please send your request to the SRMU Section.

N.C. DEPARTMENT OF TRANSPORTATION
STATE ROAD MAINTENANCE UNIT
3401 CARE SANDBURG CT.
RALEIGH, N.C. 27610

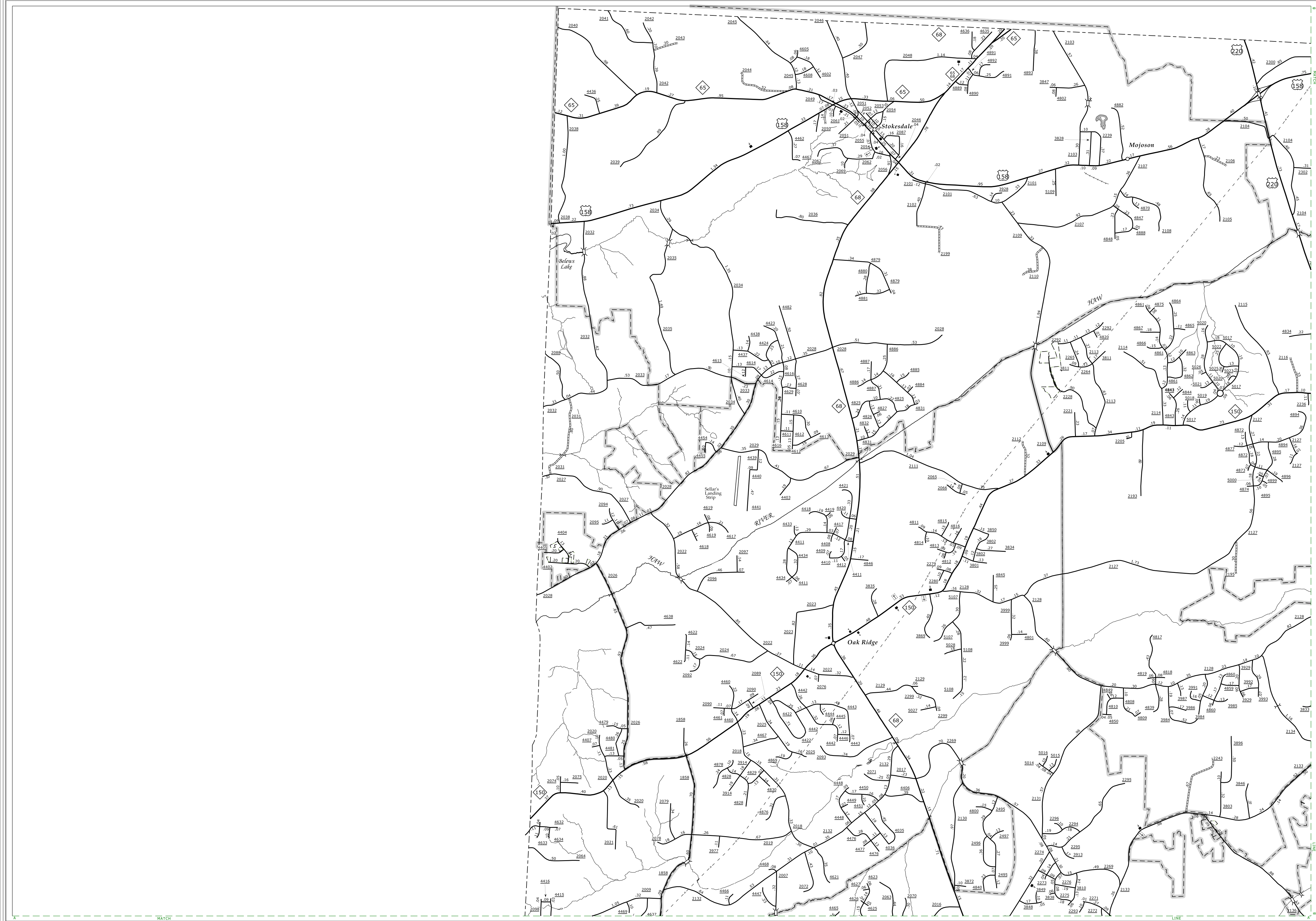

SHEET 2	SHEET 3	SHEET 4
SHEET 5	SHEET 6	SHEET 7
SHEET 8	SHEET 9	SHEET 10

SUPPLEMENT SHEET KEY

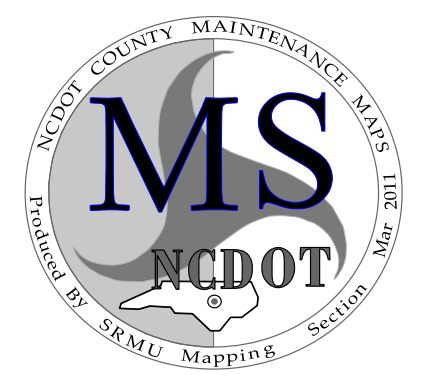
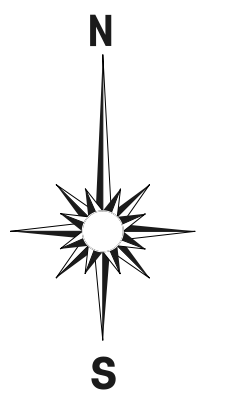

GUILFORD COUNTY NORTH CAROLINA

ENLARGED MUNICIPAL AND SUBURBAN AREAS
PREPARED BY THE
NORTH CAROLINA DEPARTMENT OF TRANSPORTATION
STATE ROAD MAINTENANCE UNIT - MAPPING SECTION
IN COOPERATION WITH THE
U.S. DEPARTMENT OF TRANSPORTATION
FEDERAL HIGHWAY ADMINISTRATION

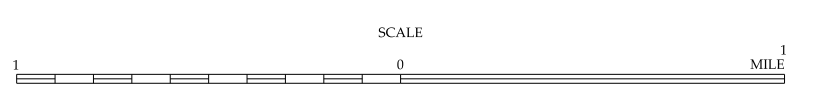

10,000 FOOT GRID BASED ON NORTH CAROLINA STATE PLANE COORDINATE SYSTEM
NAD 83 FEET
LAMBERT CONFORMAL CONIC
SHEET 2 OF 10

GUILFORD SUP1