

FORSYTH SUP. 1  
 COPIES OF THIS MAP ARE AVAILABLE TO THE PUBLIC AT A NOMINAL COST.  
 ADDRESS:  
 N.C. DEPARTMENT OF TRANSPORTATION  
 3401 CARL SANDHURST CT.  
 RALEIGH, N.C. 27610

REVISED  
 10/12/07 AMB  
 12/4/08 AMB  
 2/12/08 AMB  
 5/22/08 RLN  
 9/30/08 RLN  
 10/12/08 RLN  
 11/16/09 RLN  
 8/24/09 SJM  
 2/12/10 SM

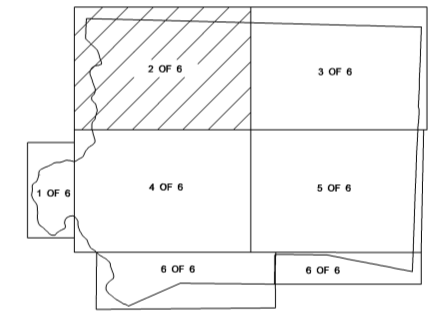

ENLARGED MUNICIPAL AND SUBURBAN AREAS  
**FORSYTH COUNTY**  
 NORTH CAROLINA  
 PREPARED BY THE  
 NORTH CAROLINA DEPARTMENT OF TRANSPORTATION  
 STATE ROAD MAINTENANCE UNIT - MAPPING AND INFORMATION SECTION  
 IN COOPERATION WITH THE  
 U.S. DEPARTMENT OF TRANSPORTATION  
 FEDERAL HIGHWAY ADMINISTRATION

