

DAVIDSON

COPIES OF THIS MAP ARE AVAILABLE TO THE PUBLIC AT A NOMINAL COST. ADDRESS: N.C. DEPARTMENT OF TRANSPORTATION 4600 S.W. 8th ST. SAULSBURY, N.C. 27169

REVISED 9/30/98 RLN 10/30/99 RLN 2/9/00 RLN 4/6/00 SLM 6/18/00 SLM 8/24/00 SLM 11/12/00 SLM 11/13/00 SLM 2/27/01 SLM 2/16/02 SLM

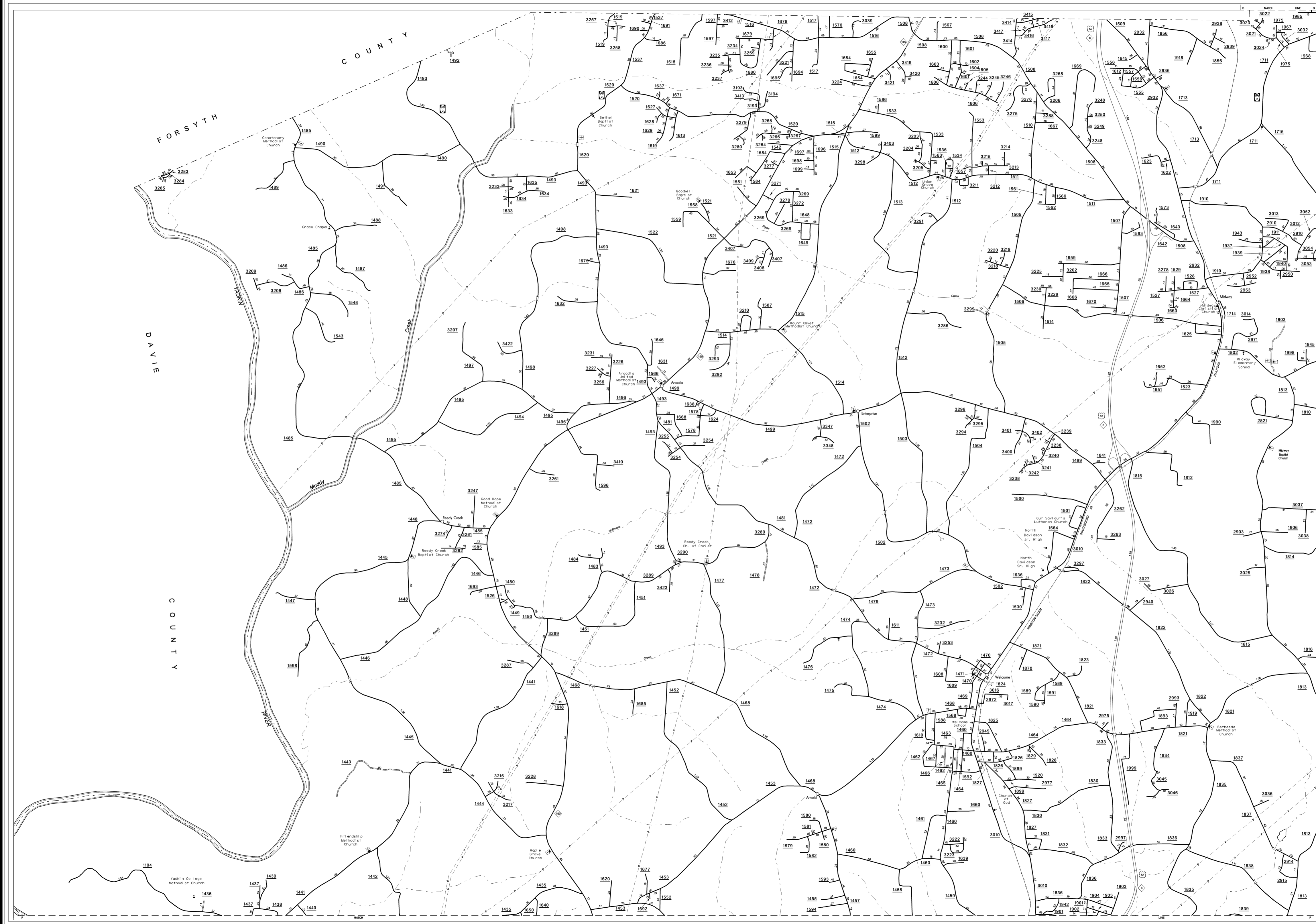

FORSYTH COUNTY
DAVIE COUNTY

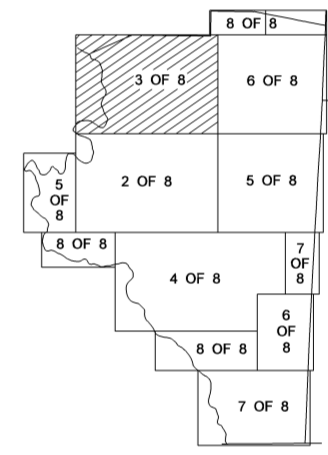

ENLARGED MUNICIPAL AND SUBURBAN AREAS
DAVIDSON COUNTY
NORTH CAROLINA
PREPARED BY THE
NORTH CAROLINA DEPARTMENT OF TRANSPORTATION
STATE ROAD MAINTENANCE UNIT - MAPPING AND INFORMATION SECTION
IN COOPERATION WITH THE
U.S. DEPARTMENT OF TRANSPORTATION
FEDERAL HIGHWAY ADMINISTRATION

