

COLUMBUS SUP 2

COPIES OF THIS MAP ARE AVAILABLE TO THE PUBLIC AT A NOMINAL COST. ADDRESS: N.C. DEPARTMENT OF TRANSPORTATION, DIVISION OF HIGHWAYS AND SURVEYS, 3401 CAPE SANDHURST CT., FOLEY, N.C. 27834

REVISED
1/26/05 P.M.K.
6/30/05 M.A.G.
9/1/06 J.M.B.
10/24/06 J.M.B.
2/5/07 J.M.B.
5/11/07 J.M.B.
1/10/08 J.M.B.
2/12/08 J.M.B.
2/20/08 J.M.B.
4/30/08 S.A.M.
12/1/09 B.D.G.

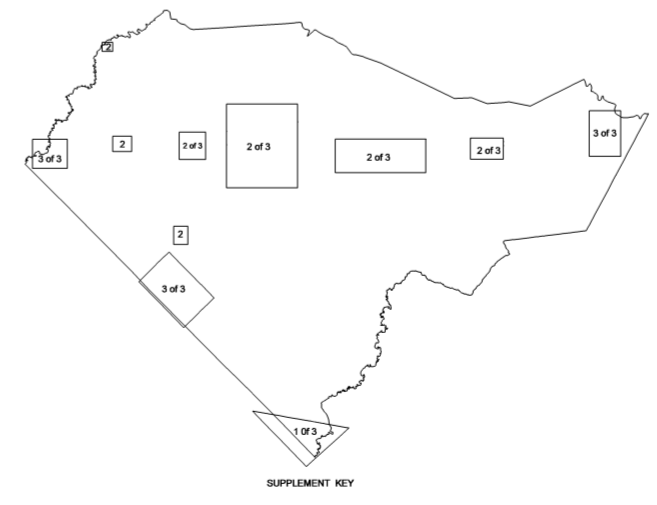
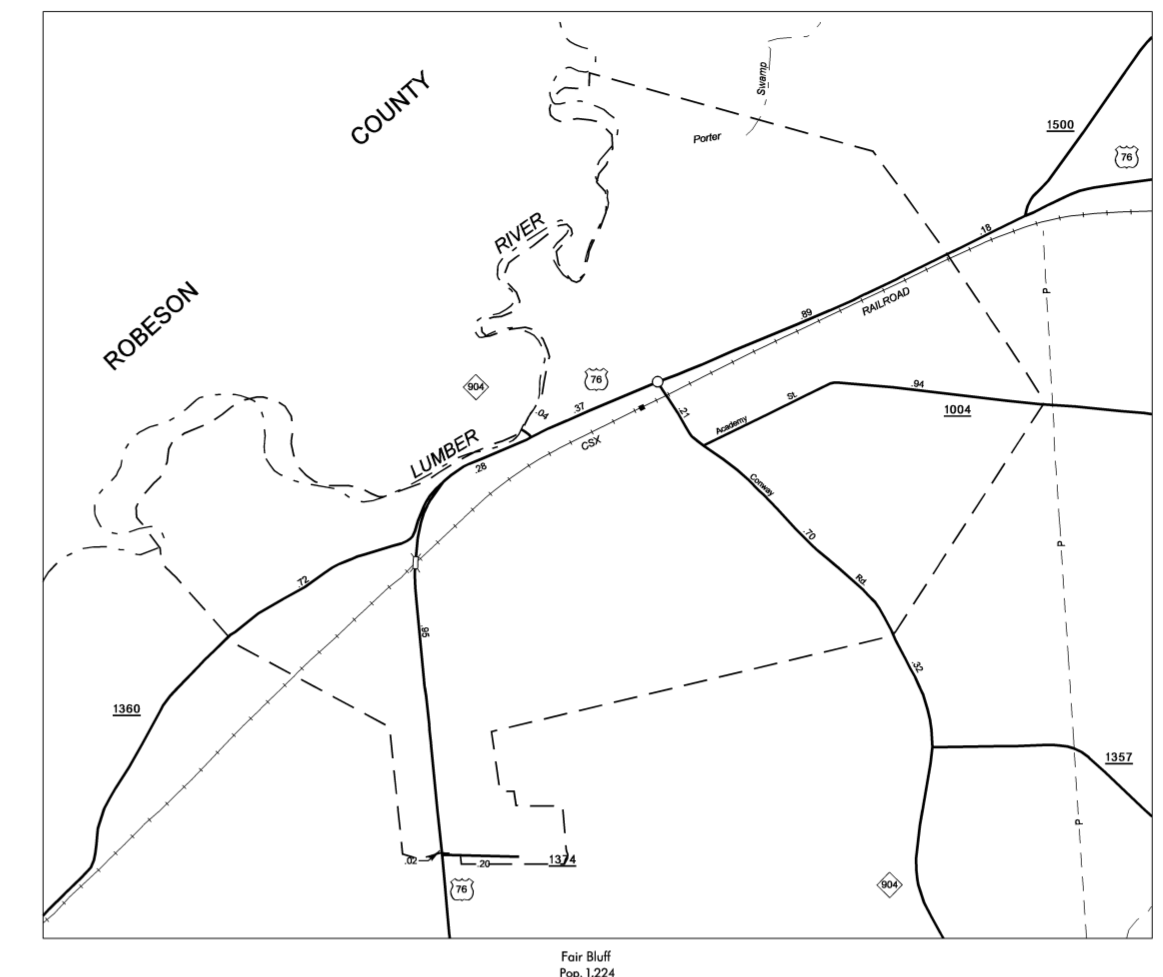
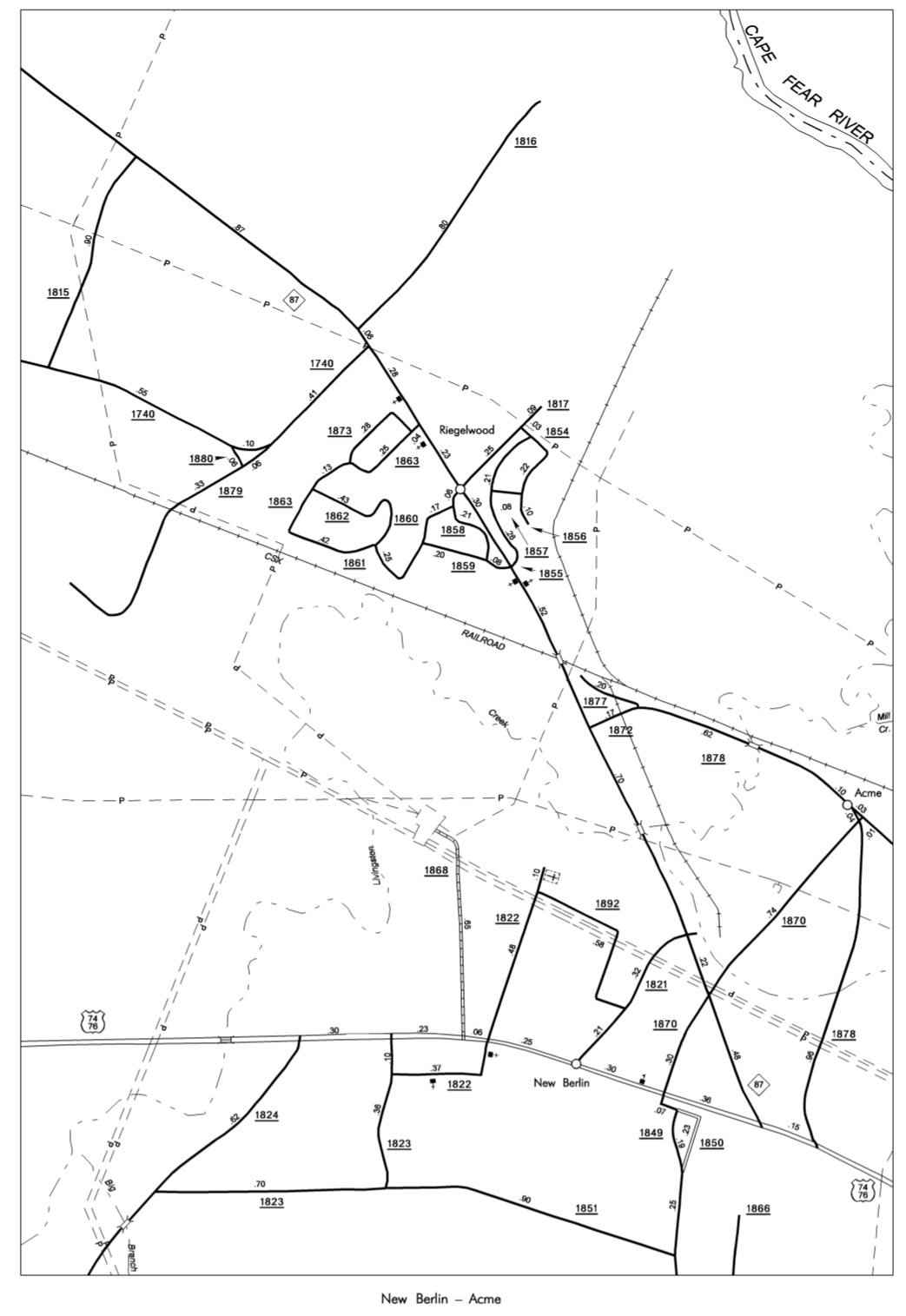
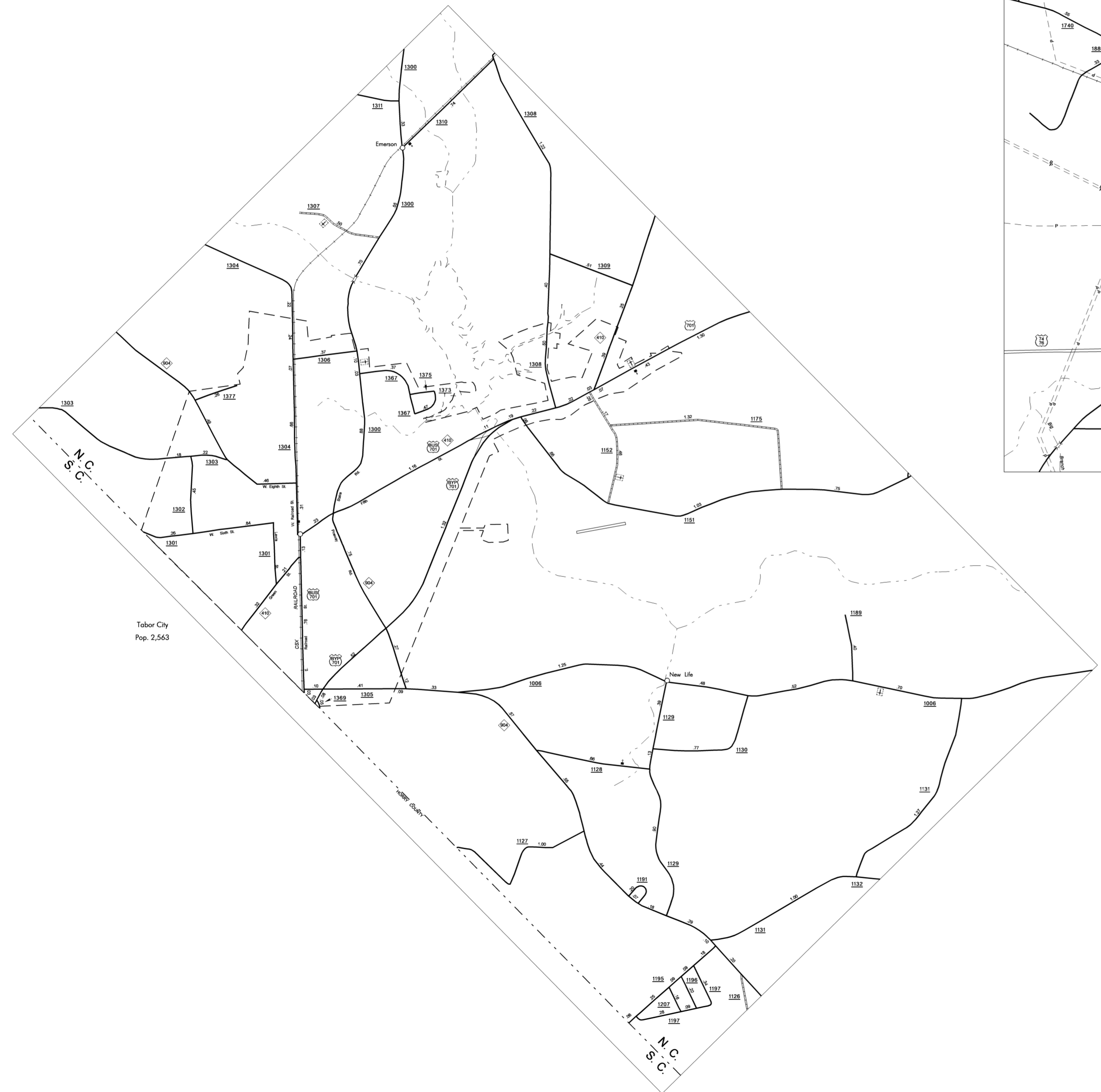

ENLARGED MUNICIPAL AND SUBURBAN AREAS
COLUMBUS COUNTY
 NORTH CAROLINA
 PREPARED BY THE
 NORTH CAROLINA DEPARTMENT OF TRANSPORTATION
 STATE ROAD MAINTENANCE UNIT - MAPPING AND INFORMATION SECTION
 IN COOPERATION WITH THE
 U.S. DEPARTMENT OF TRANSPORTATION
 FEDERAL HIGHWAY ADMINISTRATION

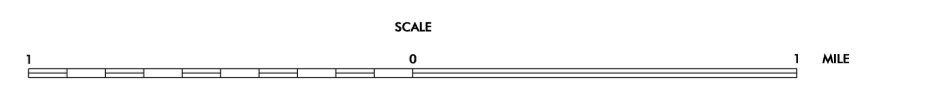

10,000 FOOT GRID BASED ON NORTH CAROLINA PLANE COORDINATE SYSTEM
 POLYCONIC PROJECTION